

UNITED STATES  
DEPARTMENT OF THE INTERIOR  
GEOLOGICAL SURVEY

30-045-21639

## APPLICATION FOR PERMIT TO DRILL, DEEPEN, OR PLUG BACK

1a. TYPE OF WORK DRILL <input checked="" type="checkbox"/> DEEPEN <input type="checkbox"/> PLUG BACK <input type="checkbox"/>		5. LEASE DESIGNATION AND SERIAL NO. MOO-C-1420-1722
b. TYPE OF WELL OIL WELL <input checked="" type="checkbox"/> GAS WELL <input type="checkbox"/> OTHER <input type="checkbox"/>		6. IF INDIAN, ALLOTTEE OR TRIBE NAME Ute Mountain Ute
2. NAME OF OPERATOR IMI, Clinton Oil, Dow & Marks		7. UNIT AGREEMENT NAME
3. ADDRESS OF OPERATOR 501 Airport Drive, Farmington New Mexico		8. FARM OR LEASE NAME Federal Ute 25
4. LOCATION OF WELL (Report location clearly and in accordance with any State requirements.)* At surface 990' FSL 2100' FWL Sec. 25-T31N-R15W At proposed prod. zone		9. WELL NO. 1-25
14. DISTANCE IN MILES AND DIRECTION FROM NEAREST TOWN OR POST OFFICE* 21 miles north and west of Farmington, New Mexico		10. FIELD AND POOL, OR WILDCAT Verde-Gallup
15. DISTANCE FROM PROPOSED* LOCATION TO NEAREST PROPERTY OR LEASE LINE, FT. (Also to nearest drig. unit line, if any) 990' FSL		11. SEC., T., R., M., OR BLK. AND SURVEY OR AREA Sec. 25-T31N-R15W
16. NO. OF ACRES IN LEASE 640		12. COUNTY OR PARISH San Juan
17. NO. OF ACRES ASSIGNED TO THIS WELL 40		13. STATE N. Mex.
18. DISTANCE FROM PROPOSED LOCATION* TO NEAREST WELL, DRILLING, COMPLETED, OR APPLIED FOR, ON THIS LEASE, FT. 2100' PxA		19. PROPOSED DEPTH 4350'
20. ROTARY OR CABLE TOOLS Rotary		21. ELEVATIONS (Show whether DF, RT, GR, etc.) 5454' GR.
22. APPROX. DATE WORK WILL START* Jan. 15, 1975		

## 23. PROPOSED CASING AND CEMENTING PROGRAM

SIZE OF HOLE	SIZE OF CASING	WEIGHT PER FOOT	SETTING DEPTH	QUANTITY OF CEMENT
12 1/2"	8 5/8"	36	150'	150 sacks
6 3/4"	4 1/2"	9.5	4350'	200 sacks

Minerals Management Inc. (operator) proposes to drill well to test Gallup formation. Completion will be determined from open hole logs. Copies of all logs will be sent to your office. Our proposed development plan is attached. Designation of sub-operator will be assigned to Minerals Management Inc. from T. Keith Marks, lessee.

IN ABOVE SPACE DESCRIBE PROPOSED PROGRAM: If proposal is to deepen or plug back, give data on present productive zone and proposed new productive zone. If proposal is to drill or deepen directionally, give pertinent data on subsurface locations and measured and true vertical depths. Give blowout preventer program, if any.

24. SIGNED J. Arnold Snell Area Manager  
TITLE Minerals Management Inc. DATE 12-31-1974  
(This space for Federal or State office use)

PERMIT NO. \_\_\_\_\_ APPROVAL DATE \_\_\_\_\_  
APPROVED BY SM TITLE \_\_\_\_\_  
CONDITIONS OF APPROVAL, IF ANY: \_\_\_\_\_

NEW MEXICO OIL CONSERVATION COMMISSION  
WELL LOCATION AND ACREAGE DEDICATION PLAT

Form C-102  
Supersedes C-128  
Effective 1-1-65

All distances must be from the outer boundaries of the Section.

Operator <b>MMI, Clinton Oil, Dow &amp; Marks</b>			Lease <b>Federal Ute 25</b>		Well No. <b>1-23</b>
Unit Letter <b>N</b>	Section <b>25</b>	Township <b>31N</b>	Range <b>15W</b>	County <b>San Juan</b>	
Actual Footage Location of Well:					
990 feet from the <b>South</b> line and		2100 feet from the <b>West</b> line			
Ground Level Elev. <b>5154</b>	Producing Formation <b>Gallup</b>	Pool <b>Verde Gallup</b>	Dedicated Acreage: <b>40</b> Acres		

1. Outline the acreage dedicated to the subject well by colored pencil or hachure marks on the plat below.
2. If more than one lease is dedicated to the well, outline each and identify the ownership thereof (both as to working interest and royalty).
3. If more than one lease of different ownership is dedicated to the well, have the interests of all owners been consolidated by communitization, unitization, force-pooling, etc?

☐ Yes ☐ No If answer is "yes," type of consolidation \_\_\_\_\_

If answer is "no," list the owners and tract descriptions which have actually been consolidated. (Use reverse side of this form if necessary.) \_\_\_\_\_

No allowable will be assigned to the well until all interests have been consolidated (by communitization, unitization, forced-pooling, or otherwise) or until a non-standard unit, eliminating such interests, has been approved by the Commission.

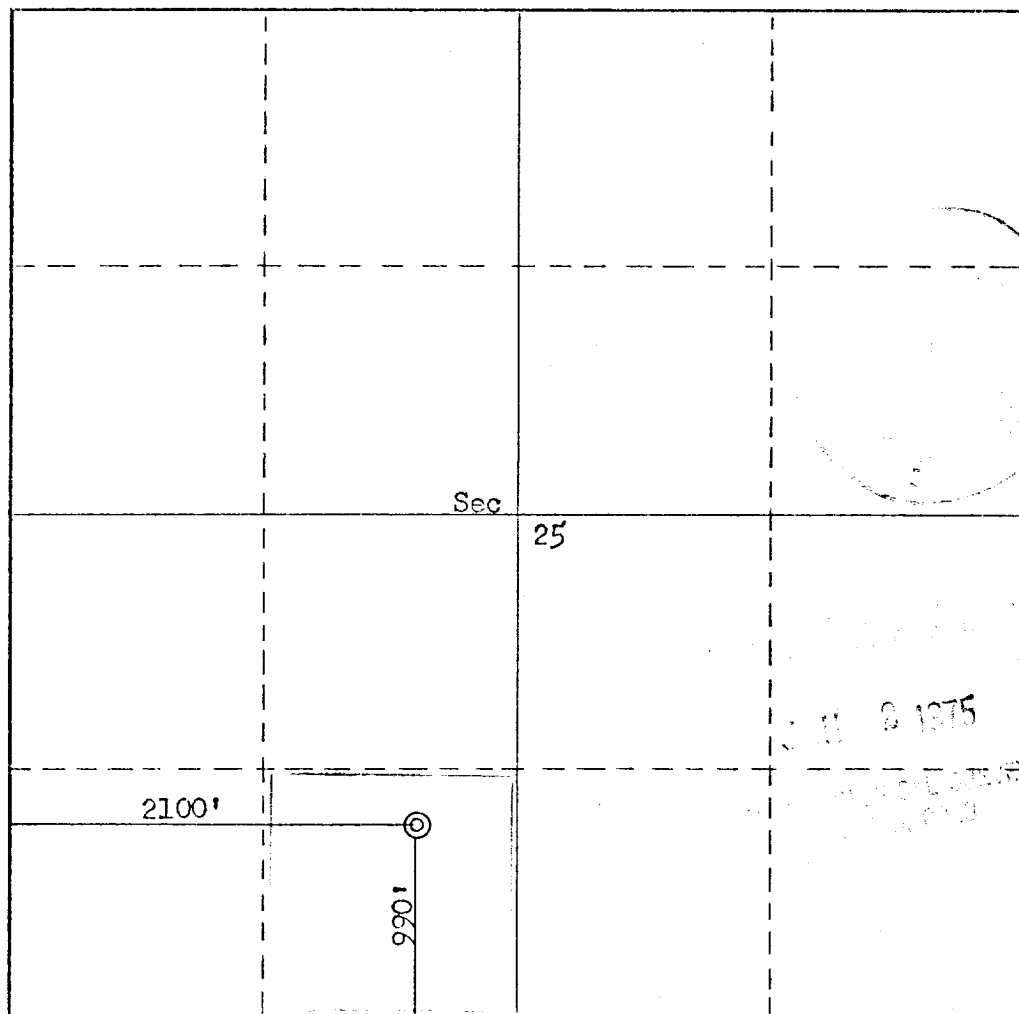

**CERTIFICATION**

I hereby certify that the information contained herein is true and complete to the best of my knowledge and belief.

*J. Arnold Snell*

Name

Area Manager

Position

Minerals Management Inc.

Company

December 31, 1974

Date

I hereby certify that the well location shown on this plat was plotted from field notes of actual surveys made by me or under my supervision, and that the same is true and correct to the best of my knowledge and belief.

Date Surveyed

December 26, 1974

Registered Professional Engineer and/or Land Surveyor.

*Fred B. Kerr Jr.*

Fred B. Kerr Jr.

Certificate No.

3950