

| | |
|------------------------|---|
| NO. OF COPIES RECEIVED | 6 |
| DISTRIBUTION | |
| SANTA FE | 1 |
| FILE | 1 |
| U.S.G.S. | 2 |
| LAND OFFICE | 1 |
| OPERATOR | 1 |

NEW MEXICO OIL CONSERVATION COMMISSION

30-045-21672

Form C-101
Revised 1-4-65

| | |
|--------------------------------|---|
| 5A. Indicate Type of Lease | |
| STATE <input type="checkbox"/> | FEE <input checked="" type="checkbox"/> |
| 5. State Oil & Gas Lease No. | |

APPLICATION FOR PERMIT TO DRILL, DEEPEN, OR PLUG BACK

| | | | |
|---|--|---|--|
| 1a. Type of Work | | 7. Unit Agreement Name | |
| b. Type of Well OIL WELL <input type="checkbox"/> GAS WELL <input checked="" type="checkbox"/> OTHER <input type="checkbox"/> | | 8. Farm or Lease Name Randlemon | |
| 2. Name of Operator El Paso Natural Gas Company | | 9. Well No. 2 | |
| 3. Address of Operator P. O. Box 990, Farmington, New Mexico 87401 | | 10. Field and Pool, or Wildcat EXT. Blanco Pictured Cliffs | |
| 4. Location of Well UNIT LETTER B LOCATED 865 FEET FROM THE North LINE AND 1830 FEET FROM THE East LINE OF SEC. 26 TWP. 31 RGE. 11 NMPM | | 12. County San Juan | |
| 19. Proposed Depth 2550' | | 19A. Formation Pictured Cliffs | |
| 21. Elevations (Show whether DI, RI, etc.) 5713' GR | | 22. Approx. Date Work will start | |
| 21A. Kind & Status Plug. Bond Statewide | | 23. Rotary or C.T. Rotary | |

PROPOSED CASING AND CEMENT PROGRAM

| SIZE OF HOLE | SIZE OF CASING | WEIGHT PER FOOT | SETTING DEPTH | SACKS OF CEMENT | EST. TOP |
|--------------|----------------|-----------------|---------------|-----------------|------------------|
| 12-1/4 | 8-5/8 | 24# | 120' | 106 cu. ft. | Surface |
| 6-3/4 | 2-7/8 | 6.4# | 2550' | 544 cu. ft. | Top of Ojo Alamo |

Selectively Perforate and Sand Water Fracture the Pictured Cliffs Formation.

A 3000 psi W.P. and 6000 psi test double gate preventor equipped with blind and pipe rams will be used for blow out prevention on this well.

The NE/4 of Section 26 is dedicated to this well.



APPROVAL VALID
FOR 90 DAYS UNLESS
DRILLING COMMENCED,

EXPIRES 4-17-75

IN ABOVE SPACE DESCRIBE PROPOSED PROGRAM; IF PROPOSAL IS TO DEEPEN OR PLUG BACK, GIVE DATA ON PRESENT PRODUCTIVE ZONE AND PROPOSED NEW PRODUCTIVE ZONE. GIVE BLOWOUT PREVENTER PROGRAM, IF ANY.

I hereby certify that the information above is true and complete to the best of my knowledge and belief.

Signed A. G. Dumas Title Drilling Clerk Date January 17, 1975

(This space for State Use)

APPROVED BY AR Hendrick TITLE PETROLEUM ENGINEER DIST. NO. 3 DATE JAN 17 1974

CONDITIONS OF APPROVAL, IF ANY:

**NEW MEXICO OIL CONSERVATION COMMISSION
WELL LOCATION AND ACREAGE DEDICATION PLAT**

Form C-102
Supersedes C-128
Effective 1-1-65

All distances must be from the outer boundaries of the Section.

| | | | | | |
|---|---|------------------------|--|--|----------------------|
| Operator El Paso Natural Gas Company | | | Lease Randlemon (Fee) | | Well No. 2 |
| Unit Letter B | Section 26 | Township 31N | Range 11W | County San Juan | |
| Actual Footage Location of Well: 865 feet from the North line and 1830 feet from the East line | | | | | |
| Ground Level Elev. 5713 | Producing Formation Pictured Cliffs | | Pool Blanco Pictured Cliffs Ext. | Dedicated Acreage: 160.00 Acres | |

1. Outline the acreage dedicated to the subject well by colored pencil or hachure marks on the plat below.
2. If more than one lease is dedicated to the well, outline each and identify the ownership thereof (both as to working interest and royalty).
3. If more than one lease of different ownership is dedicated to the well, have the interests of all leases been consolidated by communitization, unitization, force-pooling, etc?

☒ Yes ☐ No If answer is "yes," type of consolidation **Communitization**

If answer is "no," list the owners and tract descriptions which have actually been consolidated. Use reverse side of this form if necessary.) _____

No allowable will be assigned to the well until all interests have been consolidated (by communitization, unitization, forced-pooling, or otherwise) or until a non-standard unit, eliminating such interests, has been approved by the Commission.

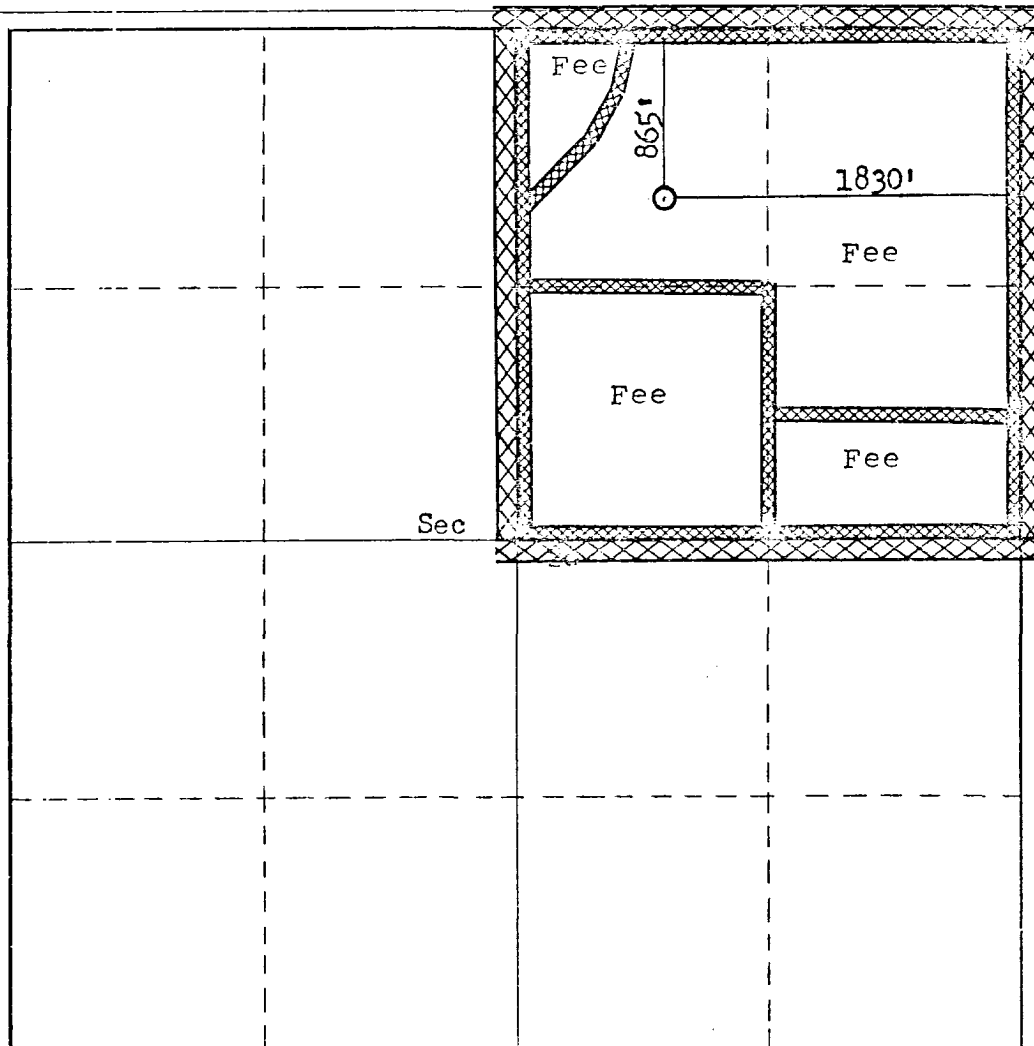
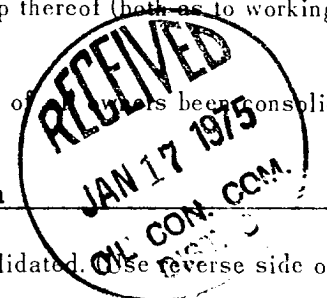

CERTIFICATION

I hereby certify that the information contained herein is true and complete to the best of my knowledge and belief.

Original Signed by

D. G. Brisco

Name

Drilling Clerk

Position

El Paso Natural Gas Company

Company

January 17, 1975

Date

I hereby certify that the well location shown on this plat was plotted from field notes of actual surveys made by me or under my supervision, and that the same is true and correct to the best of my knowledge and belief.

Date Surveyed

February 15, 1975

Registered Professional Engineer and/or Land Surveyor

Fred B. Kerr Jr.
Fred B. Kerr Jr.

Certificate No.

3950

0 330 660 990 1320 1650 1980 2310 2640 2970 3300 3630 3960 4290 4620 4950 5280 5610 5940 6270 6600