

UNITED STATES
DEPARTMENT OF THE INTERIOR
GEOLOGICAL SURVEY

30-045-21680

APPLICATION FOR PERMIT TO DRILL, DEEPEN, OR PLUG BACK

1a. TYPE OF WORK DRILL <input checked="" type="checkbox"/> DEEPEN <input type="checkbox"/> PLUG BACK <input type="checkbox"/>			5. LEASE DESIGNATION AND SERIAL NO. M00-C-1420-1716	
b. TYPE OF WELL OIL WELL <input checked="" type="checkbox"/> GAS WELL <input type="checkbox"/> OTHER <input type="checkbox"/> SINGLE ZONE <input type="checkbox"/> MULTIPLE ZONE <input type="checkbox"/>			6. IF INDIAN, ALLOTTEE OR TRIBE NAME Ute Mountain Tribe	
2. NAME OF OPERATOR R. L. Burns Corp.			7. UNIT AGREEMENT NAME ---	
3. ADDRESS OF OPERATOR 3313 Republic Bank Tower - Dallas, Texas 75201			8. FARM OR LEASE NAME Ute Mountain Tribe	
4. LOCATION OF WELL (Report location clearly and in accordance with any State requirements.)* At surface 920' FWL and 2010' FSL Sec. 18, T 31N, R 14W At proposed prod. zone Straight Hole			9. WELL NO. 18-1 Ute	
14. DISTANCE IN MILES AND DIRECTION FROM NEAREST TOWN OR POST OFFICE* Approx. 18 miles NW of Farmington, New Mexico			10. FIELD AND POOL, OR WILDCAT Verde-Gallup	
16. DISTANCE FROM PROPOSED* LOCATION TO NEAREST PROPERTY OR LEASE LINE, FT. (Also to nearest drlg. unit line, if any) 920' NWL		16. NO. OF ACRES IN LEASE 640	17. NO. OF ACRES ASSIGNED TO THIS WELL 40	
18. DISTANCE FROM PROPOSED LOCATION* TO NEAREST WELL, DRILLING, COMPLETED, OR APPLIED FOR, ON THIS LEASE, FT. None		19. PROPOSED DEPTH 2,500'	20. ROTARY OR CABLE TOOLS Rotary	
21. ELEVATIONS (Show whether DF, RT, GR, etc.) 5784' Gr			22. APPROX. DATE WORK WILL START* Jan. 15, 1975	

23. PROPOSED CASING AND CEMENTING PROGRAM				
SIZE OF HOLE	SIZE OF CASING	WEIGHT PER FOOT	SETTING DEPTH	QUANTITY OF CEMENT
9-3/4	8-5/8	32#	150'	Circulate to surface
7-7/8	5-1/2	17#	2500'	1000' Fillup behind pipe

Propose to drill new hole to the base of Verde-Gallup zone at approximately 2500 ft. This is a straight hole. 8" Shaffer LWP double hydraulic blowout preventer to be used during drilling.

IN ABOVE SPACE DESCRIBE PROPOSED PROGRAM: If proposal is to deepen or plug back, give data on present productive zone and proposed new productive zone. If proposal is to drill or deepen directionally, give pertinent data on subsurface locations and measured and true vertical depths. Give blowout preventer program, if any.

24. SIGNED John D. Dutton TITLE Petroleum Engineer DATE Jan. 6, 1974
(This space for Federal or State office use)

PERMIT NO. _____ APPROVAL DATE _____

APPROVED BY _____ TITLE _____ DATE _____
CONDITIONS OF APPROVAL, IF ANY:

N 1EX120 OIL CONSERVATION COMMISS
WELL LOCATION AND ACREAGE DEDICATION PLAT

Form C-102
Supersedes C-128
Effective 1-1-65

All distances must be from the outer boundaries of the Section.

Operator R. L. Burns Corporation			Lease Ute Mountain Tribe Ute 18		Well No. 18-1 Ute 1
Unit Letter L	Section 18	Township 31N	Range 11W	County San Juan	
Actual Footage Location of Well:					
2010 feet from the South line and		920 feet from the West line			
Ground Level Elev. 5784	Producing Formation Verde-Gallup	Pool Verde Gallup	Dedicated Acreage: 40 Acres		

1. Outline the acreage dedicated to the subject well by colored pencil or hachure marks on the plat below.
2. If more than one lease is dedicated to the well, outline each and identify the ownership thereof (both as to working interest and royalty).
3. If more than one lease of different ownership is dedicated to the well, have the interests of all owners been consolidated by communitization, unitization, force-pooling, etc?

☐ Yes ☐ No If answer is "yes," type of consolidation _____

If answer is "no," list the owners and tract descriptions which have actually been consolidated. (Use reverse side of this form if necessary.) _____

No allowable will be assigned to the well until all interests have been consolidated (by communitization, unitization, forced-pooling, or otherwise) or until a non-standard unit, eliminating such interests, has been approved by the Commission.

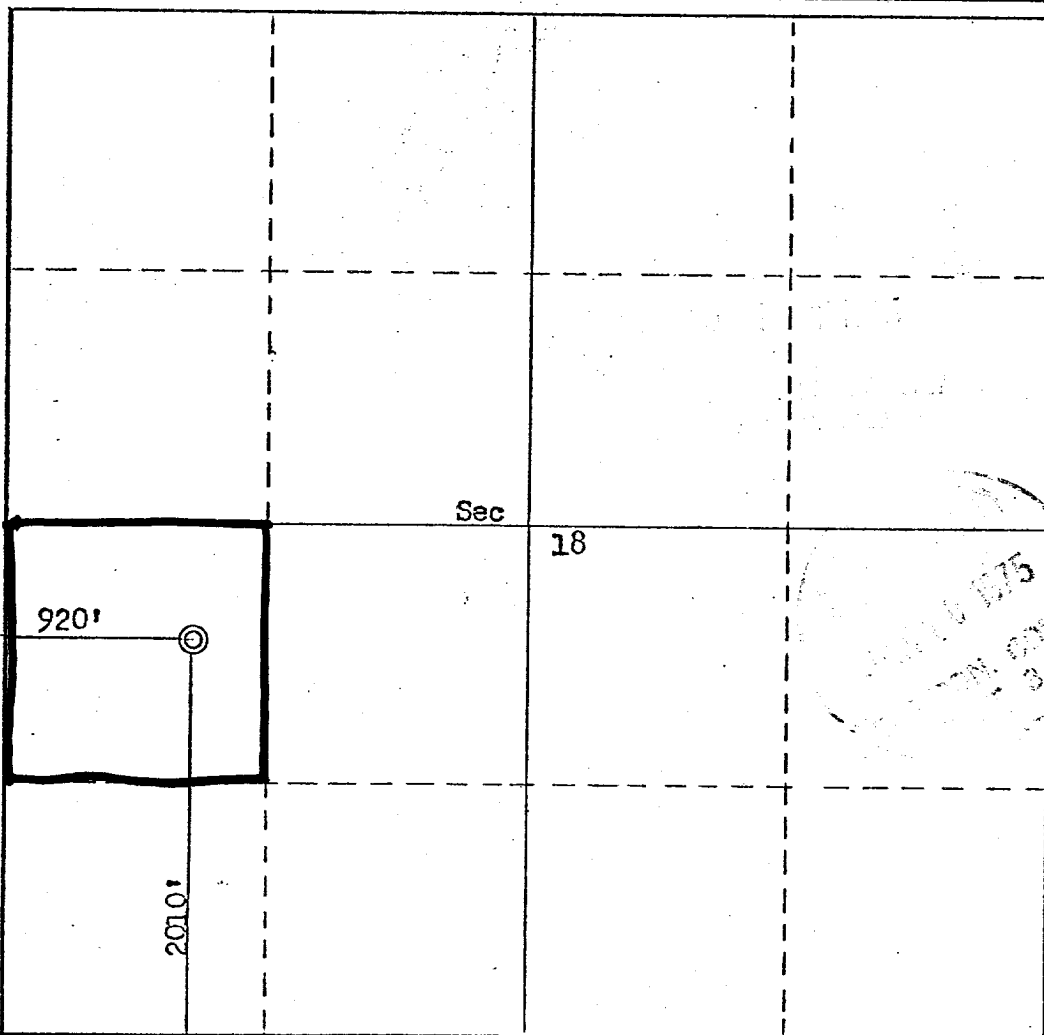

CERTIFICATION

I hereby certify that the information contained herein is true and complete to the best of my knowledge and belief.

Name *John R. Dutton*

Position
Petroleum Engineer

Company
R. L. Burns Corp.

Date
January 6, 1974

I hereby certify that the well location shown on this plat was plotted from field notes of actual surveys made by me or under my supervision, and that the same is true and correct to the best of my knowledge and belief.

Date Surveyed
January 3, 1975

Registered Professional Engineer and/or Land Surveyor

Fred B. Kerr Jr.
Fred B. Kerr Jr.

Certificate No.
3950