

NO. OF COPIES RECEIVED	6
DISTRIBUTION	
SANITARY	1
FILE	1
U.S.G.S.	2
LAND OFFICE	1
OPERATOR	1

# NEW MEXICO OIL CONSERVATION COMMISSION

30-045-21703

Form C-101  
Revised 1-1-65

5A. Indicate Type of Lease	
STATE <input checked="" type="checkbox"/>	FEE <input type="checkbox"/>
5. State Oil & Gas Lease No. B-1124 E-5317; E-284-10; E-3555-2; B-10938-31; 36	

## APPLICATION FOR PERMIT TO DRILL, DEEPEN, OR PLUG BACK

1a. Type of Work		7. Unit Agreement Name	
b. Type of Well OIL WELL <input type="checkbox"/> GAS WELL <input checked="" type="checkbox"/> OTHER <input type="checkbox"/>		8. Farm or Lease Name State Com I	
2. Name of Operator Mesa Petroleum Co.		9. Well No. #5A	
3. Address of Operator P. O. Box 2009 Amarillo, Texas 79105		10. Field and Pool, or Wildcat Blanco (Mesaverde)	
4. Location of Well UNIT LETTER F LOCATED 1850 FEET FROM THE North LINE AND 1850 FEET FROM THE West LINE OF SEC. 36 TWP. 31N RGE. 9W NMPL		17. County San Juan	
19. Proposed Depth 5500'		19A. Formation Mesaverde	
21. Elevations (Show whether DL, KI, etc.)		20. Rotary or C.T. Rotary	
21A. Kind & Status Plug. Bond Blanket		22. Approx. Date Work will start As Rig Availability	
21B. Drilling Contractor unknown		Dicates	

23.

## PROPOSED CASING AND CEMENT PROGRAM

SIZE OF HOLE	SIZE OF CASING	WEIGHT PER FOOT	SETTING DEPTH	SACKS OF CEMENT	EST. TOP
13 3/4"	10 3/4"	32.75#	150'	Sufficient to	circ. to surface
8 3/4"	7"	23#	3100'	Sufficient to	cover OJO Alamo
6 1/8"	4 1/2"	10.5#	2900-5500'	Sufficient to	tie back into 7" csg.

Mesa proposes to drill a Mesaverde infill well at the above location to an approximate depth of 5000'. Electric Logs will be run from surface casing to 7" casing point and from bottom of 7" casing to T.D. Production liner will be set through the pay zone and perforated.

BOP Program: Install 10", series 900 double gate preventer on 10 3/4" casing. B.O.P. will be tested to 500 psi prior to drilling out cement in surface casing and 1000 psi prior to drilling out cement in intermediate casing.

All work will be conducted in accordance with rules and regulations of the State of New Mexico.

APPROVAL VALID FOR 90 DAYS UNLESS DRILLING COMMENCED,

EXPIRES 5-15-75

FEB 14 1975

IN ABOVE SPACE DESCRIBE PROPOSED PROGRAM; IF PROPOSAL IS TO DEEPEN OR PLUG BACK, GIVE DATA ON PRESENT PRODUCTIVE ZONE AND PROPOSED NEW PRODUCTIVE ZONE. GIVE BLOWOUT PREVENTER PROGRAM, IF ANY.

I hereby certify that the information above is true and complete to the best of my knowledge and belief.

Signed J. Flaker Title Prod. Engr. Date 2/12/75

(This space for State Use)

PETROLEUM ENGINEER DIST. NO. 3

FEB 14 1974

APPROVED BY AK Kendrick TITLE PROD. ENGR. DATE 2/12/75

CONDITIONS OF APPROVAL, IF ANY: XC 7-Stop 1-Area 1-Div. 1-Eng.

**NEW MEXICO OIL CONSERVATION COMMISSION  
WELL LOCATION AND ACREAGE DEDICATION PLAT**

Form C-102  
Supersedes C-128  
Effective 1-1-65

All distances must be from the outer boundaries of the Section.

Operator <b>Mesa Petroleum Company</b>			Lease <b>State Com I</b>		Well No. <b>5A</b>
Unit Letter <b>F</b>	Section <b>36</b>	Township <b>31 North</b>	Range <b>9 West</b>	County <b>San Juan</b>	
Actual Footage Location of Well: <b>1850</b> feet from the <b>North</b> line and <b>1850</b> feet from the <b>West</b> line					
Ground Level Elev. <b>5969</b>	Producing Formation <b>Mesaverde</b>	Pool <b>Blanco</b>		Dedicated Acreage: <b>320</b> Acres <input checked="" type="checkbox"/>	

1. Outline the acreage dedicated to the subject well by colored pencil or hachure marks on the plat below.
2. If more than one lease is dedicated to the well, outline each and identify the ownership thereof (both as to working interest and royalty).
3. If more than one lease of different ownership is dedicated to the well, have the interests of all owners been consolidated by communitization, unitization, force-pooling, etc?

☐ Yes ☐ No If answer is "yes," type of consolidation \_\_\_\_\_

If answer is "no," list the owners and tract descriptions which have actually been consolidated. (Use reverse side of this form if necessary.) \_\_\_\_\_

No allowable will be assigned to the well until all interests have been consolidated (by communitization, unitization, forced-pooling, or otherwise) or until a non-standard unit, eliminating such interests, has been approved by the Commission.

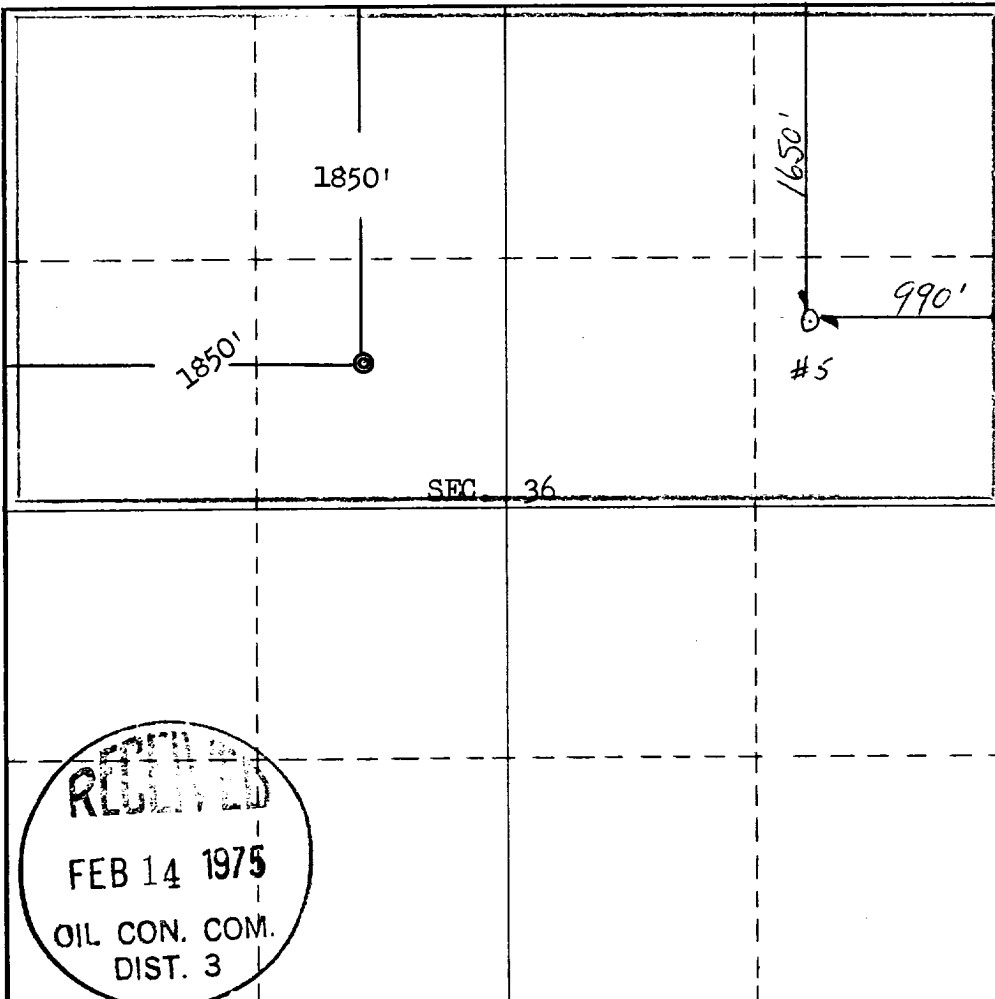

**CERTIFICATION**

I hereby certify that the information contained herein is true and complete to the best of my knowledge and belief.

*R. J. Flaker*

Name

**R. J. Flaker**

Position

**Production Engr.**

Company

**Mesa Petroleum Co.**

Date

**2/12/75**

I certify that the location shown on this plat was plotted from field notes of actual surveys made by me or under my supervision, and that the same are true and correct to the best of my knowledge and belief.

Date Surveyed

**January 29, 1975**

Registered Professional Engineer and/or Land Surveyor

*E. V. Echowhawk*

Certificate No. **3602**

**E. V. Echowhawk LS**

**RECEIVED  
FEB 14 1975  
OIL CON. COM.  
DIST. 3**

*XC 2/25 EPNG*