

30-045-21704

NO. OF COPIES RECEIVED	6
DISTRIBUTION	
SANTA FE	1
FILE	1
U.S.G.S.	2
LAND OFFICE	1
OPERATOR	1

NEW MEXICO OIL CONSERVATION COMMISSION

Form C-101
Revised 1-1-65

APPROVAL VALID
FOR 90 DAYS UNLESS
DRILLING COMMENCED,

EXPIRES 5-15-75

5A. Indicate Type of Lease

STATE ☐ REC ☒

5. State Oil & Gas Lease No.

APPLICATION FOR PERMIT TO DRILL, DEEPEN, OR PLUG BACK

1a. Type of Work				7. Unit Agreement Name	
b. Type of Well DRILL <input checked="" type="checkbox"/> DEEPEN <input type="checkbox"/> PLUG BACK <input type="checkbox"/> OIL WELL <input type="checkbox"/> GAS WELL <input checked="" type="checkbox"/> OTHER <input type="checkbox"/> SINGLE ZONE <input checked="" type="checkbox"/> MULTIPLE ZONE <input type="checkbox"/>				8. Farm or Lease Name Suter Federal	
2. Name of Operator Mesa Petroleum Co.				9. Well No. 3A	
3. Address of Operator P. O. Box 2009 Amarillo, Texas 79105				10. Field and Pool, or Wildcat Blanco (Mesaverde)	
4. Location of Well UNIT LETTER 0 LOCATED 990' FEET FROM THE South LINE AND 1850' FEET FROM THE East LINE OF SEC. 14 TWP. 32N RGE. 11W NMPM				12. County San Juan	
21. Elevations (Show whether D.F., K.I., etc.) 6261' GR		21A. Kind & Status Plug. Bond Blanket		21B. Drilling Contractor unknown	
21C. Proposed Depth 5600'		21D. Formation Mesaverde		21E. Rotary or C.T. Rotary	
22. Approx. Date Work will start As Rig Availability				23. Dicates	

PROPOSED CASING AND CEMENT PROGRAM

SIZE OF HOLE	SIZE OF CASING	WEIGHT PER FOOT	SETTING DEPTH	SACKS OF CEMENT	EST. TOP
13 3/4"	10 3/4"	32.75#	150'	Sufficient to	circ. to surface
8 3/4"	7"	23.0	3400'	Sufficient to	cover OJO Alamo
6 1/8"	4 1/2"	10.5#	3200-5600	Sufficient to	tie back into 7" csg.

Mesa proposes to drill a Mesaverde infill well at the above location to an approximate depth of 5600'. Electric Logs will be run from surface casing to 7" casing point and from bottom of 7" casing to T.D. Production liner will be set through the pay zone and perforated.

BOP Program: Install 10", Series 900 double gate preventer on 10 3/4" casing. B.O.P. will be tested to 500 psi prior to drilling out cement in surface casing and 1000 psi prior to drilling out cement in intermediate casing.

All work will be conducted in accordance with rules and regulations of the State of New Mexico.

IN ABOVE SPACE DESCRIBE PROPOSED PROGRAM: IF PROPOSAL IS TO DEEPEN OR PLUG BACK, GIVE DATA ON PRESENT PRODUCTION ZONE AND PROPOSED NEW PRODUCTION ZONE. GIVE BLOWOUT PREVENTER PROGRAM, IF ANY.

I hereby certify that the information above is true and complete to the best of my knowledge and belief.

Signed R. J. Flaker Title Prod. Engr. Date 2/11/75

(This space for State Use)

PETROLEUM ENGINEER DIST. NO. 3

FEB 14 1974

APPROVED BY R. J. Flaker TITLE Prod. Engr. DATE 2/11/75
CONDITIONS OF APPROVAL: 1-Blow mfg.

NEW MEXICO OIL CONSERVATION COMMISSION
WELL LOCATION AND ACREAGE DEDICATION PLAT

Form C-102
Supersedes C-128
Effective 1-1-65

All distances must be from the outer boundaries of the Section.

Operator Mesa Petroleum Co.			Lease Suter Federal		Well No. 3A
Unit Letter 0	Section 14	Township 32 North	Range 11 West	County San Juan	
Actual Footage Location of Well: 990 feet from the South line and 1850 feet from the East line					
Ground Level Elev. 6261	Producing Formation Mesaverde		Pool Blanco	Dedicated Acreage: 320 Acres	

1. Outline the acreage dedicated to the subject well by colored pencil or hatchure marks on the plat below.
2. If more than one lease is dedicated to the well, outline each and identify the ownership thereof (both as to working interest and royalty).
3. If more than one lease of different ownership is dedicated to the well, have the interests of all owners been consolidated by communitization, unitization, force-pooling, etc?

☐ Yes ☐ No If answer is "yes," type of consolidation _____

If answer is "no," list the owners and tract descriptions which have actually been consolidated. (Use reverse side of this form if necessary.) _____

No allowable will be assigned to the well until all interests have been consolidated (by communitization, unitization, forced-pooling, or otherwise) or until a non-standard unit, eliminating such interests, has been approved by the Commission.

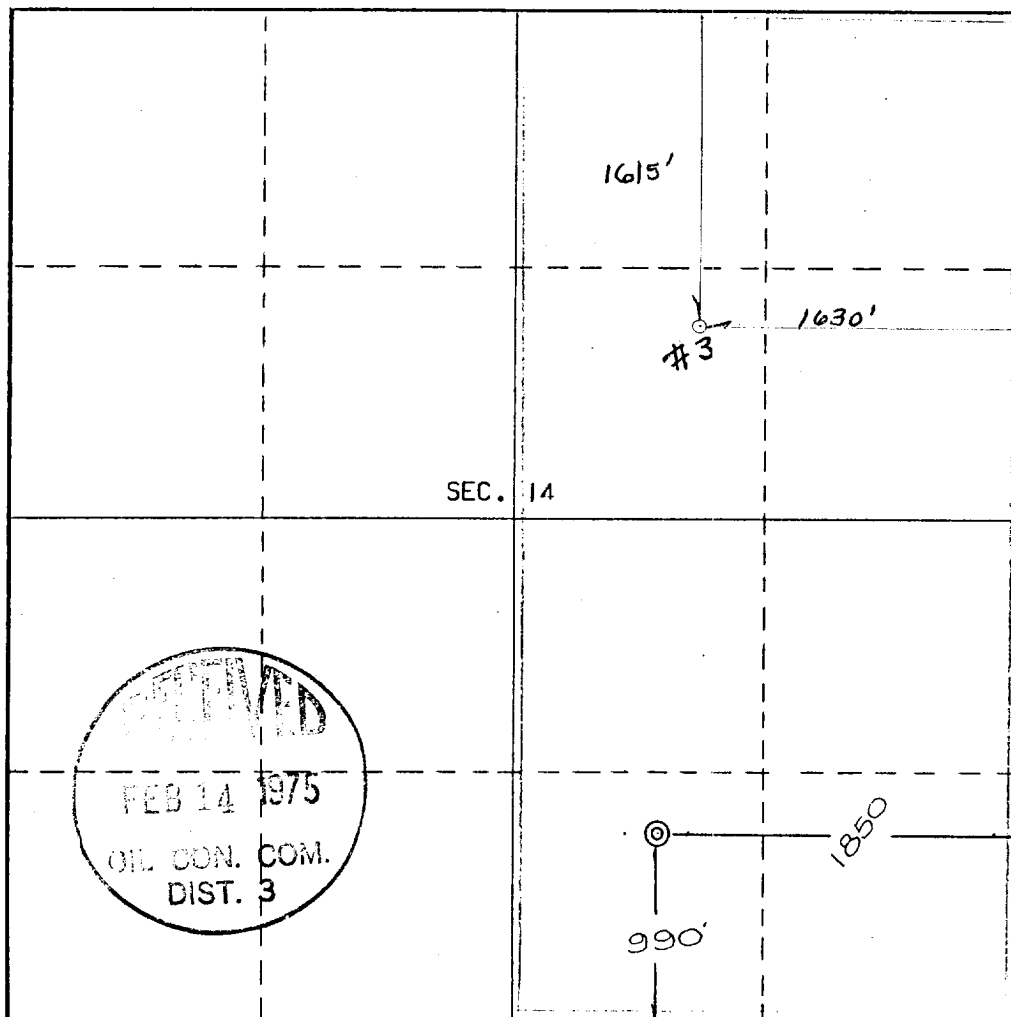

CERTIFICATION

I hereby certify that the information contained herein is true and complete to the best of my knowledge and belief.

J. L. Archer

Name
J. L. Archer

Position
Drilling Foreman

Company
Mesa Petroleum Co.

Date
2/10/75

REGISTERED LAND SURVEYOR
STATE OF NEW MEXICO
I hereby certify that the well location shown on this plat was plotted from field notes of Reg. No. 3602 made by me or under my supervision, and they be same as true and correct to the best of my knowledge and belief.
E.V. ECHOHAWK

Date Surveyed
January 14, 1975

Registered Professional Engineer and/or Land Surveyor

E.V. Echohawk

Certificate No. **3602**
E.V. Echohawk LS

XC. EPNS 1/6/75