

# AZTEC OIL & GAS COMPANY

P. O. DRAWER 570  
FARMINGTON, NEW MEXICO 87401

May 1, 1975

New Mexico Oil Conservation Commission  
1000 Rio Brazos Road  
Aztec, New Mexico

RE: Blowout Preventer plan

Dear Sir:

All drilling and completion wells will be equipped with 8" Shaffer LWP double hydraulic blowout preventers and a 2000 "C" Payne Hydraulic closing unit with steel lines.

The preventer is 3000# working pressure and 6000# test.

All crews will be thoroughly trained in the operation of this preventer. The preventer will be tested at the beginning of every tower change to insure proper operation.



Joe C. Salmon  
District Superintendent

JCS/dg

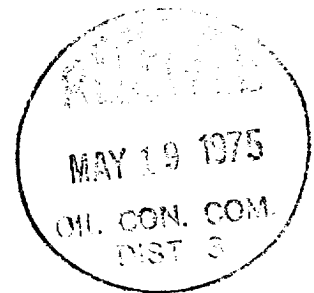

30-045-21814

Form C-101  
Revised 1-1-65

NEW MEXICO OIL CONSERVATION COMMISSION

NO. OF COPIES RECEIVED	7
DISTRIBUTION	
SANTA FE	1
FILE	1
U.S.G.S.	2
LAND OFFICE	1
OPERATOR	2

5A. Indicate Type of Lease  
STATE ☐ FEE ☒  
S. State Oil & Gas Lease No.

APPLICATION FOR PERMIT TO DRILL, DEEPEN, OR PLUG BACK

1a. Type of Work b. Type of Well OIL WELL <input type="checkbox"/> GAS WELL <input checked="" type="checkbox"/> OTHER <input type="checkbox"/>		DRILL <input checked="" type="checkbox"/> DEEPEN <input type="checkbox"/> PLUG BACK <input type="checkbox"/>		7. Unit Agreement Name	
2. Name of Operator Aztec Oil & Gas Company		SINGLE ZONE <input type="checkbox"/> MULTIPLE ZONE <input checked="" type="checkbox"/>		8. Farm or Lease Name Johns	
3. Address of Operator P. O. Drawer 570, Farmington, New Mexico		9. Well No. #1-A		10. Field and Pool, or Wildcat Blanco Mesaverde Pictured Cliffs	
4. Location of Well UNIT LETTER D LOCATED 810 FEET FROM THE North LINE AND 1130 FEET FROM THE West LINE OF SEC. 19 TWP. 32N RGE. 11W NMPM		12. County San Juan			
19. Proposed Depth 5550		19A. Formation Mesaverde-PC		20. Rotary or C.T. Rotary	
21. Elevations (Show whether DF, RT, etc.) 6534' GR		21A. Kind & Status Plug. Bond		21B. Drilling Contractor	
				22. Approx. Date Work will start	

PROPOSED CASING AND CEMENT PROGRAM

SIZE OF HOLE	SIZE OF CASING	WEIGHT PER FOOT	SETTING DEPTH	SACKS OF CEMENT	EST. TOP
15"	9-5/8"	32.30	300	300 sxs	
8-3/4"	7"	23#	5100	200 sxs	
6-3/4"	4-1/2"	10.50#	5000 - 5500	150 sxs	
	1-1/2"	2.90#	5550		
	1-1/4"	2.40#	3250		

PROPOSE TO:

Drill 15" hole.  
Set 300' of 9-5/8" casing. Cement with 300 sxs.  
Drill 8-3/4" hole to approximately 5100'.  
Run 7" casing.  
Cement both stages with 200 sxs. DV tool set below Pictured Cliffs.  
Gas drill 6-3/4" hole to approximately 5500'.  
Run 4-1/2" liner from 5000 to 5500'. Cement with 150 sxs.  
Perforate Mesaverde and Pictured Cliffs formations.  
Sand/water frac Mesaverde and Pictured Cliffs with 60,000 gallons water and 60,000# sand each.  
Run Baker Model D Packer above Mesaverde perforations.  
Run 1-1/2" to Mesaverde. Run 1-1/4" opposite Pictured Cliffs.  
Install well head.

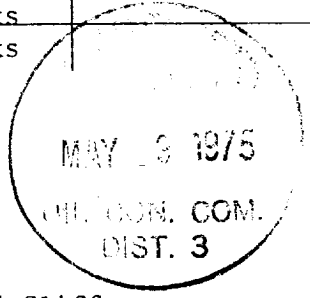

IN ABOVE SPACE DESCRIBE PROPOSED PROGRAM: IF PROPOSAL IS TO DEEPEN OR PLUG BACK, GIVE DATA ON PRESENT PRODUCTION AND PROPOSED NEW PRODUCTION. IF BLOWOUT PREVENTER PROGRAM, IF ANY.

I hereby certify that the information above is true and complete to the best of my knowledge and belief.  
Signed Jac C. Salmon Title District Superintendent Date May 1, 1975

(This space for State Use)

APPROVED BY Emmy C. ... TITLE SUPERVISOR DIST. #3 DATE MAY 19 1975  
CONDITIONS OF APPROVAL IF ANY:

*Handwritten notes:*  
Hold 40,000 gal water  
10/1/75

**NEW MEXICO OIL CONSERVATION COMMISSION  
WELL LOCATION AND ACREAGE DEDICATION PLAT**

Form C-102  
Supersedes C-128  
Effective 1-1-65

All distances must be from the outer boundaries of the Section.

Operator <b>Aztec Oil &amp; Gas Company</b>			Lease <b>Johns</b>		Well No. <b>1A</b>
Unit Letter <b>D</b>	Section <b>19</b>	Township <b>32N</b>	Range <b>11W</b>	County <b>San Juan</b>	
Actual Footage Location of Well: <b>810</b> feet from the <b>North</b> line and <b>1130</b> feet from the <b>West</b> line					
Ground Level Elev. <b>6534</b>	Producing Formation <b>Mesa Verde</b>		Pool <b>Blanco</b>		Dedicated Acreage: <b>31.40</b> Acres

1. Outline the acreage dedicated to the subject well by colored pencil or hachure marks on the plat below.
2. If more than one lease is dedicated to the well, outline each and identify the ownership thereof (both as to working interest and royalty).
3. If more than one lease of different ownership is dedicated to the well, have the interests of all owners been consolidated by communitization, unitization, force-pooling, etc?

☐ Yes ☐ No If answer is "yes," type of consolidation \_\_\_\_\_

If answer is "no," list the owners and tract descriptions which have actually been consolidated (Use reverse side of this form if necessary.) \_\_\_\_\_

No allowable will be assigned to the well until all interests have been consolidated (by communitization, unitization, forced-pooling, or otherwise) or until a non-standard unit, eliminating such interests, has been approved by the Commission.

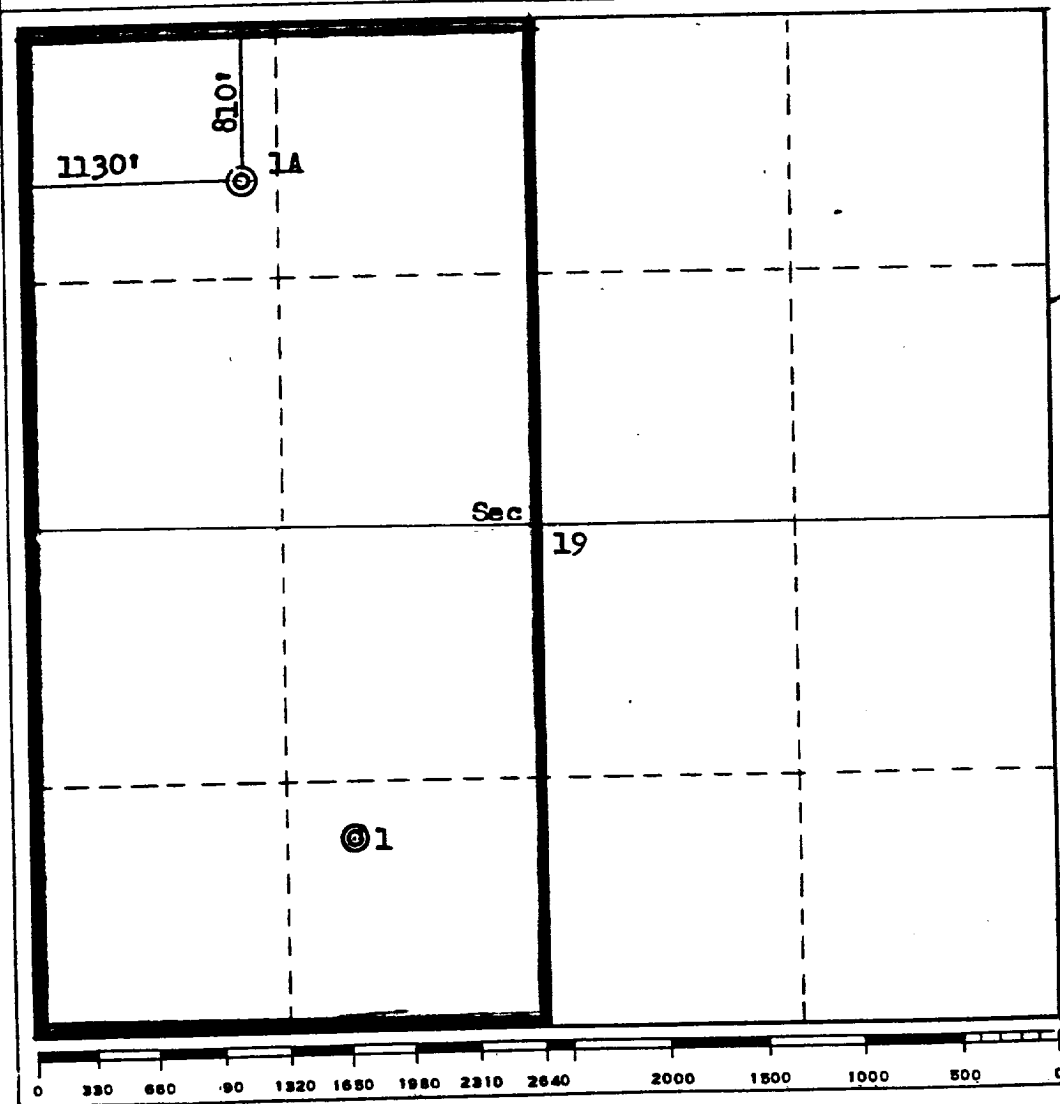
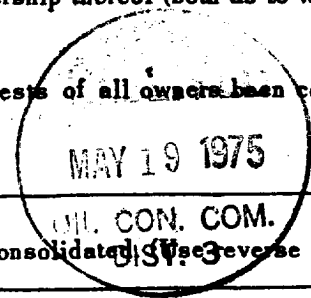

**CERTIFICATION**

I hereby certify that the information contained herein is true and complete to the best of my knowledge and belief.

Name \_\_\_\_\_  
*Joe C. Salmon*  
 Position  
**District Superintendent**  
 Company  
**Aztec Oil & Gas Company**  
 Date  
**May 1, 1975**

I hereby certify that the well location shown on this plat was plotted from field notes of actual surveys made by me or under my supervision, and that the same is true and correct to the best of my knowledge and belief.

Date Surveyed  
**April 24, 1975**  
 Registered Professional Engineer and/or Land Surveyor  
*Fred B. Kiser Jr.*  
 Certificate No.  
**3950**