

UNITED STATES
DEPARTMENT OF THE INTERIOR
GEOLOGICAL SURVEY

30-045-21821

APPLICATION FOR PERMIT TO DRILL, DEEPEN, OR PLUG BACK

1a. TYPE OF WORK DRILL <input checked="" type="checkbox"/> DEEPEN <input type="checkbox"/> PLUG BACK <input type="checkbox"/>		5. LEASE DESIGNATION AND SERIAL NO. SF 078604
b. TYPE OF WELL OIL WELL <input type="checkbox"/> GAS WELL <input checked="" type="checkbox"/> OTHER <input type="checkbox"/>		6. IF INDIAN, ALLOTTEE OR TRIBE NAME
2. NAME OF OPERATOR El Paso Natural Gas Company		7. UNIT AGREEMENT NAME
3. ADDRESS OF OPERATOR PO Box 990, Farmington, NM 87401		8. FARM OR LEASE NAME Scott
4. LOCATION OF WELL (Report location clearly and in accordance with any State requirements.)* At surface 800'S, 1000'W At proposed prod. zone		9. WELL NO. 10
14. DISTANCE IN MILES AND DIRECTION FROM NEAREST TOWN OR POST OFFICE*		10. FIELD AND POOL, OR WILDCAT Undesignated Pictured Cliffs
15. DISTANCE FROM PROPOSED* LOCATION TO NEAREST PROPERTY OR LEASE LINE, FT. (Also to nearest orig. unit line, if any)		11. SEC., T., R., M., OR BLK. AND SURVEY OR AREA Sec. 4, T-31-N, R-10-W
16. NO. OF ACRES IN LEASE		12. COUNTY OR PARISH San Juan
17. NO. OF ACRES ASSIGNED TO THIS WELL 158.64		13. STATE NM
18. DISTANCE FROM PROPOSED LOCATION* TO NEAREST WELL, DRILLING, COMPLETED, OR APPLIED FOR, ON THIS LEASE, FT.		14. ROTARY OR CABLE TOOLS Rotary
19. PROPOSED DEPTH 2965'		20. APPROX. DATE WORK WILL START*
21. ELEVATIONS (Show whether DF, RT, GR, etc.) 5961'GR		
23. PROPOSED CASING AND CEMENTING PROGRAM		

SIZE OF HOLE	SIZE OF CASING	WEIGHT PER FOOT	SETTING DEPTH	QUANTITY OF CEMENT
12 1/4"	8 5/8"	24.0#	120'	106 cu. ft. to circulate to surface
6 3/4"	2 7/8"	6.4#	2965'	558 cu. ft. to cover Ojo Alamo

Selectively perforate and sandwater fracture the Pictured Cliffs formation.

A 3000 psi WP and 6000 psi test double gate preventer equipped with blind and pipe rams will be used for blow out prevention on this well.

The SW/4 of Section 4 is dedicated to this well.

RECEIVED

JUN 2 1975

U. S. GEOLOGICAL SURVEY
FARMINGTON, N. M.

IN ABOVE SPACE DESCRIBE PROPOSED PROGRAM: If proposal is to deepen or plug back, give data on present productive zone and proposed new productive zone. If proposal is to drill or deepen directionally, give pertinent data on subsurface locations and measured and true vertical depths. Give blowout preventer program, if any.

24. SIGNED A. J. Jones TITLE Drilling Clerk DATE May 30, 1975
(This space for Federal or State office use)PERMIT NO. _____ APPROVAL DATE _____
APPROVED BY OK TITLE _____ DATE _____
CONDITIONS OF APPROVAL, IF ANY:

**NEW MEXICO OIL CONSERVATION COMMISSION
WELL LOCATION AND ACREAGE DEDICATION PLAT**

Form C-102
Supersedes C-128
Effective 1-1-65

All distances must be from the outer boundaries of the Section.

Operator EL PASO NATURAL GAS COMPANY		Lease SCOTT (SF-078604)		Well No. 10
Unit Letter M	Section 4	Township 31-N	Range 10-W	County SAN JUAN
Actual Footage Location of Well: 800 feet from the SOUTH line and 1000 feet from the WEST line 158.64				
Ground Level Elev. 5961	Producing Formation PICTURED CLIFFS	Pool UNDESIGNATED PICTURED CLIFFS	Dedicated Acreage: 160.00 Acres	

1. Outline the acreage dedicated to the subject well by colored pencil or hachure marks on the plat below.
2. If more than one lease is dedicated to the well, outline each and identify the ownership thereof (both as to working interest and royalty).
3. If more than one lease of different ownership is dedicated to the well, have the interests of all owners been consolidated by communitization, unitization, force-pooling, etc?

☒ Yes ☐ No If answer is "yes," type of consolidation **Communitization**

If answer is "no," list the owners and tract descriptions which have actually been consolidated. (Use reverse side of this form if necessary.) _____

No allowable will be assigned to the well until all interests have been consolidated (by communitization, unitization, forced-pooling, or otherwise) or until a non-standard unit, eliminating such interests, has been approved by the Commission.

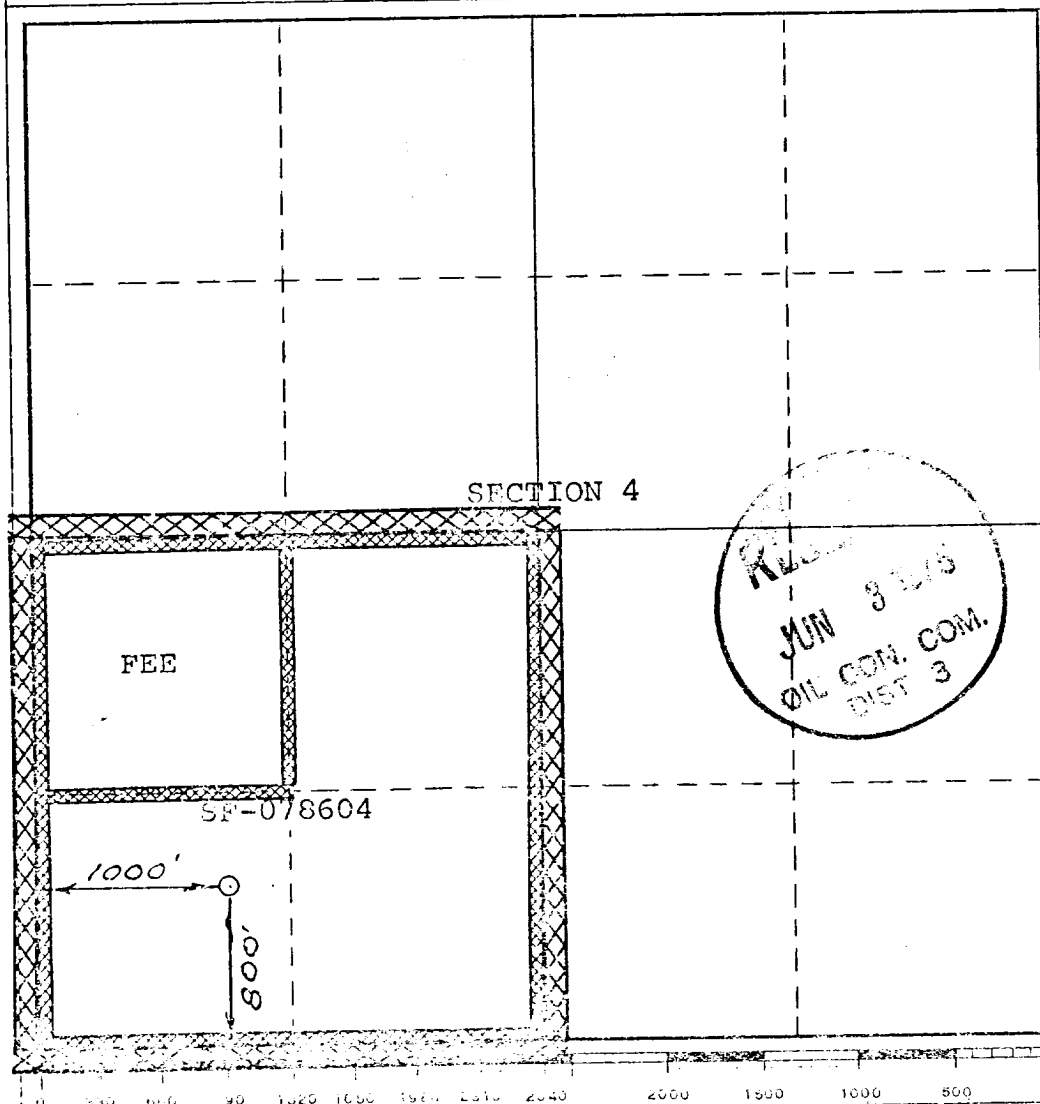

CERTIFICATION

I hereby certify that the information contained herein is true and complete to the best of my knowledge and belief.

Original Signed by
D. G. Brisco

Name _____
Drilling Clerk
 Position _____
El Paso Natural Gas Co.
 Company _____
May 30, 1975
 Date _____

I hereby certify that the well location shown on this plat was plotted from field notes of actual surveys made by me or under my supervision, and that the same is true and correct to the best of my knowledge and belief.

Date Surveyed
APRIL 8, 1974

Registered Professional Engineer
and/or Land Surveyor

[Signature]
 Certificate No. **1760**

El Paso Natural Gas Company

El Paso, Texas 79978

May 30, 1975

ADDRESS REPLY TO
POST OFFICE BOX 959
FARMINGTON NEW MEXICO 87401

Mr. P. T. McGrath
U. S. Geological Survey
Post Office Box 959
Farmington, New Mexico 87401

Re: Application for Permit to Drill
Scott #10
SWSW/4 Section 4, T-31-N, R-10-W
Undesignated Pictured Cliffs

Dear Mr. McGrath:

Details regarding existing roads, pipelines, wells, etc. relative to the above well location are included on the previously submitted base maps, "Field Road Map" and "Composite Map No. 1".

The proposed new well location, new roads and new pipeline are shown on the attached plat along with connecting existing roads and pipelines in the vicinity of the proposed new well.

Water for drilling and completion operations will be obtained from the following location: Graves-Atterbury Irrigation Ditch, Section 4, T-31-N, R-10-W.

Waste material will be disposed of by burial in the burn pit, latrine, or reserve pit as applicable. There will be no camp nor air strip associated with drilling this well. Upon completion or abandonment of this well, the location will be cleaned and leveled and a dry hole marker placed, if applicable.

Yours very truly,

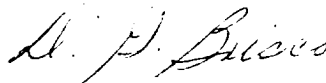

D. G. Brisco
Drilling Clerk

pb

LOCATION AND EQUIPMENT LAY-OUT

SCOTT #10

SW 5W/4 SEC 9 T-31-N R-10-W

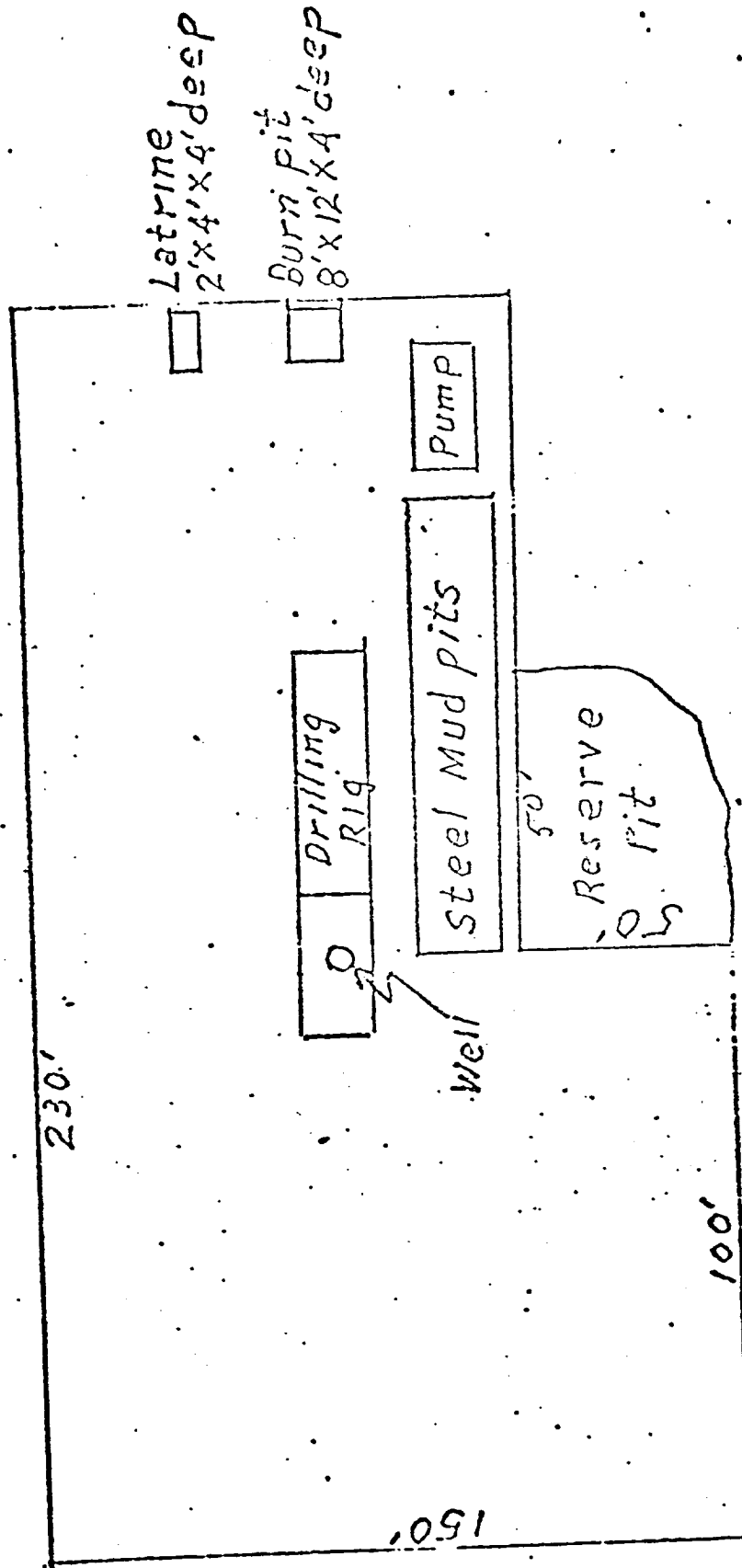

Handwritten signature or initials.

Sheet # 10
 S.W. 1/4 Sec. 4, T-31-N, R-10-W

E-10-W

1
 32
 N

1
 31
 N

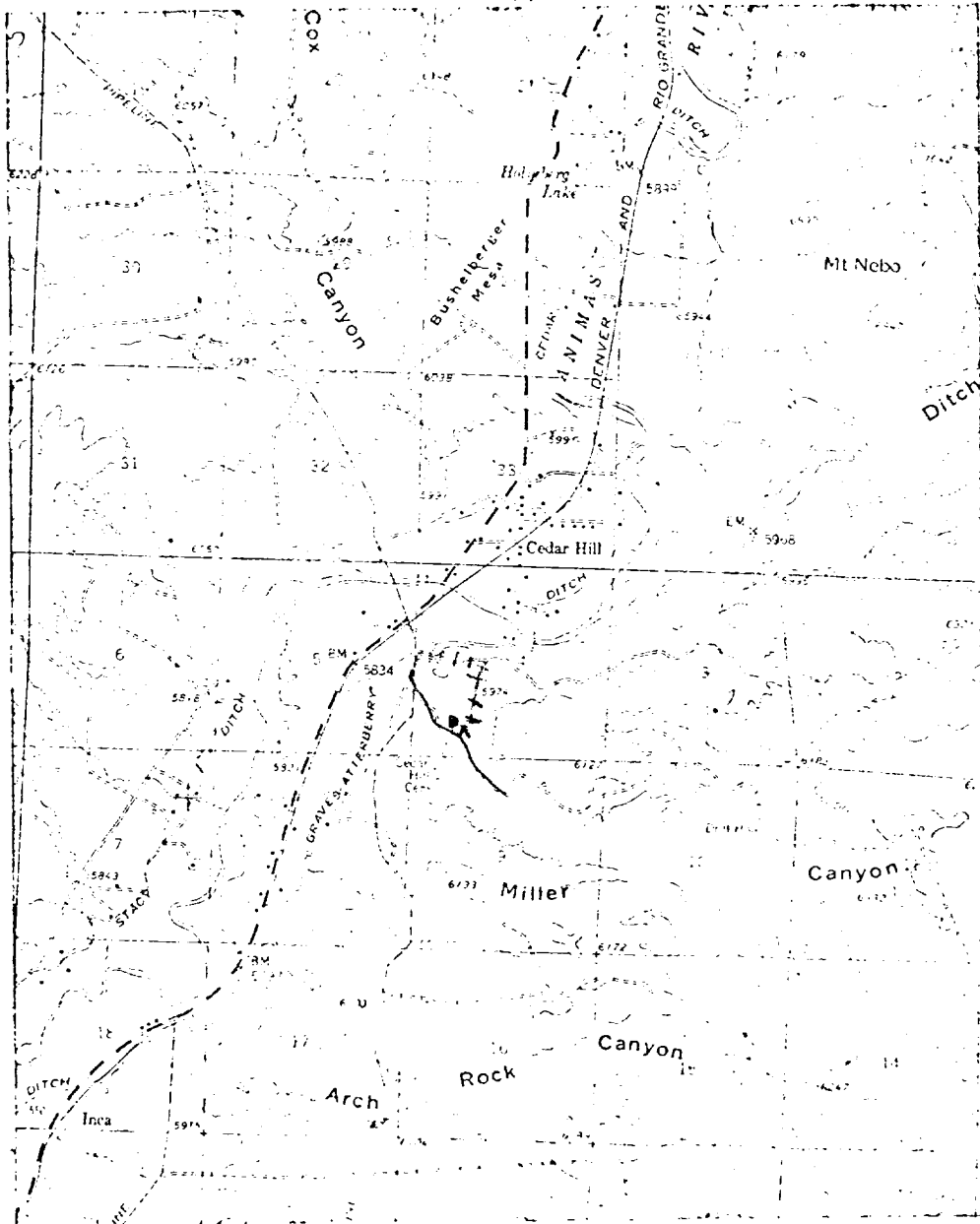

LEGEND OF RIGHT-OF-WAYS

EXISTING ROADS	—
EXISTING PIPELINES	- - - - -
EXISTING ROAD & PIPELINE	- - - - -
PROPOSED ROADS	—
PROPOSED PIPELINES	+ + + + +
PROPOSED ROAD & PIPELINE	+ + + + +