

**EL PASO FIELD SERVICES  
PRODUCTION PIT CLOSURE**

*Outside*

*12 PSK  
BTEX  
TPH*

**Canaple Gas Com #1A  
Meter/Line ID - 89516**

**RECEIVED**  
NOV - 2 1999  
**OIL CON. DIV.**  
**DIST. 3**

**SITE DETAILS**

**Legals - Twn: 31N  
NMOCD Hazard Ranking: 0  
Operator: Amoco**

**Rng: 10**

**Sec: 18**

**Unit: 1**

**Land Type: BLM**

**Pit Closure Date: 9/29/94**

**RATIONALE FOR RISK-BASED CLOSURE:**

The pit noted above was assessed and ranked according to the criteria in the New Mexico Oil Conservation Division's (NMOCD) Unlined Surface Impoundment Closure Guidelines.

A test pit was excavated to 12 feet and a soil sample was collected for field headspace analysis and laboratory analysis for TPH. Groundwater was not encountered in the test pit. The pit was then backfilled and graded in a manner to direct surface runoff away from the pit area. Headspace analysis indicated an organic vapor content of 350 ppm; laboratory analysis indicated a TPH concentration of 10,700 mg/kg.

El Paso Field Services Company (EPFS) requests closure of the above mentioned production pit location for the following reasons:

- The primary source, discharge to the pit, has been removed for over four years.
- The test pit was backfilled with clean soil and the former pit area graded to direct surface runoff away from the former pit.
- Source material has been removed from the ground surface, eliminating potential direct contact with livestock and the public.
- Groundwater was not encountered in the test excavation. In addition, the estimated depth to groundwater is greater than 100 feet; therefore, impact to groundwater is unlikely.
- There are no water supply wells or potential surface water receptors within 1,000 feet of the site.
- Residual hydrocarbons in the soil will degrade by natural attenuation with minimal risk to the environment.

**ATTACHMENT**

**Revised Field Pit Assessment Form  
Field Pit Remediation/Closure Form**

**Field Pit Assessment Form  
Laboratory Analytical Results**

**REVISED**  
**FIELD PIT SITE ASSESSMENT FORM**

<b>GENERAL</b>	Meter: <u>89516</u> Location: <u>Canaple Gas Com #1A</u> Operator #: _____ Operator Name: _____ P/L District: _____ Coordinates: Letter: <u>I</u> Section <u>18</u> Township: <u>31</u> Range: <u>10</u> Or           Latitude _____ Longitude _____ Pit Type: Dehydrator _____ Location Drip: _____ Line Drip: _____ Other: _____ Site Assessment Date: <u>4/13/98</u> Area: _____ Run: _____
<b>SITE ASSESSMENT</b>	<div style="display: flex; justify-content: space-between;"> <div style="width: 45%;"> <b>NMOCD Zone:</b>            (From NMOCD Maps)         </div> <div style="width: 45%;"> <b>Land Type:</b>            BLM <input checked="" type="checkbox"/> (1)            State <input type="checkbox"/> (2)            Fee <input type="checkbox"/> (3)            Indian _____         </div> </div> <div style="margin-top: 10px;"> <b>Depth to Groundwater</b>            Less Than 50 Feet (20 points) <input type="checkbox"/> (1)            50 Ft to 99 Ft (10 points) <input type="checkbox"/> (2)            Greater Than 100 Ft (0 points) <input checked="" type="checkbox"/> (3)         </div> <div style="margin-top: 10px;"> <b>Wellhead Protection Area</b>            Is it less than 1000 ft from wells, springs or other sources of fresh water extraction?, or; Is it less than 200 ft from a private domestic water source?  <div style="text-align: right;"> <input type="checkbox"/> (1) YES (20 points)      <input checked="" type="checkbox"/> (2) NO (0 points)         </div> </div> <div style="margin-top: 10px;"> <b>Horizontal Distance to Surface Water Body</b>            Less Than 200 Ft (20 points) <input type="checkbox"/> (1)            200 Ft to 1000 Ft (10 points) <input type="checkbox"/> (2)            Greater Than 1000 Ft (0 points) <input checked="" type="checkbox"/> (3)         </div> <div style="margin-top: 10px;">           Name of Surface Water Body _____            (Surface Water Body: Perennial Rivers, Streams, Creeks, Irrigation Canals, Ditches, Lakes, Ponds)            Distance to Nearest Ephemeral Stream <span style="float: right;">(1) &lt; 100' (Navajo Pits Only)</span>  <span style="float: right;">(2) &gt; 100'</span> </div> <div style="margin-top: 10px;"> <b>TOTAL HAZARD RANKING SCORE:</b> <u>0</u> <b>POINTS</b> </div>
<b>REMARKS</b>	Remarks : <u>Site has been re-assessed, due to initial assessment including washes as a Surface Water Body. Site is &gt; 100' vertical to center of Animas R.</u>

# FIELD PIT SITE ASSESSMENT FORM

GENERAL	Meter: <u>89-516</u> Location: <u>Canepa Gas Com Well No. 1A</u> Operator #: <u>0203</u> Operator Name: <u>Amoco Production P/L</u> District: <u>Artec</u> Coordinates: Letter: <u>I</u> Section <u>18</u> Township: <u>31</u> Range: <u>10</u> Or Latitude _____ Longitude _____ Pit Type: Dehydrator _____ Location Drip: <u>X</u> Line Drip: _____ Other: _____ Site Assessment Date: <u>8/24/94</u> Area: <u>04</u> Run: <u>52</u>	
	NMOCD Zone: (From NMOCD Maps) Inside <input type="checkbox"/> (1) Outside <input checked="" type="checkbox"/> (2) Land Type: BLM <input checked="" type="checkbox"/> (1) State <input type="checkbox"/> (2) Fee <input type="checkbox"/> (3) Indian _____ Depth to Groundwater Less Than 50 Feet (20 points) <input type="checkbox"/> (1) 50 Ft to 99 Ft (10 points) <input checked="" type="checkbox"/> (2) Greater Than 100 Ft (0 points) <input type="checkbox"/> (3) Wellhead Protection Area : Is it less than 1000 ft from wells, springs, or other sources of fresh water extraction? , or ; Is it less than 200 ft from a private domestic water source? <input type="checkbox"/> (1) YES (20 points) <input checked="" type="checkbox"/> (2) NO (0 points) Horizontal Distance to Surface Water Body Less Than 200 Ft (20 points) <input type="checkbox"/> (1) 200 Ft to 1000 Ft (10 points) <input checked="" type="checkbox"/> (2) Greater Than 1000 Ft (0 points) <input type="checkbox"/> (3) Name of Surface Water Body <u>Animas River</u> (Surface Water Body : Perennial Rivers, Major Wash, Streams, Creeks, Irrigation Canals, Ditches, Lakes, Ponds) Distance to Nearest Ephemeral Stream <input type="checkbox"/> (1) < 100' (Navajo Pits Only) <input type="checkbox"/> (2) > 100' TOTAL HAZARD RANKING SCORE: <u>20</u> POINTS	
SITE ASSESSMENT		
REMARKS	Remarks : <u>Redline Book - Inside</u> <u>Vulnerable Zone Type - Outside</u> <u>Five pits, location drip pit is dry 3/8/24/94 will close one pit.</u> <u>see back</u> <u>PUSH IN</u>	

## ORIGINAL PIT LOCATION

## ORIGINAL PIT LOCATION

Original Pit : a) Degrees from North 84° Footage from Wellhead 11'  
b) Length : 23' Width : 23' Depth : 3'

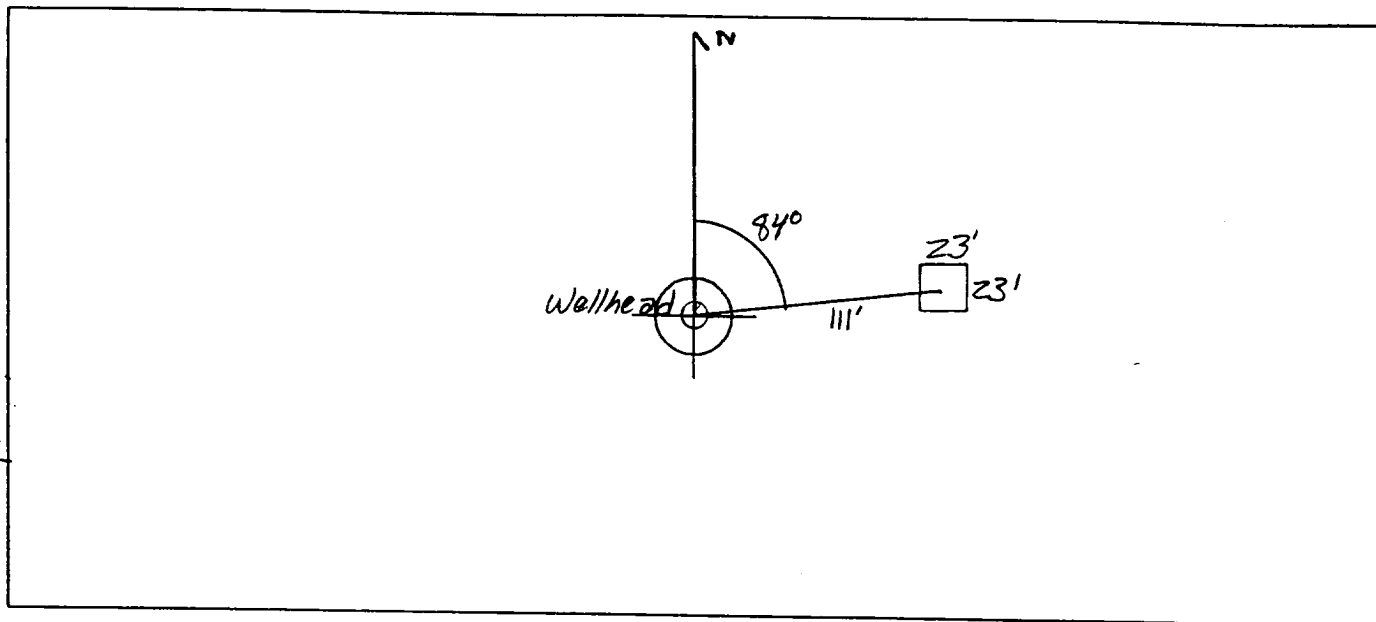

## REMARKS

## Remarks :

Pictures @ 1525 (20-24, Roll 1)

Dump Truck

Pit has a small amount of liquid in it.

Completed By:

Sarah Kelley  
Signature

8/24/94  
Date

# FIELD PIT REMEDIATION/CLOSURE FORM

GENERAL	<p>Meter: <u>89516</u> Location: <u>Cane Plc GAS Com well No. 1A</u></p> <p>Coordinates: Letter: <u>I</u> Section <u>18</u> Township: <u>31</u> Range: <u>10</u></p> <p>Or Latitude _____ Longitude _____</p> <p>Date Started : <u>9-29-94</u> Run: <u>04</u> <u>52</u></p>
FIELD OBSERVATIONS	<p>Sample Number(s): <u>K1272</u></p> <p>Sample Depth: <u>12'</u> Feet</p> <p>Final PID Reading <u>350</u> PID Reading Depth <u>12'</u> Feet</p> <p>Yes No</p> <p>Groundwater Encountered <input type="checkbox"/> <input checked="" type="checkbox"/> Approximate Depth _____ Feet</p>
CLOSURE	<p>Remediation Method :</p> <p>Excavation <input type="checkbox"/> Approx. Cubic Yards _____</p> <p>Onsite Bioremediation <input type="checkbox"/></p> <p>Backfill Pit Without Excavation <input checked="" type="checkbox"/></p> <p>Soil Disposition:</p> <p>Envirotech <input type="checkbox"/> Tierra <input type="checkbox"/></p> <p>Other Facility <input type="checkbox"/> Name: _____</p> <p>Pit Closure Date: <u>9-29-94</u> Pit Closed By: <u>B.E.I</u></p>
REMARKS	<p>Remarks : <u>Some Line markers. A little Bit of oil &amp; water in pit. At 12' Soil dark gray with a smell</u></p>
	<p>Signature of Specialist: <u>Kelly Pachilla</u></p>



Natural Gas Company

CHAIN OF CUSTODY RECORD

Page \_\_\_\_\_ of \_\_\_\_\_

PROJECT NUMBER # 24324		PROJECT NAME Pit Closure Project		DATE: 9-29-94		DATE: 9-29-94						
LAB ID		DATE	TIME	MATRIX	FIELD ID	TOTAL NUMBER OF CONTAINERS						
946273	9-29-94	0844	soil	KP 263	1	TPH EPA 418.1	BTEX EPA 8020	LAB PID	REQUESTED ANALYSIS		SEQUENCE #	REMARKS
946274	9-29-94	0945	soil	KP 264	1	X	X		VG		239	Hit sand stone at 6' soil dark gray
946275	9-29-94	0945	soil	KP 265	1	X	X		VG		240	
946276	9-29-94	0850	soil	KP 266	1	X	X		D			
946277	9-29-94	1043	soil	KP 267	1	X	X		B			
946278	9-29-94	1135	soil	KP 268	1	X	X		VG		241	soil Black with a smell.
946279	9-29-94	1300	soil	KP 269	1	X	X		VG		242	Hit sand stone at 6' soil gray looking
946280	9-29-94	1520	soil	KP 270	1	X	X		VG		243	soil dark Black with a smell
946281	9-29-94	1600	soil	KP 271	1	X	X		VG		244	Hit sand stone at 7' soil still dark gray
946282	9-29-94	1630	soil	KP 272	1	X	X		VG		245	Hit sand stone at 8' soil light brown
											246	soil gray looking with a smell
RELINQUISHED BY: (Signature)		DATE/TIME 39		RECEIVED BY: (Signature)		DATE/TIME 28		RECEIVED BY: (Signature)				
RELINQUISHED BY: (Signature)		DATE/TIME 9-29-94 1800		RECEIVED BY: (Signature)		DATE/TIME 9/30/94 10:20		RECEIVED BY: (Signature)				
REQUESTED TURNAROUND TIME: <input type="checkbox"/> ROUTINE <input type="checkbox"/> RUSH				SAMPLE RECEIPT REMARKS		RESULTS & INVOICES TO:		FIELD SERVICES LABORATORY EL PASO NATURAL GAS COMPANY P. O. BOX 4990 FARMINGTON, NEW MEXICO 87499				
CARRIER CO.				Sample KR 271 was not tested (Bik Tape) around lid. Sample was individual bagged. Brenda Riess will type (BET). CHARGE CODE Acceptable Sample.		505-599-2144		FAX: 505-599-2261				
BILL NO.:				9/30/94		No BTEX needed all of them outside con 2						



## FIELD SERVICES LABORATORY

### ANALYTICAL REPORT

#### PIT CLOSURE PROJECT - Soil Samples Outside the GWV Zone

#### SAMPLE IDENTIFICATION

	Field ID	Lab ID
SAMPLE NUMBER:	KP 272	946282
MTR CODE   SITE NAME:	89516	N/A
SAMPLE DATE   TIME (Hrs):	9-29-94	1630
SAMPLED BY:	N/A	
DATE OF TPH EXT.   ANAL.:	10-3-94	
DATE OF BTEX EXT.   ANAL.:	N/A	N/A
TYPE   DESCRIPTION:	VG	Brown fine sand

REMARKS:

#### RESULTS

PARAMETER	RESULT	UNITS	QUALIFIERS			
			DF	Q	M(g)	V(ml)
TPH (418.1)	10,700	MG/KG			0.93	28
HEADSPACE PID	350	PPM				
PERCENT SOLIDS	92.8	%				

-- TPH is by EPA Method 418.1 --

Narrative:

DF = Dilution Factor Used

Approved By:

Date:

10/6/94