

NEW MEXICO OIL CONSERVATION COMMISSION  
WELL LOCATION AND ACREAGE DEDICATION PLAT

Form No. 1  
Supersedes C-1, B  
Effective 1-1-66

All distances must be from the outer boundaries of the Section

Koch Exploration Company			Lease LAMB		Acres 7
Section M	21	31 NORTH	10 WEST	County SAN JUAN	
Actual true location of Well:					
1190	feet from the SOUTH	line and	970	feet from the WEST	line
Ground Level Elev. 6125	Predicting Formation Pictured Cliffs		Pool Blanco Ext.	Dedicated Acreage 160.48 Acres	

1. Outline the acreage dedicated to the subject well by colored pencil or hachure marks on the plat below.
2. If more than one lease is dedicated to the well, outline each and identify the ownership thereof (both as to working interest and royalty).
3. If more than one lease of different ownership is dedicated to the well, have the interests of all owners been consolidated by communitization, unitization, force-pooling, etc?

☐ Yes ☐ No If answer is "yes," type of consolidation \_\_\_\_\_

If answer is "no," list the owners and tract descriptions which have actually been consolidated. (Use reverse side of this form if necessary.) \_\_\_\_\_

No allowable will be assigned to the well until all interests have been consolidated (by communitization, unitization, forced-pooling, or otherwise) or until a non-standard unit, eliminating such interests, has been approved by the Commission.

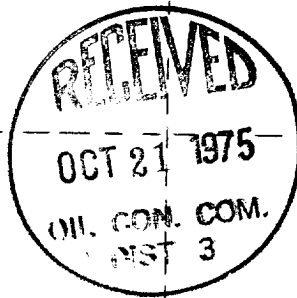
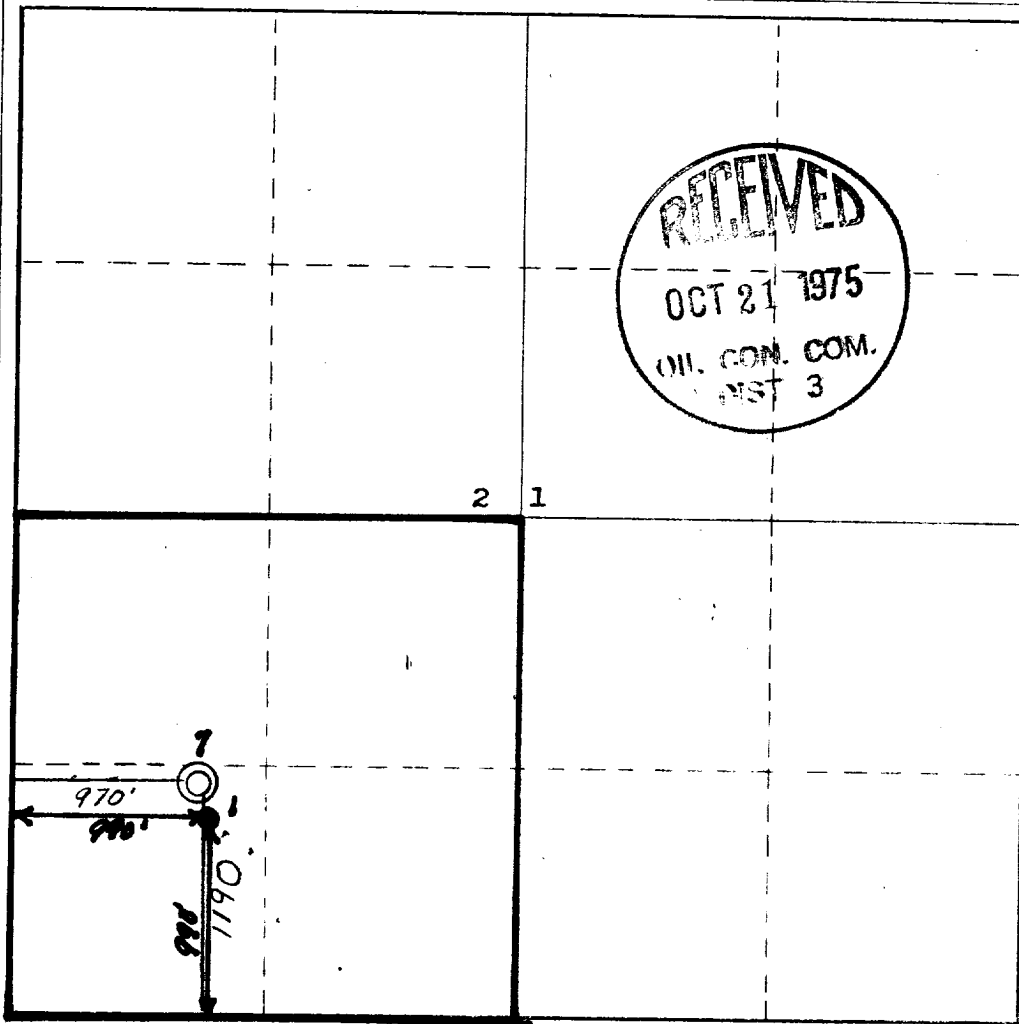

CERTIFICATION

I hereby certify that the information contained herein is true and complete to the best of my knowledge and belief.

*Dwaine L. Schmit*  
Name

Operations Manager  
Position

Koch Industries, Inc.  
Company

October 17, 1975  
Date

I hereby certify that the well location shown on this plat was plotted from field notes and that the same is true and correct to the best of my knowledge and belief.

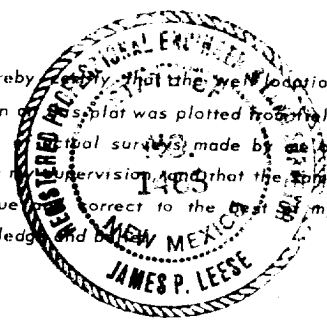

Date Surveyed

9 October, 1975

Registered Professional Engineer and/or Land Surveyor

*James P. Leese*

Certificate No.

1463