

UNITED STATES
DEPARTMENT OF THE INTERIOR
GEOLOGICAL SURVEY

30-045-21902

APPLICATION FOR PERMIT TO DRILL, DEEPEN, OR PLUG BACK

1a. TYPE OF WORK DRILL <input checked="" type="checkbox"/> DEEPEN <input type="checkbox"/> PLUG BACK <input type="checkbox"/>			5. LEASE DESIGNATION AND SERIAL NO. NM 014110
b. TYPE OF WELL OIL WELL <input type="checkbox"/> GAS WELL <input checked="" type="checkbox"/> OTHER <input type="checkbox"/> SINGLE ZONE <input checked="" type="checkbox"/> MULTIPLE ZONE <input type="checkbox"/>			6. IF INDIAN, ALLOTTEE OR TRIBE NAME
2. NAME OF OPERATOR Koch Industries Inc.			7. UNIT AGREEMENT NAME
3. ADDRESS OF OPERATOR P.O. Box 2256, Wichita, Kansas 67201			8. FARM OR LEASE NAME WALKER
4. LOCATION OF WELL (Report location clearly and in accordance with any State requirements.*) At surface 990' FSL & 1190' FEL SW NW SE At proposed prod. zone			9. WELL NO. 3
14. DISTANCE IN MILES AND DIRECTION FROM NEAREST TOWN OR POST OFFICE* Approx. 15 NE of Bloomfield			10. FIELD AND POOL, OR WILDCAT Pictured Cliffs
15. DISTANCE FROM PROPOSED* LOCATION TO NEAREST PROPERTY OR LEASE LINE, FT. (Also to nearest drlg. unit line, if any) 990' FSL			11. SEC., T., R., M., OR BLK. AND SURVEY OR AREA Sec. 10-31N-10W
18. DISTANCE FROM PROPOSED LOCATION* TO NEAREST WELL, DRILLING, COMPLETED, OR APPLIED FOR, ON THIS LEASE, FT. Appr. 200'			12. COUNTY OR PARISH San Juan
16. NO. OF ACRES IN LEASE 160			13. STATE New Mexico
17. NO. OF ACRES ASSIGNED TO THIS WELL 157.64			20. ROTARY OR CABLE TOOLS Rotary
21. ELEVATIONS (Show whether DF, RT, GR, etc.) 6148' GR			22. APPROX. DATE WORK WILL START*

23. PROPOSED CASING AND CEMENTING PROGRAM

SIZE OF HOLE	SIZE OF CASING	WEIGHT PER FOOT	SETTING DEPTH	QUANTITY OF CEMENT
8-3/4"	7"	26#	200'	100
6-1/4"	4-1/2"	10.5#	2900'	200

- Set SH 7" casing tested to 3000# @ 200'. Cement w/enough to circulate to surface. WOC 24 hours.
 - Test csg. to 1000# & drill to approx. 1800' w/native mud. Mud up w/Gel-Benex type mud & drill through Pictured Cliffs. Run approx. 2900' of new 4 1/2" 10.5# CW-55 ST&C csg. Use enough cement to cover Ojo.
 - 8" LWP Shaeffer double pipe ram BOP's will be used. Check BOP's each tour & blind rams each trip.
 - Well head will be LP screw type - will not be used to frac through.
 - Mud program: 0-200' Gel Lime Slurry, 200-1800' Water & Benex, 1800-2900' Gel-Spersene Mud.
 - Anticipated BHP at TD max. of 1000#. No abnormal pressures anticipated.
 - Auxillary & BOP equipment on rig as follows: (A) Double ram BOP, (B) Kelly cocks (If required), (C) Rotating drilling head (If required), (D) Kill valve on rig floor.
 - Complete well by swabbing csg. dry. Perf Pictured Cliffs w/2HPF & frac (Over)
- IN ABOVE SPACE DESCRIBE PROPOSED PROGRAM: If proposal is to deepen or plug back, give data on present productive zone and proposed new productive zone. If proposal is to drill or deepen directionally, give pertinent data on subsurface locations and measured and true vertical depths. Give blowout preventer program, if any.

24. SIGNED Orville L. Schmit TITLE Operations Manager DATE 9-30-75
(This space for Federal or State office use)

PERMIT NO. _____ APPROVAL DATE _____ U. S. GEOLOGICAL SURVEY

APPROVED BY _____ TITLE _____ DATE _____
CONDITIONS OF APPROVAL, IF ANY:

**NEW MEXICO OIL CONSERVATION COMMISSION
WELL LOCATION AND ACREAGE DEDICATION PLAT**

Form O-11
Supersedes O-12b
Effective 1-1-63

All distances must be from the outer boundaries of the Section

Operator KOCH EXPLORATION COMPANY			Lease WALKER		Well No. 3
Unit Letter P	Section 10	Township 31 NORTH	Range 10 WEST	County SAN JUAN	
Actual Footage Location of Well: 990 feet from the SOUTH line and 1190 feet from the EAST line					
Ground Level Elev. 6148.0	Producing Formation PICTURED CLIFFS	Pool UNDES.	Dedicated Acreage 157.64		

1. Outline the acreage dedicated to the subject well by colored pencil or hachure marks on the plat below.
2. If more than one lease is dedicated to the well, outline each and identify the ownership thereof (both as to working interest and royalty).
3. If more than one lease of different ownership is dedicated to the well, have the interests of all owners been consolidated by communitization, unitization, force-pooling, etc?

☐ Yes ☐ No If answer is "yes" type of consolidation _____

If answer is "no," list the owners and tract descriptions which have actually been consolidated (Use reverse side of this form if necessary.) _____

No allowable will be assigned to the well until all interests have been consolidated (by communitization, unitization, forced-pooling, or otherwise) or until a non-standard unit, eliminating such interests, has been approved by the Commission.

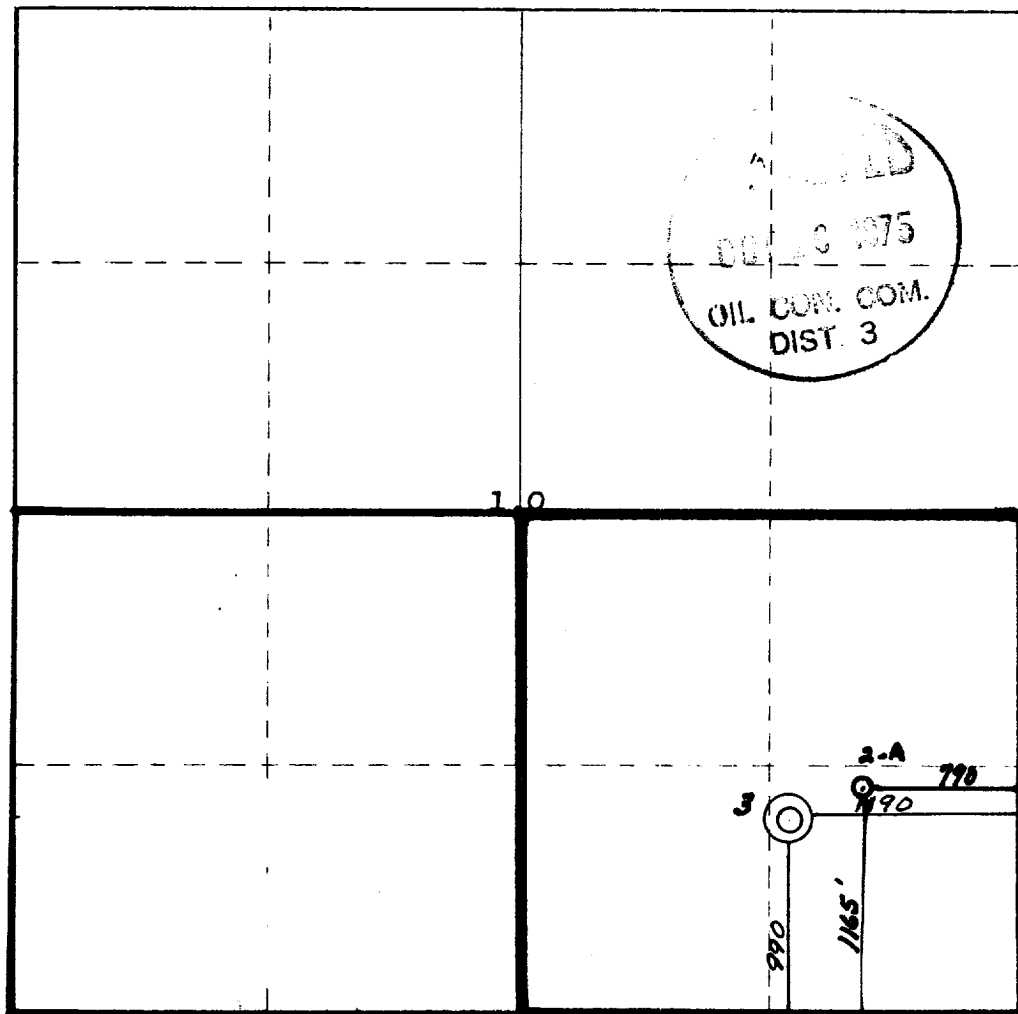
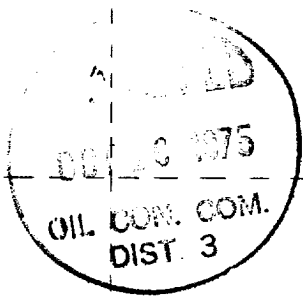
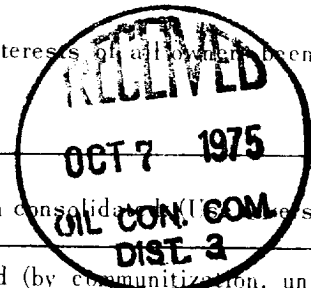

CERTIFICATION

I hereby certify that the information contained herein is true and complete to the best of my knowledge and belief.

Dwain L. Schmitt
Name

Operations Manager

Position

Koch Industries, Inc.

Company

October 13, 1975

Date

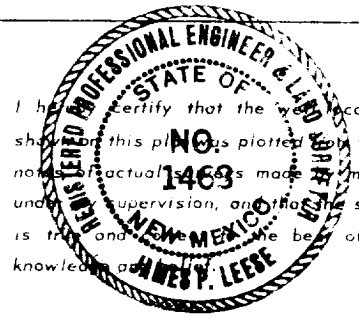

I hereby certify that the location shown on this plat was plotted in the field and that the actual survey was made under my supervision, and that the same is true and correct to the best of my knowledge and belief.

Date Surveyed

22 September, 1975

Registered Professional Engineer and Land Surveyor

James P. Lees

1463

UNITED STATES
DEPARTMENT OF THE INTERIOR
GEOLOGICAL SURVEY

SUBMIT IN TRIPLICATE*
(Other instructions on reverse side)

Form approved.
Budget Bureau No. 42-R1424.

SUNDRY NOTICES AND REPORTS ON WELLS

(Do not use this form for proposals to drill or to deepen or plug back to a different reservoir.
Use "APPLICATION FOR PERMIT—" for such proposals.)

1. OIL WELL <input type="checkbox"/> GAS WELL <input checked="" type="checkbox"/> OTHER		5. LEASE DESIGNATION AND SERIAL NO. NM 014110	
2. NAME OF OPERATOR Koch Industries, Inc.		6. IF INDIAN, ALLOTTEE OR TRIBE NAME	
3. ADDRESS OF OPERATOR P.O. Box 2256, Wichita, Kansas 67201		7. UNIT AGREEMENT NAME	
4. LOCATION OF WELL (Report location clearly and in accordance with any State requirements.* See also space 17 below.) At surface 960' FSL & 1165FEL SE SE		8. FARM OR LEASE NAME WALKER	
14. PERMIT NO.		9. WELL NO. 3	
15. ELEVATIONS (Show whether DF, RT, GR, etc.) 6151 Gr		10. FIELD AND POOL, OR WILDCAT Undes.	
		11. SEC., T., R., M., OR BLK. AND SURVEY OR AREA Sec. 10-31N-10W	
		12. COUNTY OR PARISH San Juan	13. STATE N.M.

16.

Check Appropriate Box To Indicate Nature of Notice, Report, or Other Data

NOTICE OF INTENTION TO:

TEST WATER SHUT-OFF ☐

FRACTURE TREAT ☐

SHOOT OR ACIDIZE ☐

REPAIR WELL ☐

(Other)

PULL OR ALTER CASING ☐

MULTIPLE COMPLETE ☐

ABANDON* ☐

CHANGE PLANS ☐

SUBSEQUENT REPORT OF:

WATER SHUT-OFF ☐

FRACTURE TREATMENT ☐

SHOOTING OR ACIDIZING ☐

(Other) Change in location

REPAIRING WELL ☐

ALTERING CASING ☐

ABANDONMENT* ☐

(NOTE: Report results of multiple completion on Well Completion or Recompletion Report and Log form.)

17. DESCRIBE PROPOSED OR COMPLETED OPERATIONS (Clearly state all pertinent details, and give pertinent dates, including estimated date of starting any proposed work. If well is directionally drilled, give subsurface locations and measured and true vertical depths for all markers and zones pertinent to this work.)*

The location of this proposed well has been changed from 990' FSL & 1190' FEL to 960' FSL & 1165' FEL, Sec. 10-31N-10W, San Juan County, New Mexico.



RECEIVED

OCT 20 1975

U. S. GEOLOGICAL SURVEY
WASHINGTON, D. C.

18. I hereby certify that the foregoing is true and correct

SIGNED

Charles L. Schmidt

TITLE Operations Manager

DATE 10-17-75

(This space for Federal or State office use)

APPROVED BY

CONDITIONS OF APPROVAL, IF ANY:

TITLE

DATE

NEW MEXICO OIL CONSERVATION COMMISSION
WELL LOCATION AND ACREAGE DEDICATION PLAT

Form 1-107
Supersedes C-128
Effective 1-1-65

All distances must be from the outer boundaries of the Section

Operator KOCH EXPLORATION COMPANY		Lease WALKER		Well No. 3	
Unit Letter P	Section 10	Township 31 NORTH	Range 10 WEST	County SAN JUAN	
Actual Portage Location of Well:					
960	feet from the SOUTH	line and 1165	feet from the EAST	line	
Ground Level Elev. 6151.0	Producing Formation Pictured Cliffs	Pool Undesignated	Dedicated Acreage 157.64		Acres

- Outline the acreage dedicated to the subject well by colored pencil or hachure marks on the plat below.
- If more than one lease is dedicated to the well, outline each and identify the ownership thereof (including working interest and royalty).
- If more than one lease of different ownership is dedicated to the well, have the interests of all owners been consolidated by communitization, unitization, force-pooling, etc?

☐ Yes ☐ No If answer is "yes," type of consolidation _____

If answer is "no," list the owners and tract descriptions which have actually been consolidated. (Use reverse side of this form if necessary.) _____

No allowable will be assigned to the well until all interests have been consolidated (by communitization, unitization, forced-pooling, or otherwise) or until a non-standard unit, eliminating such interests, has been approved by the Commission.

CERTIFICATION

I hereby certify that the information contained herein is true and complete to the best of my knowledge and belief.

Orville L. Schmitt
Name

Operations Manager

Position

Koch Industries, Inc.

Company

October 17, 1975

Date

I hereby certify that the well location shown on this plat was plotted from field notes of actual surveys made by me or under my supervision, and that the same is true to the best of my knowledge and belief.

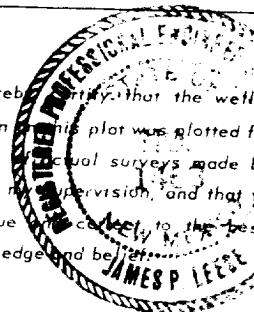

Date Surveyed

9th October, 1975

Registered Professional Engineer and/or Land Surveyor

James P. Reese

Certificate No.

1463.

