

NO. OF COPIES RECEIVED	6
DISTRIBUTION	
SANTA FE	1
FILE	1
U.S.G.S.	2
LAND OFFICE	
OPERATOR	2

NEW MEXICO OIL CONSERVATION COMMISSION

30-045-21906
Form C-101
Revised 1-1-65

OCT 10 1975

OIL CON. COM.
DIST. 3

5A. Indicate Type of Lease	
STATE <input type="checkbox"/>	FEE <input checked="" type="checkbox"/>
5. State Oil & Gas Lease No.	

APPLICATION FOR PERMIT TO DRILL, DEEPEN, OR PLUG BACK

1a. Type of Work		7. Unit Agreement Name	
b. Type of Well DRILL <input checked="" type="checkbox"/> DEEPEN <input type="checkbox"/> PLUG BACK <input type="checkbox"/> OIL WELL <input type="checkbox"/> GAS WELL <input checked="" type="checkbox"/> OTHER <input type="checkbox"/> SINGLE ZONE <input checked="" type="checkbox"/> MULTIPLE ZONE <input type="checkbox"/>		San Juan 32-7 Unit	
2. Name of Operator		8. Farm or Lease Name	
Northwest Pipeline Corporation		San Juan 32-7 Unit	
3. Address of Operator		9. Well No.	
P. O. Box 90 Farmington, New Mexico 87401		30	
4. Location of Well		10. Field and Pool, or Wildcat	
UNIT LETTER B LOCATED 810' FEET FROM THE North LINE		Blanco Mesa Verde	
AND 1560 FEET FROM THE East LINE OF SEC. 21 TWP. 32N RGE. 7W NMPM			
		12. County	
		San Juan	
		19. Proposed Depth	
		5950'	
		19A. Formation	
		Mesa Verde	
		20. Rotary or C.T.	
		Rotary	
21. Elevations (Show whether DF, RT, etc.)		22. Approx. Date Work will start	
6366' GR		October 20, 1975	

PROPOSED CASING AND CEMENT PROGRAM

SIZE OF HOLE	SIZE OF CASING	WEIGHT PER FOOT	SETTING DEPTH	SACKS OF CEMENT	EST. TOP
13 3/4"	9 5/8"	36#	200'	180	
8 3/4"	7"	20#	3940'	160	
6 1/4"	4 1/2" liner	10.5#	5950'	215	

Selectively perforate and stimulate the Mesa Verde formation.

A BOP will be installed after the surface casing is set and cemented. All subsequent work will be conducted through the BOP.

The E/2 of section 21 is dedicated to this well.

APPROVAL VALID
FOR 90 DAYS UNLESS
DRILLING COMMENCED,
EXPIRES 1-8-76

IN ABOVE SPACE DESCRIBE PROPOSED PROGRAM; IF PROPOSAL IS TO DEEPEN OR PLUG BACK, GIVE DATA ON PRESENT PRODUCTIVE ZONE AND PROPOSED NEW PRODUCTIVE ZONE. GIVE BLOWOUT PREVENTER PROGRAM, IF ANY.

I hereby certify that the information above is true and complete to the best of my knowledge and belief.

Signed D. H. Maroncelli Title Petroleum Engineer Date 10/8/75
(This space for State Use)

APPROVED BY AR Kendrick TITLE SUPERVISOR DIST. 3 DATE OCT 10 1975
CONDITIONS OF APPROVAL, IF ANY:

**NEW MEXICO OIL CONSERVATION COMMISSION
WELL LOCATION AND ACREAGE DEDICATION PLAT**

Form C-102
Supersedes C-128
Effective 1-1-65

All distances must be from the outer boundaries of the Section.

Operator Northwest Pipeline Corporation		Lease San Juan 32-7 Unit		Well No. 30
Unit Letter B	Section 21	Township 32N	Range 7W	County San Juan
Actual Footage Location of Well:				
810' feet from the North line and		1560 feet from the East line		
Ground Level Elev: 6366	Producing Formation Mesa Verde	Pool Blanco Mesa Verde	Dedicated Acreage: 328.97 320 Acres	

1. Outline the acreage dedicated to the subject well by colored pencil or hachure marks on the plat below.
2. If more than one lease is dedicated to the well, outline each and identify the ownership thereof (both as to working interest and royalty).
3. If more than one lease of different ownership is dedicated to the well, have the interests of all owners been consolidated by communitization, unitization, force-pooling, etc?

☐ Yes ☐ No If answer is "yes," type of consolidation _____

If answer is "no," list the owners and tract descriptions which have actually been consolidated. (Use reverse side of this form if necessary.) _____

No allowable will be assigned to the well until all interests have been consolidated by communitization, unitization, forced-pooling, or otherwise) or until a non-standard unit, eliminating such interests, has been approved by the Commission.

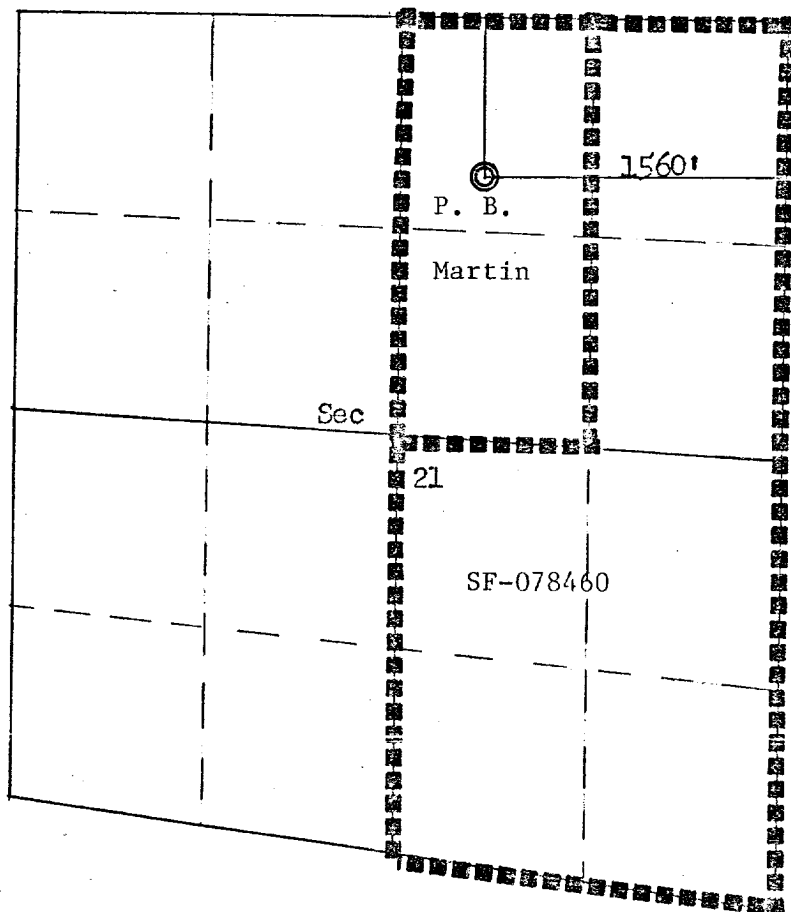
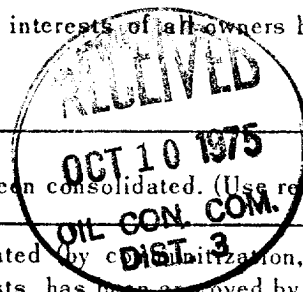

Scale: 1" = 1320'

CERTIFICATION

I hereby certify that the information contained herein is true and complete to the best of my knowledge and belief.

D. H. Maroncelli

Name
D. H. Maroncelli

Position
Petroleum Engineer

Company
Northwest Pipeline Corp.

Date
October 8, 1975

I hereby certify that the well location shown on this plat was plotted from field notes of actual surveys made by me or under my supervision, and that the same is true and correct to the best of my knowledge and belief.

Date Surveyed
August 9, 1975

Registered Professional Engineer and/or Land Surveyor

Fred B. Kott Jr.
Fred B. Kott Jr.

Certificate No.

3950

