

UNITED STATES  
DEPARTMENT OF THE INTERIOR  
GEOLOGICAL SURVEY

## APPLICATION FOR PERMIT TO DRILL, DEEPEN, OR PLUG BACK

## 1a. TYPE OF WORK

DRILL ☒DEEPEN ☐PLUG BACK ☐

## b. TYPE OF WELL

OIL  
WELL ☒GAS  
WELL ☐

OTHER

SINGLE  
ZONE ☒MULTIPLE  
ZONE ☐

## 2. NAME OF OPERATOR

Atlantic Richfield Company

## 3. ADDRESS OF OPERATOR

501 Lincoln Tower Bldg., 1860 Lincoln St., Denver, Colo. 80203

## 4. LOCATION OF WELL (Report location clearly and in accordance with any State requirements.)\*

At surface

Unit "M" - 312' E/South and 323' E/West lines Sec. 33

At proposed prod. zone

Approx same

## 14. DISTANCE IN MILES AND DIRECTION FROM NEAREST TOWN OR POST OFFICE\*

Approx 3 mi east and 10 mi NE from Shiprock, New Mexico

## 15. DISTANCE FROM PROPOSED\*

LOCATION TO NEAREST  
PROPERTY OR LEASE LINE, FT.  
(Also to nearest drlg. unit line, if any)

312' E/Tr. 12 line

## 18. DISTANCE FROM PROPOSED LOCATION\*

TO NEAREST WELL, DRILLING, COMPLETED,  
OR APPLIED FOR, ON THIS LEASE, FT.

570' E/208

## 16. NO. OF ACRES IN LEASE

Tr. 12 - 204.14 Ac  
Unit - 13,527.80 Ac

## 19. PROPOSED DEPTH

1310'

17. NO. OF ACRES ASSIGNED  
TO THIS WELL

N/A - Unitized

## 20. ROTARY OR CABLE TOOLS

Rotary

## 21. ELEVATIONS (Show whether DF, RT, GR, etc.)

5331'

## 22. APPROX. DATE WORK WILL START\*

When appl rec'd

Est. 11/5/75

## 23.

## PROPOSED CASING AND CEMENTING PROGRAM

SIZE OF HOLE	SIZE OF CASING	WEIGHT PER FOOT	SETTING DEPTH	QUANTITY OF CEMENT
12-1/4"	8-5/8"	21 1/2	120'	120 sac (Cst to surface)
7-7/8"	5-1/2"	14 1/2	T.D.	225 sac

Propose to drill well to depth sufficient to test the Gallup Formation. Est. tops are: Upper Gallup 1085'; Lower Gallup 1190'. Will set 8-5/8" OD casing at approx 120' and cement to surface; drill 7-7/8" hole to T.D. and log; if productive, set 5-1/2" casing w/ sufficient cement to protect all zones; productive zone(s) will be perforated, treated if necessary, and well completed.

Attachments: Certified Location Plat  
Pertinent Drilling Information  
Development Plan for Surface Use w/ att.

Re: New Mexico Oil Conservation Commission Order No. 4-2210 and 4-2210-A



IN ABOVE SPACE DESCRIBE PROPOSED PROGRAM: If proposal is to deepen or plug back, give data on present productive zone and proposed new productive zone. If proposal is to drill or deepen directionally, give pertinent data on subsurface locations and measured and true vertical depths. Give blowout preventer program, if any.

## 24.

SIGNED W. A. Walther, Jr. TITLE Dist. Prod. & Drlg. Supt. DATE 10/26/75  
(This space for Federal or State office use)

PERMIT NO. \_\_\_\_\_ APPROVAL DATE \_\_\_\_\_

APPROVED BY \_\_\_\_\_ TITLE \_\_\_\_\_  
CONDITIONS OF APPROVAL, IF ANY:U. S. GEOLOGICAL SURVEY  
FARMINGTON, N. M.

\*See Instructions On Reverse Side

Hold C. 100 for 11/22  
open notified 11/2-75

## Instructions

**General:** This form is designed for submitting proposals to perform certain well operations, as indicated, on all types of lands and leases for appropriate action by either a Federal or a State agency, or both, pursuant to applicable Federal and/or State laws and regulations. Any necessary special instructions concerning the use of this form and the number of copies to be submitted, particularly with regard to local, area, or regional procedures and practices, either are shown below or will be issued by, or may be obtained from, the local Federal and/or State office.

**Item 1:** If the proposal is to redrill to the same reservoir at a different subsurface location or to a new reservoir, use this form with appropriate notations. Consult applicable State or Federal regulations concerning subsequent work proposals or reports on the well.

**Item 4:** If there are no applicable State requirements, locations on Federal or Indian land should be described in accordance with Federal requirements. Consult local State or Federal office for specific instructions.

**Item 14:** Needed only when location of well cannot readily be found by road from the land or lease description. A plat, or plats, separate or on this reverse side, showing the roads to, and the surveyed location of, the well, and any other required information, should be furnished when required by Federal or State agency offices.

**Items 15 and 18:** If well is to be, or has been directionally drilled, give distances for subsurface location of hole in any present or objective production zone.

**Item 22:** Consult applicable Federal or State regulations, or appropriate officials, concerning approval of the proposal before operations are started.

**NEW MEXICO OIL CONSERVATION COMMISSION  
WELL LOCATION AND ACREAGE DEDICATION PLAT**

Form C-102  
Supersedes C-128  
Effective 1-1-65

All distances must be from the outer boundaries of the Section.

Operator <b>Atlantic Richfield Company</b>			Lease <b>Horseshoe Gallup Unit</b>		Well No. <b>290</b>
Unit Letter <b>M</b>	Section <b>33</b>	Township <b>31 North</b>	Range <b>16 West</b>	County <b>San Juan</b>	
Actual Footage Location of Well: <b>312</b> feet from the <b>South</b> line and <b>323</b> feet from the <b>West</b> line					
Ground Level Elev. <b>5331</b>	Producing Formation <b>Gallup</b>		Pool <b>Horseshoe Gallup</b>	Dedicated Acreage: <b>40</b> <del>NA - Unitized</del> Acres	

Re: Order R-2210-A

1. Outline the acreage dedicated to the subject well by colored pencil or hachure marks on the plat below.
2. If more than one lease is dedicated to the well, outline each and identify the ownership thereof (both as to working interest and royalty).
3. If more than one lease of different ownership is dedicated to the well, have the interests of all owners been consolidated by communitization, unitization, force-pooling, etc?

☒ Yes    ☐ No    If answer is "yes," type of consolidation **Unitization**

If answer is "no," list the owners and tract descriptions which have actually been consolidated. (Use reverse side of this form if necessary.) \_\_\_\_\_

No allowable will be assigned to the well until all interests have been consolidated (by communitization, unitization, forced-pooling, or otherwise) or until a non-standard unit, eliminating such interests, has been approved by the Commission.

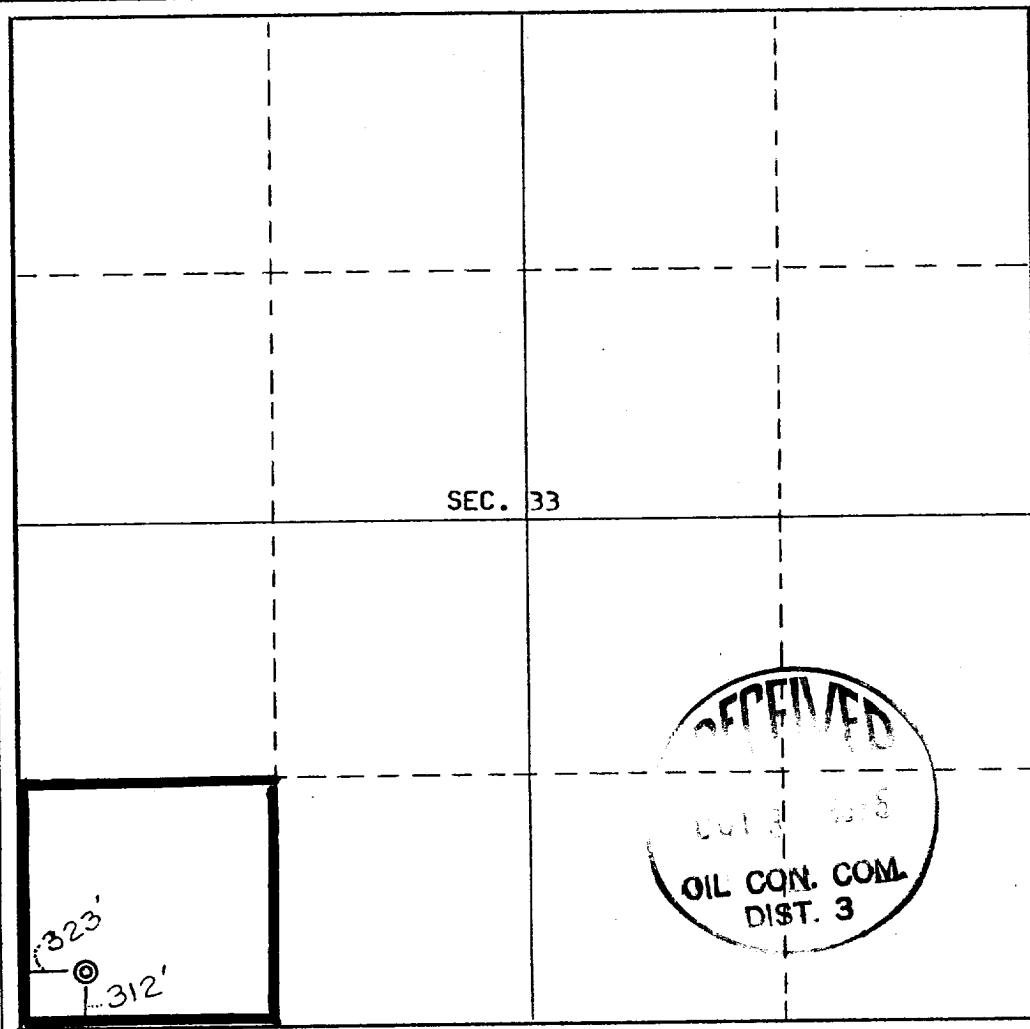

**CERTIFICATION**

I hereby certify that the information contained herein is true and complete to the best of my knowledge and belief.

Name \_\_\_\_\_  
Position **W. A. Walther, Jr.**  
**Dist. Prod. & Drlg. Supt.**  
Company  
**ATLANTIC RICHFIELD COMPANY**

Date  
**Oct. 28, 1975**

Registered Land Surveyor  
I hereby certify that the well location shown on this plat was plotted from field notes of actual surveys made by me or under my supervision, and that the same are true and correct to the best of my knowledge and belief.

Date Surveyed  
**October 7, 1975**  
Registered Professional Engineer and/or Land Surveyor

*E. V. Echhawk*  
Certificate No. **3602**  
**E. V. Echhawk LS**

