

OIL CONSERVATION COMMISSION
AZTEC DISTRICT

OIL CONSERVATION COMMISSION
BOX 2088
SANTA FE, NEW MEXICO

DATE Nov 12, 1975

RE: Proposed MC _____
Proposed DHC _____
Proposed NSL ✓ _____
Proposed SWD _____
Proposed WFX _____
Proposed PMX _____

Jim KAPTEINAH

Gentlemen:

I have examined the application dated Nov 5, 1975
for the Atlantic Richfield 4 wells as below
Operator Lease and Well No. Unit, S-T-R

and my recommendations are as follows:

Horseshoe Valley Unit #287 E-24-31N-17W
" " #288 A-25-31N-17W
" " #289 E-32-31N-16W
" " #290 N-33-31N-16W

approve all

Yours very truly,

AR Landrieu

Rocky Mountain District
1860 Lincoln St. — Suite 501
Denver, Colorado 80203
Telephone 303 573-4049

W. A. Walther, Jr.
District Production & Drilling
Superintendent

November 5, 1975



Mr. Joe D. Ramey, Secretary - Director
Oil Conservation Commission, State of New Mexico
P. O. Box 2088
Santa Fe, New Mexico 87501

Re: Horseshoe Gallup Unit
San Juan County, New Mexico

Dear Mr. Ramey:

Atlantic Richfield Company, Operator of the Horseshoe Gallup Unit, and pursuant Case No. 5236, Order No. R-2210-A, hereby requests administrative approval to drill four (4) infill Gallup formation producing wells at unorthodox locations. As set forth in Order No. R-2210-A, the following are enclosed:

1. (a) Copy of Certified Location Plat, each well.
(b) Copy of Application for Permit to Drill, each well.
(c) Map showing the Unit boundary, all existing wells, and location of the four (4) proposed wells.
2. Schematic drawing for each well, based on current information.

Atlantic Richfield Company is the Operator of all offset locations, therefore, notification to offset operators is not required.

Your administrative approval is respectfully requested.

Very truly yours,

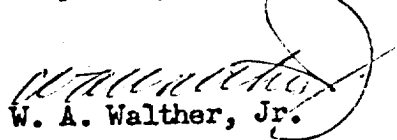
W. A. Walther, Jr.

Encls.

**NEW MEXICO OIL CONSERVATION COMMISSION
WELL LOCATION AND ACREAGE DEDICATION PLAT**

Form C-122
Supersedes C-128
Effective 1-1-65

All distances must be from the outer boundaries of the Section.

Operator Atlantic Richfield Company			Lease Horseshoe Gallup Unit		Well No. 290
Unit Letter M	Section 33	Township 31 North	Range 16 West	County San Juan	
Actual Footage Location of Well:					
312 feet from the South line and		323 feet from the West line			
Ground Level Elev. 5331	Producing Formation Gallup	Pool Horseshoe Gallup	Dedicated Acreage: NA - Unitized		

Re: Order R-2210-A

1. Outline the acreage dedicated to the subject well by colored pencil or hachure marks on the plat below.
2. If more than one lease is dedicated to the well, outline each and identify the ownership thereof (both as to working interest and royalty).
3. If more than one lease of different ownership is dedicated to the well, have the interests of all owners been consolidated by communitization, unitization, force-pooling, etc?

☒ Yes ☐ No If answer is "yes," type of consolidation **Unitization**

If answer is "no," list the owners and tract descriptions which have actually been consolidated. (Use reverse side of this form if necessary.) _____

No allowable will be assigned to the well until all interests have been consolidated (by communitization, unitization, forced-pooling, or otherwise) or until a non-standard unit, eliminating such interests, has been approved by the Commission.

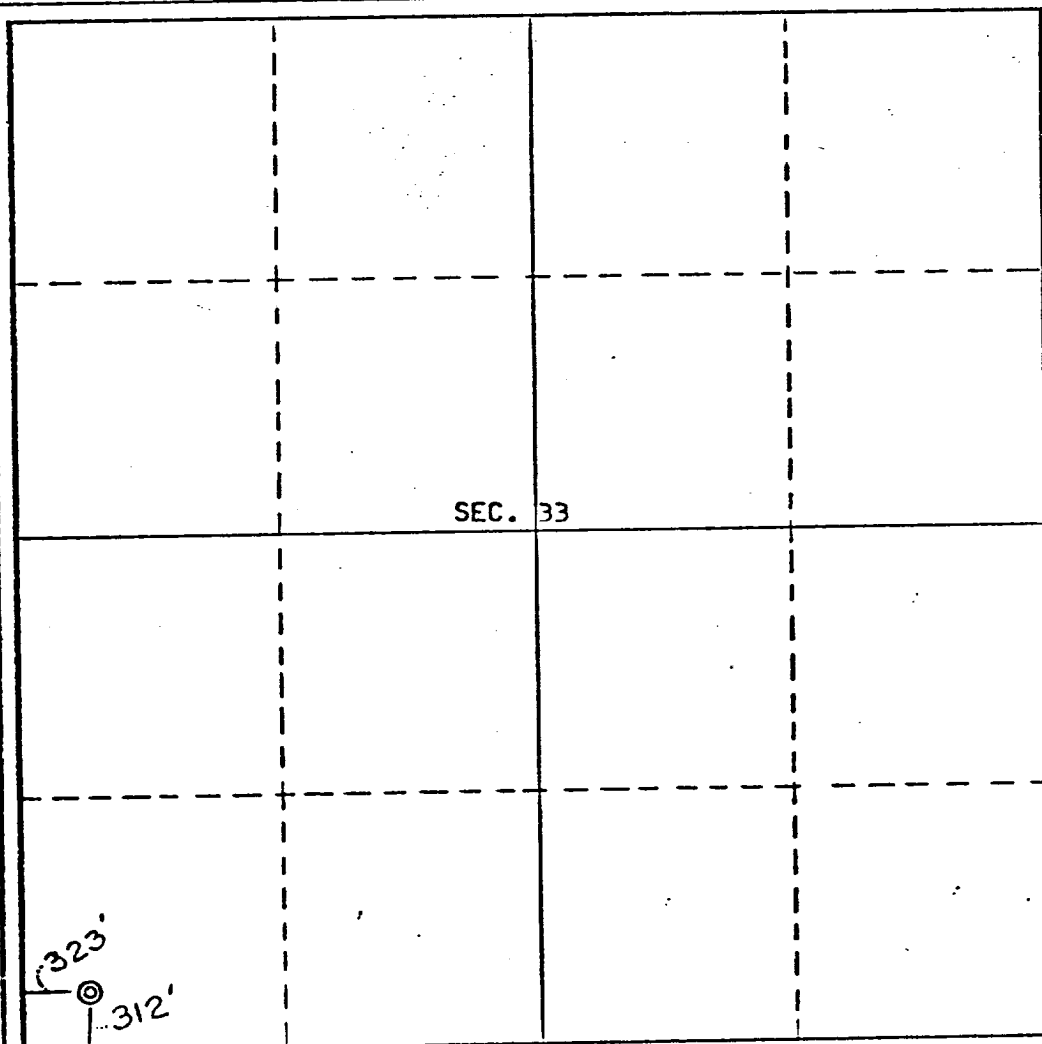

CERTIFICATION

I hereby certify that the information contained herein is true and complete to the best of my knowledge and belief.

Name *W. A. Walther, Jr.*
Position **W. A. Walther, Jr.**
Dist. Prod. & Drlg. Supt.
Company **ATLANTIC RICHFIELD COMPANY**
Date **Oct. 28, 1975**

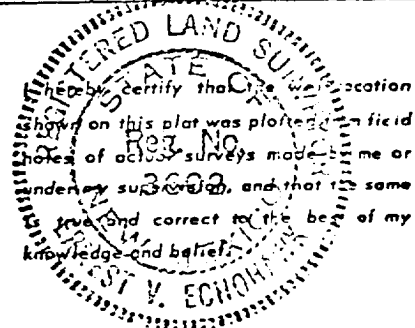

Date Surveyed
October 7, 1975
Registered Professional Engineer
and/or Land Surveyor

E. V. Echohawk

Certificate No. **3602**
E. V. Echohawk LS

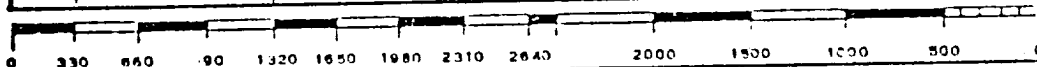

UNITED STATES
DEPARTMENT OF THE INTERIOR
GEOLOGICAL SURVEY

APPLICATION FOR PERMIT TO DRILL, DEEPEN, OR PLUG BACK

1. TYPE OF WORK

DRILL ☒

DEEPEN ☐

PLUG BACK ☐

2. TYPE OF WELL

OIL
WELL ☒

GAS
WELL ☐

OTHER

SINGLE
ZONE ☒

MULTIPLE
ZONE ☐

3. NAME OF OPERATOR

Atlantic Richfield Company

4. ADDRESS OF OPERATOR

501 Lincoln Tower Bldg., 1860 Lincoln St., Denver, Colo. 80203

5. LOCATION OF WELL (Report location clearly and in accordance with any State requirements.)

At surface

Unit "M" - 312' f/South and 323' f/West lines Sec. 33

At proposed prod. zone

Approx same

6. DISTANCE IN MILES AND DIRECTION FROM NEAREST TOWN OR POST OFFICE*

Approx 3 mi east and 10 mi NE from Shiprock, New Mexico

7. DISTANCE FROM PROPOSED*

LOCATION TO NEAREST
PROPERTY OR LEASE LINE, FT.
(Also to nearest drlg. unit line, if any)

312' f/Tr.12 line

8. DISTANCE FROM PROPOSED LOCATION*

TO NEAREST WELL, DRILLING, COMPLETED,
OR APPLIED FOR, ON THIS LEASE, FT.

570' f/#208

9. NO. OF ACRES IN LEASE

Tr.12 - 2644.14 Ac

Unit - 13,527.80 Ac

10. PROPOSED DEPTH

1310'

11. NO. OF ACRES ASSIGNED

TO THIS WELL

N/A - Unitized

12. ROTARY OR CABLE TOOLS

Rotary

13. ELEVATIONS (Show whether DF, RT, GR, etc.)

5331'

14. APPROX. DATE WORK WILL START*

When appl rec'd

Est. 11/5/75

15.

PROPOSED CASING AND CEMENTING PROGRAM

SIZE OF HOLE	SIZE OF CASING	WEIGHT PER FOOT	SETTING DEPTH	QUANTITY OF CEMENT
12-1/4"	8-5/8"	21#	120'	120 sx (Cmt to surface)
7-7/8"	5-1/2"	11#	T.D.	225 sx

Propose to drill well to depth sufficient to test the Gallup Formation. Est. tops are: Upper Gallup 1085'; Lower Gallup 1190'. Will set 8-5/8" OD casing at approx 120' and cement to surface; drill 7-7/8" hole to T.D. and log; if productive, set 5-1/2" casing w/ sufficient cement to protect all zones; productive zone(s) will be perforated, treated if necessary, and well completed.

Attachments: Certified Location Plat
Pertinent Drilling Information
Development Plan for Surface Use w/ att.

Re: New Mexico Oil Conservation Commission Order No. R-2210 and R-2210-A

IN ABOVE SPACE DESCRIBE PROPOSED PROGRAM: If proposal is to deepen or plug back, give data on present productive zone and proposed new productive zone. If proposal is to drill or deepen directionally, give pertinent data on subsurface locations and measured and true vertical depths. Give blowout preventer program, if any.

16.

SIGNED W. A. Walther, Jr.
(This space for Federal or State office use)

TITLE Dist. Prod. & Drlg. Supt. DATE 10/28/75

PERMIT NO. _____

APPROVAL DATE _____

APPROVED BY _____

TITLE _____ DATE _____

CONDITIONS OF APPROVAL, IF ANY:

Elevation 5331'

8-5/8" OD Casing set at 120' and cemented to surface

2-3/8" OD EUE tubing

Upper Gallup - Perforated as indicated from logs.

Lower Gallup - Perforated as indicated from logs.

5-1/2" OD casing set at total depth with sufficient
cement to protect all zones.

1310' Estimated total depth.

HORSESHOE GALLUP UNIT, WELL NO. 290
Unit "M" - 312' f/ South line and
323' f/ West line of
Section 33-31N-16W
San Juan County, New Mexico