

UNITED STATES
DEPARTMENT OF THE INTERIOR
GEOLOGICAL SURVEY

30-045-21951

APPLICATION FOR PERMIT TO DRILL, DEEPEN, OR PLUG BACK

1A. TYPE OF WORK

DRILL ☒DEEPEN ☐PLUG BACK ☐

B. TYPE OF WELL

OIL
WELL ☐GAS
WELL ☒

OTHER

SINGLE
ZONE ☒MULTIPLE
ZONE ☐

2. NAME OF OPERATOR

Koch Industries, Inc.

3. ADDRESS OF OPERATOR

P.O. Box 2256, Wichita, Kansas 67201

4. LOCATION OF WELL (Report location clearly and in accordance with any State requirements.)*

At surface

A 1140' FNL & 1050' FEL

NE NE

At proposed prod. zone

14. DISTANCE IN MILES AND DIRECTION FROM NEAREST TOWN OR POST OFFICE*

Approx. 15 miles NE of Bloomfield

15. DISTANCE FROM PROPOSED*

LOCATION TO NEAREST
PROPERTY OR LEASE LINE, FT.
(Also to nearest drlg. unit line, if any)

1050' FEL

16. NO. OF ACRES IN LEASE

277.56

17. NO. OF ACRES ASSIGNED
TO THIS WELL~~210.76~~ 138.86

18. DISTANCE FROM PROPOSED LOCATION*

TO NEAREST WELL, DRILLING, COMPLETED,
OR APPLIED FOR, ON THIS LEASE, FT.

appr. 160'

19. PROPOSED DEPTH

2900'

20. ROTARY OR CABLE TOOLS

Rotary

21. ELEVATIONS (Show whether DF, RT, GR, etc.)

6569' GR

22. APPROX. DATE WORK WILL START*

23.

PROPOSED CASING AND CEMENTING PROGRAM

SIZE OF HOLE	SIZE OF CASING	WEIGHT PER FOOT	SETTING DEPTH	QUANTITY OF CEMENT
8-3/4"	7"	26#	200'	150
6-1/4"	4 1/2"	10.5#	2900'	350

- Set SH 7" csg. tested to 3000# @ 200'. Cement w/enough to circ. to surface. WOC 24 hours.
 - Test csg. to 1000# & drill to appr. 1800' w/native mud. Mud up w/Gel-Benex type mud & drill through Pictured Cliffs. Run approx. 2900' of new 4 1/2" 10.5# CW-55 ST&C csg. Use enough cement to cover Ojo.
 - 8" LWP Shaeffer double pipe ram BOP's will be used. Check BOP's each tour & blind rams each trip.
 - Well head will be LP screw type - will not be used to frac through.
 - Mud program: 0-200' Gel-Lime Slurry, 200-1800' Water & Benex, 1800-2900' Gel-Spersene Mud.
 - Anticipated BHP @ TD max. of 1000#, no abnormal pressures anticipated.
 - Auxillary & BOP equipment on rig as follows: (A) Double ram BOP, (B) Kelly cocks (if required), (C) Rotating drilling head (if required), (D) Kill valve on rig floor.
 - Complete well by swabbing csg. dry. Perf Pictured Cliffs w/2HPF & Frac
- IN ABOVE SPACE DESCRIBE PROPOSED PROGRAM: If proposal is to deepen or plug back, give data on present productive zone and proposed new productive zone. If proposal is to drill or deepen directionally, give pertinent data on subsurface locations and measured and true vertical depths. Give blowout preventer program, if any. w/slick water & sand.

24.

SIGNED

Oswald L. Schmitt

TITLE

Operations Manager

DATE

11-25-75.

(This space for Federal or State office use)

PERMIT NO.

APPROVAL DATE

APPROVED BY

TITLE

CONDITIONS OF APPROVAL, IF ANY:

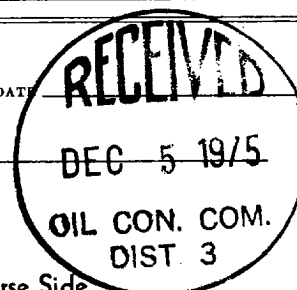
O'Neil

*See Instructions On Reverse Side

**NEW MEXICO OIL CONSERVATION COMMISSION
WELL LOCATION AND ACREAGE DEDICATION PLAT**

Form C-102
Supersedes C-128
Effective 1-1-65

All distances must be from the outer boundaries of the Section.

Operator KOCH EXPLORATION COMPANY			Lease WALKER		Well No. 5
Unit Letter A	Section 13	Township 31 NORTH	Range 10 WEST	County SAN JUAN	
Actual Footage Location of Well: 1140 feet from the NORTH line and 1050 feet from the EAST line					
Ground Level Elev. 6569	Producing Formation Pictured Cliffs	Pool Blanco	Dedicated Acreage: Ext 138.86		Acres

1. Outline the acreage dedicated to the subject well by colored pencil or hachure marks on the plat below.
2. If more than one lease is dedicated to the well, outline each and identify the ownership thereof (both as to working interest and royalty).
3. If more than one lease of different ownership is dedicated to the well, have the interests of all owners been consolidated by communitization, unitization, force-pooling, etc?

☐ Yes ☐ No If answer is "yes," type of consolidation _____

If answer is "no," list the owners and tract descriptions which have actually been consolidated. (Use reverse side of this form if necessary.) _____

No allowable will be assigned to the well until all interests have been consolidated (by communitization, unitization, forced-pooling, or otherwise) or until a non-standard unit, eliminating such interests, has been approved by the Commission.

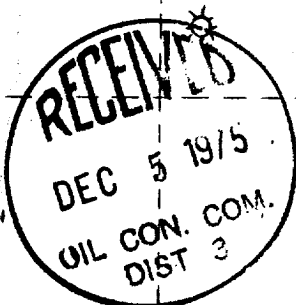
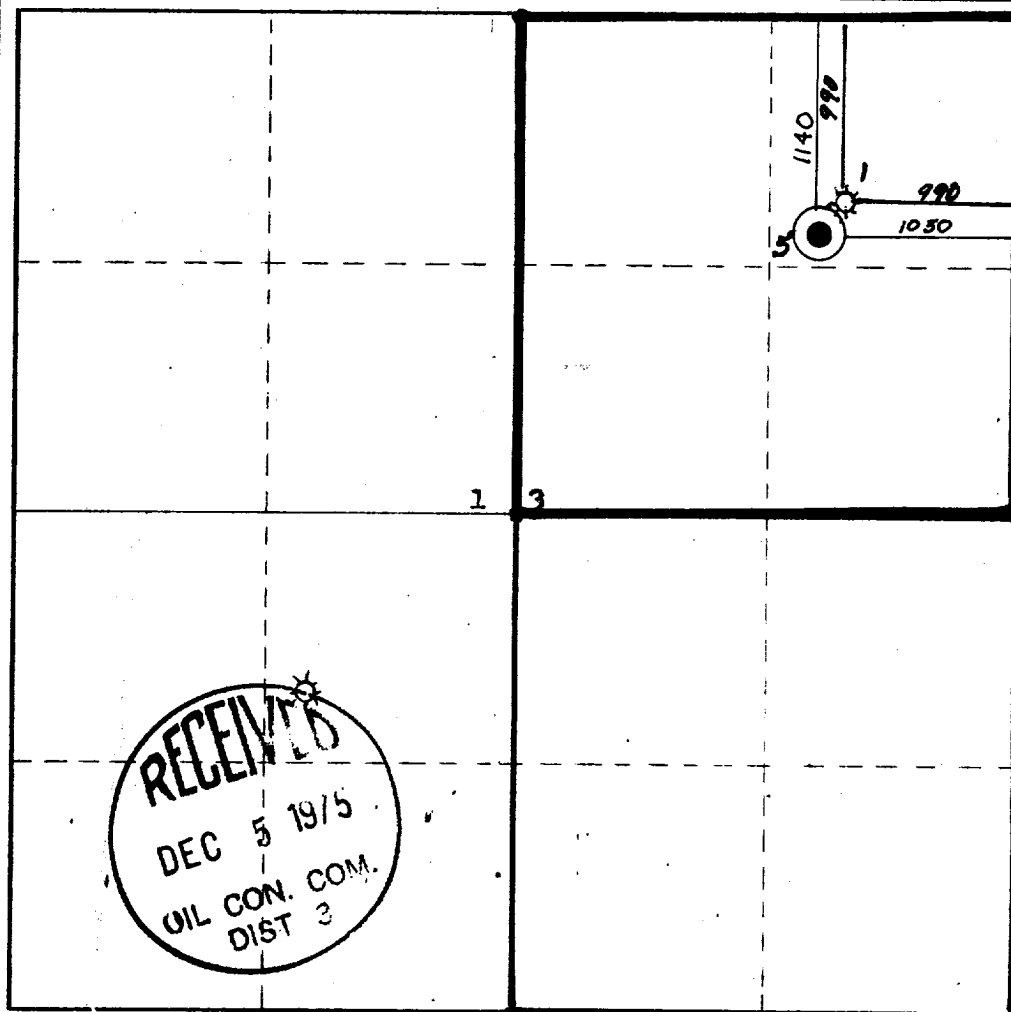

CERTIFICATION

I hereby certify that the information contained herein is true and complete to the best of my knowledge and belief.

Dwaine L. Schmit

Name
Operations Manager
Position
Koch Industries Inc.
Company

November 25, 1975
Date

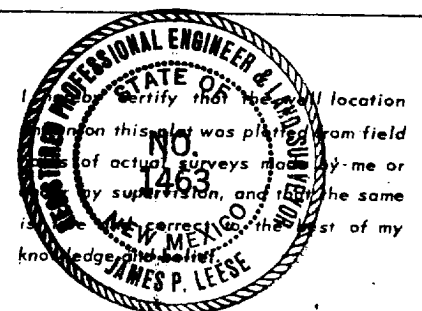

Date Surveyed
20 November, 1975

Registered Professional Engineer
and/or Land Surveyor

Dwaine L. Schmit

Certificate No.

Development Plan for Surface Use
WALKER NO. 5

1. Existing Roads: (Exhibit "A")
Equipment and personnel will utilize U.S. Highway 550 approx. 4 miles west of the location. The existing exit from the highway will be used.
2. Planned Access Roads: (Exhibit "A")
Location falls near existing lease road. Very little, if any new road will have to be built.
3. Location of Existing Wells:
The proposed well is appr. 160' SW of the Walker # 1.
4. Lateral Roads to Well Location: (Exhibit "A")
See attached map - Exhibit "A".
5. Location of Tank Battery and Flow Line:
None required.
6. Location and Type of Water Supply:
The source water to be used in the drilling operation will be from the irrigation ditch on U.S. Highway 550 appr. 4 miles west of the proposed location. Water will be hauled by trucks.
7. Waste Disposal:
The drilling contractor will furnish a metal toilet. Cuttings, metal, wire, etc. that will not burn will either be buried or hauled off the location.
8. Location of Camps:
No camps are anticipated.
9. Location of Airstrips:
None required.
10. Location Layout: (Exhibit "B")
Will spot the small mobile rig in the most convenient manner on a compacted drilling pad. No particular terrain or drainage problem anticipated.
11. Plans for Restoration of the Surface:
A minimum amount of the area will be disturbed to build the location. Upon completion of drilling, the area will be leveled and the pits either fenced or filled as soon as the rig is moved. All areas not needed in producing operations will be seeded with a grass mixture of five pounds crested wheat grass, five pounds intermediate wheat grass and three pounds nomad alfalfa to each acre. The planting will be done when conditions are favorable.
12. General Description of the Topography, Vegetation and Other Aspects of the Area:
Area is rocky, but relatively flat with large amount of sage brush with few pinon trees.

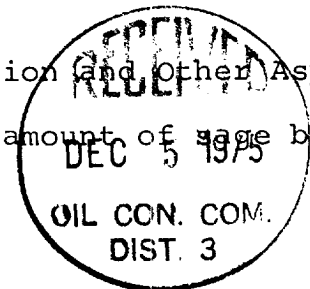

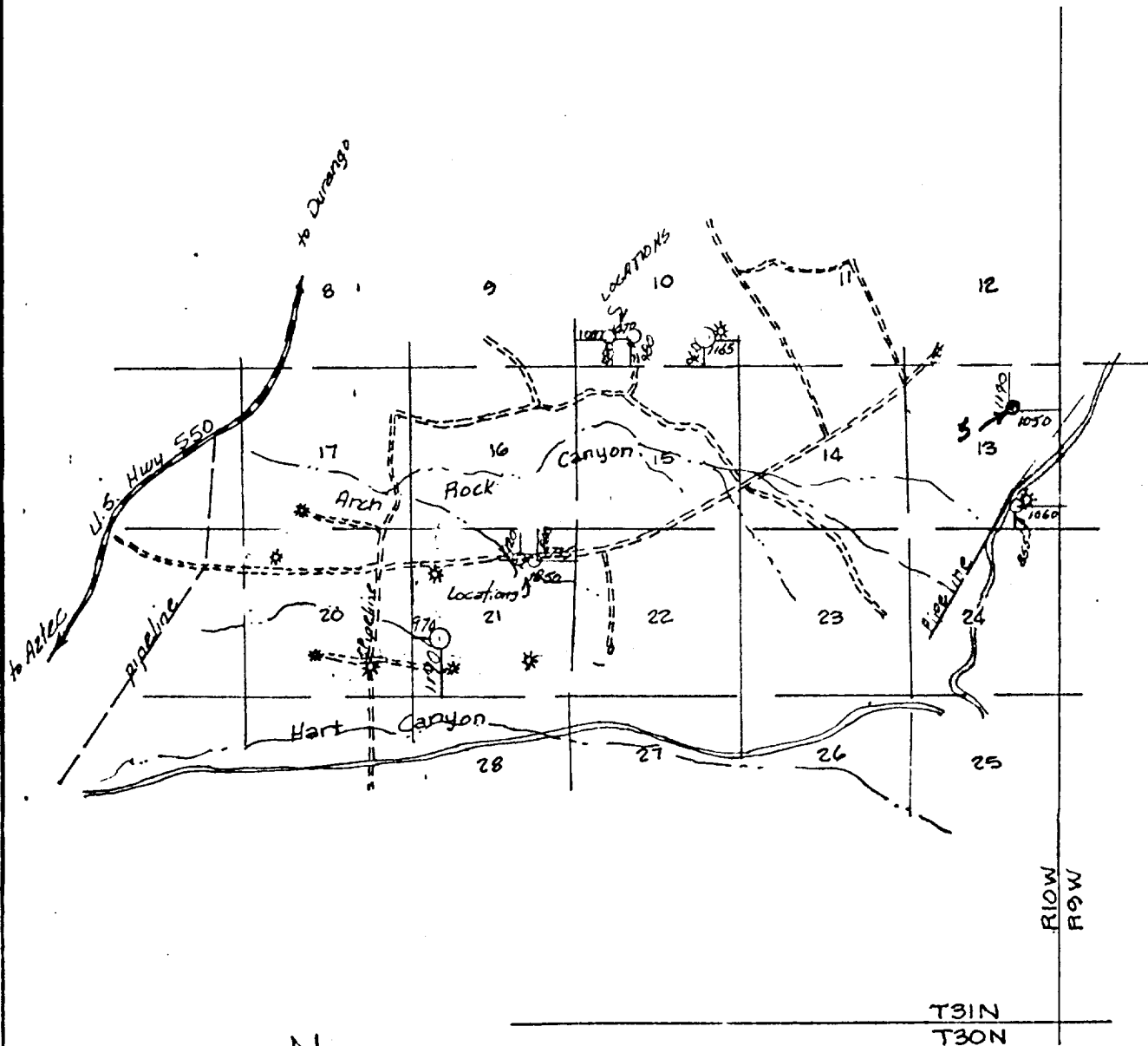

Exhibit "A"

VICINITY MAP
FOR

KOCH EXPLORATION CO.

Well located in

SE/4 & NE/4 Sec. 13, & NE/4 Sec. 21,

& SW/4 Sec. 10, T31N, R10W, N.M.P.M.,
San Juan Co., New Mex. Scale: 1" = 1 mile

San Juan Engineering Co.
Farmington, New Mexico



EXHIBIT "B"

WALKER NO. 5
NE NE Sec. 13-31N-10W
San Juan County, New Mexico

