

UNITED STATES  
DEPARTMENT OF THE INTERIOR  
GEOLOGICAL SURVEY

## APPLICATION FOR PERMIT TO DRILL, DEEPEN, OR PLUG BACK

## 1a. TYPE OF WORK

DRILL ☒DEEPEN ☐PLUG BACK ☐

## b. TYPE OF WELL

OIL  
WELL ☐GAS  
WELL ☒

OTHER

SINGLE  
ZONE ☐MULTIPLE  
ZONE ☒

## 2. NAME OF OPERATOR

Kimbark Operating Company and Ladd Petroleum

## 3. ADDRESS OF OPERATOR

1860 Lincoln Street, Suite 808, Denver, Colorado 80203

## 4. LOCATION OF WELL (Report location clearly and in accordance with any State requirements.)\*

At surface

G SW NE 1850' FNL, 1690' FEL

At proposed prod. zone

## 14. DISTANCE IN MILES AND DIRECTION FROM NEAREST TOWN OR POST OFFICE\*

## 15. DISTANCE FROM PROPOSED\*

LOCATION TO NEAREST  
PROPERTY OR LEASE LINE, FT.  
(Also to nearest drig. unit line, if any)

950

18. DISTANCE FROM PROPOSED LOCATION\*  
TO NEAREST WELL, DRILLING, COMPLETED,  
OR APPLIED FOR, ON THIS LEASE, FT.

1/4 sec

## 21. ELEVATIONS (Show whether DF, RT, GR, etc.)

6256 G.L.

## 16. NO. OF ACRES IN LEASE

320

## 19. PROPOSED DEPTH

7700' Dak.

## 17. NO. OF ACRES ASSIGNED

MV ~~to this well~~ Dak - 320

## 20. ROTARY OR CABLE TOOLS

Rotary

## 22. APPROX. DATE WORK WILL START\*

January 20, 1976

## 23.

## PROPOSED CASING AND CEMENTING PROGRAM

SIZE OF HOLE	SIZE OF CASING	WEIGHT PER FOOT	SETTING DEPTH	QUANTITY OF CEMENT
15"	10 3/4"	40.5#	150'	Circ.
<del>9 7/8"</del>	<del>9 5/8"</del> 7 7/8"	26.4	3200'	250 sxs
6 3/4"	5 1/2"	15.5-17#	7700'	400 sxs

1. This is a proposed Dakota-Mesaverde dual.

2. Operator will maintain and test proper B.O.P. equipment.



RECEIVED

DEC 22 1975

U. S. GEOLOGICAL SURVEY  
WASHINGTON, D. C.

IN ABOVE SPACE DESCRIBE PROPOSED PROGRAM: If proposal is to deepen or plug back, give data on present productive zone and proposed new productive zone. If proposal is to drill or deepen directionally, give pertinent data on subsurface locations and measured and true vertical depths. Give blowout preventer program, if any.

24.

SIGNATURE Walter K. ArbuckleTITLE PresidentDATE 12/19/75

(This space for Federal or State office use)

PERMIT NO.

APPROVAL DATE

APPROVED BY

TITLE

DATE

CONDITIONS OF APPROVAL, IF ANY:

\*See Instructions On Reverse Side

NEW MEXICO OIL CONSERVATION COMMISSION  
WELL LOCATION AND ACREAGE DEDICATION FLAT

Form C-102  
Supersedes C-128  
Effective 1-1-65

All distances must be from the outer boundaries of the Section.

Operator <b>KIMBARK OPERATING COMPANY</b>		Lease <b>HORTON</b>		Well No. <b>1A</b>
Unit Letter <b>G</b>	Section <b>7</b>	Township <b>31 NORTH</b>	Range <b>11 WEST</b>	County <b>SAN JUAN</b>

Actual Location of Well:

<b>1850</b>	feet from the	<b>NORTH</b>	line and	<b>1690</b>	feet from the	<b>EAST</b>	line	
Ground Level Elev. <b>6256</b>	Producing Formation <b>MESA VERDE-DAKOTA</b>		Pool <b>Blanco E Basin</b>		Dedicated Acreage: <b>320</b>			Acres

1. Outline the acreage dedicated to the subject well by colored pencil or hatchure marks on the plat below.
2. If more than one lease is dedicated to the well, outline each and identify the ownership thereof (both as to working interest and royalty).
3. If more than one lease of different ownership is dedicated to the well, have the interests of all owners been consolidated by communitization, unitization, force-pooling, etc?

☐ Yes ☐ No If answer is "yes," type of consolidation \_\_\_\_\_

If answer is "no," list the owners and tract descriptions which have actually been consolidated. (Use reverse side of this form if necessary.) \_\_\_\_\_

No allowable will be assigned to the well until all interests have been consolidated (by communitization, unitization, forced-pooling, or otherwise) or until a non-standard unit, eliminating such interests, has been approved by the Commission.

RECEIVED

DEC 23 1975

OIL CON. COM.  
DIST. 3

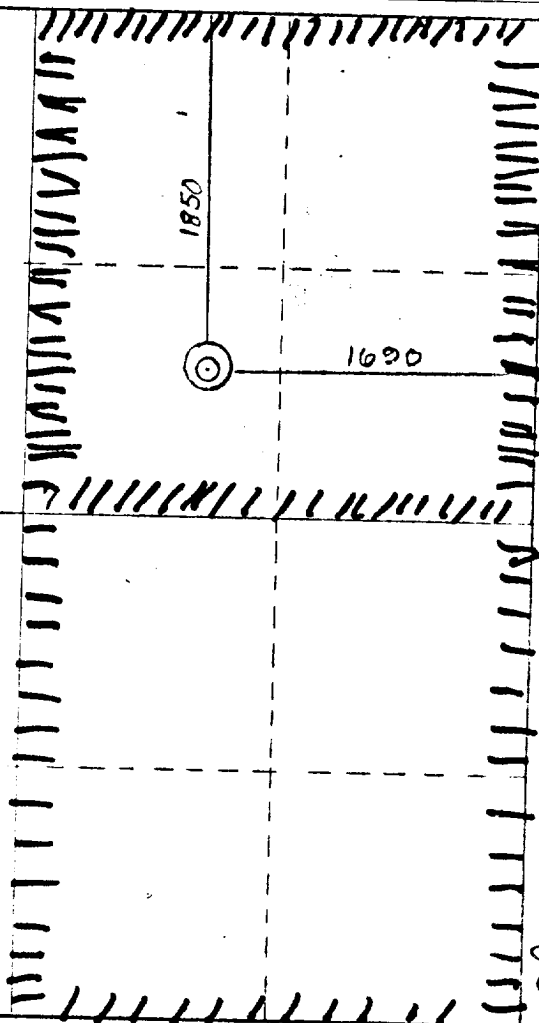

CERTIFICATION

I hereby certify that the information contained herein is true and complete to the best of my knowledge and belief.

Name  
**Walter K. Arbuckle**  
Position  
**President**  
Company  
**Kimbark Operating Co.**  
Date  
**12/19/75**

**Dakota**  
I hereby certify that the well location shown on this plat was plotted from notes of actual surveys made by me or under my supervision, and that the same is true and correct to the best of my knowledge and belief.

10 December 1975

**James P. Leese**  
James P. Leese

Certificate No.

1463