

El Paso NATURAL GAS
COMPANY

P. O. BOX 990
FARMINGTON, NEW MEXICO 87401
PHONE: 505-325-2841

January 27, 1976

Mr. Jerry Long
U. S. Geological Survey
Post Office Box 1809
Durango, Colorado 81301

Re: Application for Permit to Drill
Pinon Mesa C #2
NESE Section 24, T-31-N, R-14-W
Basin Dakota

Dear Mr. Long:

Details regarding existing roads, pipelines, wells, etc. relative to the above well location are included on the previously submitted base maps, "Field Road Map" and "Composite Map No. 1".

The proposed new well location, new roads and new pipeline are shown on the attached plat along with connecting existing roads and pipelines in the vicinity of the proposed new well.

Water for drilling and completion operations will be obtained from a water hole located in: EPNG's San Juan River Plant. Waste material will be disposed of by burial in the burn pit, latrine, or reserve pit as applicable. There will be no camp nor air strip associated with drilling this well. Upon completion or abandonment of this well, the location will be cleaned and leveled and a dry hole marker placed, if applicable.

Yours very truly,

D. G. Brisco

D. G. Brisco
Drilling Clerk

JAN 28 1976

DGB:pb

att.

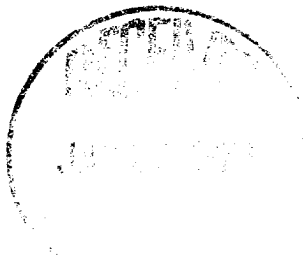

LOCATION AND EQUIPMENT LAY-OUT

Pinon Mesa C #2

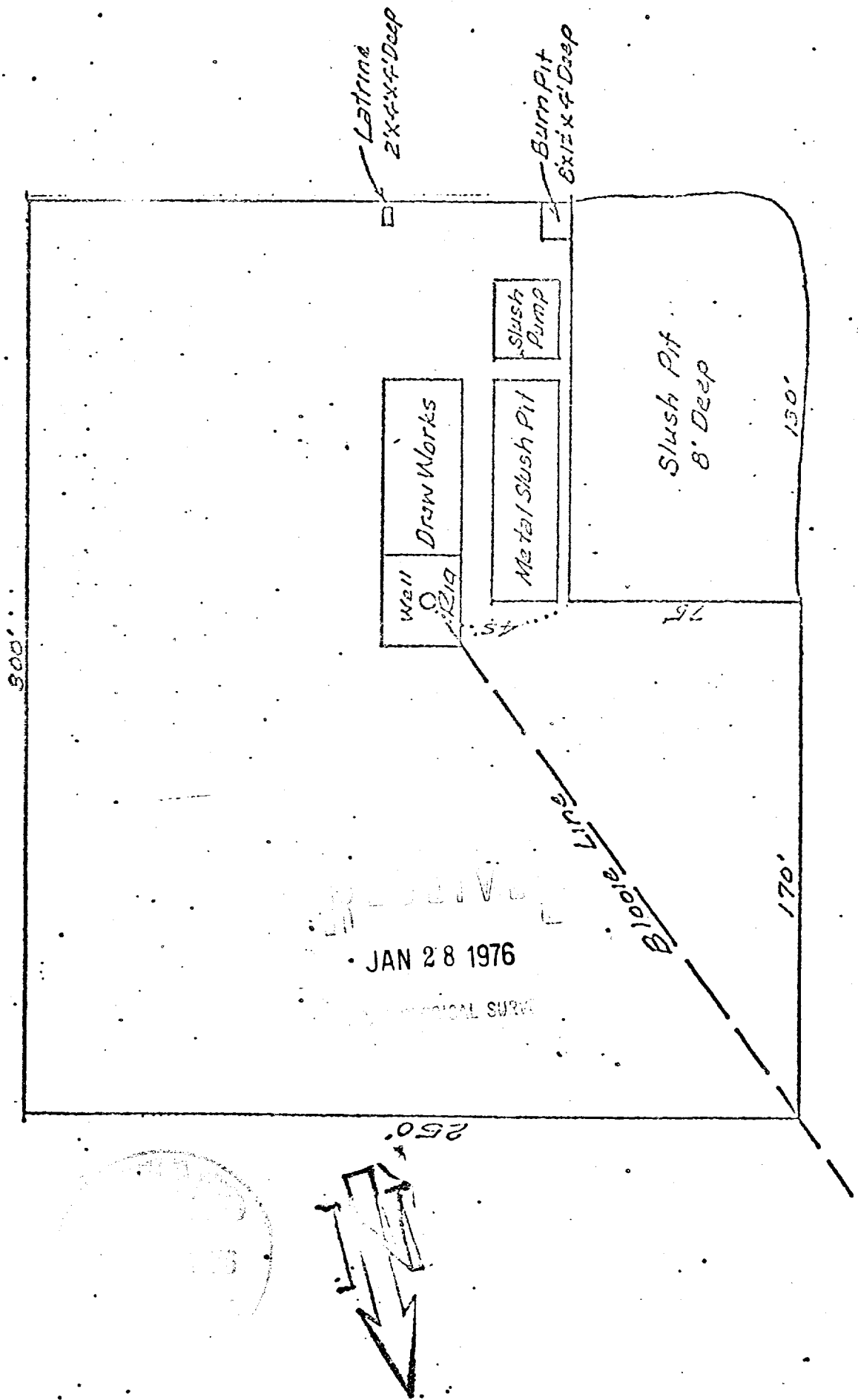

Linon Mesa C #2
NE 1/4 Sec. 24, T-31-N, R-14-W

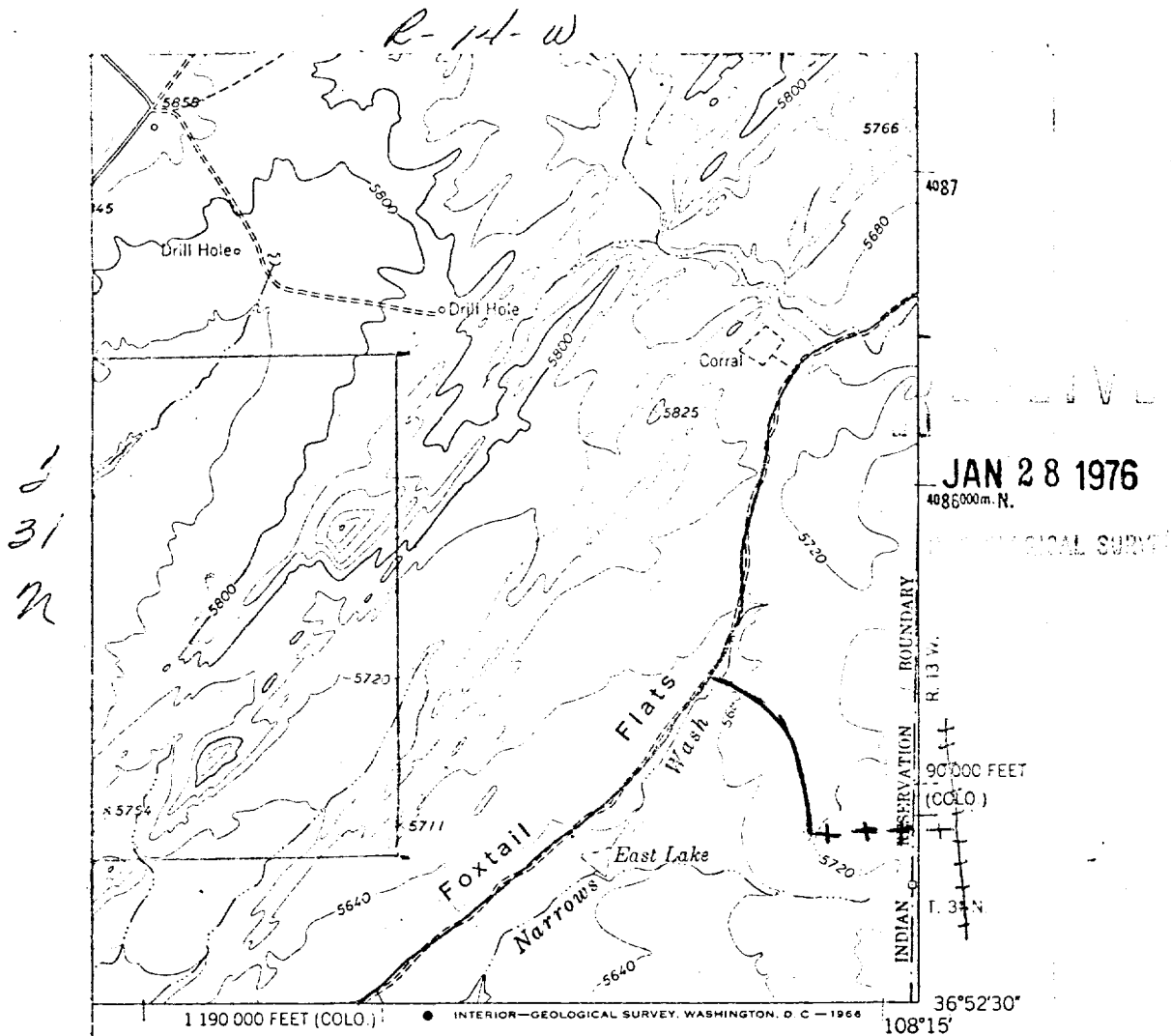

ROAD CLASSIFICATION

Light-duty ———— Unimproved dirt =====

LEGEND OF RIGHT-OF-WAYS

EXISTING ROADS	—————
EXISTING PIPELINES	+++++
EXISTING ROAD & PIPELINE	—+—+—
PROPOSED ROADS	—————
PROPOSED PIPELINES	+++++
PROPOSED ROAD & PIPELINE	—+—+—