

UNITED STATES  
DEPARTMENT OF THE INTERIOR  
GEOLOGICAL SURVEY

5. LEASE DESIGNATION AND SERIAL NO.

SF 078604

6. IF INDIAN, ALLOTTEE OR TRIBE NAME

7. UNIT AGREEMENT NAME

8. FARM OR LEASE NAME

Scott

9. WELL NO.

2A

10. FIELD AND POOL, OR WILDCAT

Blanco Mesa Verde

11. SEC., T., R., M., OR BLK.  
AND SURVEY OR AREA

Sec. 31, T-32-N, R-10

NMDM

12. COUNTY OR PARISH

San Juan NM

13. STATE

318.46

20. ROTARY OR CABLE TOOLS

Rotary

22. APPROX. DATE WORK WILL START\*

1a. TYPE OF WORK

DRILL ☒DEEPEN ☐PLUG BACK ☐

b. TYPE OF WELL

OIL  
WELL ☐GAS  
WELL ☒

OTHER

SINGLE  
ZONE ☒MULTIPLE  
ZONE ☐

2. NAME OF OPERATOR

El Paso Natural Gas Company

3. ADDRESS OF OPERATOR

PO Box 990, Farmington, NM 87401

4. LOCATION OF WELL (Report location clearly and in accordance with any State requirements.)\*

At surface

1650'S, 980'E

At proposed prod. zone

14. DISTANCE IN MILES AND DIRECTION FROM NEAREST TOWN OR POST OFFICE\*

15. DISTANCE FROM PROPOSED\*

LOCATION TO NEAREST  
PROPERTY OR LEASE LINE, FT.  
(Also to nearest drlg. unit line, if any)

16. NO. OF ACRES IN LEASE

17. NO. OF ACRES ASSIGNED  
TO THIS WELL18. DISTANCE FROM PROPOSED LOCATION\*  
TO NEAREST WELL, DRILLING, COMPLETED,  
OR APPLIED FOR, ON THIS LEASE, FT.

19. PROPOSED DEPTH

5380'

21. ELEVATIONS (Show whether DF, RT, GR, etc.)

5998'GR

23.

## PROPOSED CASING AND CEMENTING PROGRAM

SIZE OF HOLE	SIZE OF CASING	WEIGHT PER FOOT	SETTING DEPTH	QUANTITY OF CEMENT
13 3/4"	9 5/8"	32.3#	200'	224 cu.ft. to circ. to surf.
8 3/4"	7"	20.0#	3160'	459 cu.ft. to cover Ojo Alar
6 1/4"	4 1/2"	10.5#	3010-5380'	413 cu.ft. to fill to 3010'

Selectively perforate and sandwater fracture the Mesa Verde formation.

A 3000 psi WP and 6000 psi test double gate preventer equipped with blind and pipe rams will be used for blow out prevention on this well.

The E/2 of Section 31 is dedicated to this well.

RECEIVED

JAN 28 1976

U. S. GEOLOGICAL SURVEY

IN ABOVE SPACE DESCRIBE PROPOSED PROGRAM: If proposal is to deepen or plug back, give data on present productive zone and proposed new productive zone. If proposal is to drill or deepen directionally, give pertinent data on subsurface locations and measured and true vertical depths. Give blowout preventer program, if any.

24.

SIGNED

W. G. Duce

TITLE

Drilling Clerk

DATE 1-27-76

(This space for Federal or State office use)

PERMIT NO.

APPROVAL DATE

APPROVED BY

TITLE

DATE

CONDITIONS OF APPROVAL, IF ANY:

Okel

**NEW MEXICO OIL CONSERVATION COMMISSION  
WELL LOCATION AND ACREAGE DEDICATION PLAT**

Form C-102  
Supersedes C-128  
Effective 1-1-65

All distances must be from the outer boundaries of the Section.

Operator <b>EL PASO NATURAL GAS COMPANY</b>			Lease <b>SCOTT (SF-078604)</b>		Well No. <b>2A</b>
Unit Letter <b>I</b>	Section <b>31</b>	Township <b>32-N</b>	Range <b>10-W</b>	County <b>SAN JUAN</b>	
Actual Footage Location of Well: <div style="display: flex; justify-content: space-between;"> <span><b>1650</b> feet from the <b>SOUTH</b> line and</span> <span><b>980</b> feet from the <b>EAST</b> line</span> </div>					
Ground Level Elev. <b>5998</b>	Producing Formation <b>MESA VERDE</b>	Pool <b>BLANCO MESA VERDE</b>		Dedicated Acreage: <div style="display: flex; align-items: center;"> <span><del>320.00</del></span> <span style="margin-left: 10px;"><b>318.46</b> Acres</span> </div>	

1. Outline the acreage dedicated to the subject well by colored pencil or hachure marks on the plat below.
2. If more than one lease is dedicated to the well, outline each and identify the ownership thereof (both as to working interest and royalty).
3. If more than one lease of different ownership is dedicated to the well, have the interests of all owners been consolidated by communitization, unitization, force-pooling, etc?

☐ Yes    ☐ No    If answer is "yes," type of consolidation \_\_\_\_\_

If answer is "no," list the owners and tract descriptions which have actually been consolidated. (Use reverse side of this form if necessary.) \_\_\_\_\_

No allowable will be assigned to the well until all interests have been consolidated (by communitization, unitization, forced-pooling, or otherwise) or until a non-standard unit, eliminating such interests, has been approved by the Commission.

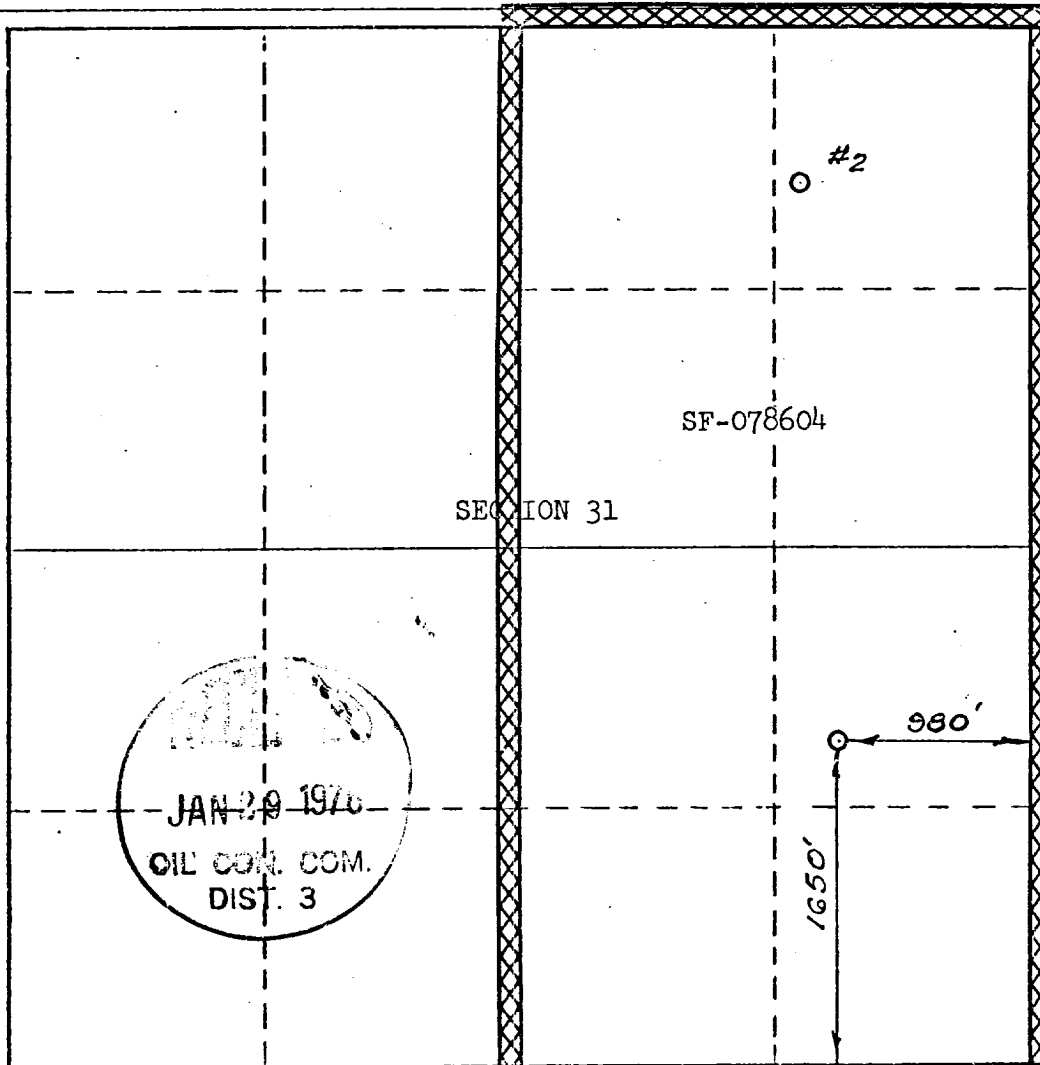

**CERTIFICATION**

*I hereby certify that the information contained herein is true and complete to the best of my knowledge and belief.*

Original Signed by  
**D. G. Brien**

Name

**Drilling Clerk**  
Position

**El Paso Natural Gas Co.**  
Company

**January 27, 1976**  
Date

*I hereby certify that the well location shown on this plat was plotted from field notes of actual surveys made by me or under my supervision, and that the same is true and correct to the best of my knowledge and belief.*

Date Surveyed  
**JANUARY 6, 1976**

Registered Professional Engineer  
and/or Land Surveyor

Certificate No. **1760**

0 330 660 990 1320 1650 1980 2310 2640 2970 3300 3630 3960 4290 4620 4950 5280 5610 5940 6270 6600

# LOCATION AND EQUIPMENT LAY-OUT

Scot #2A

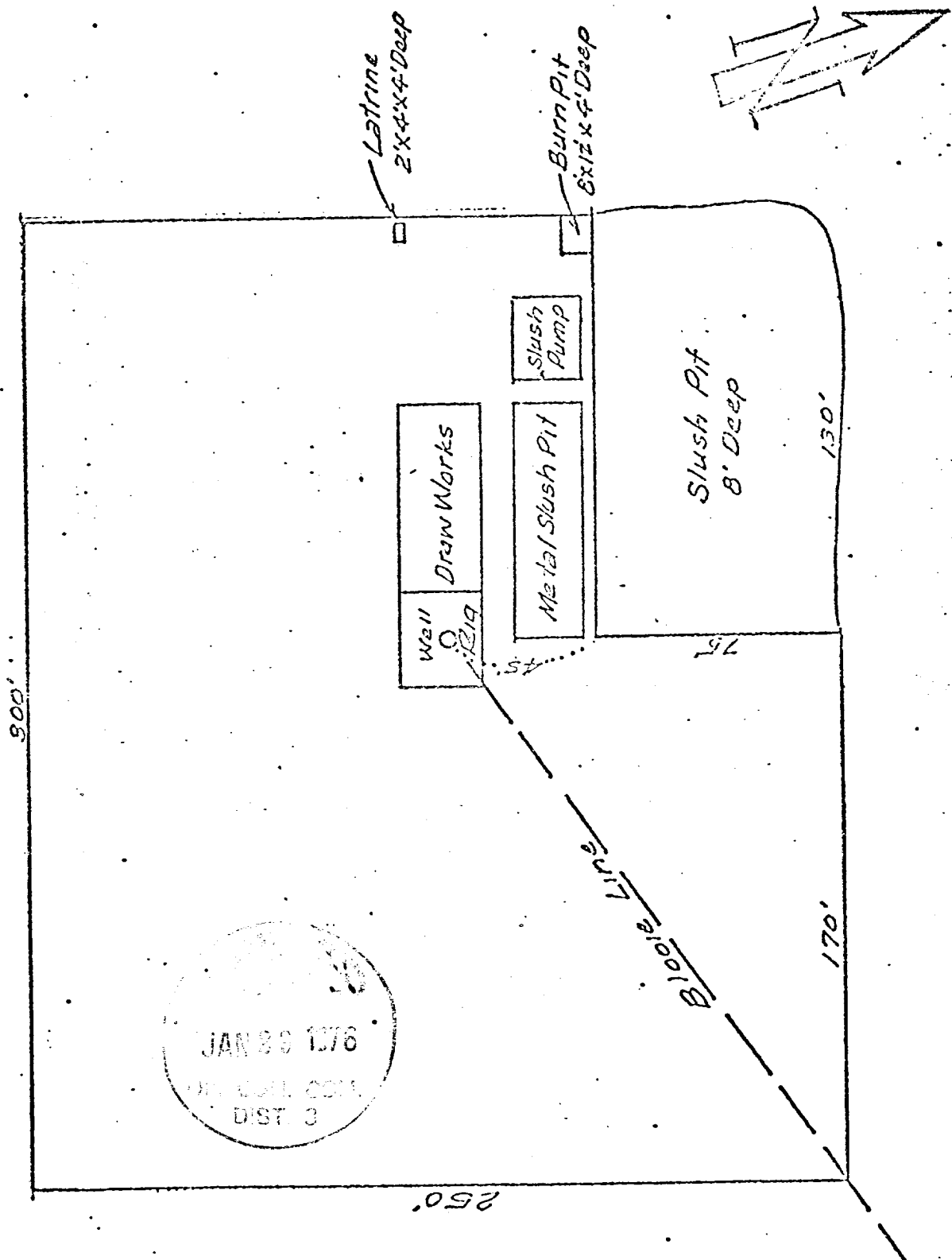

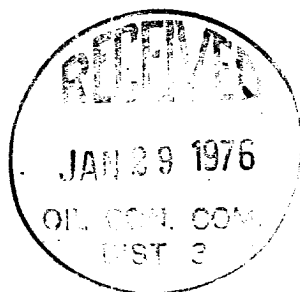
[illegible]

EXISTING ROADS	_____
EXISTING PIPELINES	++ ++
EXISTING ROAD & PIPELINE	++++
PROPOSED ROADS	_____
PROPOSED PIPELINES	+ + + +
PROPOSED ROAD & PIPELINE	++++

**El Paso** NATURAL GAS  
COMPANY

P. O. BOX 990  
FARMINGTON, NEW MEXICO 87401  
PHONE: 505-325-2841

**RECEIVED**

JAN 28 1976

U. S. GEOLOGICAL SURVEY  
FARMINGTON, N. M.

January 27, 1976

Mr. P. T. McGrath  
U. S. Geological Survey  
Post Office Box 959  
Farmington, New Mexico 87401

Re: Application for Permit to Drill  
Scott #2A  
NESE Section 31, T-32-N, R-10-W  
Blanco Mesa Verde

Dear Mr. McGrath:

Details regarding existing roads, pipelines, wells, etc.  
relative to the above well location are included on the  
previously submitted base maps, "Field Road Map" and  
"Composite Map No. 1".

The proposed new well location, new roads and new pipeline  
are shown on the attached plat along with connecting existing  
roads and pipelines in the vicinity of the proposed new well.

Water for drilling and completion operations will be obtained  
from the following location: Graves Atterbury Irrigation Ditch  
in Section 4, T-31-N, R-10-W.

Waste material will be disposed of by burial in the burn pit,  
latrine, or reserve pit as applicable. There will be no camp  
nor air strip associated with drilling this well. Upon  
completion or abandonment of this well, the location will be  
cleaned and leveled and a dry hole marker placed, if applicable.

Yours very truly,

*D. G. Brisco*

D. G. Brisco  
Drilling Clerk



pb