

UNITED STATES
DEPARTMENT OF THE INTERIOR
GEOLOGICAL SURVEY

APPLICATION FOR PERMIT TO DRILL, DEEPEN, OR PLUG BACK

1a. TYPE OF WORK

DRILL ☒DEEPEN ☐PLUG BACK ☐

b. TYPE OF WELL

OIL
WELL ☐GAS
WELL ☒

OTHER

SINGLE
ZONE ☒MULTIPLE
ZONE ☐

2. NAME OF OPERATOR

El Paso Natural Gas Company

3. ADDRESS OF OPERATOR

PO Box 990, Farmington, NM 87401

4. LOCATION OF WELL (Report location clearly and in accordance with any State requirements.*)

At surface

800'S, 600'E

At proposed prod. zone

14. DISTANCE IN MILES AND DIRECTION FROM NEAREST TOWN OR POST OFFICE*

30-045-21999

15. DISTANCE FROM PROPOSED*

LOCATION TO NEAREST
PROPERTY OR LEASE LINE, FT.
(Also to nearest drig. unit line, if any)

16. NO. OF ACRES IN LEASE

17. NO. OF ACRES ASSIGNED
TO THIS WELL

320

18. DISTANCE FROM PROPOSED LOCATION*
TO NEAREST WELL, DRILLING, COMPLETED,
OR APPLIED FOR, ON THIS LEASE, FT.

19. PROPOSED DEPTH

6556'

20. ROTARY OR CABLE TOOLS

Rotary

21. ELEVATIONS (Show whether DF, RT, GR, etc.)

5681'GR

22. APPROX. DATE WORK WILL START*

23.

PROPOSED CASING AND CEMENTING PROGRAM

SIZE OF HOLE	SIZE OF CASING	WEIGHT PER FOOT	SETTING DEPTH	QUANTITY OF CEMENT
12 1/4"	8 5/8"	24.0#	200'	164 cu.ft. to circ.
7 7/8"	4 1/2"	10.5#	6556'	1315 cu.ft. - 3 stages

1st stage cement - 317 cu.ft. to cover Gallup formation.

2nd stage cement - 425 cu.ft. to cover Mesa Verde formation.

3rd stage cement - 573 cu.ft. to circulate to surface.

Selectively perforate and sandwater fracture the Dakota formation.

A 3000 psi WP and 6000 psi test double gate preventer equipped with
blind and pipe rams will be used for blow out prevention on this well.

The E/2 of Section 13 is dedicated to this well.

IN ABOVE SPACE DESCRIBE PROPOSED PROGRAM: If proposal is to deepen or plug back, give data on present productive zone and proposed new productive zone. If proposal is to drill or deepen directionally, give pertinent data on subsurface locations and measured and true vertical depths. Give blowout preventer program, if any.

24.

SIGNED

A. G. Duice

TITLE

Drilling Clerk

DATE

January 26, 1976

(This space for Federal or State office use)

PERMIT NO.

APPROVAL DATE

APPROVED BY

TITLE

DATE

CONDITIONS OF APPROVAL, IF ANY:

All distances must be from the outer boundaries of the Section.

Operator EL PASO NATURAL GAS COMPANY		Lease PINON MESA D		UTE. MTN. TRIBAL MOO-C-1420-0623		Well No. 2	
Unit Letter P	Section 13	Township 31-N	Range 14-W	County SAN JUAN			
Actual Well Location of Well: 800 feet from the SOUTH line and 600 feet from the EAST line							
Ground Level Elev. 5681	Producing Formation DAKOTA		Pool BASIN DAKOTA		Dedicated Acreage: 320.00 Acres		

1. Outline the acreage dedicated to the subject well by colored pencil or hachure marks on the plat below.
2. If more than one lease is dedicated to the well, outline each and identify the ownership thereof (both as to working interest and royalty).
3. If more than one lease of different ownership is dedicated to the well, have the interests of all owners been consolidated by communitization, unitization, force-pooling, etc?

☐ Yes ☐ No If answer is "yes," type of consolidation _____

If answer is "no," list the owners and tract-descriptions which have actually been consolidated. (Use reverse side of this form if necessary.) _____

No allowable will be assigned to the well until all interests have been consolidated (by communitization, unitization, forced-pooling, or otherwise) or until a non-standard unit, eliminating such interests, has been approved by the Commission. NOTE: THIS PLAT HAS BEEN REISSUED TO REFLECT A MOVED LOCATION. 1-19

NOTE: THIS PLAT IS REISSUED TO SHOW TERRAIN IN LOCATION AREA. 1-22-76

SECTION 13

UTE. MTN. TRIBAL
MOO-C-1420-0623

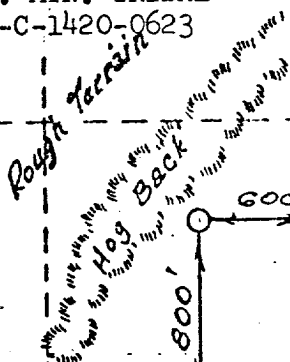
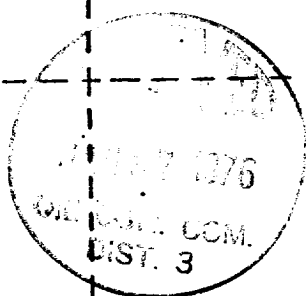

CERTIFICATE

I hereby certify that the information contained herein is true and complete to the best of my knowledge and belief.
Original Signature
D. C. Erison

Name
Drilling Clerk
Position
El Paso Natural Gas Co.
Company
January 26, 1976
Date

I hereby certify that the well location shown on this plat was plotted from field notes of actual surveys made by me or under my supervision, and that the same is true and correct to the best of my knowledge and belief.

Date Surveyed
JULY 7, 1975 1-12-76

Registered Professional Engineer
and/or Land Surveyor

Drill Clerk
Certificate No. **1760**

LOCATION AND EQUIPMENT LAY-OUT Pinon Mesa D #2

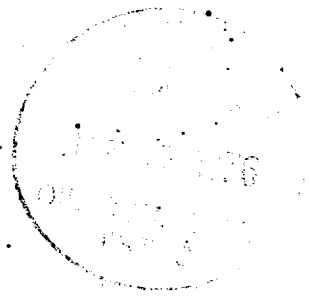
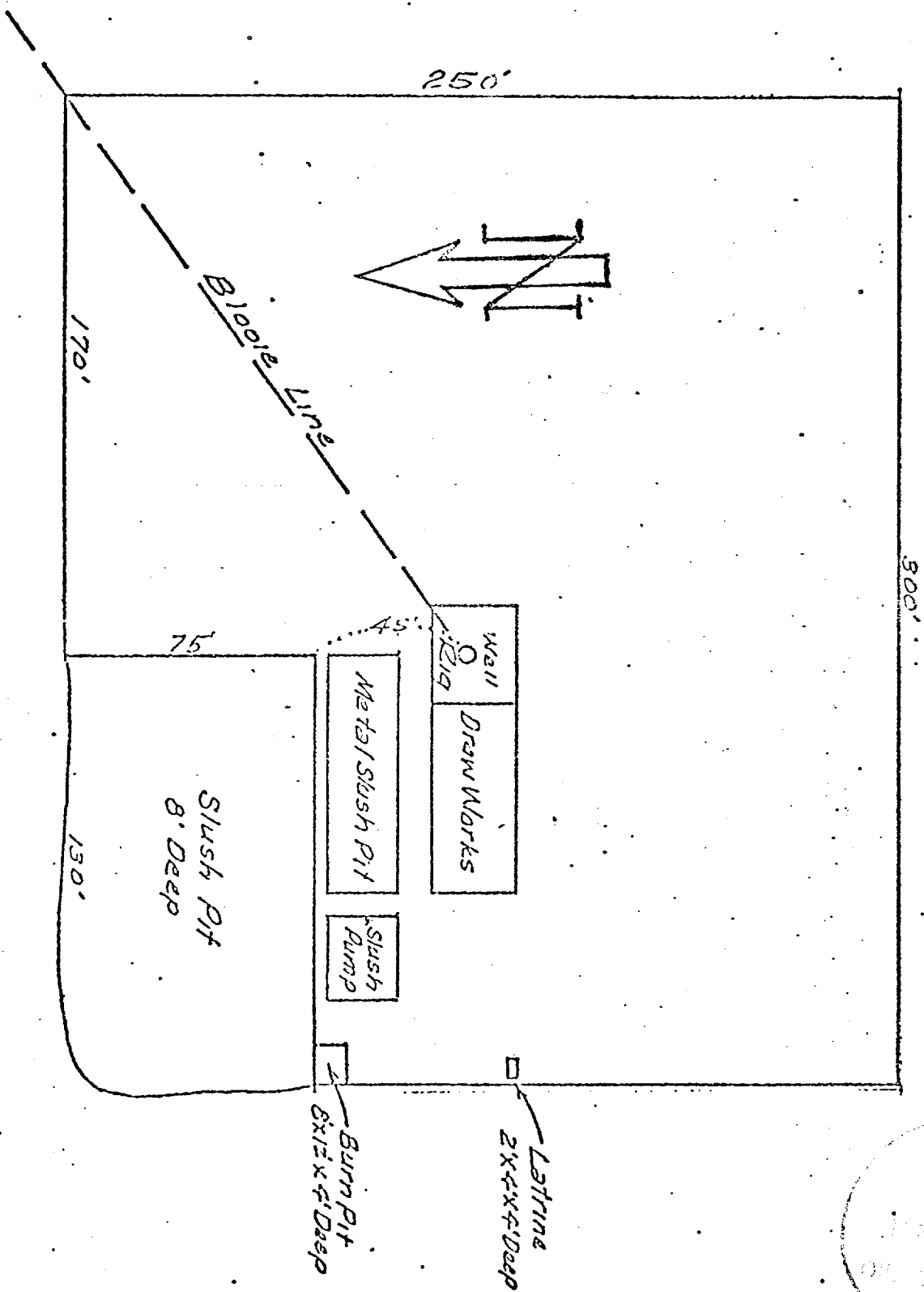

FINON MESA &
SE, SE/4 SEC 13, T-31-N, R-14-W

R-14-W

T
31
N

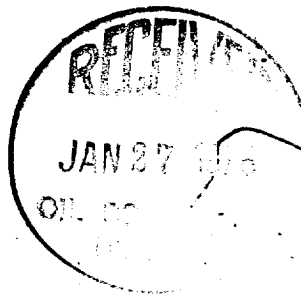
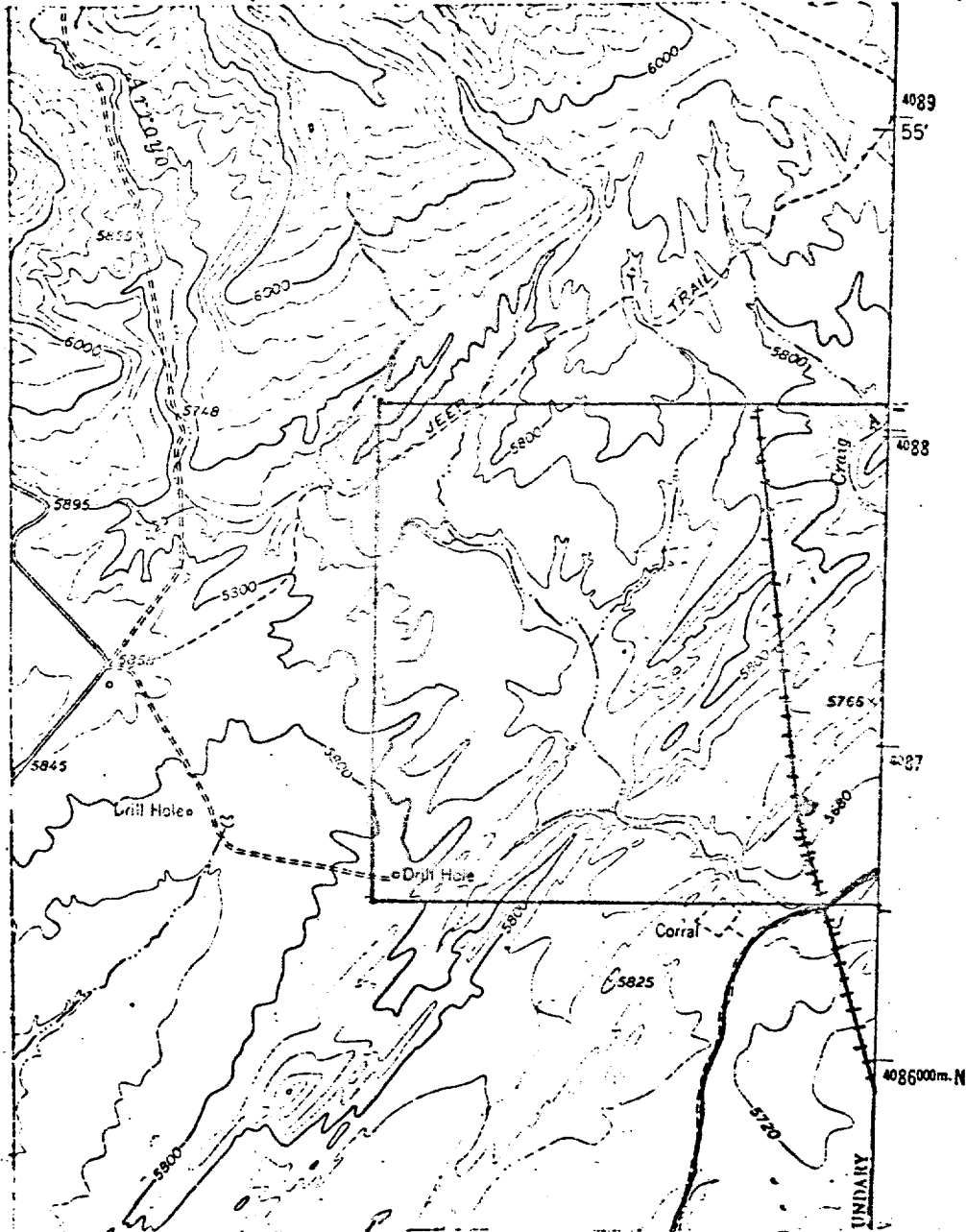

LEGEND OF RIGHT-OF-WAYS

EXISTING ROADS	— — — — —
EXISTING PIPELINES	— + + + —
EXISTING ROAD & PIPELINE	— + + + —
PROPOSED ROADS	— — — — —
PROPOSED PIPELINES	+ + + + +
PROPOSED ROAD & PIPELINE	+ + + + +

R 13 W

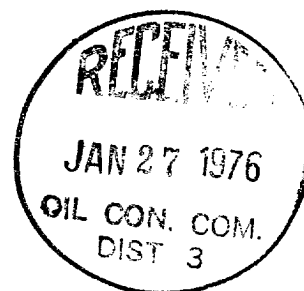
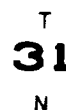

ENG. REC.		DATE
DRAWN	J.H.	1-20-76
CHECKED		
CHECKED		
PROJ. APP.		
DESIGN		
W.O.		

San Juan Co., New Mexico

REV.

PRINT RECORD

EASTERN NEW MEXICO UNIVERSITY

DIVISION OF CONSERVATION ARCHAEOLOGY

ROUTE 3 • BOX 169
FARMINGTON, NEW MEXICO 87401

PHONES: 632-2013 • 632-2733 • 632-2777

January 20, 1976

Earl W. Mealer, Jr.
Division Project Engineer
San Juan Division
El Paso Natural Gas Company
P.O. Box 990
Farmington, New Mexico 87401

PROJECT
JAN 22 1976
ENGINEERING

Dear Mr. Mealer:

Enclosed please find a copy of the archaeological clearance survey for the five well pads (Pinon Mesa #A-2, #B-2, #C-2, #C-3, #D-2), connecting tie-in lines and two access roads located in Township 31 North, Range 14 West, on the Ute Mountain Indian Reservation.

As explained in the enclosed report, archaeological clearance has been recommended for all of these areas with the exception of the well pad, tie-in line and access road of Pinon Mesa #D-2, which has been recommended for clearance with qualification.

I wish to add that I am very impressed with the efforts that Harland Gould and the other members of El Paso Natural Gas Company have taken to respect the archaeological remains near well #D-2. Besides setting up a new location previous to my visit in the field, they were most patient and understanding in the field while I surveyed the archaeological site ENM #10665.

Sincerely yours,

Peter A. Ingle

Peter A. Ingle
Division of Conservation Archaeology

xc: Harland Gould, El Paso Natural Gas Company, Farmington, N.M.
Phil Kirk, Bureau of Land Management, Farmington, N.M.
Marshall Whyte, Ute Mountain Tribal Office, Towaoc, Colo.
Hal Rogers, Real Property Management, Towaoc, Colo. (B.I.A.)
J. Loring Haskell, D.C.A., Portales, N.M.

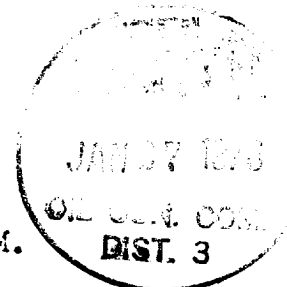

SAN JUAN COUNTY MUSEUM ASSOCIATION
EASTERN NEW MEXICO UNIVERSITY
DIVISION OF CONSERVATION ARCHAEOLOGY

ROUTE 3 • BOX 169
FARMINGTON, NEW MEXICO 87401
PHONES: 632-2013 • 632-2733 • 632-2777

Archaeological Clearance Survey Report

for

El Paso Natural Gas Company

Farmington, New Mexico

January 20, 1976

by

Peter A. Ingle

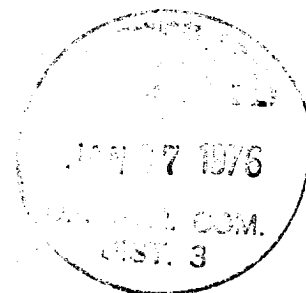

Introduction

The Division of Conservation Archaeology of the San Juan County Museum Association and Eastern New Mexico University recently completed an archaeological clearance survey of Ute Mountain Indian Reservation Lands under the jurisdiction of the Bureau of Indian Affairs to be impacted by the scheduled construction of five well pads, tie-in lines and two access roads by El Paso Natural Gas Company of Farmington, New Mexico. The required field work was accomplished on January 15, 1976.

The survey project was initiated at the request of and under contract with El Paso Natural Gas Company. It was administered by Earl W. Mealer, Jr., representing El Paso Natural Gas Company, and by J. Loring Haskell, who served as the principal investigator for the Division of Conservation Archaeology of the San Juan County Museum Association and Eastern New Mexico University. The field work was conducted by Peter Ingle, representing the Division of Conservation Archaeology, under provisions of the permit issued by the Ute Mountain Tribal Office to the Division of Conservation Archaeology. Representatives in the field were Harland Could, Lon Hitt, and John Ahlm, of El Paso Natural Gas Company; Hal Rogers of the Bureau of Indian Affairs; and John Keller, of the U.S. Geological Survey Office in Durango.

Survey

The requested survey involved five well tie-in lines, their respective well pads, and two access roads on the Ute Mountain Indian Reservation. A section of one well, E.P.M.G. Pinon Mesa #C-2, lies on land under the jurisdiction of the Bureau of Land Management. (For specific details of locations, see attached copies of topographic maps, plats, and the recommendations section of this report.)

Survey Procedure

The Division of Conservation Archaeology representative walked in a zig-zag fashion over all the areas in question, visually scanning the ground for any evidence of cultural activity. Erosional gullies were inspected closely for signs of subsurface cultural resources. Adjacent areas which were thought to have potential for containing cultural resources were also checked.

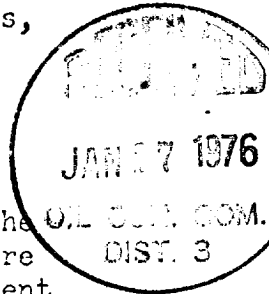

E.P.M.G. Pinon Mesa #A-2: This well and its connecting tie-in line will be located in a gently sloping area to the south of Foxtail Flats, at an elevation of approximately 5690 feet. Along the tie-in line there is moderate to heavy overall coverage of *Artemisia tridentata* (sagebrush), *Opuntia* (prickly pear cactus), *Yucca* (yucca), *Atriplex confertifolia* (shadscale), and *Bromus tectorum* (cheet grass). Drainage is to the west. The tie-in line is approximately 4125 feet in length. The area of the prospective pad itself, which measures 300 feet by 260 feet, contains the same coverage as the area along the tie-in line, and drainage is to the west-northwest. No cultural resources were noted in either the pad area or along the tie-in line.

E.P.M.G. Pinon Mesa #B-2: The tie-in line for this well is approximately 3300 feet in length. The proposed pad and tie-in line are both located in Foxtail Flats, with the pad at an elevation of approximately 5680 feet and with an area of 300 feet by 260 feet. The coverage in both cases is moderate to heavy and consists primarily of *Artemisia tridentata*, *Gutierrezia sarothrae* (broom snakeweed), *Bromus tectorum*, and scattered *Juniperus* (juniper) and *Yucca*. The topography is gentle, and slopes to the west. In neither the pad area nor the tie-in line were any archaeological resources noted.

E.P.M.G. Pinon Mesa #C-2: This well, its access road and tie-in line are in a gently sloping area to the east of Narrows Wash, at an elevation of approximately 5700 feet. The tie-in line will be approximately 1500 feet in length, is in an area with local drainage to the north, and has a moderate overall coverage predominantly of *Artemisia tridentata* and various grasses with isolated occurrences of *Gutierrezia sarothrae*, *Juniperus*, and *Atriplex canescens* (fourwing saltbush). The proposed well pad exhibits the same foliage, measures 300 feet by 260 feet, and drainage there is to the west. The access road will be approximately 500 feet in length and heads in a northwesterly direction towards a previously existing unpaved road. One segment of the tie-in line for this well is on land under Bureau of Land Management jurisdiction (see accompanying plat). In none of the areas surveyed were there any cultural artifacts or evidence thereof that would be impacted by construction in these areas.

E.P.N.G. Pinon Mesa #C-3: The tie-in line to this proposed well is 492 feet. The well pad will be relatively small, 100 feet by 150 feet, as it is adjacent to an existing well, Pinon Mesa #3. The drainage locally is to the east, and the coverage is moderate overall, consisting solely of *Eriogonum tectorum* and various other grasses. Nowhere in this area were any cultural resources noted.

E.P.N.G. Pinon Mesa #D-2: There are two prospective sites for this well pad. Both are in the same area, with a moderate to heavy coverage predominantly of *Artemisia tridentata*, *Gutierrezia sarothrae*, and various grasses. Drainage is to the east. The orthodox location for this well would have encompassed an archaeological site (EMM #10665), and seeing this, the El Pas Natural Gas Company representatives had already selected another site. It is upon this latter area that the survey was concentrated. This new site was surveyed and found to contain very few sherds, but these were noted as being wash from the site, to the west of it. The well pad and tie-in line will skirt the area of the site that appears to retain cultural deposition (see map accompanying the site report for relationships mentioned.) This area of cultural deposition was flagged by the Division of Conservation Archaeology representative in the field, and there will be no danger of disturbance to the site if the flagged area is avoided. The access road, which heads east approximately 150 meters from the new location to a previously existing unpaved road, was found to be void of any evidence of cultural remains.

Recommendations

The well pads and tie-in lines for E.P.N.G. Pinon Mesa #A-2, #B-2, #C-2, and #C-3 are recommended for immediate archaeological clearance. The access road for E.P.N.G. Pinon Mesa #C-2 is also recommended for immediate archaeological clearance. The original (orthodox) site for E.P.N.G. Pinon Mesa #D-2 is not recommended. The revised site for E.P.N.G. Pinon Mesa #D-2 is recommended with qualification.

The new locations for the well pad, access road, and tie-in line for E.P.N.G. Pinon Mesa #D-2 will not subject the site EMM #10665 to any primary impact as long as the flagged area is kept intact. Secondary impact will not be increased, as there is a previously existing road accompanying the Twin Mounds Gathering System pipeline which already passes directly along the western edge of the ruin. It is felt that the construction of this well, its access road and tie-in line will not further expose this site to secondary disturbance. It is however, an intact site representing a transitional period in the Pueblo III culture, and as such the Ute Mountain Tribe may wish to have it fenced to prevent loss of any of the valuable information stored within. For E.P.N.G. Pinon Mesa #D-2, it is recommended that the new location, its access road, and tie-in line be granted archaeological clearance with the qualification that an archaeologist be present during their construction. It is possible, due to their proximity to the remains of a sedentary culture, that special activity areas or water control devices may be uncovered during construction. These things can not be predicted, but should they be found, they must be mapped, excavated, and collected in the proper manner consistent with archaeological ethics.

<u>Location Name</u>	<u>Location</u>	<u>Clearance Status</u>
E.P.N.G. Pinon Mesa #A-2 (Well pad & Tie-in Line)	Northwest $\frac{1}{4}$ of the Southwest $\frac{1}{4}$ of Section 36, Township 31 North, Range 14 West, Ute Mountain Indian Reservation. Map Source: U.S.G.S. 7.5 Minute Purgatory Canyon Quadrangle	Recommended
E.P.M.G. Pinon Mesa #B-2 (Well pad & Tie-in Line)	Southeast $\frac{1}{4}$ of the Northeast $\frac{1}{4}$ of Section 25, Township 31 North, Range 14 West, Ute Mountain Indian Reservation. Map Source: U.S.G.S. 7.5 Minute Purgatory Canyon Quadrangle	Recommended
E.P.N.G. Pinon Mesa #C-2 (Well pad, Tie-in Line, & Access Road)	Northeast $\frac{1}{4}$ of the Southeast $\frac{1}{4}$ of Section 24, Township 31 North, Range 14 West, Ute Mountain Indian Reservation. Map Source: U.S.G.S. 7.5 Minute Purgatory Canyon Quadrangle	Recommended
E.P.N.G. Pinon Mesa #C-3 (Well pad & Tie-in Line)	Southeast $\frac{1}{4}$ of the Southeast $\frac{1}{4}$ of Section 23, Township 31 North, Range 14 West, Ute Mountain Indian Reservation. Map Source: U.S.G.S. 7.5 Minute Purgatory Canyon Quadrangle	Recommended
<u>E.P.N.G. Pinon Mesa #D-2</u> (Orthodox)	1000 feet from the south line, 800 feet from the east line, Southeast $\frac{1}{4}$ of the Southeast $\frac{1}{4}$ of Section 13, Township 31 North, Range 14 West, Ute Mountain Indian Reservation. Map Source: U.S.G.S. 7.5 Minute Purgatory Canyon Quadrangle	<u>Not Recommended</u>

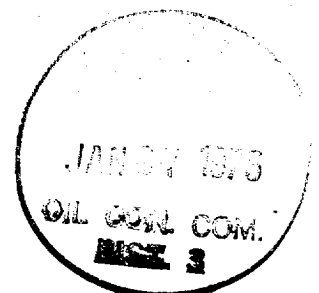

E.P.N.G. Pinon Mesa #D-2
(Revised)
(Well pad, Tie-in Line,
& Access Road)

800 feet from the south
line, 600 feet from the
east line, Southeast $\frac{1}{4}$
of the Southeast $\frac{1}{4}$ of
Section 13, Township 31
North, Range 14 West, Ute
Mountain Indian Reservation.
Map Source: U.S.G.S.
7.5 Minute Purgatory
Canyon Quadrangle

Recommended with
Qualification

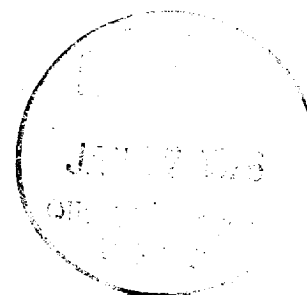

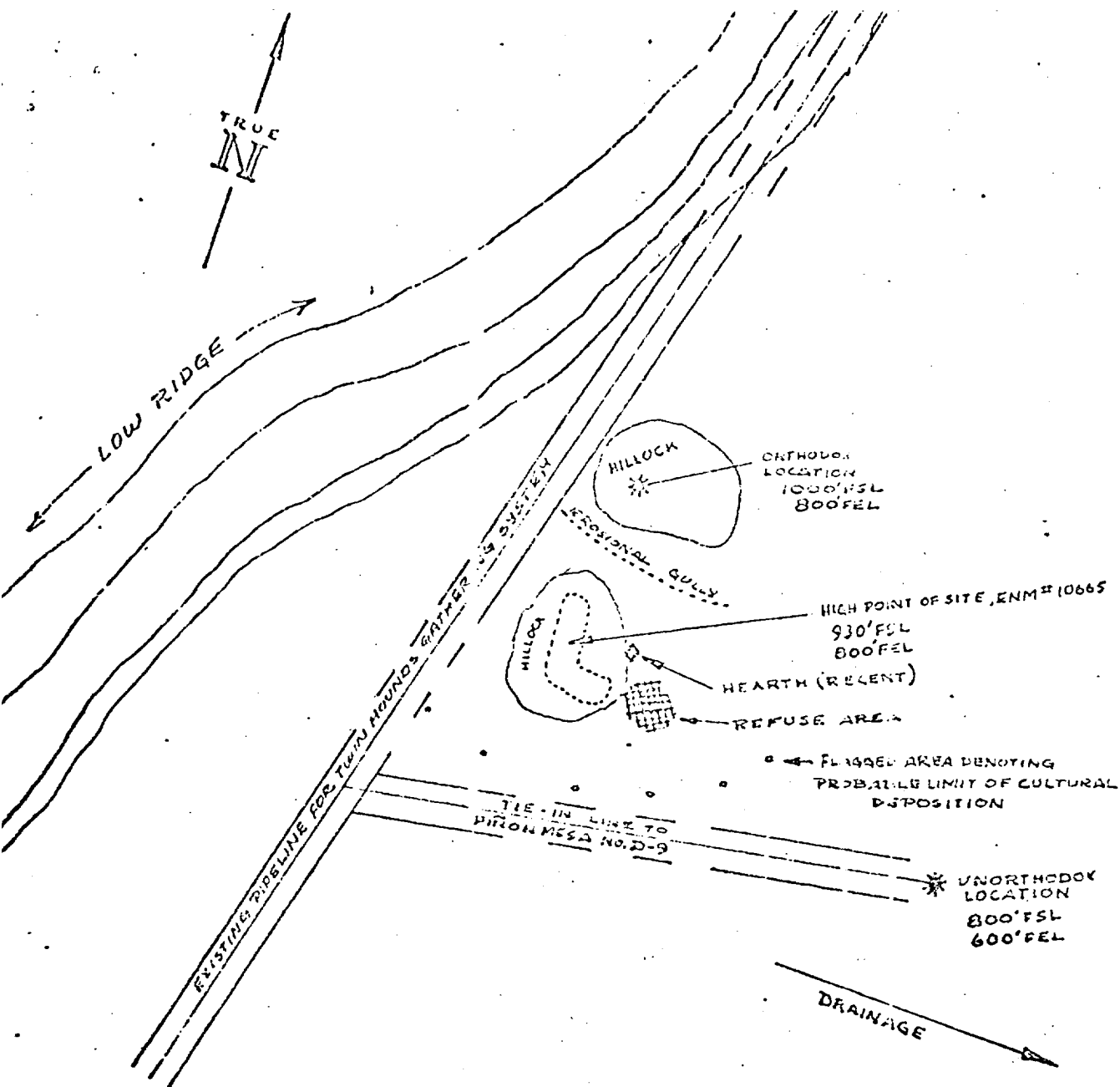

SKETCH OF SITE ENM#10665, NOT TO SCALE

FEATURES

HEARTH: Presence of tin can dates it to recent times, consistency and depth denote limited usage. Probably a shepherd's. no associated artifacts outside periphery of hearth.

REFUSE AREA: Marked by a high concentration of lithic and ceramic artifacts. Appears to be totally intact. Lithic content: Tools as well as debris. Ceramics: Approximate even representation of corrugated and painted wares.

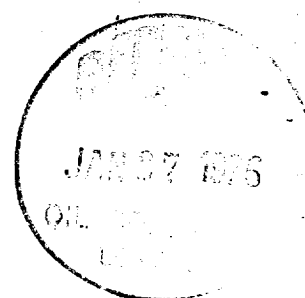

El Paso NATURAL GAS
COMPANY

P.O. BOX 990
FARMINGTON, NEW MEXICO 87401
PHONE: 505-325-2841

January 26, 1976

Mr. Joe Ramey, Director
New Mexico Oil Conservation Commission
Post Office Box 2088
Santa Fe, New Mexico 87501

Dear Mr. Ramey:

This is a request for administrative approval for an unorthodox gas well location in the Basin Dakota pool.

It is intended to locate the El Paso Natural Gas Company Pinon Mesa D #2 well 800' from the South line and 600' from the East line of Section 13, T-31-N, R-14-W, NMPM, San Juan County, New Mexico. The East half of Section 13 is dedicated to this well.

This well is located on the Ute Mountain Indian Reservation and in an area of a very prominent hogback. For geological reasons, an orthodox location would not be acceptable in the Northwestern portion of the SESE/4 of Section 13. A very rugged sandstone outcrop and a valuable archaeological site near the center of the SESE/4 of Section 13 eliminate the possibility of an orthodox location in this area. Attached is Mr. Peter Ingle's discussion and recommendation concerning the archaeological site. For these reasons, it is requested that the unorthodox location be approved.

All of the operators in the offsetting proration units have been notified of this application.

Plats showing the proposed well location with terrain features and operators of offset leases are attached.

Very truly yours,

Donald R. Read
Donald R. Read
Division Drilling Engineer

GDM:pb

cc: A. R. Kendrick, with attachments
Jim Permenter, with attachments
Jerry Long, with attachments



El Paso NATURAL GAS
COMPANY

P. O. BOX 990
FARMINGTON, NEW MEXICO 87401
PHONE: 505-325-2841

January 26, 1976

Mr. Jerry Long
U. S. Geological Survey
Post Office Box 1809
Durango, Colorado 81301

Re: Application for Permit to Drill
Pinon Mesa D #2
SESE Section 13, T-31-N, R-14-W
Basin Dakota

Dear Mr. Long:

Details regarding existing roads, pipelines, wells, etc. relative to the above well location are included on the previously submitted base maps, "Field Road Map" and "Composite Map No. 1".

The proposed new well location, new roads and new pipeline are shown on the attached plat along with connecting existing roads and pipelines in the vicinity of the proposed new well.

Water for drilling and completion operations will be obtained from a water hole located in: EPNG's San Juan River Plant. Waste material will be disposed of by burial in the burn pit, latrine, or reserve pit as applicable. There will be no camp nor air strip associated with drilling this well. Upon completion or abandonment of this well, the location will be cleaned and leveled and a dry hole marker placed, if applicable.

Yours very truly,



D. G. Brisco
Drilling Clerk

DGB:pb

att.

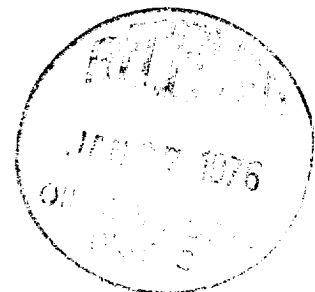

well file

OIL CONSERVATION COMMISSION
Custer DISTRICT

OIL CONSERVATION COMMISSION
BOX 2088
SANTA FE, NEW MEXICO

DATE Feb 2, 1976

RE: Proposed MC _____
Proposed DHC _____
Proposed NSL h _____
Proposed SWD _____
Proposed WFX _____
Proposed PMX _____

Gentlemen:

I have examined the application dated Jan 26, 1976
for the El Paso Natural Gas Co. Apache Mesa D #2 P-13-31N-146
Operator Lease and Well No. Unit, S-T-R

and my recommendations are as follows:

Approve

Yours very truly,

AR Kendrick