

**NEW MEXICO OIL CONSERVATION COMMISSION
WELL LOCATION AND ACERAGE DEDICATION PLAT**

All distances must be from the outer boundaries of the Section

Operator NORTHWEST PIPELINE			Lease COX CANYON UNIT COM		Well No. 9-A
Unit Letter D	Section 20	Township 32 NORTH	Range 11 WEST	County SAN JUAN	
Actual Footage Location of Well: 1050 feet from the NORTH line and 941 feet from the WEST line					
Ground Level Elev. 6644	Producing Formation MESA VERDE		Pool BLANCO	Dedicated Acreage: 320 Acres	

1. Outline the acreage dedicated to the subject well by colored pencil or hachure marks on the plat below.
2. If more than one lease is dedicated to the well, outline each and identify the ownership thereof (both as to working interest and royalty),
3. If more than one lease of different ownership is dedicated to the well, have the interests of all owners been consolidated by communitization, unitization, force-pooling, etc?

() Yes () No If answer is "yes," type of consolidation

If answer is "no," list the owners and tract descriptions which have actually consolidated. (Use reverse side of this form if necessary.)

No allowable will be assigned to the well until all interests have been consolidated (by communitization, unitization, forced-pooling, or otherwise) or until a non standard unit, eliminating such interests, has been approved by the Commission.

CERTIFICATION

I hereby certify that the information contained herein is true and complete to the best of my knowledge and belief.

D.H. Maroncelli
Name
D.H. Maroncelli
Position
Production Engineer
Company
Northwest Pipeline Cor.

May 21, 1976

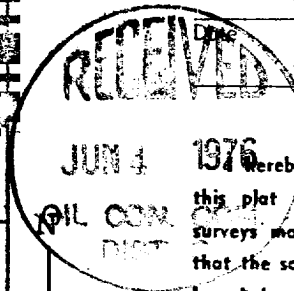
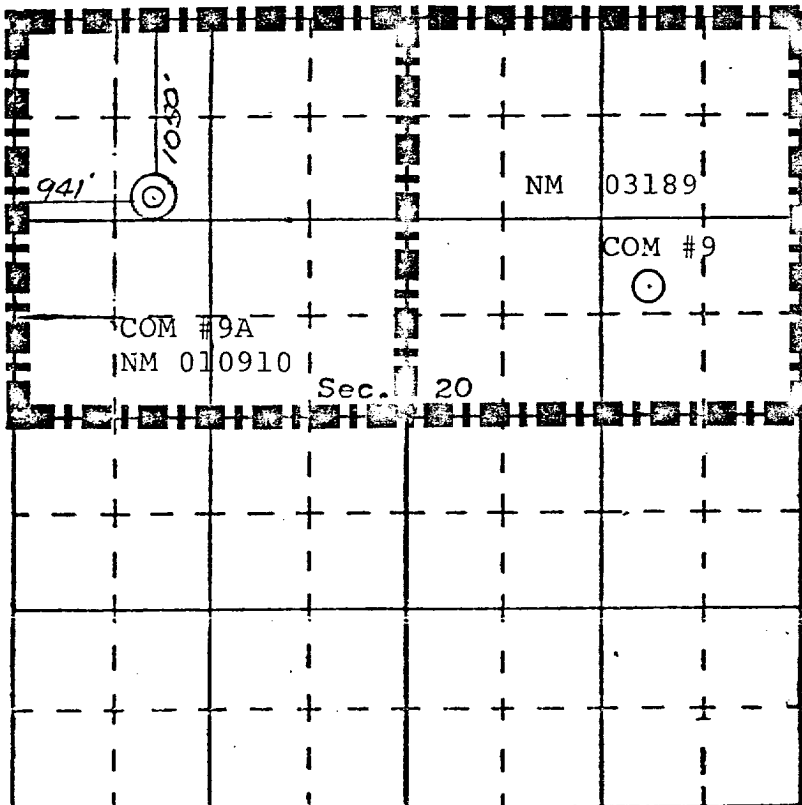

I hereby certify that the well location shown on this plat was plotted from field notes of actual surveys made by me or under my supervision, and that the same is true and correct to the best of my knowledge and belief.

20 May, 1976
Date Surveyed

James P. Leese
Registered Professional Engineer
and/or Land Surveyor

James P. Leese

1463
Certificate No.

