

**NEW MEXICO OIL CONSERVATION COMMISSION
WELL LOCATION AND ACERAGE DEDICATION PLAT**

All distances must be from the outer boundaries of the Section

Owner: CONSOLIDATED OIL AND GAS, INC. Lease: HANCOCK Well No: 1-A
 Section: 1 Township: 31 NORTH Range: 13 WEST County: SAN JUAN
 Section Location of Well: 1450 feet from the NORTH line and 1100' feet from the WEST line
 Section No.: 5781 Range: Mesa Verde Township: Blanco Mesa Verde Dedicated Acreage: 319.20 Acres

- Outline the acreage dedicated to the subject well by colored pencil or hatchure marks on the plat below.
- If more than one lease is dedicated to the well, outline each and identify the ownership thereof (both as to working interest and royalty).
- If more than one lease of different ownership is dedicated to the well, have the interests of all owners been consolidated by communitization, unitization, force-pooling, etc?

() Yes () No If answer is "yes," type of consolidation _____

If answer is "no," list the owners and tract descriptions which have actually consolidated (Use reverse side of this Form if necessary) _____

No allowable will be assigned to the well until all interests have been consolidated (by communitization, unitization, forced-pooling, or otherwise) or until a non standard unit, eliminating such interests, has been approved by the Commission.

CERTIFICATION

I hereby certify that the information contained herein is true and complete to the best of my knowledge and belief.

C.B. Whitenburg
 Name: C.B. Whitenburg
 Position: Sr. Drlg. Engineer
 Company: Consolidated Oil & Gas, Inc.
 Date: 1-23-78

I hereby certify that the well location shown on this plat was plotted from field notes of actual surveys made by me or under my supervision, and that the same is true and correct to the best of my knowledge and belief.

Date Surveyed: 21 January, 1978
James P. Leese
 Registered Professional Engineer
 and/or Land Surveyor James P. Leese

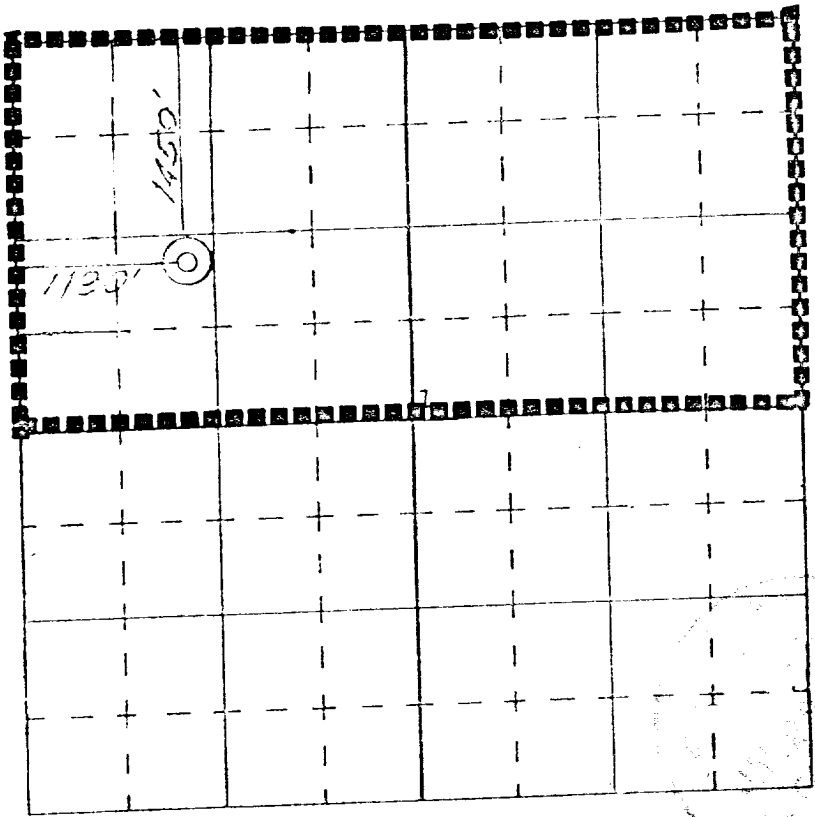

SCALE—4 INCHES EQUALS 1 MILE