

UNITED STATES
DEPARTMENT OF THE INTERIOR
GEOLOGICAL SURVEY

APPLICATION FOR PERMIT TO DRILL, DEEPEN, OR PLUG BACK

1a. TYPE OF WORK
DRILL ☒ DEEPEN ☐ PLUG BACK ☐

b. TYPE OF WELL
OIL WELL ☐ GAS WELL ☒ OTHER ☐ SINGLE ZONE ☒ MULTIPLE ZONE ☐

2. NAME OF OPERATOR
CHACE OIL COMPANY, INC.

3. ADDRESS OF OPERATOR
313 Washington S.E. Albuquerque, NM 87108

4. LOCATION OF WELL (Report location clearly and in accordance with any State requirements.)*
At surface Unit "D" 790' WL and 790' NL
At proposed prod. zone same

14. DISTANCE IN MILES AND DIRECTION FROM NEAREST TOWN OR POST OFFICE*
Shiprock, NM 14 mi southwest

15. DISTANCE FROM PROPOSED* LOCATION TO NEAREST PROPERTY OR LEASE LINE, FT. (Also to nearest drig. unit line, if any) 790'
16. NO. OF ACRES IN LEASE 960

18. DISTANCE FROM PROPOSED LOCATION* TO NEAREST WELL, DRILLING, COMPLETED, OR APPLIED FOR, ON THIS LEASE, FT. 2680'
19. PROPOSED DEPTH 2500'

21. ELEVATIONS (Show whether DF, RT, GR, etc.)
22. APPROX. DATE WORK WILL START* Dec. 1978

23. PROPOSED CASING AND CEMENTING PROGRAM

SIZE OF HOLE	SIZE OF CASING	WEIGHT PER FOOT	SETTING DEPTH	QUANTITY OF CEMENT
8-5/8"	7"	20#	500'	200 sxs

Drill 8-5/8" hole to 510' with native mud. Run 7" casing to 500' to close off water sands. Drill ahead with 6-1/4" bit with air to TD of 2500'. Contractor will install Schaeffer double ram hydraulic BOP on spud date. Will run 4-1/2" 9 1/2# casing, if productive.

gas is not dedicated

RECEIVED
JUN 26 1978
U. S. GEOLOGICAL SURVEY

IN ABOVE SPACE DESCRIBE PROPOSED PROGRAM: If proposal is to deepen or plug back, give data on present productive zone and proposed new productive zone. If proposal is to drill or deepen directionally, give pertinent data on subsurface locations and measured and true vertical depths. Give blowout preventer program if any.

24. SIGNED *Loyce M. Cary* TITLE President DATE 6-22-78

(This space for Federal or State office use)

PERMIT NO. _____ APPROVAL DATE _____

APPROVED BY _____ TITLE _____

CONDITIONS OF APPROVAL, IF ANY:

ok Frank

30-045-23132

5. LEASE DESIGNATION AND SERIAL NO.
M00-C-1420-1935

6. IF INDIAN, ALLOTTEE OR TRIBE NAME
UTE

7. UNIT AGREEMENT NAME

8. FARM OR LEASE NAME
Chace Ute

9. WELL NO.
3

10. FIELD AND POOL, OR WILDCAT
Wildcat Straight
Canyon Nakutu
ext

11. TOWN, R. 1, S. 1, OR BLK. AND SURVEY OR AREA
Sec. 23, T31N, R16W

12. COUNTY OR PARISH
San Juan

13. STATE
NM

NEW MEXICO OIL CONSERVATION COMMISSION
WELL LOCATION AND ACERAGE DEDICATION PLAT

All distances must be from the outer boundaries of the Section

Operator CHACE OIL COMPANY			Lease CHACE UTE		Well No. 3
Unit Letter D	Section 23	Township 31 NORTH	Range 16 WEST	County SAN JUAN	
Actual Footage Location of Well: 790 feet from the NORTH line and 790 feet from the WEST line					
Ground Level Elev. 5636	Producing Formation Dakota		Pool Straight Canyon ext		Dedicated Acreage: 160 Acres

1. Outline the acreage dedicated to the subject well by colored pencil or hachure marks on the plat below.
2. If more than one lease is dedicated to the well, outline each and identify the ownership thereof (both as to working interest and royalty),
3. If more than one lease of different ownership is dedicated to the well, have the interests of all owners been consolidated by communitization, unitization, force-pooling, etc?

() Yes () No If answer is "yes," type of consolidation

If answer is "no," list the owners and tract descriptions which have actually consolidated. (Use reverse side of this form if necessary.)

No allowable will be assigned to the well until all interests have been consolidated (by communitization, unitization, forced-pooling, or otherwise) or until a non standard unit, eliminating such interests, has been approved by the Commission.

CERTIFICATION

I hereby certify that the information contained herein is true and complete to the best of my knowledge and belief.

Royce McGary
 Name

Royce McGary
 Position

President
 Company

Chace Oil Company

Date
June 22, 1978

I hereby certify that the well location shown on this plat was plotted from field notes of actual surveys made by me or under my supervision, and that the same is true and correct to the best of my knowledge and belief.

25 March 1978

Date Surveyed
James P. Leese
 Registered Professional Engineer
 and/or Land Surveyor
James P. Leese

1463
 Certificate No.

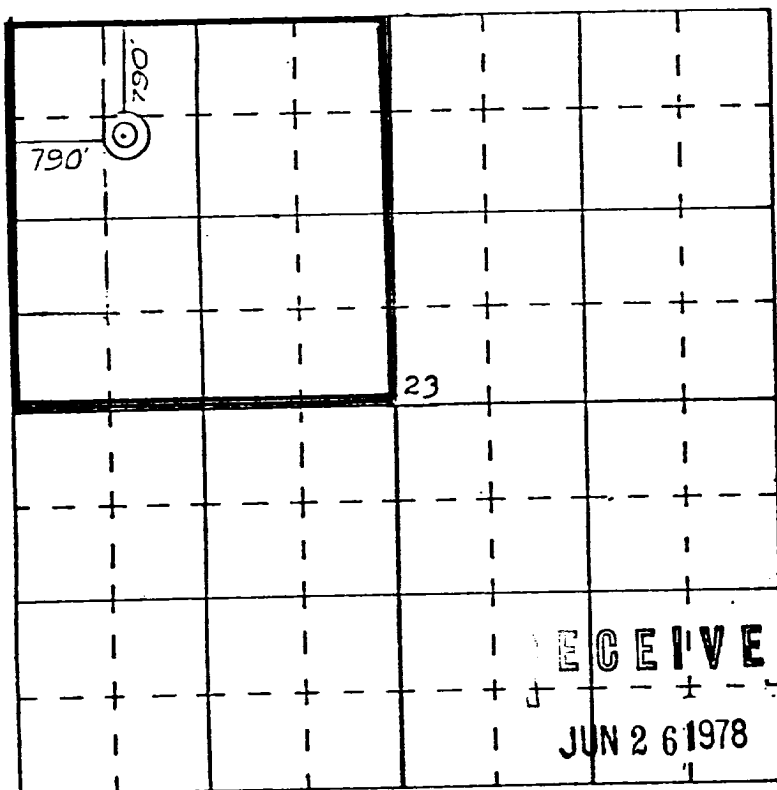

SCALE - 4 INCHES EQUALS 1 MILE

SAN JUAN ENGINEERING COMPANY,

U. S. GEOLOGICAL SURVEY

FARMINGTON, N. M.