

*Denny S. Faust*  
District I  
P.O. Box 1980, Hobbs, NM  
**DEPUTY OIL & GAS INSPECTOR**  
District II  
P.O. Drawer DD, Artesia, NM 88221  
District III  
1000 Rio Brazos Rd, Aztec, NM 87410  
**SEP 03 1999**

State of New Mexico  
Energy, Minerals and Natural Resources Department

**OIL CONSERVATION DIVISION**

2040 South Pacheco Street  
Santa Fe, New Mexico 87505

SUBMIT 1 COPY TO  
APPROPRIATE  
DISTRICT OFFICE  
AND 1 COPY TO  
SANTA FE OFFICE

**RECEIVED**  
JUL 30 1999  
**OIL CON. DIV.**  
**DIST. 3**

**PIT REMEDIATION AND CLOSURE REPORT**

**Operator:** PNM Gas Services ( Burlington ) **Telephone:** 324-3764

**Address:** 603 W. Elm Street Farmington, NM 87401

**Facility or Well Name:** Dusenberry #3E

**Location:** Unit H Sec 1 T 31 N R 12 W County San Juan

**Pit Type:** Separator ☐ Dehydrator ☒ Other                     

**Land Type:** BLM ☐ State ☐ Fee ☒ Other                     

**Pit Location:** Pit dimensions: length 20 ' width 20 ' depth 4 '

(Attach diagram) Reference: wellhead ☒ other                     

Footage from reference: 105'

Direction from reference: 60 Degrees ☒ East ☐ North ☒  
of ☐ West ☐ South ☐

**Depth to Ground Water:**  
(Vertical distance from contaminants to seasonal high water elevation of ground water)  
Less than 50 feet (20 points)  
50 feet to 99 feet (10 points)  
Greater than 100 feet (0 points) 0

**Wellhead Protection Area:**  
(Less than 200 feet from a private domestic water source, or, less than 1,000 feet from all other water sources)  
Yes (20 points)  
No (0 points) 0

**Distance to Surface Water:**  
(Horizontal distance to perennial lakes, ponds, rivers, streams, creeks, irrigation canals and ditches)  
Less than 200 feet (20 points)  
200 feet to 1,000 feet (10 points)  
Greater than 1,000 feet (0 points) 0

**RANKING SCORE (TOTAL POINTS):** 0

Dusenberry #3E

Date Remediation Started: \_\_\_\_\_ Date Completed: \_\_\_\_\_

Remediation Method: Excavation \_\_\_\_\_ Approx. Cubic Yard \_\_\_\_\_

(Check all appropriate sections) Landfarmed \_\_\_\_\_ Amount Landfarmed (cubic yds) \_\_\_\_\_

Other \_\_\_\_\_

Remediation Location: Onsite \_\_\_\_\_ Offsite \_\_\_\_\_

(i.e., landfarmed onsite, name and location of offsite facility)

Backfill Material Location: \_\_\_\_\_

General Description of Remedial Action:

No remedial action necessary. Lab results below OCD/BLM standards.

Ground Water Encountered: No ☒ Yes ☐ Depth \_\_\_\_\_

Final Pit Closure Sampling:

Sample Location 3 pt. composite - bottom.

(if multiple samples, attach sample result and diagram of sample locations and depths.)

Sample depth 4'

Sample date 05/12/1999 Sample time 4:00:00 PM

Sample Results

Benzene (ppm) \_\_\_\_\_

Total BTEX (ppm) \_\_\_\_\_

Field headspace (ppm) 0

TPH (ppm) < 25.00 Method 8015B

Vertical Extent (ft) \_\_\_\_\_ Risk Analysis form attached Yes ☐ No ☒

Ground Water Sample: Yes ☐ No ☒ (If yes, see attached Groundwater Site Summary Report)

I HEREBY CERTIFY THAT THE INFORMATION ABOVE IS TRUE AND COMPLETE TO THE BEST OF MY KNOWLEDGE AND MY BELIEF

DATE July 27, 1999

SIGNATURE Maureen Gannon

PRINTED NAME Maureen Gannon  
AND TITLE Project Manager

Sec 1 T31N R12W Unit H  
Burlington

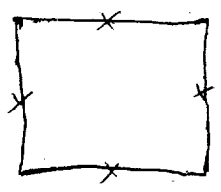
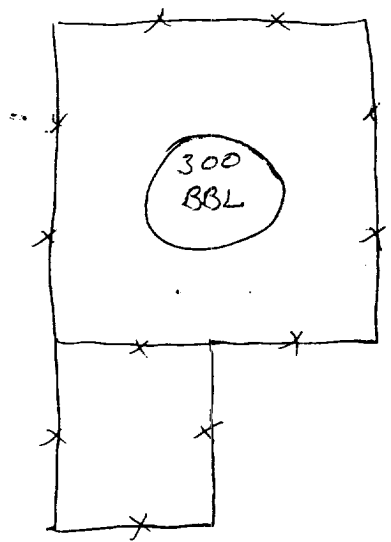

Sep

Sep

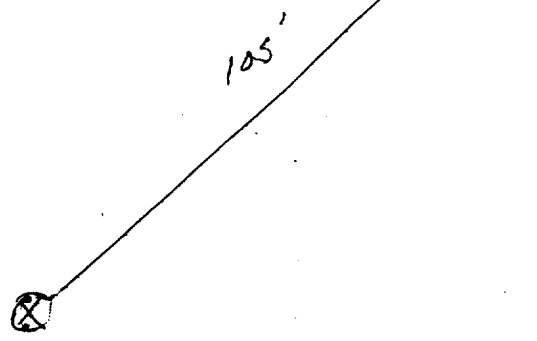

0 ppm (3 pt comp.)  
field headspace

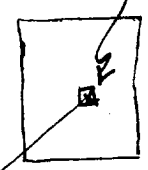

DH

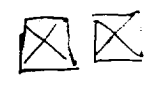

OFF: (505) 325-5667



LAB: (505) 325-1556

**On Site Technologies, LTD.**

**Date:** 26-May-99

---

**CLIENT:** PNM - Public Service Company of NM  
**Project:** Dusenberry 2A & 3E  
**Lab Order:** 9905055

---

**CASE NARRATIVE**

Samples were analyzed using the methods outlined in the following references:

Test Methods for Evaluating Solid Waste, Physical/Chemical Methods, SW846, 3rd Edition

All method blanks, laboratory spikes, and/or matrix spikes met quality assurance objectives.

OFF: (505) 325-5667



LAB: (505) 325-1556

**ANALYTICAL REPORT****Date:** 26-May-99

<b>Client:</b>	PNM - Public Service Company of NM	<b>Client Sample Info:</b>	Dusenberry 3E
<b>Work Order:</b>	9905055	<b>Client Sample ID:</b>	9905121600; 3pt Bottom @ 48in
<b>Lab ID:</b>	9905055-03A	<b>Matrix:</b>	SOIL
<b>Project:</b>	Dusenberry 2A & 3E	<b>Collection Date:</b>	5/12/99 4:00:00 PM
		<b>COC Record:</b>	7480

Parameter	Result	PQL	Qual	Units	DF	Date Analyzed
<b>DIESEL RANGE ORGANICS</b>		<b>SW8015B</b>				<b>Analyst: DC</b>
T/R Hydrocarbons: C10-C28	ND	25		mg/Kg	1	5/20/99

**Qualifiers:**

PQL - Practical Quantitation Limit

S - Spike Recovery outside accepted recovery limits

ND - Not Detected at Practical Quantitation Limit

R - RPD outside accepted recovery limits

J - Analyte detected below Practical Quantitation Limit

E - Value above quantitation range

B - Analyte detected in the associated Method Blank

Surr: - Surrogate

1 of 1

**P.O. BOX 2606 • FARMINGTON, NM 87499**

- TECHNOLOGY BLENDING INDUSTRY WITH THE ENVIRONMENT -

State of New Mexico  
Energy, Minerals and Natural Resources Department  
Oil Conservation Division

Sundry Notices and Reports on Wells

<p>1. Type of Well GAS</p> <hr/> <p>2. Name of Operator <b>BURLINGTON RESOURCES</b> OIL &amp; GAS COMPANY</p> <hr/> <p>3. Address &amp; Phone No. of Operator PO Box 4289, Farmington, NM 87499 (505) 326-9700</p> <hr/> <p>4. Location of Well, Footage, Sec., T, R, M <b>H</b> 1720' FNL, 790' FEL, Sec.1, T-31-N, R-12-W, NMPM, San Juan County, NM</p>	<p>API # (assigned by OCD) 30-045-23644</p> <p>5. Lease Number Fee</p> <p>6. State Oil&amp;Gas Lease #</p> <p>7. Lease Name/Unit Name Dusenberry</p> <p>8. Well No. #3E</p> <p>9. Pool Name or Wildcat <b>MV</b>/Dusenberry GP/Basin DK</p> <p>10. Elevation:</p>
--	---

Type of Submission	Type of Action
<input checked="" type="checkbox"/> Notice of Intent	<input type="checkbox"/> Abandonment <input type="checkbox"/> Change of Plans
<input type="checkbox"/> Subsequent Report	<input checked="" type="checkbox"/> Recompletion <input type="checkbox"/> New Construction
<input type="checkbox"/> Final Abandonment	<input type="checkbox"/> Plugging Back <input type="checkbox"/> Non-Routine Fracturing
	<input type="checkbox"/> Casing Repair <input type="checkbox"/> Water Shut off
	<input type="checkbox"/> Altering Casing <input type="checkbox"/> Conversion to Injection
	<input checked="" type="checkbox"/> Other -

13. Describe Proposed or Completed Operations

It is intended to recomplete the subject well according to the attached procedure.

**RECEIVED**  
NOV 22 1999  
OIL CON. DIV.  
DIST. 3

SIGNATURE  Regulatory Administrator November 15, 1999

trc

(This space for State Use)

DEPUTY OIL & GAS INSPECTOR, DIST. 33

Approved by ORIGINAL SIGNED BY ERNIE BUSCH Title \_\_\_\_\_ Date NOV 23 1999

District I  
PO Box 1980, Hobbs, NM 88241-1980  
District II  
PO Drawer DD, Artesia, NM 88211-0719  
District III  
1000 Rio Brazos Rd., Aztec, NM 87410  
District IV  
PO Box 2088, Santa Fe, NM 87504-2088

State of New Mexico  
Energy, Minerals & Natural Resources Department

OIL CONSERVATION DIVISION  
PO Box 2088  
Santa Fe, NM 87504-2088

Form C-102  
Revised February 21, 1994  
Instructions on back  
Submit to Appropriate District Office  
State Lease - 4 Copies  
Fee Lease - 3 Copies

☐ AMENDED REPORT

WELL LOCATION AND ACREAGE DEDICATION PLAT

1 API Number 30-045-23644		2 Pool Code 71599 72319/76180/		3 Pool Name Basin Dakota Blanco Mesaverde/Dusenberry Gallup/	
4 Property Code 18515		5 Property Name Dusenberry			6 Well Number 3E
7 OGRID No. 14538		8 Operator Name Burlington Resources Oil & Gas Company			9 Elevation 6375' GR

10 Surface Location

UL or lot no.	Section	Township	Range	Lot Idn	Feet from the	North/South line	Feet from the	East/West line	County
H	1	31N	12W		1720	North	790	East	SJ

11 Bottom Hole Location If Different From Surface

UL or lot no.	Section	Township	Range	Lot Idn	Feet from the	North/South line	Feet from the	East/West line	County

12 Dedicated Acres Gal-155.32 MV/DK-E/315.58	13 Joint or Infill	14 Consolidation Code	15 Order No.
--	--------------------	-----------------------	--------------

NO ALLOWABLE WILL BE ASSIGNED TO THIS COMPLETION UNTIL ALL INTERESTS HAVE BEEN CONSOLIDATED  
OR A NON-STANDARD UNIT HAS BEEN APPROVED BY THE DIVISION

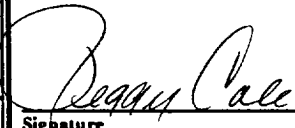
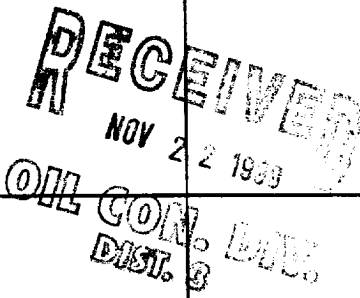
16  Original plat from Fred B. Kerr Jr. 6-19-79				17 OPERATOR CERTIFICATION <i>I hereby certify that the information contained herein is true and complete to the best of my knowledge and belief</i>   Signature Peggy Cole Printed Name Regulatory Administrator Title  Date	
				18 SURVEYOR CERTIFICATION <i>I hereby certify that the well location shown on this plat was plotted from field notes of actual surveys made by me or under my supervision, and that the same is true and correct to the best of my belief.</i>  Date of Survey Signature and Seal of Professional Surveyer:  Certificate Number	

OK @

# SUNDRY NOTICE SUBMITTAL

**Well: Dusenberry #3E**

Unit A, Sec. 1, T 31N, R 12W  
San Juan, NM

It is intended to recomplete the Mesaverde formation in the existing Dakota wellbore. A rig will MIRU, ND wellhead, NU BOP, and pull production tubing. A CIBP will be set above the Dakota formation at approximately 5732'.

If adequately isolated by cement, the Mesaverde will be perforated and fracture stimulated in two stages in the following interval: 4812' - 5632'. If cement remediation operations are necessary, Burlington Resources will contact the appropriate regulatory agency for approval prior to work initiation.

After stimulation flowback, the CIBP above the Dakota will be drilled out and tubing will be landed approximately 100' above PBTD. The well will then produce commingled production for the Mesaverde and Dakota formations. Application for commingling will be submitted.

Approved: Bruce W. Boyer  
Drilling Superintendent

11-10-99  
Date