

UNITED STATES
DEPARTMENT OF THE INTERIOR
GEOLOGICAL SURVEY

30 045-23874

5. LEASE DESIGNATION AND SERIAL NO.
SF-078244

6. IF INDIAN, ALLOTTEE OR TRIBE NAME

7. UNIT AGREEMENT NAME

8. FARM OR LEASE NAME
Southern Union

9. WELL NO.
1-M

10. FIELD AND, POOL, OR WILDCAT
BLANCO MESAVERDE
Basin Dakota

11. SEC., T., R., M., OR BLK.
AND SURVEY OR AREA
Sec 19, T31N, R12W

12. COUNTY OR PARISH
San Juan

13. STATE
New Mexico

APPLICATION FOR PERMIT TO DRILL, DEEPEN, OR PLUG BACK

1a. TYPE OF WORK
DRILL ☒ DEEPEN ☐ PLUG BACK ☐

b. TYPE OF WELL
OIL WELL ☐ GAS WELL ☒ OTHER ☐ SINGLE ZONE ☐ MULTIPLE ZONE ☐

2. NAME OF OPERATOR
Consolidated Oil & Gas, Inc.

3. ADDRESS OF OPERATOR
1860 Lincoln Street, Suite 1300, Denver, Colorado 80295

4. LOCATION OF WELL (Report location clearly and in accordance with any State requirements.)
At surface 790' FEL & 1850' FSL Sec. 19, T31N, R12W
At proposed prod. zone Same

14. DISTANCE IN MILES AND DIRECTION FROM NEAREST TOWN OR POST OFFICE*
3.4 miles SE of La Plata P. O., New Mexico

15. DISTANCE FROM PROPOSED*
LOCATION TO NEAREST
PROPERTY OR LEASE LINE, FT.
(Also to nearest drig. unit line, if any) 790'

16. NO. OF ACRES IN LEASE
304.48

17. NO. OF ACRES ASSIGNED
TO THIS WELL
S/ 304.48 152.24

18. DISTANCE FROM PROPOSED LOCATION*
TO NEAREST WELL, DRILLING, COMPLETED,
OR APPLIED FOR, ON THIS LEASE, FT. 3560'

19. PROPOSED DEPTH
7050'

20. ROTARY OR CABLE TOOLS
Rotary

21. ELEVATIONS (Show whether DF, RT, GR, etc.)

22. APPROX. DATE WORK WILL START*
Nov. 1, 1979

PROPOSED CASING AND CEMENTING PROGRAM

SIZE OF HOLE	SIZE OF CASING	WEIGHT PER FOOT	SETTING DEPTH	QUANTITY OF CEMENT
12-1/4"	8-5/8"	24.0#	250'	200 sx
7-7/8"	5-1/2"	15.5#	7050'	500 sx

1. Drill 12-1/4" hole to \pm 250'. Run 8-5/8" casing. Circulate cement to surface.
2. WOC 12 hours.
3. Install BOP's. Pressure test surface casing and blowout preventers to 1000 psig.
4. Drill 7-7/8" hole to approximately 7050' with fresh water gel mud. Log. Run 5-1/2" casing and cement same with approximately 500 sx. WOC 12 hours.
5. Selectively perforate and stimulate the Mesaverde and Dakota formations and dually complete as required by the appropriate rules and regulations.

The S/2 of Section 19 is dedicated to this well and this acreage is committed to a gas sales contract.

MV NW 229
DK NW 393

IN ABOVE SPACE DESCRIBE PROPOSED PROGRAM: If proposal is to deepen or plug back, give data on present productive zone and proposed new productive zone. If proposal is to drill or deepen directionally, give pertinent data on subsurface locations and proposed new productive zone. Give blowout preventer program, if any.

24. C.M. Parham SIGNED Sr. Production Engineer TITLE Sept. 20, 1979 DATE

(This space for Federal or State office use)

PERMIT NO. _____ APPROVAL DATE _____

APPROVED BY _____ TITLE _____ DATE _____

CONDITIONS OF APPROVAL, IF ANY:

Additional well needed pursuant to New Mexican gas contract.
U.S. Geological Survey dated 8/29/79
Additional well needed pursuant to New
Mexican gas contract. U.S. Geological Survey dated 8/29/79
Additional well needed pursuant to New Mexican gas contract.

NMOCC

ok Frank

RECEIVED
SEP 24 1979

U.S. GEOLOGICAL SURVEY
FARMINGTON, N.M.

NEW MEXICO OIL CONSERVATION COMMISSION
WELL LOCATION AND ACREAGE DEDICATION PLAT

Form C-104
Supersedes C-128
Effective 1-1-65

All distances must be from the outer boundaries of the Section.

Operator CONSOLIDATED OIL AND GAS, INC.			Lease SOUTHERN UNION		Well No. 1M
Well Letter I	Section 19	Township 31 NORTH	Range 12 WEST	County SAN JUAN	
Original Footage Location of Well: 1850 feet from the SOUTH line and 790 feet from the EAST line Round Level Elev. 5962 Producing Formation Mesaverde Pool Blanco Mesaverde Dedicated Acreage 304.48 220 Acres					

1. Outline the acreage dedicated to the subject well by colored pencil or hachure marks on the plat below.
2. If more than one lease is dedicated to the well, outline each and identify the ownership thereof (both as to working interest and royalty).
3. If more than one lease of different ownership is dedicated to the well, have the interests of all owners been consolidated by communitization, unitization, force-pooling, etc? Single lease

☒ Yes ☐ No If answer is "yes," type of consolidation Communitization

If answer is "no," list the owners and tract descriptions which have actually been consolidated. (Use reverse side of this form if necessary.)

No allowable will be assigned to the well until all interests have been consolidated (by communitization, unitization, forced-pooling, or otherwise) or until a non-standard unit, eliminating such interests, has been approved by the Commission.

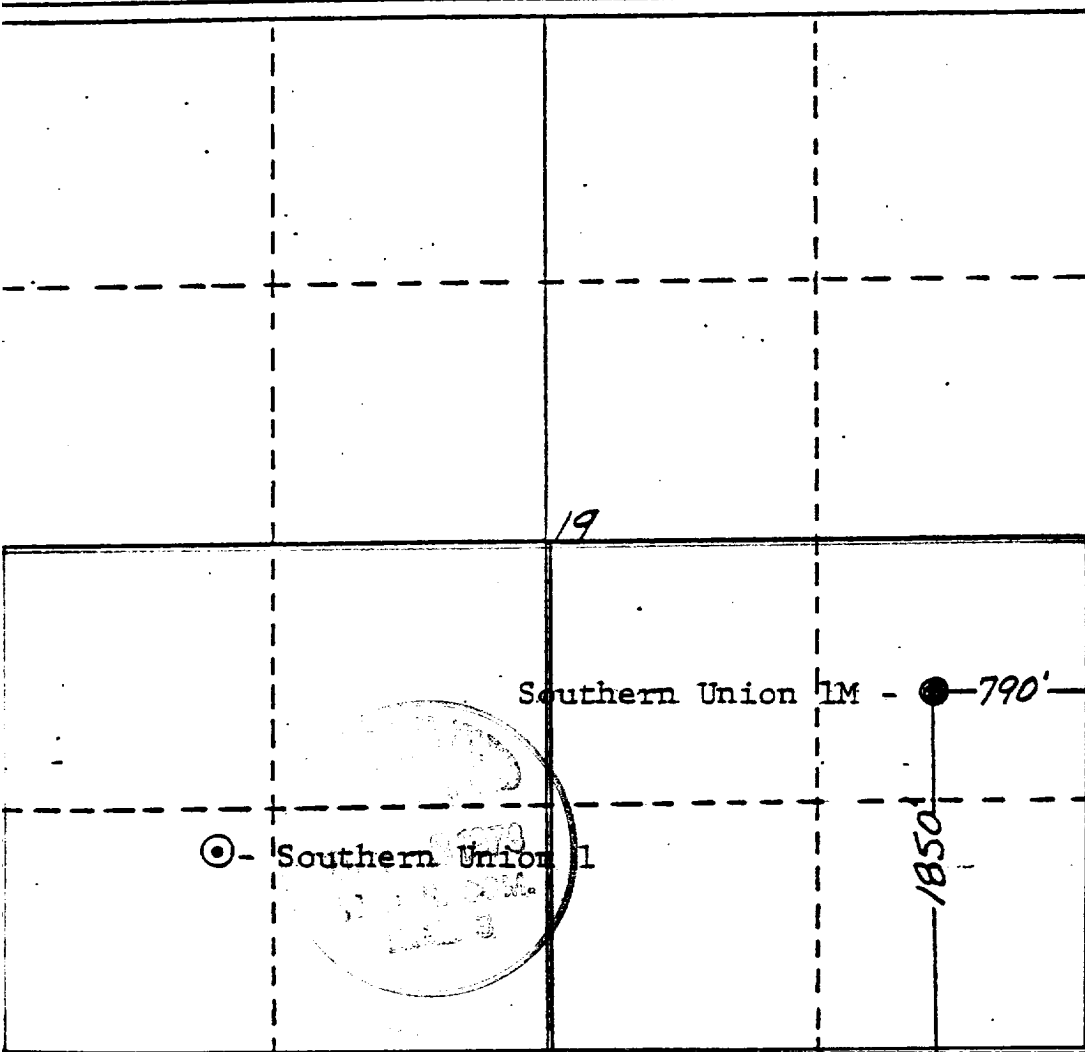

CERTIFICATION

I hereby certify that the information contained herein is true and complete to the best of my knowledge and belief.

C. M. Parham

Name
C. M. Parham

Position
Sr. Production Engineer

Company
Consolidated Oil & Gas, Inc

Date
September 20, 1979

I hereby certify that the location shown on this plat was plotted in the field notes of actual surveys made by me or under my supervision, and that the same is true and correct to the best of my knowledge and belief.

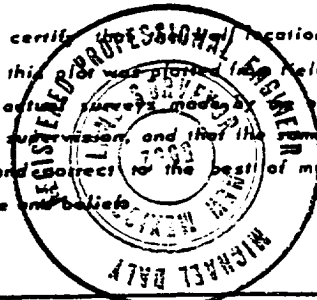

Date Surveyed
23 January 1979

Registered Professional Engineer and/or Land Surveyor

Michael Daly
Michael Daly

Certificate No.
5992

WELL LOCATION AND ACREAGE DEDICATION PLAT

Supersedes L-1
Effective 1-1-61

All distances must be from the outer boundaries of the Section.

Operator CONSOLIDATED OIL AND GAS, INC.			Lease SOUTHERN UNION		Well No. 1 M
Unit Letter I	Section 19	Township 31 NORTH	Range 12 WEST	County SAN JUAN	
Actual Footage Location of Well:					
1850 feet from the SOUTH line and		790 feet from the EAST line			
Ground Level Elev. 5962	Producing Formation Dakota	Pool Basin Dakota	Dedicated Acreage: 304.48 320 Acres		

1. Outline the acreage dedicated to the subject well by colored pencil or hatchure marks on the plat below.
2. If more than one lease is dedicated to the well, outline each and identify the ownership thereof (both as to working interest and royalty).
3. If more than one lease of different ownership is dedicated to the well, have the interests of all owners been consolidated by communitization, unitization, force-pooling, etc?

☒ Yes ☐ No If answer is "yes," type of consolidation Single lease
~~Communitization~~

If answer is "no," list the owners and tract descriptions which have actually been consolidated. (Use reverse side of this form if necessary.)

No allowable will be assigned to the well until all interests have been consolidated (by communitization, unitization, forced-pooling, or otherwise) or until a non-standard unit, eliminating such interests, has been approved by the Commission.

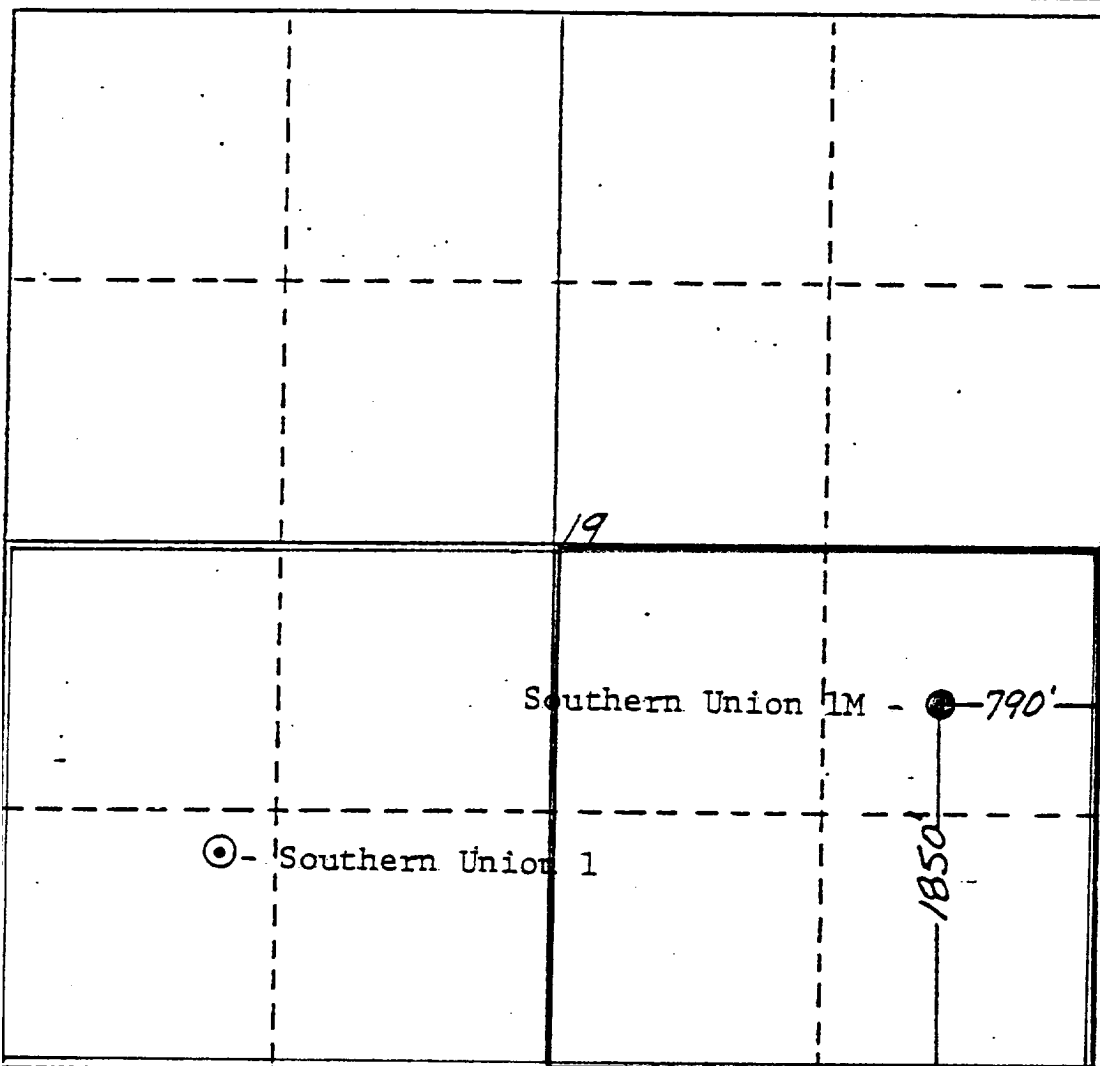

CERTIFICATION

I hereby certify that the information contained herein is true and complete to the best of my knowledge and belief.

C. M. Parham

Name

C. M. Parham

Position

Senior Production Engineer

Company

Consolidated Oil & Gas, Inc.

Date

September 20, 1979

I hereby certify that the location shown on this plat was plotted from notes of actual surveys made by me or under my supervision, and that the same is true and correct to the best of my knowledge and belief.

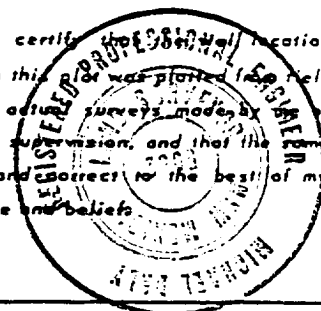

Date Surveyed

23 January 1979

Registered Professional Engineer
and/or Land Surveyor

Michael Daly

Certificate No.

5992