

NO. OF COPIES RECEIVED	
DISTRIBUTION	
SANTA FE	
FILE	
U.S.G.S.	
LAND OFFICE	
OPERATOR	

APPLICATION FOR PERMIT TO DRILL, DEEPEN, OR PLUG BACK

1a. Type of Work
 DRILL ☒ DEEPEN ☐ PLUG BACK ☐

b. Type of Well
 OIL WELL ☐ GAS WELL ☒ OTHER ☐ SINGLE ZONE ☒ MULTIPLE ZONE ☐

2. Name of Operator
 AMOCO PRODUCTION COMPANY

3. Address of Operator
 501 Airport Drive, Farmington, NM 87401

4. Location of Well
 UNIT LETTER F LOCATED 1660 FEET FROM THE North LINE
1770 FEET FROM THE West LINE OF SEC. 27 TWP. 32N RCF. 10W NMAPM

5. Proposed Depth
 7768'

6. Formation
 Dakota

7. History or C.T.
 Rotary

8. Elevations (Show whether D.P., R.I., etc.)
 5947' GL

9. Kind & Status Plug. Bond
 Statewide

10. Drilling Contractor
 Unknown

11. Approx. Date Work will start
 As soon as permitted

5A. Indicate Type of Lease
 STATE ☐ FEE ☒

5. State Oil & Gas Lease No.

7. Unit Agreement Name

8. Form of Lease Name
 Keys Gas Com "A"

9. Well No.
 2

10. Field and Pool, or Wildcat
 Basin Dakota

12. County
 San Juan

23. PROPOSED CASING AND CEMENT PROGRAM

SIZE OF HOLE	SIZE OF CASING	WEIGHT PER FOOT	SETTING DEPTH	SACKS OF CEMENT	EST. TOP
12 1/4"	9 5/8"	32.3#	300'	300	Surface
8 3/4"	7"	20#	3200'	420	Surface
6 1/4"	4 1/2"	11.6#	7768'	700	Surface

Amoco proposes to drill the above well to further develop the Basin Dakota reservoir. The well will be drilled to the surface casing point using native mud. The well will then be drilled to 3200 ft. using a low solids nondispersed mud system. The well will then be drilled to TD with gas. Completion design will be based on open hole logs. Copies of all logs will be filed upon completion. Amoco's standard blowout prevention will be employed; see attached drawing for blowout preventer design.

Upon completion the well location will be cleaned and the reserve pit filled and leveled.

Gas produced from this well is not dedicated to a gas sales contract.

EXPIRES 7-23-81



IN ABOVE SPACE DESCRIBE PROPOSED PROGRAM; IF PROPOSAL IS TO DEEPEN OR PLUG BACK, GIVE DATA ON PRESENT PRODUCTIVE ZONE AND PROPOSED NEW PRODUCTIVE ZONE. GIVE BLOWOUT PREVENTER PROGRAM, IF ANY.

I hereby certify that the information above is true and complete to the best of my knowledge and belief.

Signed [Signature] Title District Engineer Date 1-21-81

(This space for State Use)

APPROVED BY [Signature] TITLE Superintendent DATE JAN 23 1981

CONDITIONS OF APPROVAL, IF ANY:

All distances must be from the outer boundaries of the Section.

Operator AMOCO PRODUCTION COMPANY			Lease KEYES GAS COM "A"		Well No. 2
Unit Letter F	Section 27	Township 32N	Range 10W	County San Juan	
Actual Footage Location of Well: 1660 feet from the North line and 1770 feet from the West line					
Ground Level Elev: 5947	Producing Formation DAKOTA		Pool BASIN DAKOTA		Dedicated Acreage: 320 Acres

1. Outline the acreage dedicated to the subject well by colored pencil or hatchure marks on the plat below.
2. If more than one lease is dedicated to the well, outline each and identify the ownership thereof (both as to working interest and royalty).
3. If more than one lease of different ownership is dedicated to the well, have the interests of all owners been consolidated by communitization, unitization, force-pooling, etc?

☒ Yes ☐ No If answer is "yes," type of consolidation Communitization

If answer is "no," list the owners and tract descriptions which have actually been consolidated. (Use reverse side of this form if necessary.)

No allowable will be assigned to the well until all interests have been consolidated (by communitization, unitization, forced-pooling, or otherwise) or until a non-standard unit, eliminating such interests, has been approved by the Commission.

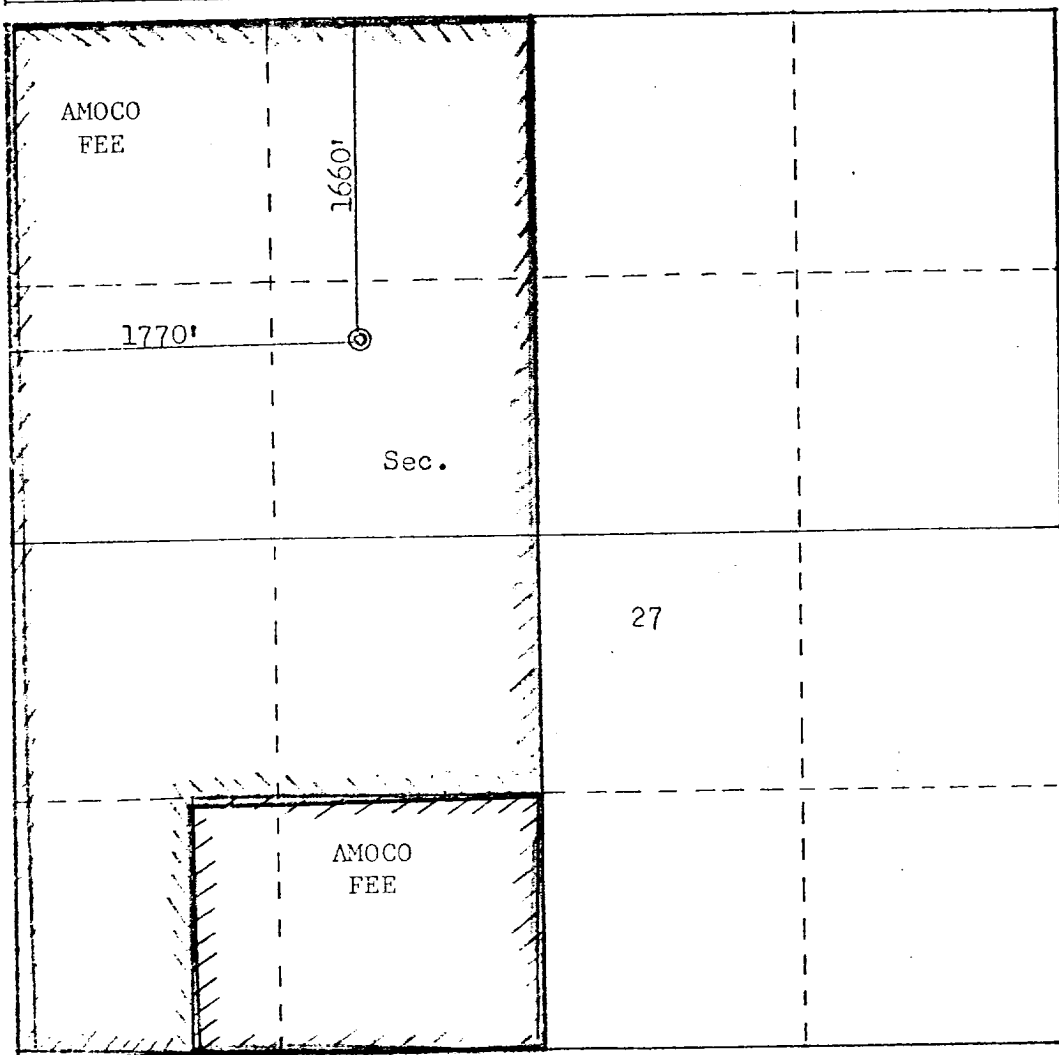

Scale: 1"=1000'

CERTIFICATION

I hereby certify that the information contained herein is true and complete to the best of my knowledge and belief.

Wayne Peterson

Name	W. L. PETERSON
Position	DISTRICT ENGINEER
Company	AMOCO PRODUCTION COMPANY
Date	1-21-81

I hereby certify that the well location shown on this plat was plotted from field notes of actual surveys made by me or under my supervision, and that the same is true and correct to the best of my knowledge and belief.

Date Surveyed	Jan 20 1981
Registered Professional Engineer and Land Surveyor	<i>Fred R. Kerr, Jr.</i>
Certificate No.	3950

1. Blowout Preventers and Master Valve to be fluid operated, and all fittings must be in good condition.
2. Equipment through which bit must pass shall be as large as the inside diameter of the casing that is being drilled through.
3. Nipple above Blowout Preventer shall be same size or larger than BOP being drilled through.
4. All fittings to be flanged.
5. Omsco or comparable safety valve must be be available on rig floor at all times with proper connection or sub. The I.D. of safety valve should be as great as I.D. of tool joints of drill pipe, or at least as great as I.D. of drill collars.

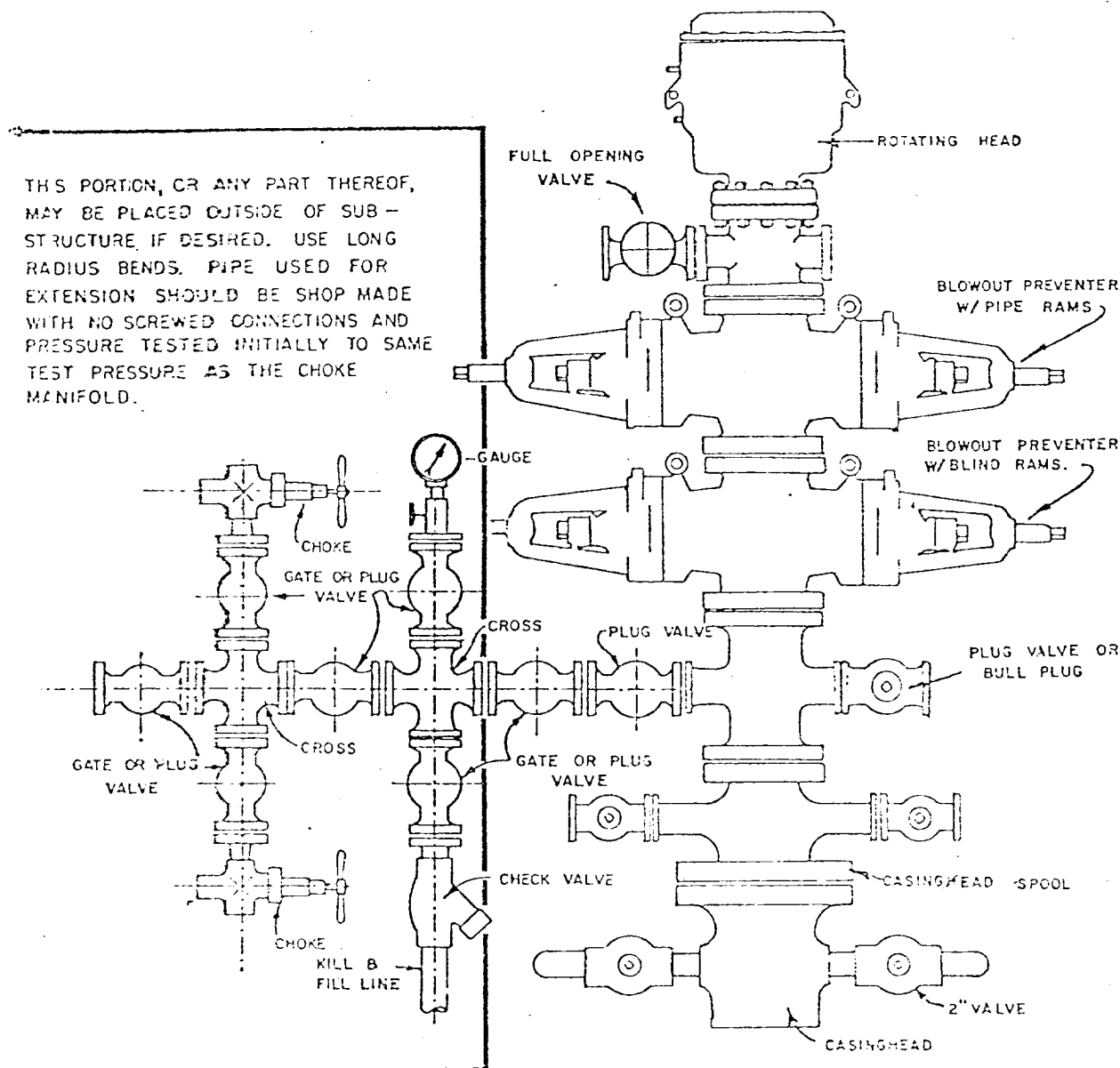

BLOWOUT PREVENTER HOOKUP

API Series # 900

EXHIBIT D-4

OCTOBER 16, 1969

Operation of BOP by closing both pipe and blind rams will be tested each trip or, on long bit runs, pipe rams will be closed once each 24 hours.