

| | |
|------------------------|--|
| NO. OF COPIES RECEIVED | |
| DISTRIBUTION | |
| SANTA FE | |
| FILE | |
| U.S.G.S. | |
| LAND OFFICE | |
| OPERATOR | |

NEW MEXICO OIL CONSERVATION COMMISSION

Form C-103
Supersedes Old
C-102 and C-103
Effective 1-1-65

| | |
|--------------------------------|---|
| 5a. Indicate Type of Lease | |
| State <input type="checkbox"/> | Fee <input checked="" type="checkbox"/> |
| 5. State Oil & Gas Lease No. | |

SUNDRY NOTICES AND REPORTS ON WELLS

(DO NOT USE THIS FORM FOR PROPOSALS TO DRILL OR TO DEEPEN OR PLUG BACK TO A DIFFERENT RESERVOIR.
USE "APPLICATION FOR PERMIT -" (FORM C-101) FOR SUCH PROPOSALS.)

| | | |
|--|--|---|
| 1. <input type="checkbox"/> OIL WELL <input checked="" type="checkbox"/> GAS WELL <input type="checkbox"/> OTHER | | 7. Unit Agreement Name Rosa Unit Com |
| 2. Name of Operator Northwest Pipeline Corporation | | 8. Farm or Lease Name Rosa Unit Com |
| 3. Address of Operator P.O. Box 90, Farmington, N.M. 87401 | | 9. Well No. #90 |
| 4. Location of Well UNIT LETTER <u>G</u> <u>1800</u> FEET FROM THE <u>North</u> LINE AND <u>1810</u> FEET FROM THE <u>East</u> LINE, SECTION <u>33</u> TOWNSHIP <u>32N</u> RANGE <u>6W</u> NMPM. | | 10. Field and Pool, or Wildcat Blanco Mesa Verde |
| 15. Elevation (Show whether DF, RT, GR, etc.) 6388' GR | | 12. County San Juan |

16. Check Appropriate Box To Indicate Nature of Notice, Report or Other Data
NOTICE OF INTENTION TO:

PERFORM REMEDIAL WORK ☐
TEMPORARILY ABANDON ☐
PULL OR ALTER CASING ☐
OTHER ☐

PLUG AND ABANDON ☐
CHANGE PLANS ☐

SUBSEQUENT REPORT OF:

REMEDIAL WORK ☐
COMMENCE DRILLING OPNS. ☐
CASING TEST AND CEMENT JOB ☐
OTHER Name change ☐

17. Describe Proposed or Completed Operations (Clearly state all pertinent details, and give pertinent dates, including estimated date of starting any proposed work) SEE RULE 1103.

The name of the well has been changed from the Rosa Unit #90 to the new name of Rosa Unit Com #90.

This lease will be communitized with the Rosa Unit.

The E/2 of the SE/4 is a Fee lease.

18. I hereby certify that the information above is true and complete to the best of my knowledge and belief.

SIGNED Donna J. Brace TITLE Production Clerk DATE April 8, 1982
Donna J. Brace

APPROVED BY Original Signed By FRANK T. CHAVEZ TITLE SUPERVISOR DISTRICT #1 DATE APR 9 1982

CONDITIONS OF APPROVAL, IF ANY:

All distances must be from the outer boundaries of the Section.

| | | | | | |
|--|--|------------------------|----------------------------------|---------------------------|--|
| Operator NORTHWEST PIPELINE CORPORATION | | | Lease ROSA UNIT COM | | Well No. 90 |
| Unit Letter G | Section 33 | Township 32N | Range 6W | County San Juan | |
| Actual Footage Location of Well: 1800 feet from the North line and 1810 feet from the East line | | | | | |
| Ground Level Elev. 6388 | Producing Formation Mesa Verde | | Pool Blanco Mesa Verde | | Dedicated Acreage: 320 Acres |

1. Outline the acreage dedicated to the subject well by colored pencil or hachure marks on the plat below.
2. If more than one lease is dedicated to the well, outline each and identify the ownership thereof (both as to working interest and royalty).
3. If more than one lease of different ownership is dedicated to the well, have the interests of all owners been consolidated by communitization, unitization, force-pooling, etc?

☒ Yes ☐ No If answer is "yes," type of consolidation Communitized

If answer is "no," list the owners and tract descriptions which have actually been consolidated. (Use reverse side of this form if necessary.)

No allowable will be assigned to the well until all interests have been consolidated (by communitization, unitization, forced-pooling, or otherwise) or until a non-standard unit, eliminating such interests, has been approved by the Commission.

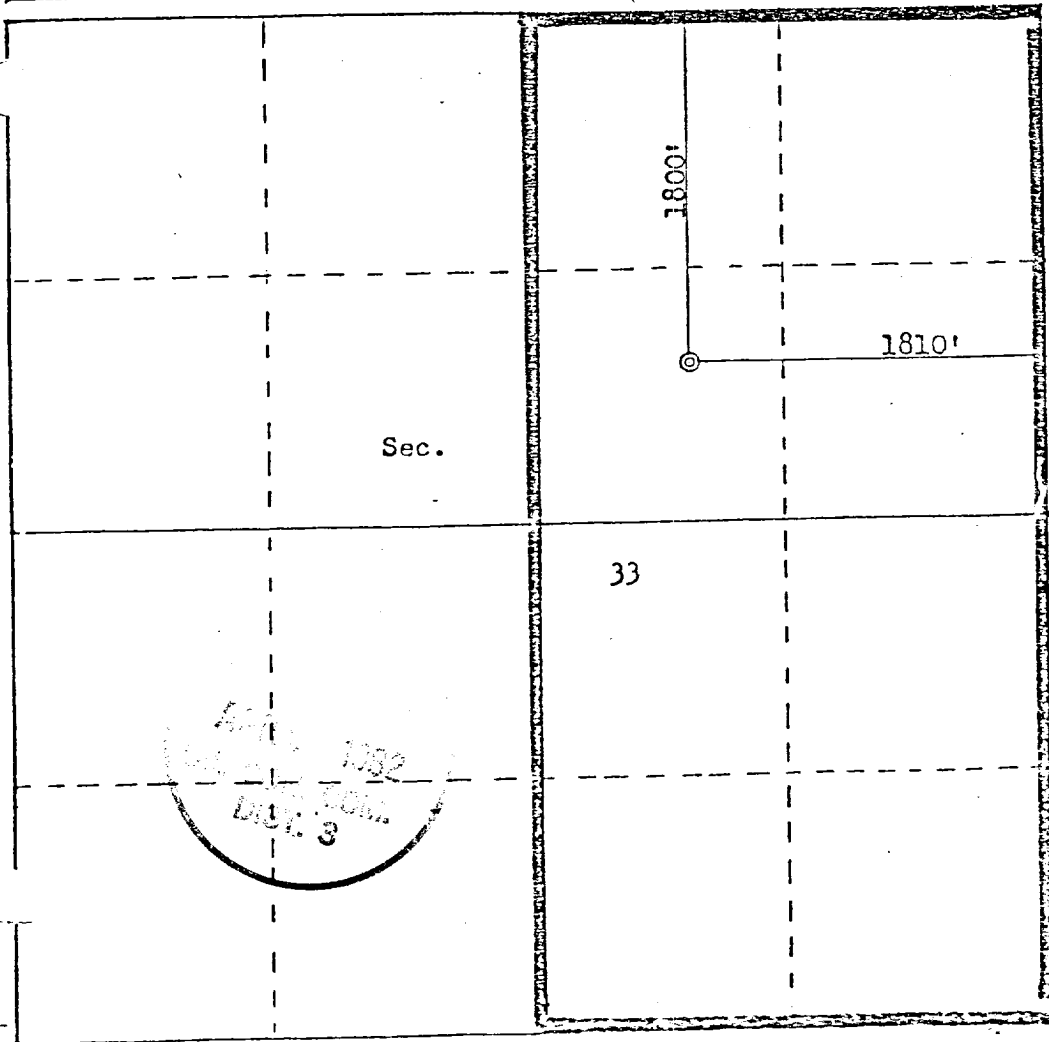

Scale: 1"=1000'

CERTIFICATION

I hereby certify that the information contained herein is true and complete to the best of my knowledge and belief.

Paul C. Thompson

Name

Paul C. Thompson

Position

Drilling Engineer

Company

Northwest Pipeline Corp

Date

March 5, 1981

I hereby certify that the well location shown on this plat was plotted from field notes of actual surveys made by me or under my supervision, and that the same is true and correct to the best of my knowledge and belief.

REGISTERED LAND SURVEYOR
February 21, 1981
Registered Professional Engineer
and Land Surveyor
Fred B. ...
Fred B. ... Jr.

Certificate No.

3950