

UNITED STATES
DEPARTMENT OF THE INTERIOR
GEOLOGICAL SURVEY

APPLICATION FOR PERMIT TO DRILL, DEEPEN, OR PLUG BACK

1a. TYPE OF WORK

DRILL ☒

DEEPEN ☐

PLUG BACK ☐

b. TYPE OF WELL

OIL
WELL ☒

GAS
WELL ☐

OTHER ☐

SINGLE
ZONE ☒

2. NAME OF OPERATOR

Solar Petroleum Inc.

3. ADDRESS OF OPERATOR

One Denver Place, Suite 1300, 919-18th St. Denver

4. LOCATION OF WELL (Report location clearly and in accordance with any State requirements.)

At surface
1330' FSL, 1310' FWL

At proposed prod. zone

14. DISTANCE IN MILES AND DIRECTION FROM NEAREST TOWN OR POST OFFICE*

15 miles NE of Shiprock, New Mexico

15. DISTANCE FROM PROPOSED*

LOCATION TO NEAREST
PROPERTY OR LEASE LINE, FT.
(Also to nearest drlg. unit line, if any) 1310'

18. DISTANCE FROM PROPOSED LOCATION*

TO NEAREST WELL, DRILLING, COMPLETED,
OR APPLIED FOR, ON THIS LEASE, FT.

21. ELEVATIONS (Show whether DF, RT, GR, etc.)

5254 G.L.

PROPOSED CASING AND CEMENTING

SIZE OF HOLE	SIZE OF CASING	WEIGHT PER FOOT	SETTING
12 1/4	8 5/8	23#	60'
6 3/4	4 1/2	10.5#	1000'

Propose to drill with mud, run mechanical and fracture the Gallup formation. A blowout prevention illustration will be used for blow out or checked for proper operation daily.

5. LEASE DESIGNATION AND SERIAL NO.

14-20-603-2033

6. IF INDIAN, ALLOTTEE OR TRIBE NAME

7. UNIT AGREEMENT NAME

8. FARM OR LEASE NAME

Navajo "G"

9. WELL NO.

227

10. FIELD AND POOL, OR WILDCAT

Horseshoe Gallup

11. SEC., T., R., M., OR BLK.
AND SURVEY OR AREA

11-31N-17W

12. COUNTY OR PARISH 13. STATE

San Juan New Mexico

14. ACRES ASSIGNED
TO THIS WELL

Joint with #202

15. LIST OF CABLE TOOLS

22. APPROX. DATE WORK WILL START*

12-1-82

QUANTITY OF CEMENT

1-circulate

1-circulate

15. perforate,
line attached
It will be

IN ABOVE SPACE DESCRIBE PROPOSED PROGRAM: If proposal is to deepen or plug back, give description of productive zone. If proposal is to deepen directionally, give pertinent data on subsurface location, measured and true vertical depths. Give blowout prevention program, if any.

24.

SIGNED

TITLE Agent

DATE 1-29-82

(This space for Federal or State office use)

PERMIT NO.

APPROVAL DATE

APPROVED BY

TITLE

CONDITIONS OF APPROVAL, IF ANY:

Hold C104 for NSL

ch2

NMOCC

APPROVED
NOT AMENDED

DATE JUL 06 1982

JAMES F. SMITH
DISTRICT ENGINEER

All distances must be from the outer boundaries of the Section.

Operator SOLAR PETROLEUM, INCORPORATED			Lease NAVAJO "G"		Well No. 227
Unit Letter L	Section 11	Township 31N	Range 17W	County San Juan	
Actual Footage Location of Well: 1330 feet from the South line and 1310 feet from the West line					
Ground Level Elev. 5254	Producing Formation Horseshoe		Pool Gallup		Dedicated Acreage: 40 joint with #202 Acres

1. Outline the acreage dedicated to the subject well by colored pencil or hatchure marks on the plat below.
2. If more than one lease is dedicated to the well, outline each and identify the ownership thereof (both as to working interest and royalty).
3. If more than one lease of different ownership is dedicated to the well, have the interests of all owners been consolidated by communitization, unitization, force-pooling, etc?

☐ Yes ☐ No If answer is "yes," type of consolidation _____

If answer is "no," list the owners and tract descriptions which have actually been consolidated. (Use reverse side of this form if necessary.) _____

No allowable will be assigned to the well until all interests have been consolidated (by communitization, unitization, forced-pooling, or otherwise) or until a non-standard unit eliminating such interests, has been approved by the Commission.

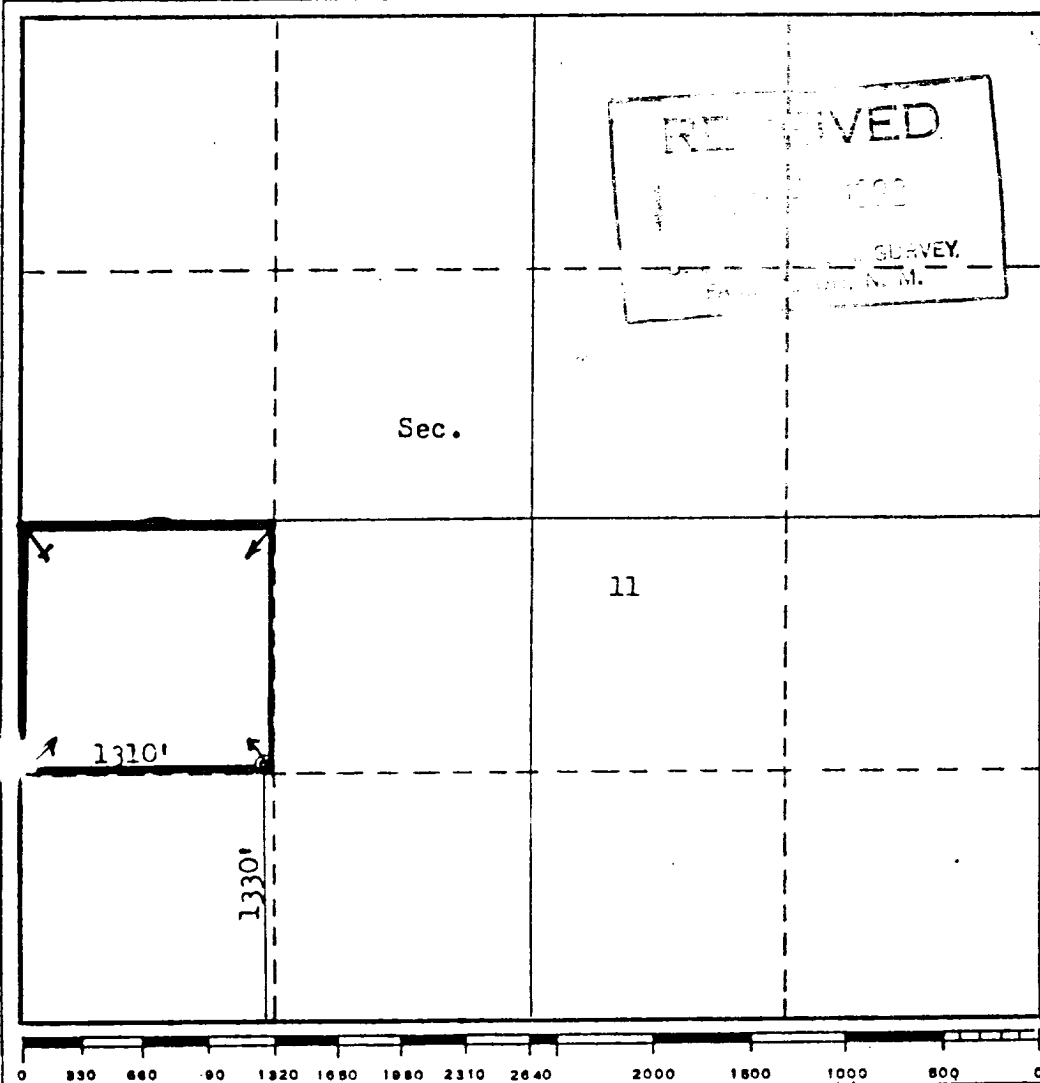

CERTIFICATION

I hereby certify that the information contained herein is true and complete to the best of my knowledge and belief.

Name

Position

Agent

Company

Solar Petroleum, Inc.

Date

1-29-82

I hereby certify that the well location shown on this plat was plotted from field notes of actual surveys made by me or under my supervision, and that the same is true and correct to the best of my knowledge and belief.

Date Surveyed

December 17, 1981

Registered Professional Engineer and/or Land Surveyor

Fred B. Kerr Jr.

Certificate No.

3950