



STATE OF NEW MEXICO
ENERGY AND MINERALS DEPARTMENT

OIL CONSERVATION DIVISION
AZTEC DISTRICT OFFICE

Handwritten: well file

1000 RIO BRAZOS ROAD
AZTEC, NEW MEXICO 87410
(505) 334-6178

OIL CONSERVATION DIVISION
BOX 2088
SANTA FE, NEW MEXICO 87501

DATE 11-2-82

RE: Proposed MC _____
Proposed DHC _____
Proposed NSL ✓ _____
Proposed SWD _____
Proposed WFX _____
Proposed PMX _____

Gentlemen:

I have examined the application dated 10-25-82
for the Bayless Stribling #2 N-31-31N-13W
Operator Lease and Well No. Unit, S-T-R

and my recommendations are as follows:

Approve, nonstandard unit makes it impossible for a
standard location

Yours truly,

Jeff A. Edmister

ROBERT L. BAYLESS

PETROLEUM PLAZA BUILDING
P. O. BOX 1541
FARMINGTON, NEW MEXICO 87401
(505) 326-2659

October 22, 1982

New Mexico Oil Conservation
Commission
P.O. Box 2088
Santa Fe, NM 87501

Attn: Joe Ramey

RE: Stribling #2

Gentlemen:

We request administrative approval of an unorthodox location for a Dakota formation gas well.

You will note from the enclosed plat that the proration unit is a long narrow strip set up by your Order R-2046. Because the width of the tract is only 1,498 feet, it is impossible to comply with the regulation calling for the location to be no closer than 790 feet from the nearest lease line. By copy of this letter to offset leaseholders we are asking they waive any objection to this location.

Yours truly,

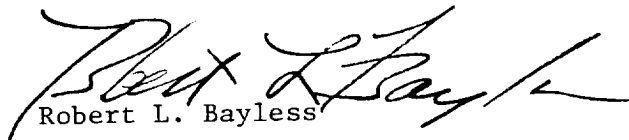
Robert L. Bayless

RLB/lb

Enclosures

cc: Anslie Perrault
El Paso Natural Gas Co.
Marathon Oil Co.
Beard Oil Co.
Merrion Oil & Gas
NMOCC, Aztec

The undersigned has no objection
to the above location.

Company

Signature

Date

If you concur and have no objection,
please sign and return a copy of this
letter to the NMOCC in Santa Fe,
Attn: Joe Ramey.

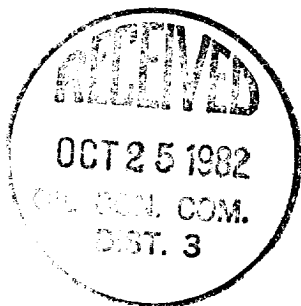
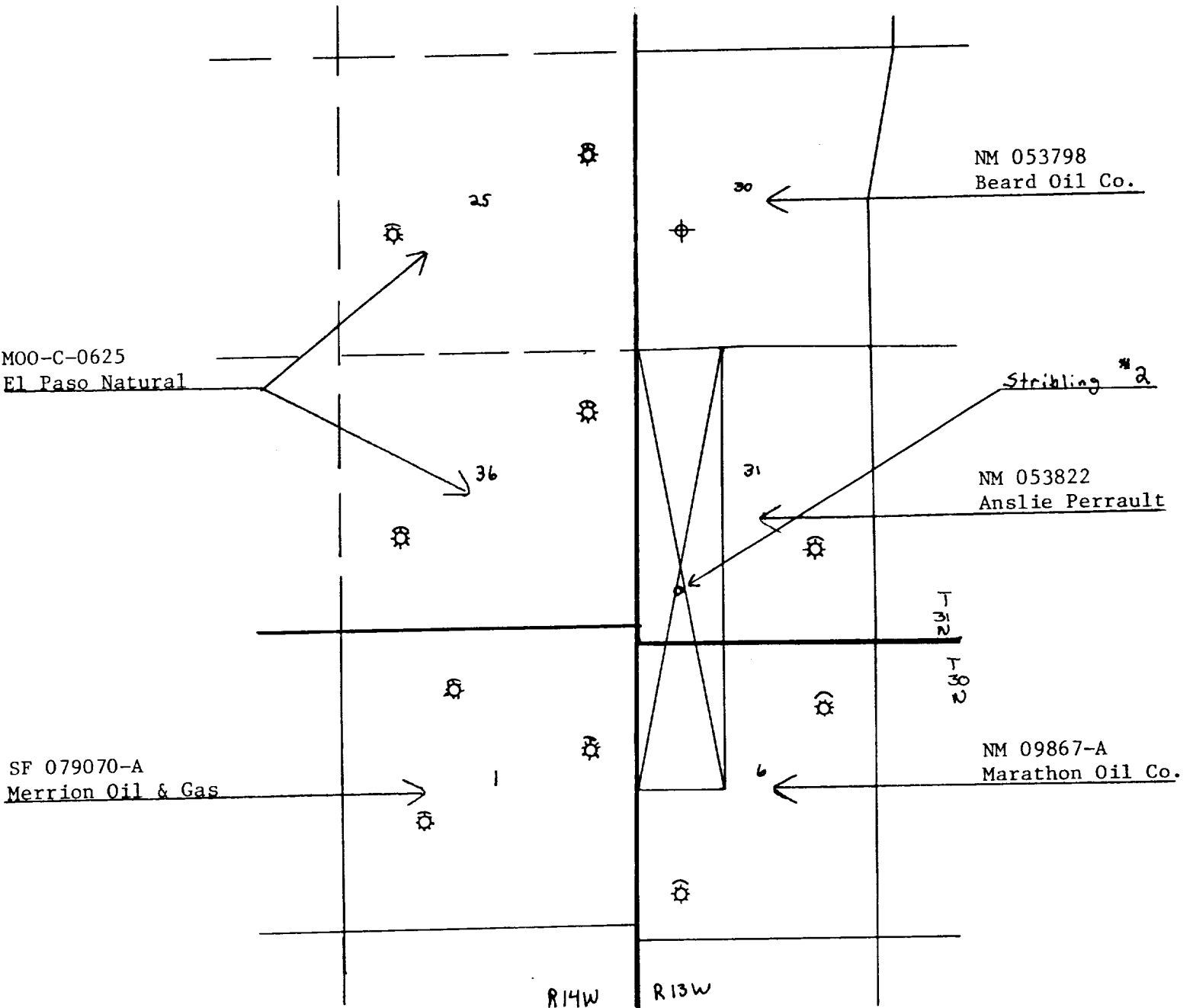

EXHIBIT 'A'

W $\frac{1}{2}$ Section 31, Township 31 North, Range 13 West
San Juan County, New Mexico



To be attached to Waiver letter
for unorthodox location of
Stribling #2



NEW MEXICO OIL CONSERVATION COMMISSION
WELL LOCATION AND ACREAGE DEDICATION PLAT

Supersedes C-128
Effective 1-1-65

All distances must be from the outer boundaries of the Section.

Operator Robert L. Bayless		Lease Stribling		Well No. 2
Unit Letter N	Section 31	Township 31 North	Range 13 West	County San Juan
Actual Footage Location of Well:				
1100	feet from the South	line and	650	feet from the West line
Ground Level Elev. 5823	Producing Formation Dakota	Pool Basin Dakota	Dedicated Acreage: (See attached plat) 322 Acres	

1. Outline the acreage dedicated to the subject well by colored pencil or hachure marks on the plat below.
2. If more than one lease is dedicated to the well, outline each and identify the ownership thereof (both as to working interest and royalty).
3. If more than one lease of different ownership is dedicated to the well, have the interests of all owners been consolidated by communitization, unitization, force-pooling, etc?

☒ Yes ☐ No If answer is "yes," type of consolidation Communitization agreement

If answer is "no," list the owners and tract descriptions which have actually been consolidated. (Use reverse side of this form if necessary.) _____

No allowable will be assigned to the well until all interests have been consolidated (by communitization, unitization, forced-pooling, or otherwise) or until a non-standard unit, eliminating such interests, has been approved by the Commission.

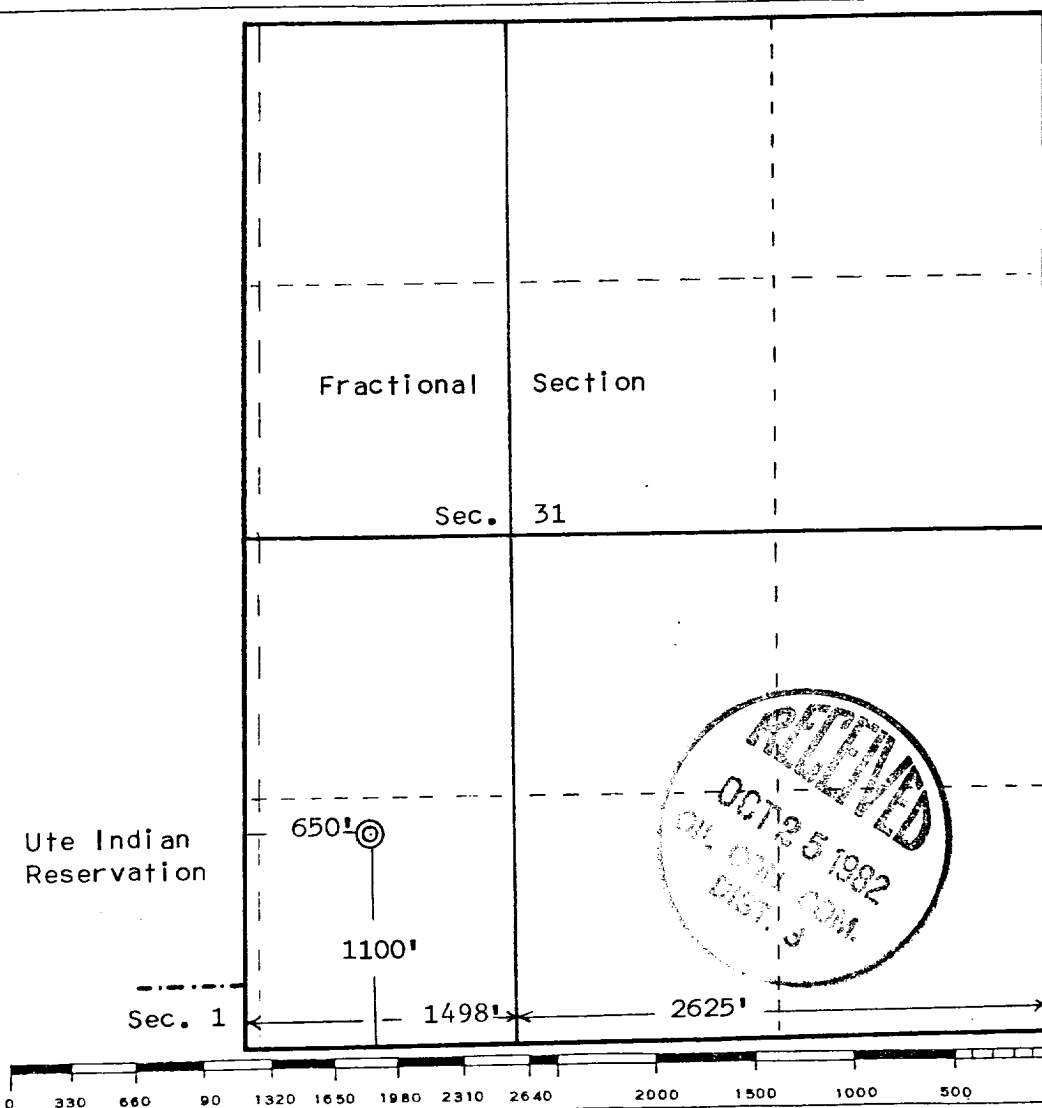

CERTIFICATION	
I hereby certify that the information contained herein is true and complete to the best of my knowledge and belief.	
Name	Robert L. Bayless
Position	Owner
Company	Robert L. Bayless
Date	August 31, 1982
I hereby certify that the location shown on this plat was from field notes of actual survey made by me or under my supervision, and that the same is true and correct to the best of my knowledge and belief.	
Date Surveyed	April 21, 1982
Registered Professional Engineer and/or Land Surveyor	
Edgar L. Risenhoover	
Certificate No.	5979
Edgar L. Risenhoover, L.S.	