

UNITED STATES
DEPARTMENT OF THE INTERIOR
GEOLOGICAL SURVEY

APPLICATION FOR PERMIT TO DRILL, DEEPEN, OR PLUG BACK

1a. TYPE OF WORK DRILL <input checked="" type="checkbox"/> DEEPEN <input type="checkbox"/> PLUG BACK <input type="checkbox"/>		5. LEASE DESIGNATION AND SERIAL NO. NM-021127	
b. TYPE OF WELL OIL WELL <input type="checkbox"/> GAS WELL <input checked="" type="checkbox"/> OTHER <input type="checkbox"/>		6. IF INDIAN, ALLOTTEE OR TRIBE NAME	
2. NAME OF OPERATOR Amoco Production Co.		7. UNIT AGREEMENT NAME	
3. ADDRESS OF OPERATOR 501 Airport Drive, Farmington, NM 87401		8. FARM OR LEASE NAME Stanolind "A"	
4. LOCATION OF WELL (Report location clearly and in accordance with any State requirements.) At surface 1030' FSL x 1450' FEL At proposed prod. zone Same		9. WELL NO. 1A	
14. DISTANCE IN MILES AND DIRECTION FROM NEAREST TOWN OR POST OFFICE* 6 miles N.E. of Flora Vista		10. FIELD AND POOL, OR WILDCAT Blanco Mesaverde	
15. DISTANCE FROM PROPOSED* LOCATION TO NEAREST PROPERTY OR LEASE LINE, FT. (Also to nearest drlg. unit line, if any) 1030'		11. SEC., T., R., M., OR BLK. AND SURVEY OR AREA SW/SE Sec. 29, T31N, R12W	
16. NO. OF ACRES IN LEASE 320		12. COUNTY OR PARISH San Juan	
17. NO. OF ACRES ASSIGNED TO THIS WELL L=320		13. STATE NM	
18. DISTANCE FROM PROPOSED LOCATION* TO NEAREST WELL, DRILLING, COMPLETED, OR APPLIED FOR, ON THIS LEASE, FT. 300' W		20. ROTARY OR CABLE TOOLS Rotary	
21. ELEVATIONS (Show whether DP, RT, GR, etc.) 6041' GR		22. APPROX. DATE WORK WILL START* As soon as permitted	
23. PROPOSED CASING AND CEMENTING PROGRAM		This action is subject to administrative appeal pursuant to 30 CFR 290.	
SIZE OF HOLE	SIZE OF CASING	WEIGHT PER FOOT	SETTING DEPTH
12-1/4"	8-5/8"	24# K-55	300'
7-7/8"	4-1/2"	10.5# K-55	5100'
		300 sx C1 B 2% CaCl ₂	
		200 sx C1 B Neat	
		300 sx C1 B 50:50 poz 6% gel	
		700 sx C1 B 65:35 poz 6% gel	

Amoco proposes to drill the above well to further develop the Blanco Mesaverde reservoir. The well will be drilled to the surface casing point using native mud. The well will then be drilled to TD with a low solids nondispersed mud system. Completion design will be based on open hole logs. Copy of all logs will be filed upon completion. Amoco's standard blowout prevention will be employed; see attached drawing for blowout preventer design. Upon completion the well site will be cleaned and the reserve pit filled and leveled.

The gas from this well is dedicated to El Paso Natural Gas under contract No. 17568.

IN ABOVE SPACE DESCRIBE PROPOSED PROGRAM: If proposal is to deepen or plug back, give data on present productive zone and proposed new productive zone. If proposal is to drill or deepen directionally, give pertinent data on subsurface locations and measured and true vertical depths. Give blowout prevention program, if any.

24. SIGNED Ed L. Lawton TITLE District Admin. Supervisor DATE 02-15-84
(This space for Federal or State office use)

PERMIT NO. _____ APPROVAL DATE _____

APPROVED BY _____ TITLE _____
CONDITIONS OF APPROVAL, IF ANY: _____

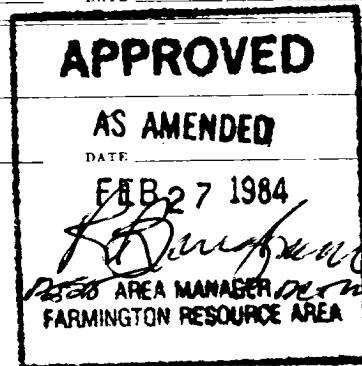

NMOCC

All distances must be from the outer boundaries of the Section.

Operator Amoco Production Company			Lease Stanolind A		Well No. 1A
Unit Letter 0	Section 29	Township 31N	Range 12W	County San Juan	
Actual Footage Location of Well: 1030 feet from the South line and 1450 feet from the East line					
Ground Level Elev: 6041	Producing Formation Mesaverde		Pool Blanco		Dedicated Acreage: 320 Acres

1. Outline the acreage dedicated to the subject well by colored pencil or hatchure marks on the plat below.

2. If more than one lease is dedicated to the well, outline each and identify the ownership thereof (both as to working interest and royalty).

3. If more than one lease of different ownership is dedicated to the well, have the interests of all owners been consolidated by communitization, unitization, force-pooling, etc?

☐ Yes ☐ No If answer is "yes," type of consolidation _____

If answer is "no," list the owners and tract descriptions which have actually been consolidated. (Use reverse side of this form if necessary.) _____

No allowable will be assigned to the well until all interests have been consolidated (by communitization, unitization, forced-pooling, or otherwise) or until a non-standard unit, eliminating such interests, has been approved by the Commission.

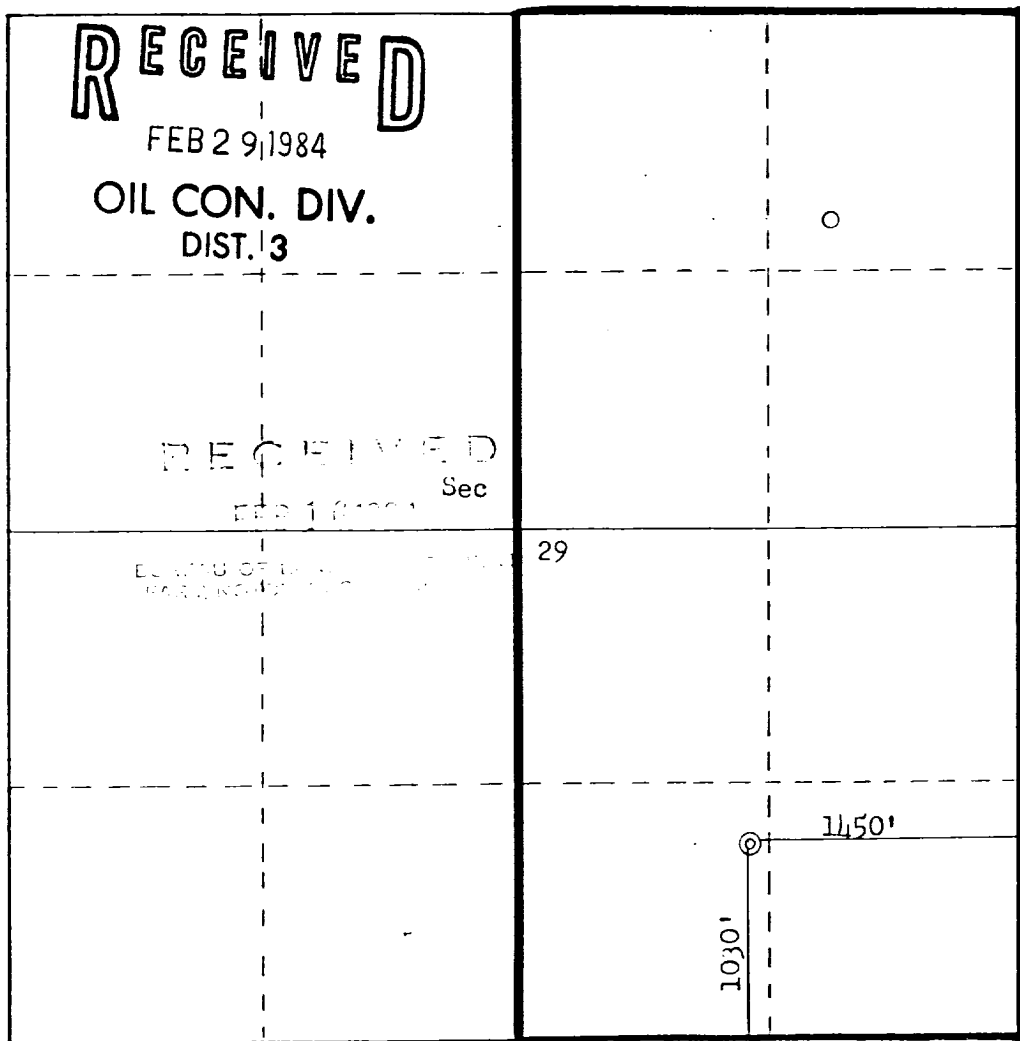

Scale: 1"=1000'

CERTIFICATION	
I hereby certify that the information contained herein is true and complete to the best of my knowledge and belief.	
<i>Darrell D. Lawson</i>	
Name	Darrell D. Lawson
Position	Dist. Adm. Supervisor
Company	Amoco Production Company
Date	02-13-84
I hereby certify that the well location shown on this plat was plotted from field notes of actual surveys made by me or under my supervision, and that the same is true and correct to the best of my knowledge and belief.	
Date Surveyed	January 10, 1984
Registered Professional Engineer and Land Surveyor	<i>Fred B. Kerr Jr.</i>
Certificate No.	3950