

Caller Service 4104  
Farmington, New Mexico 87499

Consolidated Oil and Gas, Inc.  
P. O. Box 2038  
Farmington, New Mexico 87499

Gentlemen:

Reference is made to the attached Sundry Notice for the following wells:

1. 2-E Payne, SW/4NW/4 sec. 35, T. 31 N., R. 13 W., San Juan County, New Mexico, lease SF-078463-A.
2. 3-E Payne, NW/4NW/4 sec. 26, T. 31 N., R. 13 W., San Juan County, New Mexico, lease SF-078464.
3. 1-E Nance, SE/4SW/4 sec. 27, T. 31 N., R. 13 W., San Juan County, New Mexico, lease SF-078463.
4. 1-E Leads, SW/4NW/4 sec. 8, T. 31 N., R. 12 W., San Juan County, New Mexico, lease NM-021123.

The above mentioned wells perforated the Gallup formation without prior approval from this office and our Albuquerque District Office is pursuing the matter. The intentions to complete into the Gallup formation are hereby approved after the fact.

Sincerely yours,

(Sgd.) WALTER B. HOLLENBACK

Area Manager

cc:  
NMOCC/

Form 3160-5  
(November 1983)  
(Formerly 9-331)

UNITED STATES  
DEPARTMENT OF THE INTERIOR  
BUREAU OF LAND MANAGEMENT

SUBMIT IN TRIPLICATE\*  
(Other instructions on reverse side)

Form approved.  
Budget Bureau No. 1004-0135  
Expires August 31, 1985

SUNDRY NOTICES AND REPORTS ON WELLS

(Do not use this form for proposals to drill or to deepen or plug back to a different reservoir.  
Use "APPLICATION FOR PERMIT—" for such proposals.)

1. OIL WELL <input type="checkbox"/> GAS WELL <input checked="" type="checkbox"/> OTHER	5. LEASE DESIGNATION AND SERIAL NO. SF 078464
2. NAME OF OPERATOR Consolidated Oil & Gas, Inc.	6. IF INDIAN, ALLOTTEE OR TRIBE NAME
3. ADDRESS OF OPERATOR P.O. Box 2038, Farmington, New Mexico 87499	7. UNIT AGREEMENT NAME
4. LOCATION OF WELL (Report location clearly and in accordance with any State requirements.* See also space 17 below.) At surface 850' FNL & 840' FWL	8. FARM OR LEASE NAME PAYNE
14. PERMIT NO. API # 30-045-25953	9. WELL NO. 3E
15. ELEVATIONS (Show whether DF, RT, GR, etc.) 5660' KB	10. FIELD AND POOL, OR WILDCAT Flora Vista Gallup
	11. SEC., T., R., M., OR BLK. AND SURVEY OR AREA Sec 26, T31N, R13W
	12. COUNTY OR PARISH San Juan
	13. STATE N.M.

16.

Check Appropriate Box To Indicate Nature of Notice, Report, or Other Data

NOTICE OF INTENTION TO:

TEST WATER SHUT-OFF <input type="checkbox"/>	PULL OR ALTER CASING <input type="checkbox"/>
FRACTURE TREAT <input type="checkbox"/>	MULTIPLE COMPLETE <input checked="" type="checkbox"/>
SHOOT OR ACIDIZE <input type="checkbox"/>	ABANDON* <input type="checkbox"/>
REPAIR WELL <input type="checkbox"/>	CHANGE PLANS <input type="checkbox"/>
(Other) <input type="checkbox"/>	

SUBSEQUENT REPORT OF:

WATER SHUT-OFF <input type="checkbox"/>	REPAIRING WELL <input type="checkbox"/>
FRACTURE TREATMENT <input type="checkbox"/>	ALTERING CASING <input type="checkbox"/>
SHOOTING OR ACIDIZING <input type="checkbox"/>	ABANDONMENT* <input type="checkbox"/>
(Other) <input type="checkbox"/>	

(Note: Report results of multiple completion on Well Completion or Recompletion Report and Log form.)

17. DESCRIBE PROPOSED OR COMPLETED OPERATIONS (Clearly state all pertinent details, and give pertinent dates, including estimated date of starting any proposed work. If well is directionally drilled, give subsurface locations and measured and true vertical depths for all markers and zones pertinent to this work.)\*

This well has been drilled to a TD of 6686' KB (Dakota). It is our intent to perforate and stimulate the Gallup formation (approximately 5500' to 5800'), and complete as a dual well.

RECEIVED

JUN 07 1984

BUREAU OF LAND MANAGEMENT  
FARMINGTON FIELD OFFICE

RECEIVED  
JUN 11 1984  
FARMINGTON  
CR-100

18. I hereby certify that the foregoing is true and correct

SIGNED L. A. L. L.

TITLE Prod. & Drilg. Technician DATE 5-15-84

(This space for Federal or State office use)

APPROVED BY \_\_\_\_\_  
CONDITIONS OF APPROVAL, IF ANY:

TITLE \_\_\_\_\_

DATE \_\_\_\_\_

MOCC

\*See Instructions on Reverse Side

Title 18 U.S.C. Section 1001, makes it a crime for any person knowingly and willfully to make to any department or agency of the United States any false, fictitious or fraudulent statements or representations as to any matter within the jurisdiction of such department or agency.



All distances must be from the outer boundaries of the Section.

Operator <b>CONSOLIDATED OIL &amp; GAS, INC.</b>			Lease <b>PAYNE</b>		Well No. <b>3E</b>
Unit Letter <b>D</b>	Section <b>26</b>	Township <b>31 NORTH</b>	Range <b>13 WEST</b>	County <b>SAN JUAN</b>	
Actual Footage Location of Well:					
<b>850</b> feet from the <b>NORTH</b> line and		<b>940</b> feet from the <b>WEST</b> line			
Ground Level Elev. <b>5645</b>	Producing Formation <b>Gallup</b>	Pool <b>Flora Vista Gallup</b>		Dedicated Acreage: <b>171.77</b> <b>150</b>	

1. Outline the acreage dedicated to the subject well by colored pencil or hatchure marks on the plat below.
2. If more than one lease is dedicated to the well, outline each and identify the ownership thereof (both as to work interest and royalty).
3. If more than one lease of different ownership is dedicated to the well, have the interests of all owners been consolidated by communitization, unitization, force-pooling, etc?

☐ Yes ☐ No If answer is "yes," type of consolidation \_\_\_\_\_

If answer is "no," list the owners and tract descriptions which have actually been consolidated. (Use reverse side of this form if necessary.) \_\_\_\_\_

No allowable will be assigned to the well until all interests have been consolidated (by communitization, unitization, forced-pooling, or otherwise) or until a non-standard unit, eliminating such interests, has been approved by the Division.

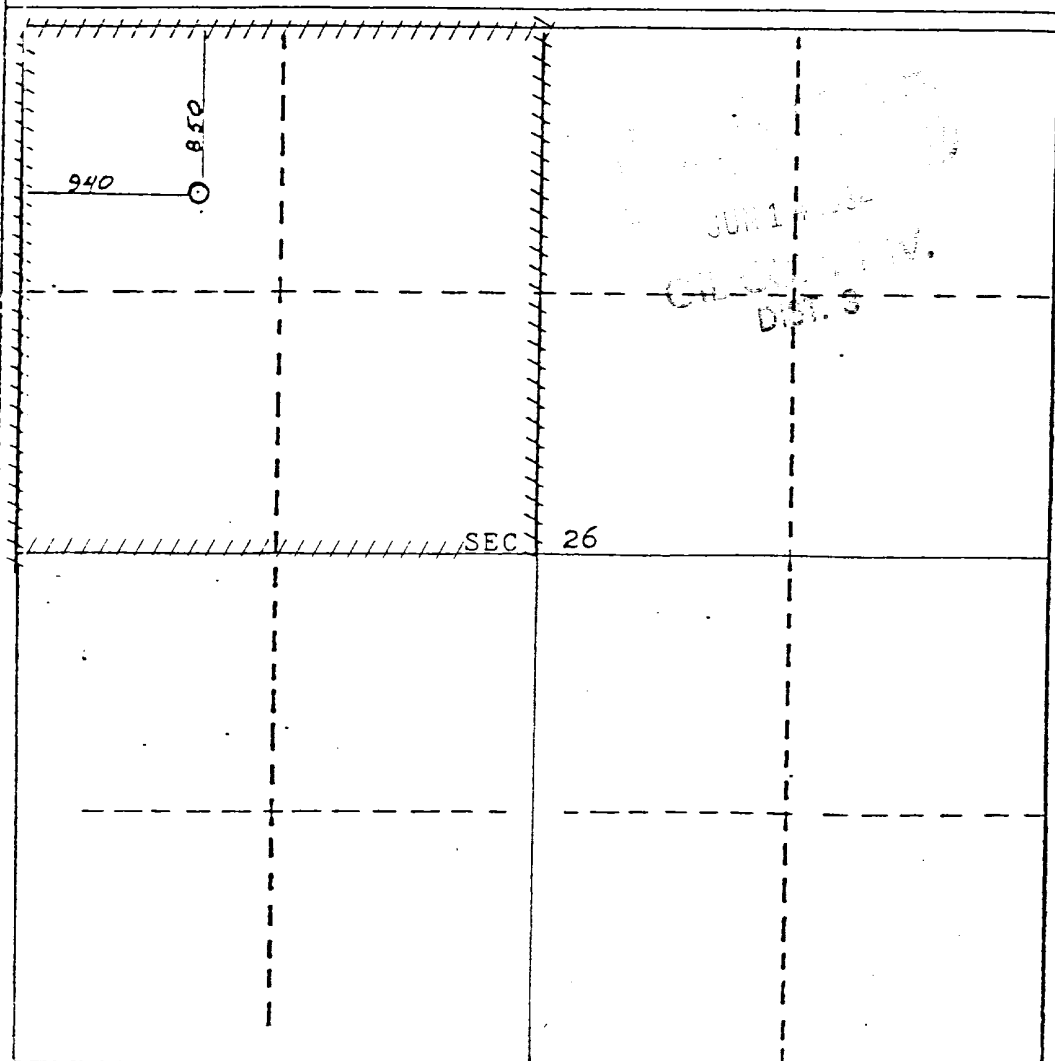

CERTIFICATION

I hereby certify that the information contained herein is true and complete to best of my knowledge and belief.

*Benny L. L...*  
Name

Drilling Foreman  
Position

Consolidated Oil & Gas, Inc.  
Company

March 27, 1984  
Date

I hereby certify that the well location shown on this plat was plotted from field notes made by me under my supervision and that the same are true to the best of my knowledge and belief.

*Michael Daly*  
Date Surveyed  
March 27, 1984

Registered Professional Engineer and/or Land Surveyor

Michael Daly

Certification No.  
EQ92

