

STATE OF NEW MEXICO
ENERGY AND MINERALS DEPARTMENT

OIL CONSERVATION DIVISION

P. O. BOX 2088

SANTA FE, NEW MEXICO 87501

Form C-101
Revised 10-1-78

5A. Indicate Type of Lease
STATE ☐ FEDERAL ☒

5. State Oil & Gas Lease No.

7. Unit Agreement Name

8. Name of Lessee Name Gas
WALLACE
Charley Kiecke Com

9. Well No.

1EA

10. Field and Pool, or Wildcat
Blanco MV/Basin Dk

12. County

San Juan

APPLICATION FOR PERMIT TO DRILL, DEEPEN, OR PLUG BACK

1a. Type of Work

DRILL ☒

DEEPEN ☐

PLUG BACK ☐

b. Type of Well

OIL WELL ☐

GAS WELL ☒

OTHER

SINGLE ZONE ☐

MULTIPLE ZONE ☒

2. Name of Operator

Amoco Production Co.

3. Address of Operator

501 Airport Drive, Farmington, N M 87401

4. Location of Well

UNIT LETTER C LOCATED 1140 FEET FROM THE North LINE

AND 1640 FEET FROM THE West LINE OF SEC. 35 TWP. 31N RGE. 11W

13. Proposed Depth

6743'

13A. Formation

M.V./Dakota

20. Rotary or C.T.

Rotary

21. Elevations (Show whether DH, RL, etc.)

5683' GR

21A. Ring & Status Plug. Bond

Statewide

21B. Drilling Contractor

Unknown

22. Approx. Date Work will start

Unknown

23. PROPOSED CASING AND CEMENT PROGRAM

SIZE OF HOLE	SIZE OF CASING	WEIGHT PER FOOT	SETTING DEPTH	SACKS OF CEMENT	EST. TOP
12 1/4"	9 5/8"	36# K-55	300'	300 Sx	Surface
8 3/4"	7"	20# K-55	6743'	1200 Sx	Surface

Amoco proposes to drill the above well to further develop the Blanco Mesaverde and the Basin Dakota reservoir. The well will be drilled to the surface casing point using native mud. The well will then be drilled to TD with a low solids nondispersed mud system. Completion design will be based on open hole logs. Copy of all logs will be filed upon completion. Amoco's standard blowout prevention will be employed. Upon completion the well site will be cleaned and the reserve pit filled and leveled. The gas from this well is dedicated to El Paso Natural Gas Company.

APPROVAL EXPIRES 8-21-86
UNLESS DRILLING IS COMMENCED.
SPUD NOTICE MUST BE SUBMITTED
WITHIN 10 DAYS.

RECEIVED
FEB 20 1986

OIL CON. DIV.
DIST. 3

IN ABOVE SPACE DESCRIBE PROPOSED PROGRAM: IF PROPOSAL IS TO DEEPEN OR PLUG BACK, GIVE DATA ON PRESENT PRODUCTION ZONE AND PROPOSED NEW PRODUCTION ZONE. GIVE BLOWOUT PREVENTION PROGRAM, IF ANY.

I hereby certify that the information above is true and complete to the best of my knowledge and belief.

Signed BS Shaw Title Adm. Supervisor Date 2-6-86

(This space for State Use)

APPROVED BY ORIGINAL SIGNED BY ERNIE BUSCH TITLE GEOLOGIST DISTRICT #3 DATE FEB 21 1986

CONDITIONS OF APPROVAL, IF ANY:

OIL CONSERVATION DIVISION

STATE OF NEW MEXICO
ENERGY AND MINERALS DEPARTMENTP. O. BOX 2088
SANTA FE, NEW MEXICO 87501Form C-102
Revised 10-1-78

All distances must be from the outer boundaries of the Section.

Operator AMOCO PRODUCTION COMPANY		Lease WALLACE GAS CO. #1 CHARLEY RIECKE GAS COM A		Well No. #1EA
Unit Letter C	Section 35	Township 31 NORTH	Range 11 WEST	County SAN JUAN
Actual Footage Location of Well: 1140 feet from the NORTH line and 1640 feet from the WEST line				
Ground Level Elev. 5683	Producing Formation Mesaverde/Dakota	Pool Blanco Mesaverde/Basin Dk	Dedicated Acreage 320/320 Acres	

1. Outline the acreage dedicated to the subject well by colored pencil or hachure marks on the plat below.
2. If more than one lease is dedicated to the well, outline each and identify the ownership thereof (both as to working interest and royalty).
3. If more than one lease of different ownership is dedicated to the well, have the interests of all owners been consolidated by communitization, unitization, force-pooling, etc?

☐ Yes ☐ No If answer is "yes," type of consolidation _____

If answer is "no," list the owners and tract descriptions which have actually been consolidated. (Use reverse side of this form if necessary.) _____

No allowable will be assigned to the well until all interests have been consolidated (by communitization, unitization, forced-pooling, or otherwise) or until a non-standard unit, eliminating such interests, has been approved by the Division.

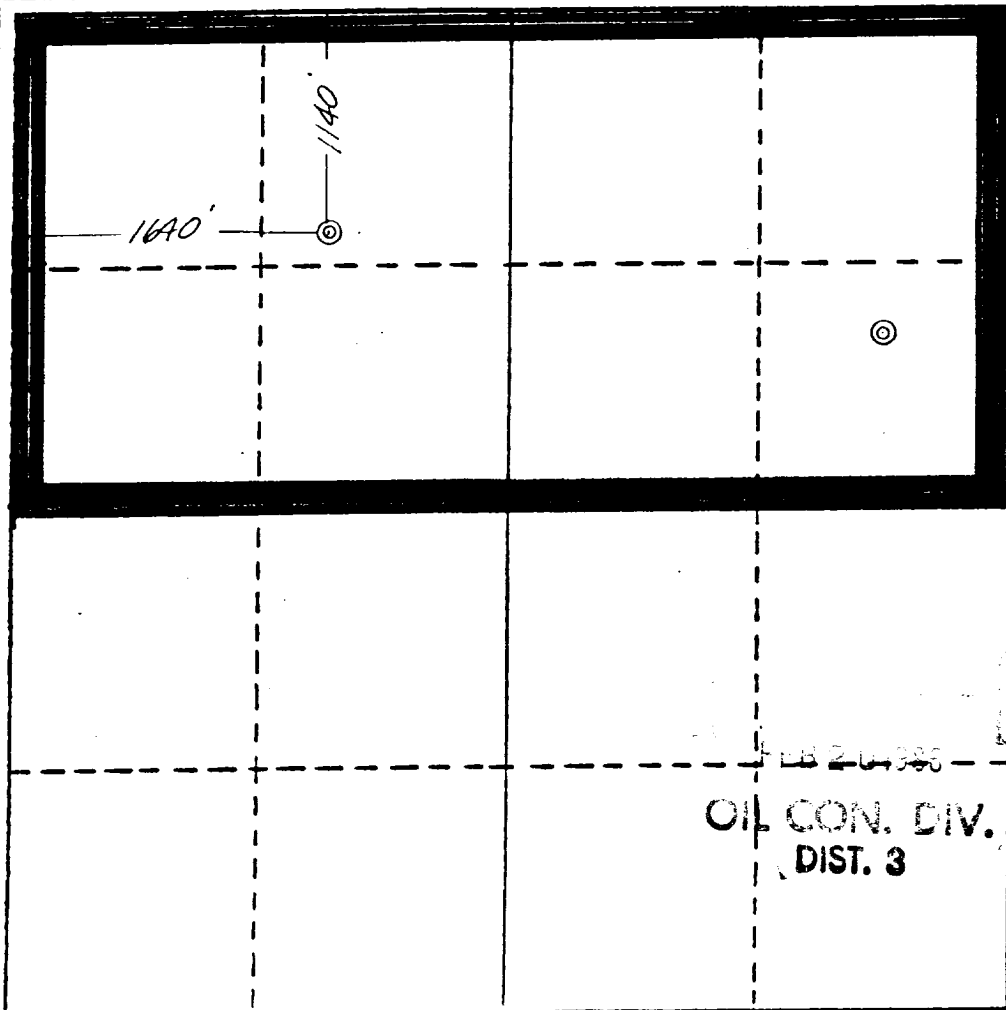

CERTIFICATION

I hereby certify that the information contained herein is true and complete to the best of my knowledge and belief.

B. D. Shaw

Name

B. D. Shaw

Position

Adm. Supervisor

Company

Amoco Production Co.

Date

February 7, 1986

I hereby certify that the location shown on this plat was plotted from field notes of a duly licensed surveyor or under my supervision, and that the same is true and correct to the best of my knowledge and belief.

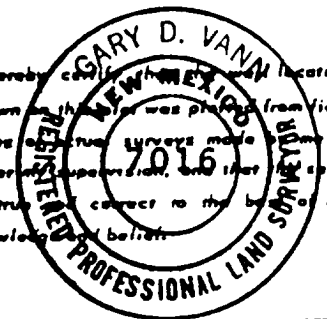

Date Surveyed

JANUARY 8, 1986

Registered Professional Engineer
and/or Land Surveyor

Gary D. Vann

Certificate No.

7016

0 330 660 990 1320 1650 1980 2310 2640 2970 3300 3630 3960 4290 4620 4950 5280 5610 5940 6270 6600

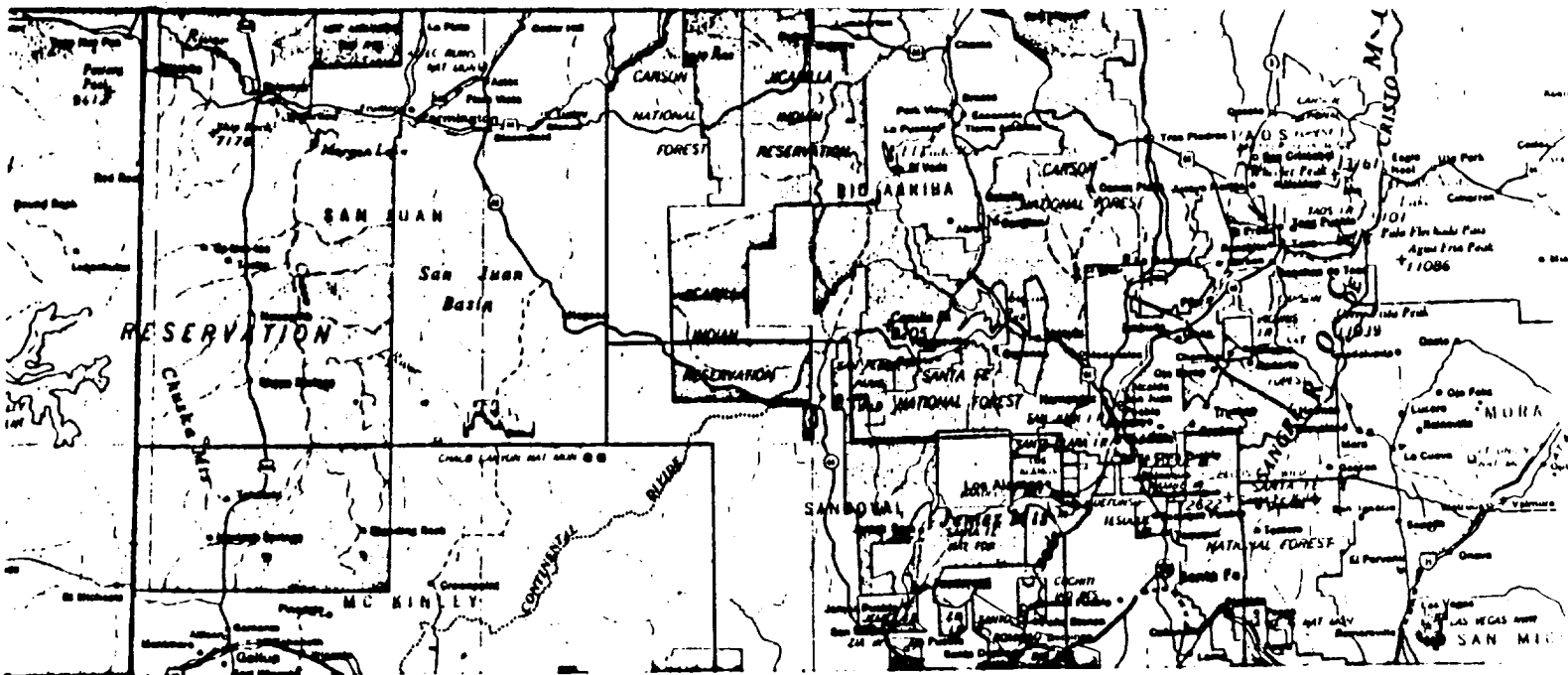

CHARLEY RIECKE GAS COM A #1E
 1140' F/NL 1640' F/WL
 SEC. 35, T31N, R11W, NMPPM
 RAIL POINT: 144 mi. Montrose, Colo.
 MUD POINT: 3 mi. Aztec, N.M.
 CEMENT POINT: 17 mi. Farmington, N.M.

