

UNITED STATES
DEPARTMENT OF THE INTERIOR
BUREAU OF LAND MANAGEMENT

APPLICATION FOR PERMIT TO DRILL, DEEPEN, OR PLUG BACK

1a. TYPE OF WORK

DRILL ☒

DEEPEN ☐

PLUG BACK ☐

b. TYPE OF WELL

OIL
WELL ☐

GAS
WELL ☒

OTHER

SINGLE
ZONE ☒

MULTIPLE
ZONE ☒

2. NAME OF OPERATOR

Wintershall Corporation

(303) 694-0988

3. ADDRESS OF OPERATOR

5251 DTC Pkwy., Ste. 500, Englewood, Co. 80111

4. LOCATION OF WELL (Report location clearly and in accordance with any State requirements.)*

At surface

1090' FSL & 790' FEL (SESE)

At proposed prod. zone

Same

14. DISTANCE IN MILES AND DIRECTION FROM NEAREST TOWN OR POST OFFICE*

9 air miles NNE of Kirtland, New Mexico

15. DISTANCE FROM PROPOSED*

LOCATION TO NEAREST
PROPERTY OR LEASE LINE, FT.
(Also to nearest drlg. unit line, if any)

790'

16. NO. OF ACRES IN LEASE

250,000+

17. NO. OF ACRES ASSIGNED
TO THIS WELL

5-320

18. DISTANCE FROM PROPOSED LOCATION*

TO NEAREST WELL, DRILLING, COMPLETED,
OR APPLIED FOR, ON THIS LEASE, FT.

1+ mi.

19. PROPOSED DEPTH

6,150'

20. ROTARY OR CABLE TOOLS

Rotary

21. ELEVATIONS (Show whether DF, RT, GR, etc.)

5,612' ungraded

22. APPROX. DATE WORK WILL START*

Mar. 1, 1987

23. PROPOSED CASING AND CEMENTING PROGRAM

SIZE OF HOLE	SIZE OF CASING	WEIGHT PER FOOT	SETTING DEPTH	QUANTITY OF CEMENT
12 1/4"	9 5/8"	36#	240'	Cement to Surface
7 1/4"	4 1/2"	10.5#	6150'	2 Stage 0'-3600' 200-50

1. Revised APD (Form 3160-3) and Plat (Form C-102) submitted to
reflect following changes:

- Wintershall Petroleum Corporation has changed its name to
Wintershall Corporation.
- Wintershall's new address is shown above.
- Wintershall's new Area Superintendent is Fred J. Clausen. The
Area Superintendent's office remains the same.
- Spacing changed from 160 acres to 320 acres to conform with
Order R-8170, effective 4-1-86.

2. No other changes in original APD submitted in March, 1986.

IN ABOVE SPACE DESCRIBE PROPOSED PROGRAM: If proposal is to deepen or plug back, give data on present productive zone and proposed new productive zone. If proposal is to drill or deepen directionally, give pertinent data on subsurface locations and measured and true vertical depths. Give blowout preventer program, if any.

24.

SIGNED

Area Superintendent

2-17-87

(This space for Federal or State office use)

PERMIT NO.

PROVAL DATE

APPROVED BY

L. Mark Hollis

ACTING

AREA MANAGER

DATE FEB 24 1987

CONDITIONS OF APPROVAL, IF ANY:

cc: BIA (1), BLM (3), Clausen (3), Howell (3), NMOCD (2), Ute Mt. Tribe (1)

DURANGO OFFICE COPY

*See Instructions On Reverse Side

NEW MEXICO OIL CONSERVATION COMMISSION
WELL LOCATION AND ACREAGE DEDICATION PLAT

Form C-102
Supersedes C-120
Effective 1-1-67

All distances must be from the outer boundaries of the Section.

Operator WINTERSHALL		Lease MOO C-1420-4387-34		Well No. 34-44
Unit Letter P	Section 34	Township 31 North	Range 14 West	County San Juan
Actual Footage Location of Well:				
1090 feet from the South		790 feet from the East		Line
Ground Level Elev. 5612'	Producing Formation Dakota	Pool Basin-Dakota Gas	Dedicated Acreage 320 Acres	

1. Outline the acreage dedicated to the subject well by colored pencil or hatchure marks on the plat below.
2. If more than one lease is dedicated to the well, outline each and identify the ownership thereof (both as to working interest and royalty).
3. If more than one lease of different ownership is dedicated to the well, have the interests of all owners been consolidated by communitization, unitization, force-pooling, etc?

☐ Yes ☐ No If answer is "yes," type of consolidation _____

If answer is "no," list the owners and tract descriptions which have actually been consolidated. (Use reverse side of this form if necessary.) _____

No allowable will be assigned to the well until all interests have been consolidated (by communitization, unitization, forced-pooling, or otherwise) or until a non-standard unit, eliminating such interests, has been approved by the Commission.

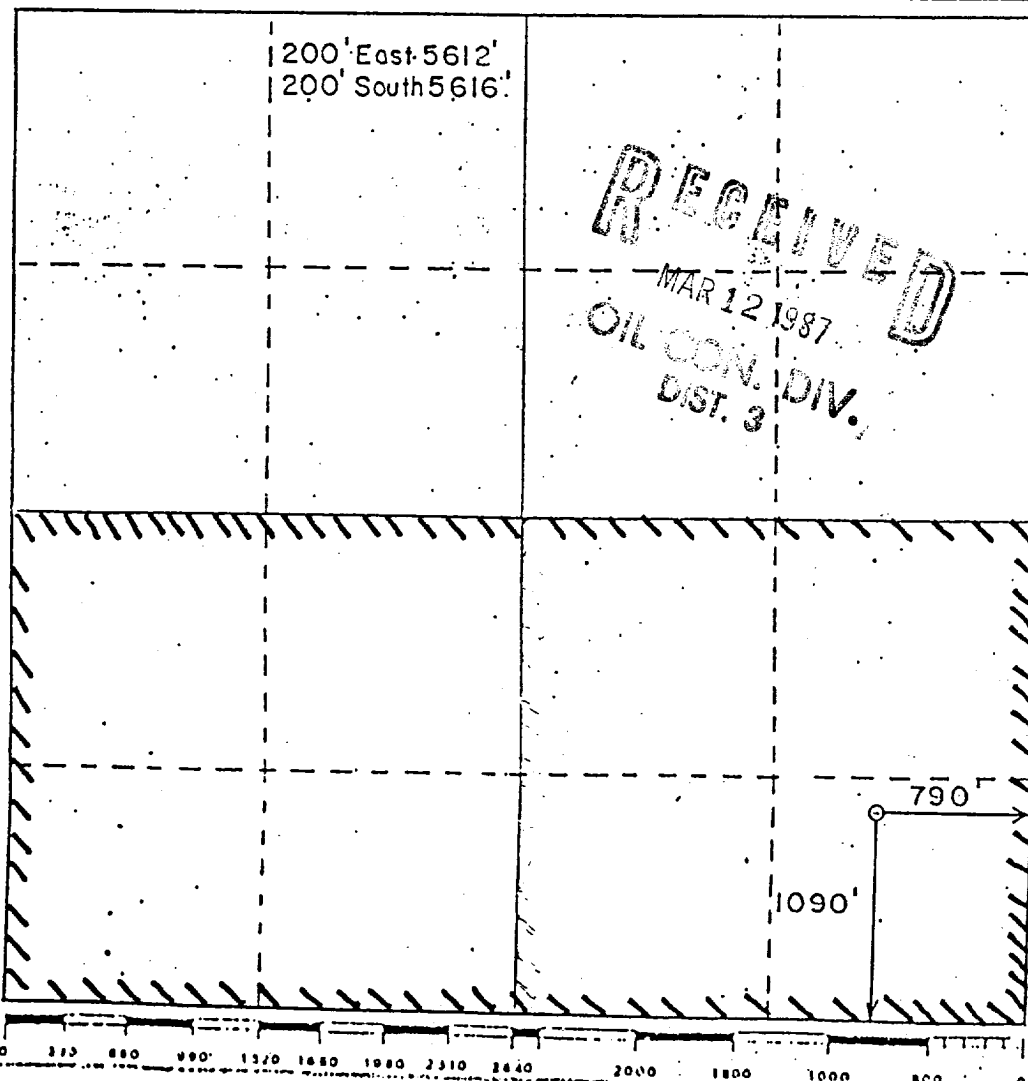

CERTIFICATION

I hereby certify that the information contained herein is true and complete to the best of my knowledge and belief.

Name
[Signature]
Position
AREA SUPERINTENDENT
Company
WINTERSHALL CORPORATION
Date
FEBRUARY 17, 1987

I hereby certify that the location shown on this plat was plotted from field notes actually made by me or under my supervision, and that the same is true and correct to the best of my knowledge and belief.

Date Surveyed
2-28-86
Registered Professional Engineer and/or Land Surveyor
[Signature]
Certificate No.
6844

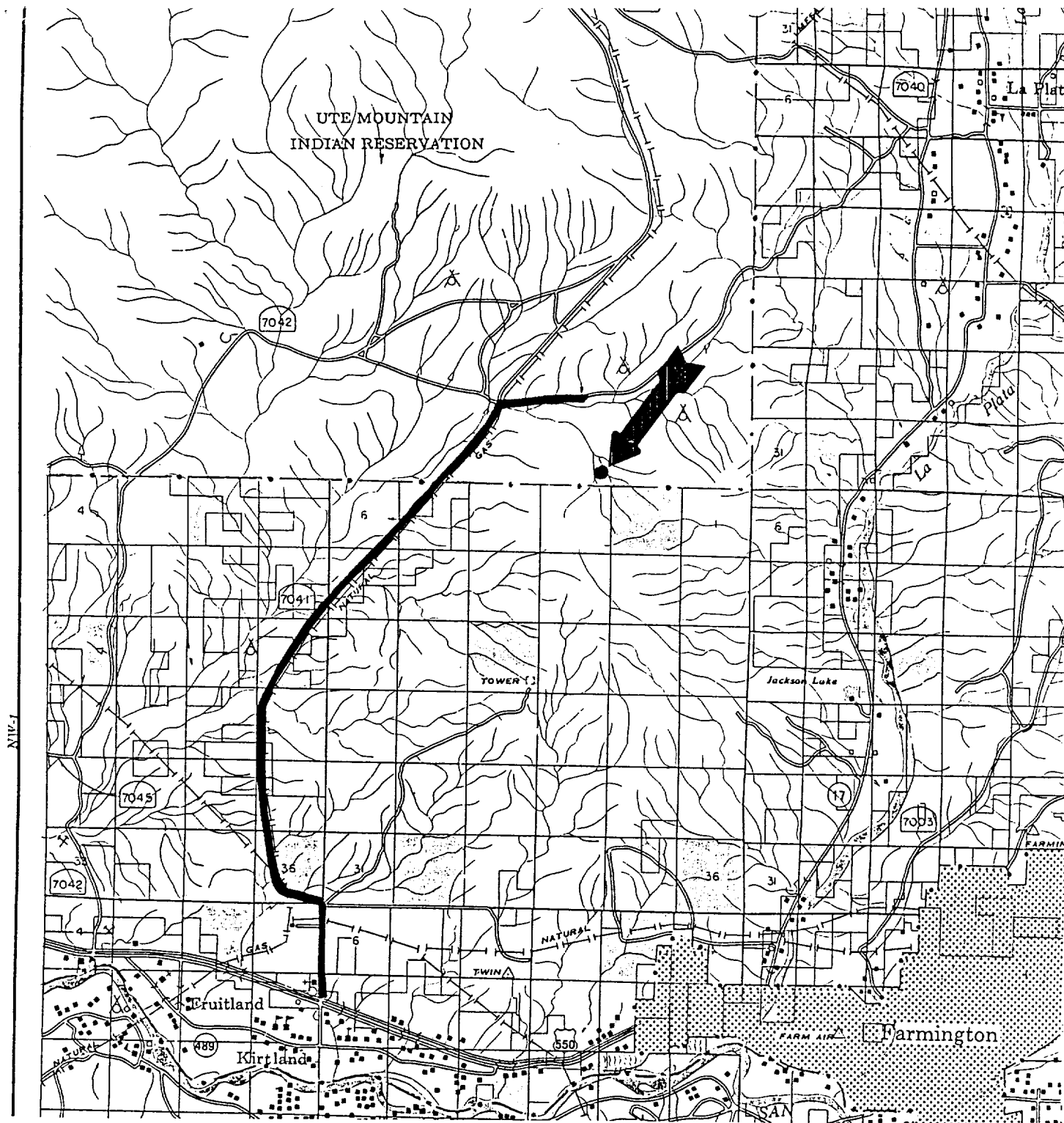

Wintershall Petroleum Corp.
 Ute 34-44
 1090' FSL & 790' FEL
 Sec. 34, T. 31 N., R. 14 W.
 San Juan County, New Mexico

PROPOSED WELL = ●
 EXISTING ROAD = —

PAGE 13