

NO. OF COPIES RECEIVED		
DISTRIBUTION		
SANTA FE		
FILE		
U.S.G.S.		
LAND OFFICE		
OPERATOR		

# NEW MEXICO OIL CONSERVATION COMMISSION

Form C-101  
Revised 1-1-65

5A. Indicate Type of Lease	
STATE <input type="checkbox"/>	FEE <input checked="" type="checkbox"/>
5. State Oil & Gas Lease No.	

## APPLICATION FOR PERMIT TO DRILL, DEEPEN, OR PLUG BACK

1a. Type of Work			7. Unit Agreement Name		
b. Type of Well OIL WELL <input type="checkbox"/> GAS WELL <input checked="" type="checkbox"/> OTHER <input type="checkbox"/>			8. Farm or Lease Name Aztec A		
2. Name of Operator Meridian Oil Inc.			9. Well No. 1A		
3. Address of Operator PO Box 4289, Farmington, NM 87499			10. Field and Pool, or Wildcat Blanco Mesa Verde		
4. Location of Well UNIT LETTER <u>J</u> LOCATED <u>1660</u> FEET FROM THE <u>South</u> LINE AND <u>1760</u> FEET FROM THE <u>East</u> LINE OF SEC. <u>22</u> TWP. <u>31N</u> RGE. <u>11W</u> NMPM			12. County San Juan		
19. Proposed Depth 5095			19A. Formation Mesa Verde		20. Rotary or C.T. Rotary
21. Elevations (Show whether DF, RT, etc.) 5782' GL		21A. Kind & Status Plug. Bond statewide		22. Approx. Date Work will start	

### 23. PROPOSED CASING AND CEMENT PROGRAM

SIZE OF HOLE	SIZE OF CASING	WEIGHT PER FOOT	SETTING DEPTH	SACKS OF CEMENT	EST. TOP
12 1/4"	9 5/8"	32.3#	200'	125 cu.ft.	circ. surface
8 3/4"	7"	20&23#	2775'	609 cu.ft.	cover Ojo Alam
6 1/4"	4 1/2"	10.5#	5095'	431 cu.ft.	circ. liner

Selectively perforate and sandwater fracture the Mesa Verde formation.

A 3000 psi WP and 6000 psi test double gate preventer equipped with blind and pipe rams will be used for blow out prevention on this well.

This gas is dedicated.

The S/2 of Section 22 is dedicated to this well.

APPROVAL EXPIRES 9-26-88  
UNLESS DRILLING IS COMMENCED.  
SPUD NOTICE MUST BE SUBMITTED  
WITHIN 10 DAYS.

**RECEIVED**  
MAR 4 1988  
OIL CON. DIV.  
DIST. 3

IN ABOVE SPACE DESCRIBE PROPOSED PROGRAM: IF PROPOSAL IS TO DEEPEN OR PLUG BACK, GIVE DATA ON PRESENT PRODUCTIVE ZONE AND PROPOSED NEW PRODUCTIVE ZONE. GIVE BLOWOUT PREVENTER PROGRAM, IF ANY.

I hereby certify that the information above is true and complete to the best of my knowledge and belief.

Signed Debbie L. Cook Title Drilling Clerk Date 3-22-88

(This space for State Use)

APPROVED BY Ernie Busch TITLE DEPUTY OIL & GAS INSPECTOR, DIST. #3 DATE MAR 25 1988  
CONDITIONS OF APPROVAL, IF ANY:

**NEW MEXICO OIL CONSERVATION COMMISSION  
WELL LOCATION AND ACREAGE DEDICATION PLAT**

Form C-102  
Supersedes C-128  
Effective 1-1-65

All distances must be from the outer boundaries of the Section.

Operator <b>MERIDIAN OIL INC.</b>			Lease <b>AZTEC A</b>		(FEE)	Well No. <b>1A</b>
Unit Letter <b>J</b>	Section <b>22</b>	Township <b>31N</b>	Range <b>11W</b>	County <b>San Juan</b>		
Actual Footage Location of Well:						
<b>1660</b>		feet from the <b>South</b>	line and	<b>1760</b>	feet from the <b>East</b>	line
Ground Level Elev. <b>5782</b>	Producing Formation <b>Mesa Verde</b>		Pool <b>Blanco</b>		Dedicated Acreage: <b>320.00</b> Acres	

1. Outline the acreage dedicated to the subject well by colored pencil or hatchure marks on the plat below.
2. If more than one lease is dedicated to the well, outline each and identify the ownership thereof (both as to working interest and royalty).
3. If more than one lease of different ownership is dedicated to the well, have the interests of all owners been consolidated by communitization, unitization, force-pooling, etc?

☐ Yes    ☐ No    If answer is "yes," type of consolidation \_\_\_\_\_

If answer is "no," list the owners and tract descriptions which have actually been consolidated. (Use reverse side of this form if necessary.) \_\_\_\_\_

No allowable will be assigned to the well until all interests have been consolidated (by communitization, unitization, forced-pooling, or otherwise) or until a non-standard unit, eliminating such interests, has been approved by the Commission.

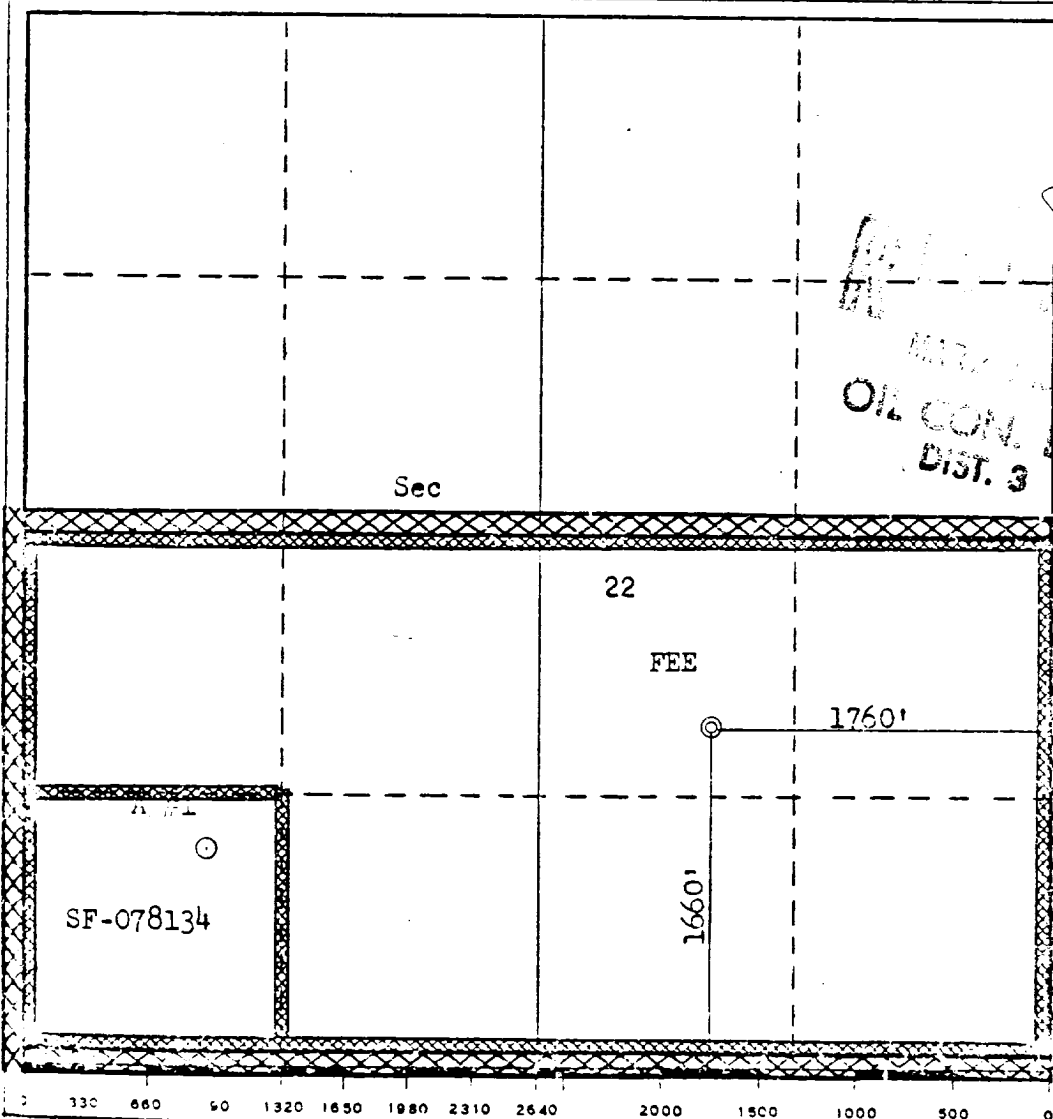

**CERTIFICATION**

I hereby certify that the information contained herein is true and complete to the best of my knowledge and belief.

Name \_\_\_\_\_  
Position  
**Drilling Clerk**  
**Meridian Oil Inc.**  
Company

**3-22-88**

I hereby certify that the well location shown on this plat was plotted from field notes of actual surveys made by me or under my supervision, and that the same is true and correct to the best of my knowledge and belief.

Date Surveyed  
**September 27, 1978**  
Registered Professional Engineer  
and/or Land Surveyor

**W. B. Kern Jr.**  
Certificate No. \_\_\_\_\_

**1050**