

STATE OF NEW MEXICO
ENERGY AND MINERALS DEPARTMENT

| | |
|------------------------|--|
| NO. OF COPIES RECEIVED | |
| DISTRIBUTION | |
| SANTA FE | |
| FILE | |
| U.S.G.S. | |
| LAND OFFICE | |
| OPERATOR | |

OIL CONSERVATION DIVISION
P. O. BOX 2088
SANTA FE, NEW MEXICO 87501

Form C-103
Revised 10-1-78

5a. Indicate Type of Lease
State ☐ Fee ☒
5. State Oil & Gas Lease No.

SUNDRY NOTICES AND REPORTS ON WELLS

(DO NOT USE THIS FORM FOR PROPOSALS TO DRILL OR TO DEEPEN OR PLUG BACK TO A DIFFERENT RESERVOIR.
USE APPLICATION FOR PERMIT TO DRILL FORM C-1011 FOR SUCH PROPOSALS.)

| | |
|--|---|
| 1. OIL WELL <input type="checkbox"/> GAS WELL <input checked="" type="checkbox"/> OTHER- | 7. Unit Agreement Name Allison Unit |
| 2. Name of Operator Meridian Oil Inc. | 8. Farm or Lease Name Allison Unit |
| 3. Address of Operator P.O. Box 4289, Farmington, NM 87499 | 9. Well No. 101 |
| 4. Location of Well UNIT LETTER <u>L</u> <u>1840</u> FEET FROM THE <u>South</u> LINE AND <u>1190</u> FEET FROM THE <u>West</u> LINE, SECTION <u>17</u> TOWNSHIP <u>32N</u> RANGE <u>6W</u> NMPM. | 10. Field and Pool, or Whichever Basin Fruitland Coa |
| 15. Elevation (Show whether DF, RT, CR, etc.) 6593' GL | 12. County San Juan |

16.

Check Appropriate Box To Indicate Nature of Notice, Report or Other Data
NOTICE OF INTENTION TO: SUBSEQUENT REPORT OF:

| | | | |
|--|--|---|---|
| PERFORM REMEDIAL WORK <input type="checkbox"/> | PLUG AND ABANDON <input type="checkbox"/> | REMEDIAL WORK <input type="checkbox"/> | ALTERING CASING <input type="checkbox"/> |
| TEMPORARILY ABANDON <input type="checkbox"/> | CHANGE PLANS <input type="checkbox"/> | COMMENCE DRILLING OPS. <input type="checkbox"/> | PLUG AND ABANDONMENT <input type="checkbox"/> |
| PULL OR ALTER CASING <input type="checkbox"/> | OTHER <input checked="" type="checkbox"/> Revision | CASING TEST AND CEMENT JOB <input type="checkbox"/> | |

17. Describe Proposed or Completed Operations (Clearly state all pertinent details, and give pertinent dates, including estimated date of starting any proposed work) SEE RULE 1103.

Attached is a copy of the C-102 showing the revised pool & dedication.

RECEIVED
DEC 30 1988
OIL CON. DIV.
DIST. 3

18. I hereby certify that the information above is true and complete to the best of my knowledge and belief.

SIGNED [Signature] TITLE Regulatory Affairs DATE 12-27-88

APPROVED BY [Signature] TITLE DEPUTY OIL & GAS INSPECTOR, DIST. #3 DATE JAN 04 1989

CONDITIONS OF APPROVAL, IF ANY:

**NEW MEXICO OIL CONSERVATION COMMISSION
WELL LOCATION AND ACREAGE DEDICATION PLAT**

Form 2-10
Supersedes 1-128
Effective 1-1-67

All distances must be from the outer boundaries of the Section.

| | | | | | |
|--|--|-------------------------|------------------------------------|---------------------------|--|
| Operator Meridian Oil, Inc. | | | Lease ALLISON UNIT (Fee) | | Well No. 101 |
| Unit Letter L | Section 17 | Township 32 N | Range 6 W | County SAN JUAN | |
| Actual Footage Location of Well: 1840 feet from the South line and 1190 feet from the West line | | | | | |
| Ground Level Elev: 6593 | Producing Formation Fruitland Coal | | Pool Basin | | Dedicated Acreage: 320 Acres |

1. Outline the acreage dedicated to the subject well by colored pencil or hatchure marks on the plat below.
2. If more than one lease is dedicated to the well, outline each and identify the ownership thereof (both as to working interest and royalty).
3. If more than one lease of different ownership is dedicated to the well, have the interests of all owners been consolidated by communitization, unitization, force-pooling, etc?

☒ Yes ☐ No If answer is "yes," type of consolidation unitization

If answer is "no," list the owners and tract descriptions which have actually been consolidated. (Use reverse side of this form if necessary.) _____

No allowable will be assigned to the well until all interests have been consolidated (by communitization, unitization, forced-pooling, or otherwise) or until a non-standard unit, eliminating such interests, has been approved by the Commission.

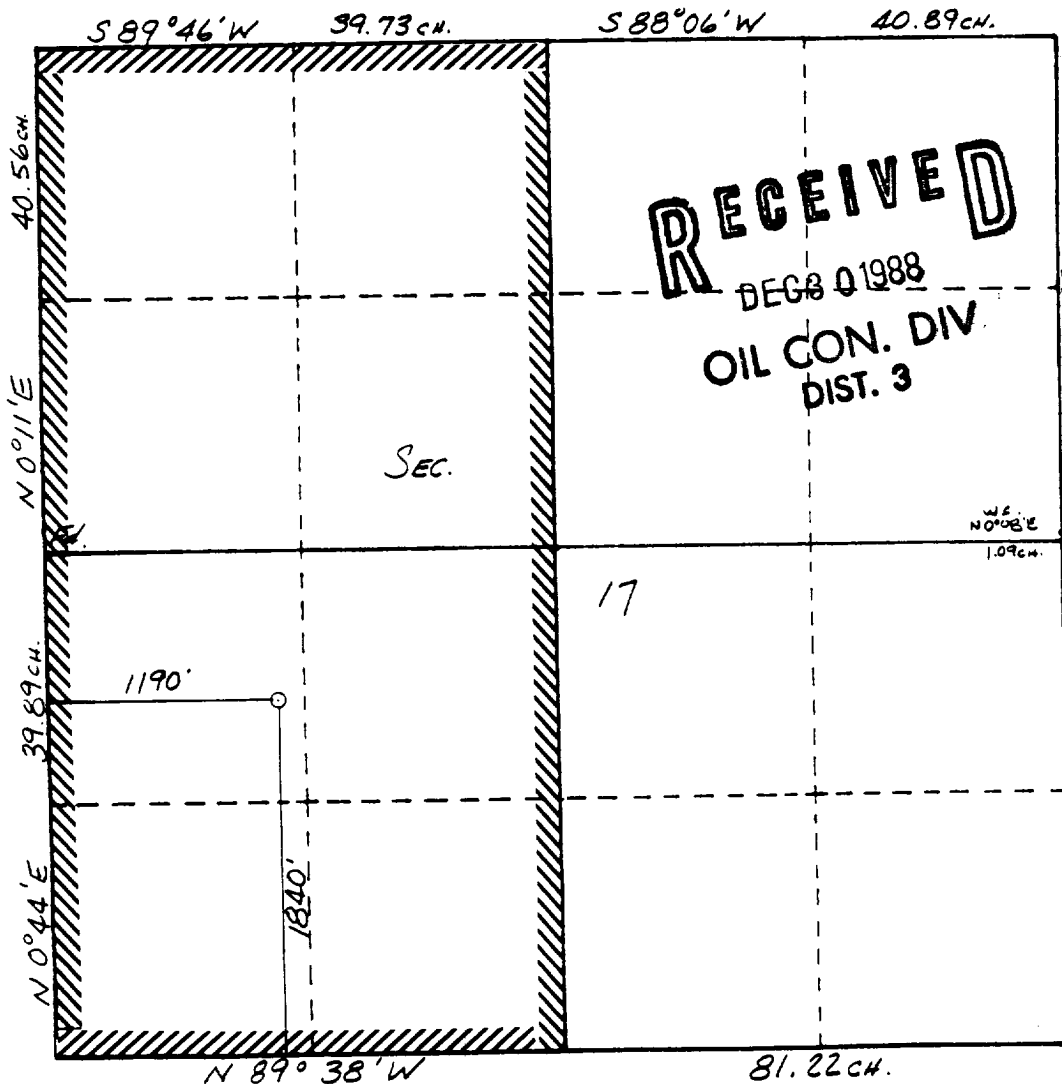

CERTIFICATION

I hereby certify that the information contained herein is true and complete to the best of my knowledge and belief.

Name D. B. [Signature]
Position Regulatory Affairs
Company Meridian Oil Inc.
Date 12-27-88

I hereby certify that the well location shown on this plat was plotted from field notes of actual surveys made by me or under my supervision, and that the same is true and correct to the best of my knowledge and belief.

Date Surveyed 12-27-88
Registered Professional Engineer and Land Surveyor William E. Mahnkrell II
Certificate No. 8466