

UNITED STATES
DEPARTMENT OF THE INTERIOR
BUREAU OF LAND MANAGEMENT

30-145-26949

RECEIVED
MAY 11 10:37 AM '88
FASHER ROOM

3. LEASE DESIGNATION AND SERIAL NO.
NM-0607

6. IF INDIAN, ALLOTTEE OR TRIBE NAME

7. UNIT AGREEMENT NAME

8. FARM OR LEASE NAME
Atlantic C

9. WELL NO.
200

10. FIELD AND POOL, OR WILDCAT
Undes.Ft. Coal

11. SEC., T., R., M., OR BLK. AND SUBST. OR JARA
Sec. 35, T-31-N, R-10-W
NMPM

12. COUNTY OR PARISH | 13. STATE
San Juan | NM

APPLICATION FOR PERMIT TO DRILL, DEEPEN, OR PLUG BACK

1a. TYPE OF WORK
 DRILL DEEPEN PLUG BACK

b. TYPE OF WELL
 OIL WELL GAS WELL OTHER

2. NAME OF OPERATOR
Meridian Oil Inc.

3. ADDRESS OF OPERATOR
PO Box 4289, Farmington, NM 87499

4. LOCATION OF WELL (Report location clearly and in accordance with any State requirements.)
 At surface 1450' N, 1545' E
 At proposed prod. zone

14. DISTANCE IN MILES AND DIRECTION FROM NEAREST TOWN OR POST OFFICE*
8 miles from Aztec, NM

15. DISTANCE FROM PROPOSED* LOCATION TO NEAREST PROPERTY OR LEASE LINE, FT. (Also to nearest drig. unit line, if any)
1500'

16. NO. OF ACRES IN LEASE
160
2480-68

17. NO. OF ACRES ASSIGNED TO THIS WELL
160.00

18. DISTANCE FROM PROPOSED LOCATION* TO NEAREST WELL, DRILLING COMPLETED, OR APPLIED FOR, ON THIS LEASE, FT.
300'

19. PROPOSED DEPTH
3160'

20. ROTARY OR CABLE TOOLS
Rotary

21. ELEVATIONS (Show whether DF, RT, GR, etc.)
6422' GL

22. APPROX. DATE WORK WILL START*

23. PROPOSED CASING AND CEMENTING PROGRAM

This action is subject to technical and procedural review under 30 CFR 2165.3 and appeal rights in 3160.4.

SIZE OF HOLE	SIZE OF CASING	WEIGHT PER FOOT	SETTING DEPTH	QUANTITY OF CEMENT
12 1/4"	9 5/8"	32.3#	200'	130 cf. circulated
8 3/4"	7"	20.0#	2958'	930 cf circ. surface
6 1/4"	5 1/2" liner	23.0#	3160'	do not cement

The Fruitland coal formation will be completed.

A 3000 psi WP and 6000 psi test double gate preventer equipped with blind and pipe rams will be used for blow out prevention on this well.

This gas is dedicated.

The NE/4 of Section 35 is dedicated to this well.

RECEIVED
JUN 4 1988
OIL CON. DIV.
DIST. 3

IN ABOVE SPACE DESCRIBE PROPOSED PROGRAM: If proposal is to deepen or plug back, give data on present productive zone. If proposal is to drill or deepen directionally, give pertinent data on subsurface locations and measured and true vertical depths. Give blowout preventer program, if any.

24. SIGNED [Signature] TITLE Drilling Clerk DATE 05-10-88

(This space for Federal or State office use)

PERMIT NO. _____ APPROVAL DATE _____

APPROVED BY _____ TITLE _____ DATE _____

CONDITIONS OF APPROVAL, IF ANY:

2/5/88
[Signature]

[Signature]

*See Instructions On Reverse Side

NEW MEXICO OIL CONSERVATION COMMISSION
WELL LOCATION AND ACREAGE DEDICATION PLAT

Form O-100
Supersedes O-120
Effective 1-4-66

All distances must be from the outer boundaries of the Section.

Operator MERIDIAN OIL INC.		Lease ATLANTIC "C" (NM-0607)		Well No. 200
Unit Letter G	Section 35	Township 31 NORTH	Range 10 WEST	County SAN JUAN
Actual Footage Location of Well 1450 feet from the NORTH line and 1545 feet from the EAST line				
Ground Level Elev. 6422	Producing Formation Fruitland Coal	Pool Undesignated	Dedicated Acreage 160 Acres	

1. Outline the acreage dedicated to the subject well by colored pencil or hatchure marks on the plat below.
2. If more than one lease is dedicated to the well, outline each and identify the ownership thereof (both as to working interest and royalty).
3. If more than one lease of different ownership is dedicated to the well, have the interests of all owners been consolidated by communitization, unitization, force-pooling, etc?

Yes No If answer is "yes," type of consolidation _____

If answer is "no," list the owners and tract descriptions which have actually been consolidated. (Use reverse side of this form if necessary.) _____

No allowable will be assigned to the well until all interests have been consolidated (by communitization, unitization, forced-pooling, or otherwise) or until a non-standard unit, eliminating such interests, has been approved by the Commission. $S89^{\circ}36'W$ $N89^{\circ}49'W$

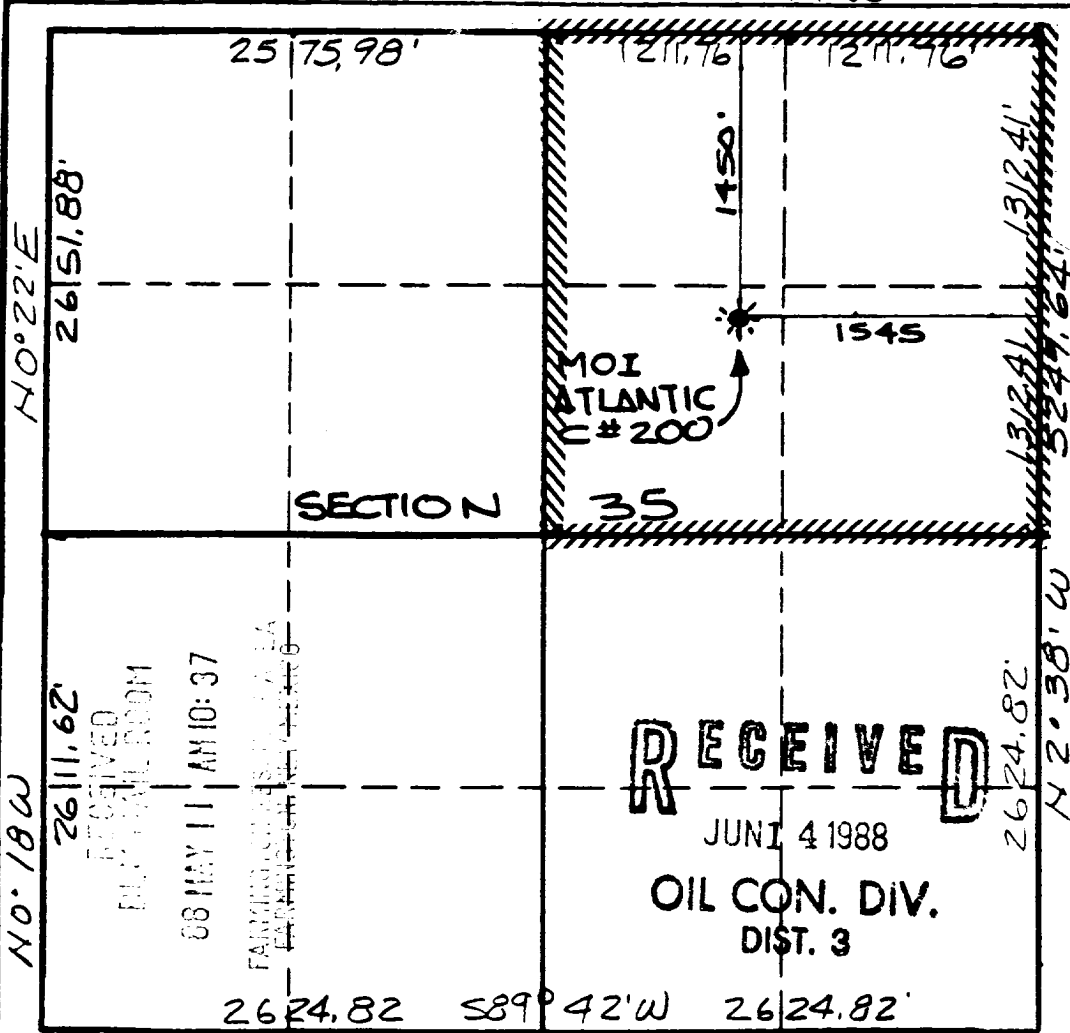

CERTIFICATION

I hereby certify that the information contained herein is true and complete to the best of my knowledge and belief.

Neale C. Edwards
Name
Drilling Clerk

Position
Meridian Oil Inc.

Company
5-10-88

Date

I hereby certify that the location shown on this plat was taken from field notes of actual survey made by me or under my supervision, and that the same is true and correct to the best of my knowledge and belief.

Neale C. Edwards
Date Surveyed
APRIL 27, 1988

Registered Professional Engineer and/or Land Surveyor

NEALE C. EDWARDS

Certificate No.
6857

NO. 18 W
26 11.62
RECEIVED
ELECTRICAL ROOM
68 MAY 11 AM 10:37
FARMINGVILLE, N.M. 87416

RECEIVED
JUNI 4 1988
OIL CON. DIV.
DIST. 3



