

UNITED STATES
DEPARTMENT OF THE INTERIOR
BUREAU OF LAND MANAGEMENT

APPLICATION FOR PERMIT TO DRILL, DEEPEN, OR PLUG BACK

1a. TYPE OF WORK

DRILL ☒

DEEPEN ☐

PLUG BACK ☐

b. TYPE OF WELL

OIL
WELL ☐

GAS
WELL ☒

OTHER

2. NAME OF OPERATOR

~~El Paso Natural Gas Company~~
MERIDIAN OIL INC.

3. ADDRESS OF OPERATOR

PO Box 4289, Farmington, NM 87499

4. LOCATION OF WELL (Report location clearly and in accordance with any State requirements.)*

At surface
941'N, 1510'W

At proposed prod. zone

14. DISTANCE IN MILES AND DIRECTION FROM NEAREST TOWN OR POST OFFICE*

6 miles south of Allison, CO

15. DISTANCE FROM PROPOSED*

LOCATION TO NEAREST
PROPERTY OR LEASE LINE, FT.
(Also to nearest drlg. unit line, if any)

941'

18. DISTANCE FROM PROPOSED LOCATION*

TO NEAREST WELL, DRILLING, COMPLETED
OR APPLIED FOR, ON THIS LEASE, FT.

100'

16. NO. OF ACRES IN LEASE

Unit 1978.05

17. NO. OF ACRES ASSIGNED

TO THIS WELL

160.00 167.74

19. PROPOSED DEPTH

3275'

20. ROTARY OR CABLE TOOLS

Rotary

21. ELEVATIONS (Show whether DF, RT, GR, etc.)

6596' GL

DRILLING OPERATIONS AUTHORIZED ARE
SUBJECT TO COMPLIANCE WITH ATTACHED

"GENERAL REQUIREMENTS"
PROPOSED CASING AND CEMENTING PROGRAM

22. APPROX. DATE WORK WILL START*

This action is subject to technical and
procedural review pursuant to 43 CFR 3165.3
and appeal pursuant to 43 CFR 3165.4.

SIZE OF HOLE	SIZE OF CASING	WEIGHT PER FOOT	SETTING DEPTH	QUANTITY OF CEMENT
12 1/4"	9 5/8"	32.3#	200'	130 cf. circulated
8 3/4"	7"	20.0#	3125'	990 cf to cover Ojo Alamo
6 1/4"	5 1/2" liner	23.0#	3275'	do not cement

The Fruitland formation will be completed.

A 3000 psi WP and 6000 psi test double gate preventer equipped with
blind and pipe rams will be used for blow out prevention on this well.

This gas is dedicated.

The NW/4 of Section 15 is dedicated to this well.

IN ABOVE SPACE DESCRIBE PROPOSED PROGRAM: If proposal is to deepen or plug back, give data on present productive zone and proposed new productive zone. If proposal is to drill or deepen directionally, give pertinent data on subsurface locations and measured and true vertical depths. Give blowout preventer program, if any.

24.

SIGNED

TITLE

Drilling Clerk

DATE

04-19-88

(This space for Federal or State office use)

PERMIT NO.

APPROVAL DATE

APPROVED BY

TITLE

DATE

CONDITIONS OF APPROVAL, IF ANY:

NMOC

*See Instructions On Reverse Side

Form C-102
Supers-der C-12
Effective 1-1-63

Operator MERIDIAN OIL INC. El Paso Natural Gas Company		Lease ALLISON Unit (SF-078459B)		Well No. 107
U&N Letter C	Section 15 (LOT 2)	Township 32 NORTH	Range 7 WEST	County SAN JUAN
Actual Footage Location of Well 941 feet from the NORTH line and 1510 feet from the WEST line				
Ground Level Elev. 6596	Producing Formation Fruitland COAL	Pool Undesignated	Dedicated Acreage: 160 167.74 Acres	

- ☒ Yes ☐ No If answer is "yes," type of consolidation unitization

No allowable will be assigned to the well until all interests have been consolidated (by communitization, unitization, forced-pooling, or otherwise) or until a non-standard unit, eliminating such interests, has been approved by the Commission.

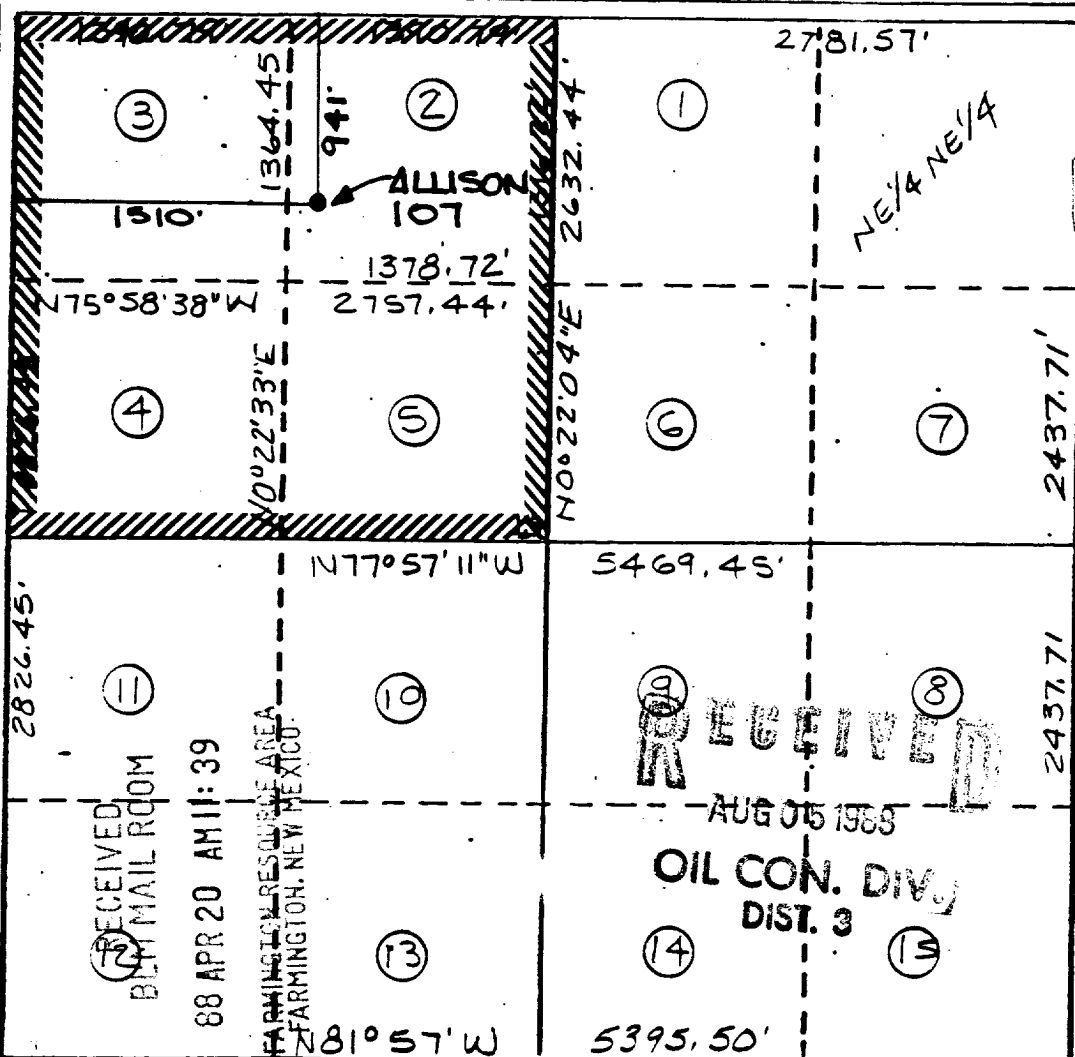

I hereby certify that the information contained herein is true and complete to the best of my knowledge and belief.

Date _____

1. I have been to the well location
shown on this plat as plotted from field
notes of actual surveys made by me or
under my supervision, and that the same
is true and correct to the best of my
knowledge and belief.

NEALE C. EDWARDS

Certificate No.
. 6857



MERIDIAN OIL INC.
 Allison 107
 NE 1/4 NW 1/4, Sec. 15, T32N, R7W, N.M.P.M.,
 San Juan County, New Mexico