

UNITED STATES  
DEPARTMENT OF THE INTERIOR  
GEOLOGICAL SURVEY

## APPLICATION FOR PERMIT TO DRILL, DEEPEN, OR PLUG BACK

1a. TYPE OF WORK DRILL <input checked="" type="checkbox"/> DEEPEN <input type="checkbox"/> PLUG BACK <input type="checkbox"/>				5. LEASE DESIGNATION AND SERIAL NO. NM-010989	
b. TYPE OF WELL OIL WELL <input type="checkbox"/> GAS WELL <input checked="" type="checkbox"/> OTHER <input type="checkbox"/>				6. IF INDIAN, ALLOTTEE OR TRIBE NAME	
2. NAME OF OPERATOR Tenneco Oil Company				7. UNIT AGREEMENT NAME	
3. ADDRESS OF OPERATOR P.O. Box 3249, Englewood, CO 80155				8. FARM OR LEASE NAME Fields	
4. LOCATION OF WELL (Report location clearly and in accordance with any State requirements.) At surface NW/4 Sec. 25, 1740' FWL, 1590' FNL At proposed prod. zone Same				9. WELL NO. 17	
14. DISTANCE IN MILES AND DIRECTION FROM NEAREST TOWN OR POST OFFICE* 11 miles NE of Aztec				10. FIELD AND POOL OR WILDCAT Blanco Fruitland <i>comp</i>	
15. DISTANCE FROM PROPOSED* LOCATION TO NEAREST PROPERTY OR LEASE LINE, FT. (Also to nearest drlg. unit line, if any)		1590'		11. SEC., T., R., M., OR BLK. AND SURVEY OR AREA F Sec. 25, T32N, R11W	
18. DISTANCE FROM PROPOSED LOCATION* TO NEAREST WELL, DRILLING, COMPLETED, OR APPLIED FOR, ON THIS LEASE, FT.		300'		12. COUNTY OR PARISH San Juan	
16. NO. OF ACRES IN LEASE 2480		17. NO. OF ACRES ASSIGNED TO THIS WELL 320 / 160		13. STATE NM	
19. PROPOSED DEPTH 3092'		20. ROTARY OR CABLE TOOLS Rotary		22. APPROX. DATE WORK WILL START* 8/1/88	
21. ELEVATIONS (Show whether DF, RT, GR, etc.) 6232' GR DRILLING OPERATIONS AUTHORIZED ARE SUBJECT TO COMPLIANCE WITH ATTACHED "GENERAL REQUIREMENTS" PROPOSED CASING AND CEMENTING PROGRAM				23. <i>This action is subject to technical and procedural review pursuant to 43 CFR 3103.3 and appeal pursuant to 43 CFR 3103.4</i>	
SIZE OF HOLE	SIZE OF CASING	WEIGHT PER FOOT	SETTING DEPTH	200 cu.ft. - Circ. to Surface	
12 1/2"	9 5/8"	36#	± 200'	650 cu.ft. - Circ. to Surface	
8 3/4"	7"	23#	± 2538'	None	
6 1/2"	5 1/2" - Liner	23#	± 2438' - 3090'		

See Attached Drilling Procedure.

See Item 1.B of Surface Use Plan and Map 2 for BLM Right-of-Way Application.

RECEIVED  
BLM MAIL ROOM

88 JUL -8 AM 11:04

MINING RESOURCE AREA  
WASHINGTON, NEW MEXICO

RECEIVED

AUG 15 1988

OIL CON. DIV.  
DIST. 3

IN ABOVE SPACE DESCRIBE PROPOSED PROGRAM: If proposal is to deepen or plug back, give data on present productive zone and proposed new productive zone. If proposal is to drill or deepen directionally, give pertinent data on subsurface locations and measured and true vertical depths. Give blowout preventer program, if any.

24. SIGNED Larry Bell TITLE Admin. Supervisor DATE 7/6/88  
(This space for Federal or State office use)

PERMIT NO. \_\_\_\_\_ APPROVAL DATE \_\_\_\_\_

APPROVED BY \_\_\_\_\_ TITLE \_\_\_\_\_ DATE \_\_\_\_\_  
CONDITIONS OF APPROVAL, IF ANY:OK  
SFB

00000

APPROVED  
DATE  
Ful

NEW MEXICO OIL CONSERVATION COMMISSION  
WELL LOCATION AND ACREAGE DEDICATION PLAT

Form C-102  
Supersedes C-228  
Effective 1-1-85

All distances must be from the outer boundaries of the Section.

Operator <b>TENNECO OIL COMPANY</b>			Lease <b>FIELDS</b>		Well No. <b>17</b>
Unit Letter <b>F</b>	Section <b>25</b>	Township <b>32 N</b>	Range <b>11 W</b>	County <b>SAN JUAN</b>	
Actual Footage Location of Well: <b>1590</b> feet from the <b>North</b> line and <b>1740</b> feet from the <b>West</b> line					
Ground Level Elev. <b>6232</b>	Producing Formation <b>Fruitland Coal</b>	Pool <b>Blanco Fruitland</b>	Dedicated Acreage <b>328 160</b> Acres		

1. Outline the acreage dedicated to the subject well by colored pencil or hatchure marks on the plat below.
2. If more than one lease is dedicated to the well, outline each and identify the ownership thereof (both as to working interest and royalty).
3. If more than one lease of different ownership is dedicated to the well, have the interests of all owners been consolidated by communitization, unitization, force-pooling, etc?

☐ Yes ☐ No If answer is "yes," type of consolidation \_\_\_\_\_

If answer is "no," list the owners and tract descriptions which have actually been consolidated. (Use reverse side of this form if necessary.) \_\_\_\_\_

No allowable will be assigned to the well until all interests have been consolidated (by communitization, unitization, forced-pooling, or otherwise) or until a non-standard unit, eliminating such interests, has been approved by the Commission.

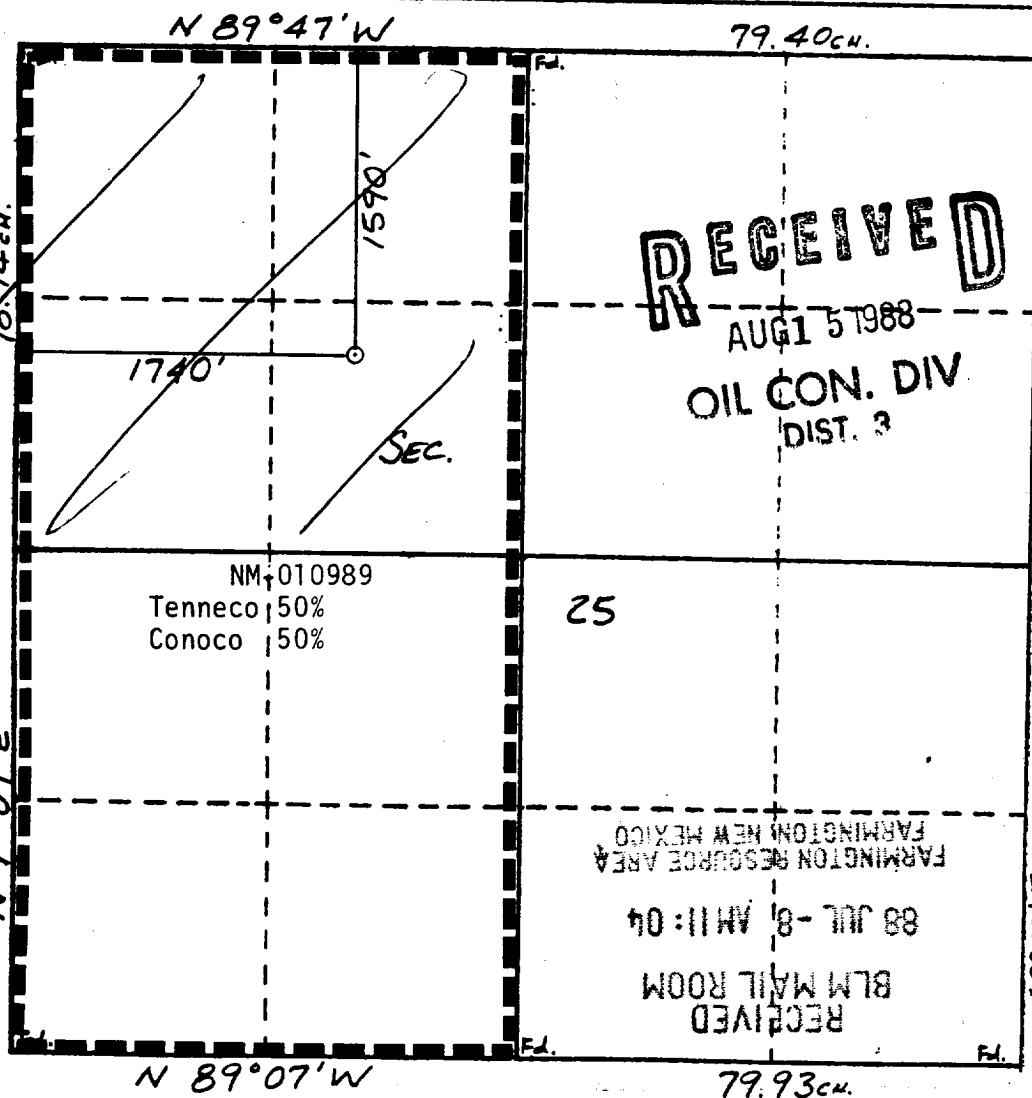

CERTIFICATION

I hereby certify that the information contained herein is true and complete to the best of my knowledge and belief.

Name  
**Larry Bell**  
Position  
**Administrative Supervisor**  
Company  
**Tenneco Oil Company**  
Date  
**7/6/88**

I hereby certify that the well location shown on this plat was plotted from field notes of actual surveys made by me or under my supervision, and that the same is true and correct to the best of my knowledge and belief.

Date Surveyed  
**Willam L. Mahoney**  
Registered Professional Engineer and  
Land Surveyor  
Certificate No. **6466**

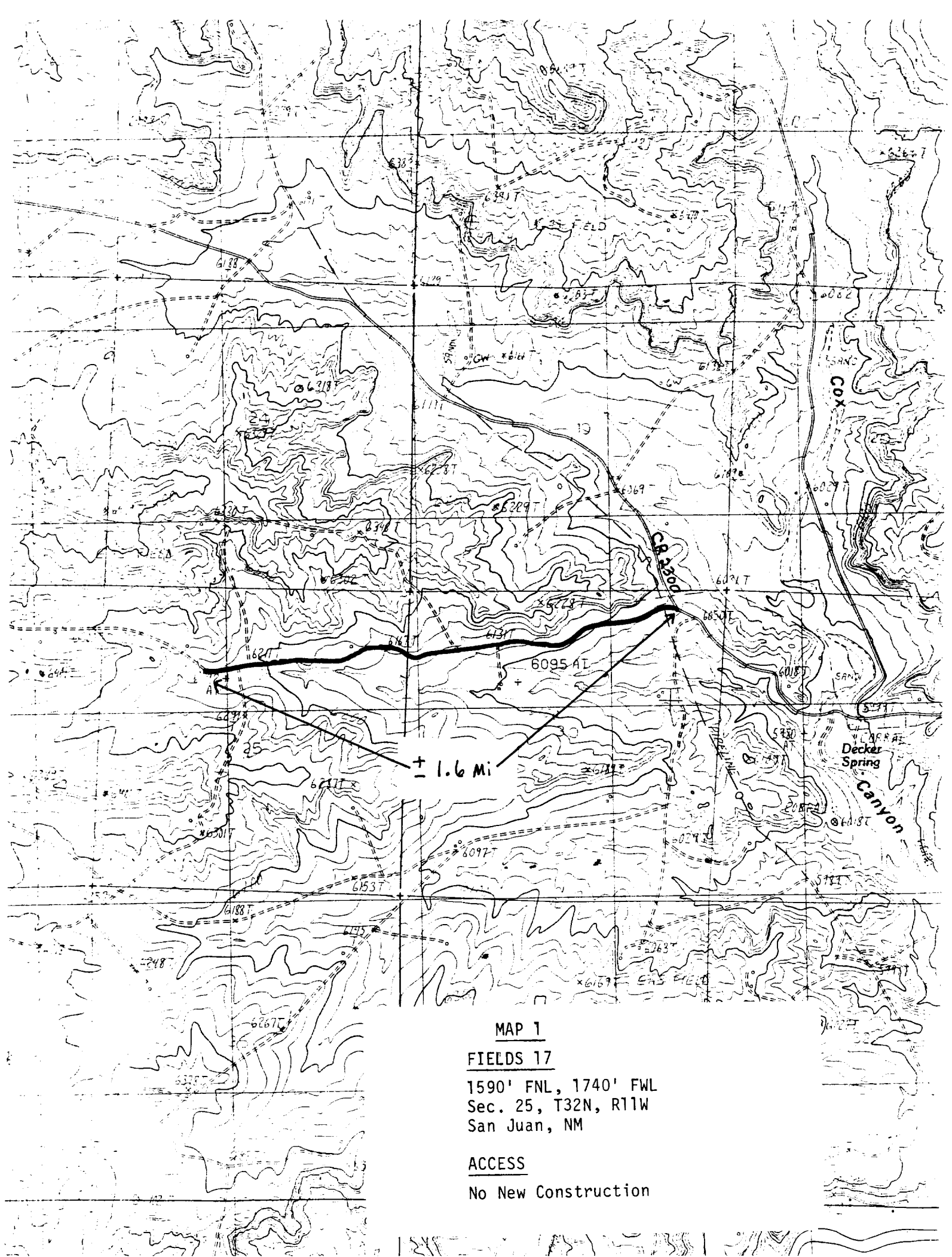

MAP 1

FIELDS 17

1590' FNL, 1740' FWL  
Sec. 25, T32N, R11W  
San Juan, NM

ACCESS

No New Construction