

UNITED STATES
DEPARTMENT OF THE INTERIOR
BUREAU OF LAND MANAGEMENT

SUBMIT IN TRIPLICATE*
(Other instructions on
reverse side)

Form approved.
Budget Bureau No. 1004-0136
Expires August 31, 1985

APPLICATION FOR PERMIT TO DRILL, DEEPEN, OR PLUG BACK

1a. TYPE OF WORK

DRILL ☒

DEEPEN ☐

PLUG BACK ☐

b. TYPE OF WELL

OIL
WELL ☐

GAS
WELL ☒

OTHER ☐

2. NAME OF OPERATOR El Paso Natural Gas Company

3. ADDRESS OF OPERATOR

PO Box 4289, Farmington, NM 87499

4. LOCATION OF WELL (Report location clearly and in accordance with any State requirements.)

At 1070' N, 1100' E

At proposed prod. zone

14. DISTANCE IN MILES AND DIRECTION FROM NEAREST TOWN OR POST OFFICE*

15 miles from Allison, Colorado

15. DISTANCE FROM PROPOSED*
LOCATION TO NEAREST
PROPERTY OR LEASE LINE, FT.
(Also to nearest drig. unit line, if any)

1070'

18. DISTANCE FROM PROPOSED LOCATION*
TO NEAREST WELL, DRILLING, COMPLETED,
OR APPLIED FOR, ON THIS LEASE, FT.

200'

16. NO. OF ACRES IN LEASE

Unit 1872.99

17. NO. OF ACRES ASSIGNED
TO THIS WELL

320.00

19. PROPOSED DEPTH

3082'

20. ROTARY OR CABLE TOOLS

Rotary

21. ELEVATIONS (Show whether DF, RT, GR, etc.)

6402' GL

DRILLING AND CEMENTING ARE
SUBJECT TO STATE REQUIREMENTS ATTACHED

22. APPROX. DATE WORK WILL START*

23. PROPOSED CASING AND CEMENTING PROGRAM

This casing is subject to state requirements
and approval must be obtained from the state
and approved prior to drilling.

SIZE OF HOLE	SIZE OF CASING	WEIGHT PER FOOT	SETTING DEPTH	QUANTITY OF CEMENT
12 1/4"	9 5/8"	32.3#	200'	130 cf. circulated
8 3/4"	7"	20.0#	2998'	242 cf cover Ojo Alamo
6 1/4"	5 1/2" liner	23.0#	2878' - 3082'	do not cement

The Fruitland coal formation will be completed.

A 3000 psi WP and 6000 psi test double gate preventer equipped with blind and pipe rams will be used for blow out prevention on this well.

This gas is dedicated.

The E/2 of Section 30 is dedicated to this well.

RECEIVED
DEC 28 1988
OIL CON. DIV.
DIST. 3

IN ABOVE SPACE DESCRIBE PROPOSED PROGRAM: If proposal is to deepen or plug back, give data on present productive zone and proposed new productive zone. If proposal is to drill or deepen directionally, give pertinent data on subsurface locations and measured and true vertical depths. Give blowout preventer program, if any.

24. SIGNED [Signature] TITLE Regulatory Affairs DATE 11-08-88

(This space for Federal or State office use)

PERMIT NO. _____ APPROVAL DATE _____

APPROVED BY _____ TITLE _____
CONDITIONS OF APPROVAL, IF ANY:

APPROVED
AS AMENDED

DEC 22 1988

*See Instructions On Reverse Side

Title 18 U.S.C. Section 1001, makes it a crime for any person knowingly and willfully to make to any department or agency of the United States any false, fictitious or fraudulent statements or representations as to any matter within its jurisdiction.

All distances must be from the outer boundaries of the Section.

Operator <i>Meridian Oil Co.</i> El Paso Natural Gas		Lease Allison Unit (SF-081155)		Well No. 120	
Unit Letter A	Section 30	Township 32 North	Range 6 West	County San Juan	
Actual Footage Location of Wells 1070 feet from the North line and 1100 feet from the East line					
Ground Level Elev. 6402'	Producing Formation Fruitland Coal		Pool Basin	Dedicated Acreage: 320.00	

1. Outline the acreage dedicated to the subject well by colored pencil or hachure marks on the plat below.
2. If more than one lease is dedicated to the well, outline each and identify the ownership thereof (both as to working interest and royalty).
3. If more than one lease of different ownership is dedicated to the well, have the interests of all owners been consolidated by communitization, unitization, force-pooling, etc?

☒ Yes ☐ No If answer is "yes," type of consolidation unitization

If answer is "no," list the owners and tract descriptions which have actually been consolidated. (Use reverse side of this form if necessary.)

No allowable will be assigned to the well until all interests have been consolidated (by communitization, unitization, forced-pooling, or otherwise) or until a non-standard unit, eliminating such interests, has been approved by the Division. Reissued to show moved location.

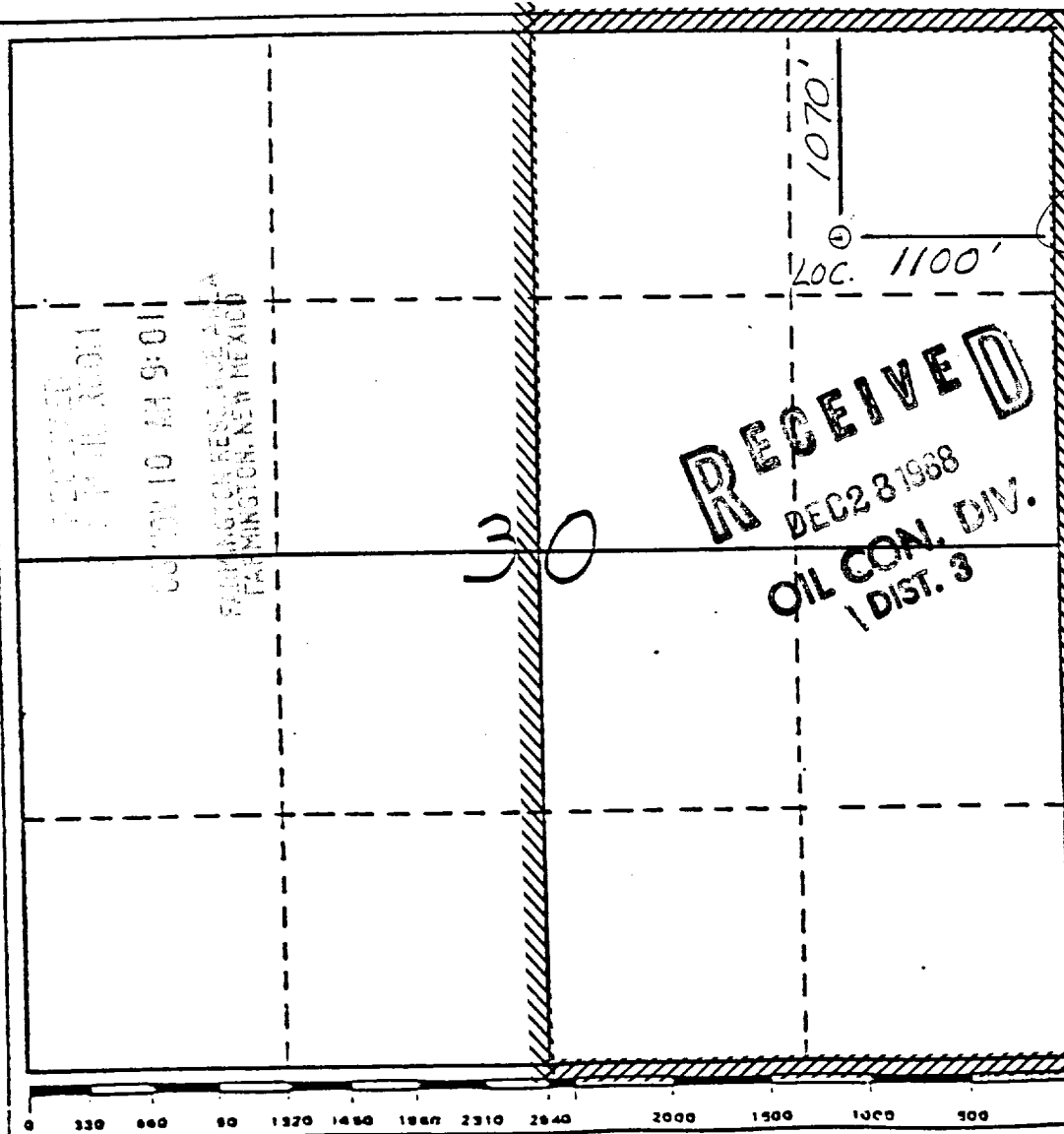

CERTIFICATION

I hereby certify that the information contained herein is true and complete to best of my knowledge and belief.

Name

Regulatory Affairs

Position

El Paso Natural Gas

Company

Date

I hereby certify that the location shown on this plat was plotted from notes of actual surveys made by me under my supervision, and that the same is true and correct to the best of my knowledge and belief.

Date Surveyed

11-1-88

Registered Professional Engineer
and/or Land Surveyor

Neale C. Edward

Certificate No.

6857

NEW MEXICO

DEPARTMENT OF THE INTERIOR
GEOLOGICAL SURVEY

7.5 MINUTE SERIES (TOPOGRAPHIC)

600 000 FEET (WEST) 22 MI 279 000m E

LA PLATA CO ARCHULETA CO
SAN JUAN CO MP 8084 244

LA PLATA CO
SAN JUAN CO

R 7 W R 6 W 277

MP 246 6269

6257

T-32N
R-7-W

T-32N
R-6-W

