

Submit to Appropriate
District Office
State Lease - 6 copies
Fee Lease - 5 copies

State of New Mexico
Energy, Minerals and Natural Resources Department

Form C-101
Revised 1-1-89

OIL CONSERVATION DIVISION

DISTRICT I
P.O. Box 1980, Hobbs, NM 88240

DISTRICT II
P.O. Drawer DD, Artesia, NM 88210

DISTRICT III
1000 Rio Brazos Rd., Aztec, NM 87410

P.O. Box 2088
Santa Fe, New Mexico 87504-2088

API NO. (assigned by OCD on New Wells)
30-045-27251
5. Indicate Type of Lease STATE <input checked="" type="checkbox"/> FEE <input type="checkbox"/>
6. State Oil & Gas Lease No. NM-E3088-E3091-E3092-E3093

APPLICATION FOR PERMIT TO DRILL, DEEPEN, OR PLUG BACK

1a. Type of Work: DRILL <input checked="" type="checkbox"/> RE-ENTER <input type="checkbox"/> DEEPEN <input type="checkbox"/> PLUG BACK <input type="checkbox"/>		7. Lease Name or Unit Agreement Name Box CANYON UNIT			
b. Type of Well: OIL WELL <input type="checkbox"/> GAS WELL <input checked="" type="checkbox"/> OTHER <input type="checkbox"/>		8. Well No. #202			
2. Name of Operator NORTHWEST PIPELINE CORP		9. Pool name or Wildcat Darwin Fruitland Coal			
3. Address of Operator 3539 EAST 30TH ST FARMINGTON, NM 87401					
4. Well Location Unit Letter M : 792 Feet From The SOUTH Line and 1157 Feet From The WEST Line					
Section 16 Township T32N Range R11W NMPM SAN JUAN County					
10. Proposed Depth 3575'		11. Formation FRUITLAND COAL			
12. Rotary or C.T. ROTARY					
13. Elevations (Show whether DF, RT, GR, etc.) 6886' GR		14. Kind & Status Plug. Bond SURETY BOND - CURRENT			
15. Drilling Contractor W/320		16. Approx. Date Work will start JUNE 15, 1990			
17. PROPOSED CASING AND CEMENT PROGRAM					
SIZE OF HOLE	SIZE OF CASING	WEIGHT PER FOOT	SETTING DEPTH	SACKS OF CEMENT	EST. TOP
12 1/4"	9 5/8"	36# K-55	200'	120 SK	SURFACE
8 3/4"	7"	23# K-55	3290'	450 SK	SURFACE
5 1/2"	5 1/2"	23# P-110	3190' to 3575'	NONE	N/A

1) PLAN TO DRILL FRUITLAND COAL FROM 3310' TO 3567' & SET LINER IN OPEN HOLE.

2) THE WEST HALF OF SECTION 16 IS DEDICATED TO THIS WELL.

3) BOP: 8" 3000 # SCHAFER N/ PIPE RAMS & BLIND RAMS

APPROVAL EXPIRES 10-23-90
UNLESS DRILLING IS COMMENCED.
SPUD NOTICE MUST BE SUBMITTED
WITHIN 10 DAYS

RECEIVED
APR 23 1990
OIL CON. DIV.
DIST. 3

IN ABOVE SPACE DESCRIBE PROPOSED PROGRAM: IF PROPOSAL IS TO DEEPEN OR PLUG BACK, GIVE DATA ON PRESENT PRODUCTIVE ZONE AND PROPOSED NEW PRODUCTIVE ZONE. GIVE BLOWOUT PREVENTER PROGRAM, IF ANY.

I hereby certify that the information above is true and complete to the best of my knowledge and belief.

SIGNATURE Mark McCallister TITLE PRODUCTION & DRILLING ENGINEER DATE 4/20/90
TYPE OR PRINT NAME MARK MCCALLISTER TELEPHONE NO. 327-5351

(This space for State Use)

APPROVED BY [Signature] TITLE MANAGER DISTRICT 3 DATE APR 23 1990
CONDITIONS OF APPROVAL, IF ANY:

RECEIVED

APR 11 1960

NO. 1000
OIL CONT. DIV.

RECEIVED

APR 11 1960

1000

RECEIVED

Submit to Appropriate
District Office
State Lease - 4 copies
Fee Lease - 3 copies

State of New Mexico
Energy, Minerals and Natural Resources Department

Form C-102
Revised 1-1-89

OIL CONSERVATION DIVISION

P.O. Box 2088

Santa Fe, New Mexico 87504-2088

DISTRICT I
P.O. Box 1980, Hobbs, NM 88240

DISTRICT II
P.O. Drawer DD, Artesia, NM 88210

DISTRICT III
1000 Rio Brazos Rd., Aztec, NM 87410

WELL LOCATION AND ACREAGE DEDICATION PLAT

All Distances must be from the outer boundaries of the section

Operator NORTHWEST PIPELINE CORP.			Lease COX CANYON UNIT		Well No. 202
Unit Letter M	Section 16	Township T.32 N.	Range R.11 W.	County SAN JUAN COUNTY	
Actual Footage Location of Well: 792 feet from the SOUTH line and 1157 feet from the WEST line					
Ground level Elev. 6886	Producing Formation FRUITLAND		Pool BASIN FRUITLAND COAL		Dedicated Acreage: W/2 320 Acres

1. Outline the acreage dedicated to the subject well by colored pencil or hachure marks on the plat below.

2. If more than one lease is dedicated to the well, outline each and identify the ownership thereof (both as to working interest and royalty).

3. If more than one lease of different ownership is dedicated to the well, have the interest of all owners been consolidated by communization, unitization, force-pooling, etc.?

☒ Yes

☐ No

If answer is "yes" type of consolidation

UNITIZED

If answer is "no" list the owners and tract descriptions which have actually been consolidated. (Use reverse side of this form if necessary).

No allowable will be assigned to the well until all interests have been consolidated (by communization, unitization, forced-pooling, or otherwise) or until a non-standard unit, eliminating such interest, has been approved by the Division.

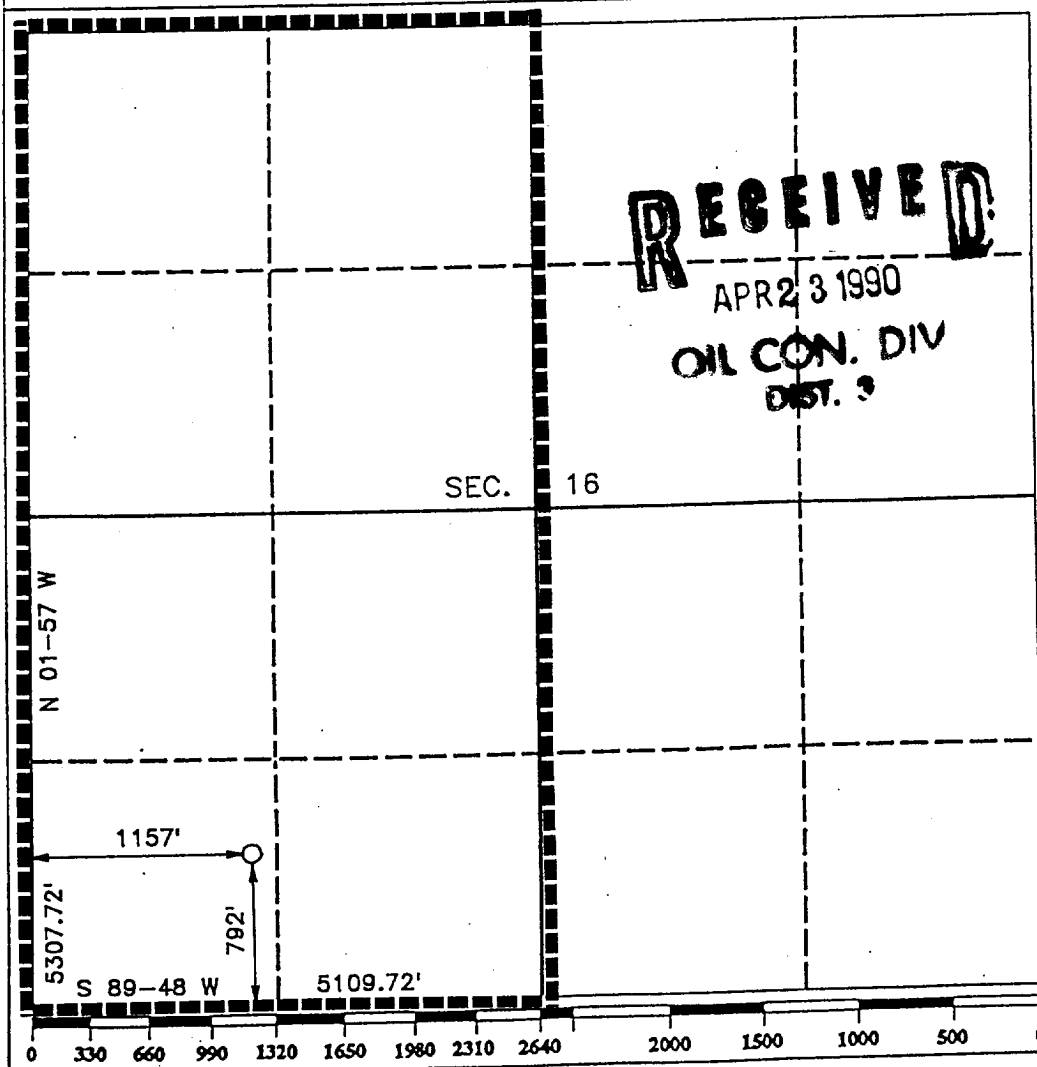

OPERATOR CERTIFICATION

I hereby certify that the information contained herein is true and complete to the best of my knowledge and belief.

Signature <i>Mark McCallister</i>
Printed Name MARK MCCALLISTER
Position PROD. & DRLG. ENGINEER
Company NORTHWEST PIPELINE CORP.
Date APRIL 17, 1990

SURVEYOR CERTIFICATION

I hereby certify that the well location shown on this plat was plotted from field notes of actual surveys made by me or under my supervision, and that the same is true and correct to the best of my knowledge and belief.

Date Surveyed APRIL 10, 1990
Signature of Professional Surveyor <i>R. Howard Daggett</i>
Printed Name R. HOWARD DAGGETT
Certificate No. 9679
Registered Professional Land Surveyor

