

UNITED STATES
DEPARTMENT OF THE INTERIOR
BUREAU OF LAND MANAGEMENT

APPLICATION FOR PERMIT TO DRILL, DEEPEN, OR PLUG BACK

1a. TYPE OF WORK DRILL <input checked="" type="checkbox"/> DEEPEN <input type="checkbox"/> PLUG BACK <input type="checkbox"/>		6. LEASE DENOMINATION AND SERIAL NO. SF-078096	
b. TYPE OF WELL OIL WELL <input type="checkbox"/> GAS WELL <input checked="" type="checkbox"/> OTHER Coal Seam <input type="checkbox"/> SINGLE ZONE <input checked="" type="checkbox"/> MULTIPLE ZONE <input type="checkbox"/>		7. UNIT AGREEMENT NAME	
2. NAME OF OPERATOR Amoco Production Company ATTN: J. L. Hampton		8. FARM OR LEASE NAME Mudge "B"	
3. ADDRESS OF OPERATOR P. O. Box 800 Denver, Colorado 80201		9. WELL NO. #62	
4. LOCATION OF WELL (Report location clearly and in accordance with any State requirements.) At surface 1470' FSL, 1570' FWL, NE/SW At proposed prod. zone same		10. FIELD AND POOL, OR WILDCAT Basin Fruitland Coal Gas	
11. DISTANCE IN MILES AND DIRECTION FROM NEAREST TOWN OR POST OFFICE 6 miles Artesia, NM		11. SEC., T., R., M., OR BLK. AND SURVEY OR AREA K Sec. 21, T31N R11W	
12. DISTANCE FROM PROPOSED LOCATION TO NEAREST PROPERTY OR LEASE LINE, FT. (Also to nearest drlg. unit line, if any) 1470'		12. COUNTY OR PARISH 13. STATE San Juan NM	
13. DISTANCE FROM PROPOSED LOCATION TO NEAREST WELL, DRILLING, COMPLETED, OR APPLIED FOR, ON THIS LEASE, FT.		14. NO. OF ACRES IN LEASE 2,512.00	
14. ELEVATIONS (Show whether DF, RT, GR, etc.) 5897' GR		15. NO. OF ACRES ASSIGNED TO THIS WELL 520 acres W/2 304.41	
15. PROPOSED CASING AND CEMENTING PROGRAM		16. PROPOSED DEPTH 2677' TD	
16. ROTARY OR CABLE TOOL		17. ROTARY OR CABLE TOOL Rotary	
17. APPROX. DATE WORK WILL START As soon as permitted		18. GENERAL REQUIREMENTS DRILLING OPERATIONS AUTHORIZED ARE SUBJECT TO COMPLIANCE WITH ATTACHED GENERAL REQUIREMENTS	
18. SIZE OF HOLE		19. SIZE OF CASING	
12 1/4"		8 5/8"	
7 7/8"		5 1/2"	
20. WEIGHT PER FOOT		21. SETTING DEPTH	
24#		250'	
17#		2677' (TD)	
22. QUANTITY OF CEMENT		23. QUANTITY OF CEMENT	
250 cf (cement to surface)		750 cf (cement to surface)	

Notice of Staking was submitted: 6/1/90

Lease Description:

T31N-R11W:

Sec. 8: E/2
Sec. 9: All
Sec. 14: S/2 SE/4
Sec. 17: E/2
Sec. 20: Lots 1-6, N/2 NE/4 (E/2)
Sec. 21: Lots 1-16, (All)
Sec. 23: W/2 NE/4, E/2 NW/4, NE/4 SW/4, NW/4 SE/4

RECEIVED
AUG 08 1990
OIL CON. DIV.
DIST. 3

IN ABOVE SPACE DESCRIBE PROPOSED PROGRAM: If proposal is to deepen or plug back, give data on present productive zone and proposed new productive zone. If proposal is to drill or deepen directionally, give pertinent data on subsurface locations and measured and true vertical depths. Give blowout preventer program, if any.

24. SIGNED J. L. Hampton
J. L. Hampton
TITLE Sr. Staff Admin. Supv. DATE 6/26/90
(This space for Federal or State office use)

PERMIT NO. APPROVAL DATA

APPROVED BY TITLE
CONDITIONS OF APPROVAL, IF ANY:

NMOCD

*See Instructions On Reverse Side

Amoco proposes to drill the well to further develop the Fruitland Coal reservoir. The well will be drilled to the surface casing point using native mud. The well will then be drilled to the total depth with a non-dispersed mud system. The attached modified 12" 3000 psi blowout preventer will be used (please see attached BOP information). The well will be completed in the Fruitland Coal with a fracture stimulation.

Quantity	Size	Weight	Description	Cementing Program
----------	------	--------	-------------	-------------------

SURFACE CASING

250'	8-5/8"	24#	K55 ST&C	250 cf Class B, 2% CaCl ₂ 15.6 ppg
------	--------	-----	----------	--

INTERMEDIATE STRING

2677	5.5"	17#	K55 ST&C	750 cf Class B, 65:35:6 10% salt, .25% dispersant 13.1 ppg 118 cf Class B, 2% CaCl ₂ 15.6 ppg
------	------	-----	----------	---

The above casing design is based upon a 11.0#/gal mud weight.

EVALUATION

The log surveys (FDC/GR/CAL, Microlog) will be run per attached drilling and completion program.

Submit to Appropriate
District Office
State Lease - 4 copies
Fee Lease - 3 copies

State of New Mexico
Energy, Minerals and Natural Resources Department

Form C-102
Revised 1-1-89

OIL CONSERVATION DIVISION

P.O. Box 2088
Santa Fe, New Mexico 87504-2088

DISTRICT I
P.O. Box 1980, Hobbs, NM 88240

DISTRICT II
P.O. Drawer DD, Artesia, NM 88210

DISTRICT III
1000 Rio Brazos Rd., Aztec, NM 87410

WELL LOCATION AND ACREAGE DEDICATION PLAT

All Distances must be from the outer boundaries of the section

Operator AMOCO PRODUCTION COMPANY			Lease MUDGE /B/		Well No. # 62
Unit Letter K	Section 21	Township 31 NORTH	Range 11 WEST	County SAN JUAN	
Actual Footage Location of Well: 1470 feet from the SOUTH line and 1570 feet from the WEST line					
Ground level Elev. 5897	Producing Formation Fruitland Coal	Pool Basin Fruitland Coal Gas		Dedicated Acreage W/2 304.41 Acres	

1. Outline the acreage dedicated to the subject well by colored pencil or hatchure marks on the plat below.
2. If more than one lease is dedicated to the well, outline each and identify the ownership thereof (both as to working interest and royalty).
3. If more than one lease of different ownership is dedicated to the well, have the interest of all owners been consolidated by communitization, unitization, force-pooling, etc.?
☐ Yes ☐ No If answer is "yes" type of consolidation _____
If answer is "no" list the owners and tract descriptions which have actually been consolidated. (Use reverse side of this form if necessary.) _____
No allowable will be assigned to the well until all interests have been consolidated (by communitization, unitization, forced-pooling, or otherwise) or until a non-standard unit, eliminating such interest, has been approved by the Division.

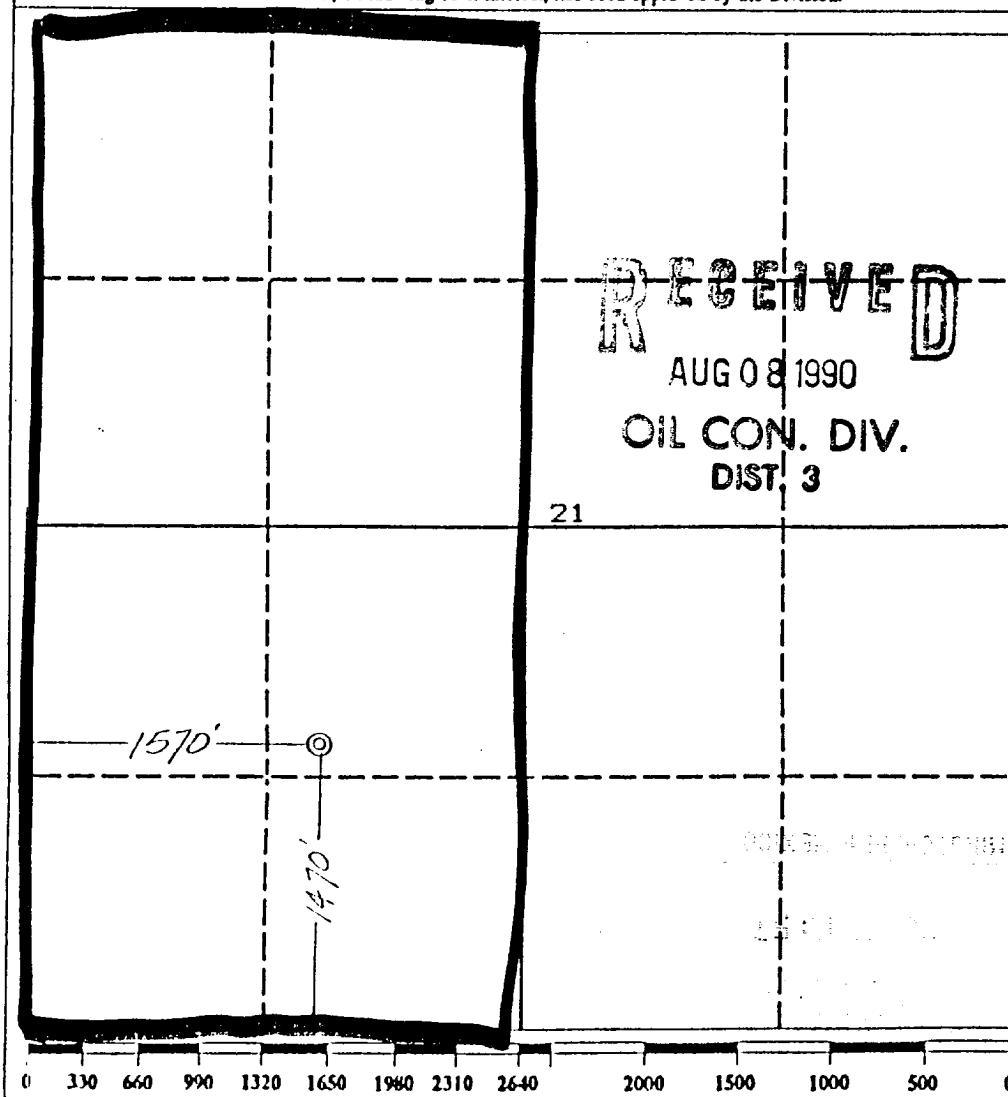

OPERATOR CERTIFICATION

I hereby certify that the information contained herein is true and complete to the best of my knowledge and belief.

Signature *JL Hampton*
Printed Name **JL Hampton**
Position **Sr Staff Admin Supr**
Company **Amoco Prod.**
Date **6-1-90**

SURVEYOR CERTIFICATION

I hereby certify that the well location shown on this plat was plotted from field notes of actual surveys made by me or under my supervision, and that the same is true and correct to the best of my knowledge and belief.

Date Surveyed **May 24, 1990**

Signature & Seal of Professional Surveyor

GARY D. VANN
7016
REGISTERED PROFESSIONAL LAND SURVEYOR
NEW MEXICO
7016

