

UNITED STATES
DEPARTMENT OF THE INTERIOR
BUREAU OF LAND MANAGEMENT

APPLICATION FOR PERMIT TO DRILL, DEEPEN, OR PLUG BACK

1a. TYPE OF WORK

DRILL ☒

DEEPEN ☐

PLUG BACK ☐

b. TYPE OF WELL

OIL
WELL ☐

GAS
WELL ☒

OTHER Coal Seam

SINGLE
ZONE ☒

MULTIPLE
ZONE ☐

2. NAME OF OPERATOR

GREAT WESTERN DRILLING COMPANY

3. ADDRESS OF OPERATOR

2550 La Plata Hwy. Farmington, NM 87401

4. LOCATION OF WELL (Report location clearly and in accordance with any State requirements.)*

At surface

895' FSL, 840' FWL

NE/SW

At proposed prod. zone

14. DISTANCE IN MILES AND DIRECTION FROM NEAREST TOWN OR POST OFFICE*

8 miles Aztec, NM

15. DISTANCE FROM PROPOSED*

LOCATION TO NEAREST
PROPERTY OR LEASE LINE, FT.
(Also to nearest drlg. unit line, if any)

895'

18. DISTANCE FROM PROPOSED LOCATION*

TO NEAREST WELL, DRILLING, COMPLETED,
OR APPLIED FOR, ON THIS LEASE, FT.

16. NO. OF ACRES IN LEASE

2,512.00

19. PROPOSED DEPTH

2940' TD

17. NO. OF ACRES ASSIGNED
TO THIS WELL

320 acres W/2

20. ROTARY OR CABLE TOOLS

Rotary

21. ELEVATIONS (Show whether DF, RT, GR, etc.)

6085 GR

This action is subject to technical and
procedural review pursuant to 43 CFR 3165.3

and appeal pursuant to 43 CFR 3165.4

23. DRILLING, CEMENTING AND CEMENTING PROGRAM

SUBJECT TO COMPLIANCE WITH ATTACHED
"GENERAL REQUIREMENTS"

SIZE OF HOLE	SIZE OF CASING	WEIGHT PER FOOT	SETTING DEPTH	CEMENT
12 1/4"	8 5/8"	24#	250'	250 cf (cement to surface)
7 7/8"	5 1/2"	17#	2940 (TD)	823 cf (cement to surface)

NOTICE OF STAKING WAS SUBMITTED: 10-19-90

Lease Description:

T31N R11W:

Sec. 8: E/2

Sec. 9: All

Sec. 14: S/2SE/4

Sec. 17: E/2

Sec. 20: Lots 1-6, N/2NE/4, E/2

SEc. 21: Lots 1-6, All

Sec. 23: W/2NE/4, E/2NW/4, NE/4SW/4, NW/4SE/4

IN ABOVE DESCRIBE PROPOSED PROGRAM: If proposal is to deepen or plug back, give data on present productive zone and proposed new productive zone. If proposal is to drill or deepen directionally, give pertinent data on subsurface locations and proposed depths. Give blowout prevention program, if any.

24.

SE

TITLE Area Supervisor

11-28-90

(This space for Federal or State office use)

PERM

APPROVAL DATE

APPROVED BY

TITLE

CONDITIONS OF APPROVAL, IF ANY:

NMOCD

*See Instructions On Reverse Side

Title 18 U.S.C. Section 1001, makes it a crime for any person knowingly and willfully to make to any department or agency of the United States any false, fictitious or fraudulent statements or representations as to any matter within its jurisdiction.

5. LEASE DESIGNATION AND SERIAL NO.
SF-078096

6. IF INDIAN, ALLOTTEE OR TRIBE NAME

7. UNIT AGREEMENT NAME

8. FARM OR LEASE NAME
Mudge "C"

9. WELL NO.
60

10. FIELD AND POOL, OR WILDCAT
Basin Fruitland Coal Gas

11. SEC., T., R., M., OR BLE.
AND SURVEY OR AREA
M Sec. 9, T31N R11W

12. COUNTY OR PARISH
San Juan

13. STATE
NM

"Approval of this action does
not warrant that the applicant
holds legal or equitable right
or title to this land."

RECEIVED

JAN 04 1991

OIL CON. DIV.

DIST. 3

APPROVED
AS AMENDED

DEC 27 1990

AREA MANAGER

Submit to Appropriate
District Office
State Lease - 4 copies
Fee Lease - 3 copies

State of New Mexico
Energy, Minerals and Natural Resources Department

Form C-102
Revised 1-1-89

OIL CONSERVATION DIVISION

DISTRICT I
P.O. Box 1980, Hobbs, NM 88240

P.O. Box 2088

Santa Fe, New Mexico 87504-2088

DISTRICT II
P.O. Drawer DD, Artesia, NM 88210

DISTRICT III
1000 Rio Brazos Rd., Aztec, NM 87410

WELL LOCATION AND ACREAGE DEDICATION PLAT

All Distances must be from the outer boundaries of the section.

Operator GREAT WESTERN DRILLING COMPANY			Lease MUDGE C		Well No. 60
Unit Letter M	Section 9	Township 31 N	Range 11 W	County San Juan	
Actual Footage Location of Well: 895 feet from the South line and 840 feet from the West line					
Ground level Elev. 6085	Producing Formation BASIN FRUITLAND COAL GAS		Pool BASIN FRUITLAND COAL		Dedicated Acreage 2,512.00 Acres
<p>1. Outline the acreage dedicated to the subject well by colored pencil or hatchure marks on the plat below.</p> <p>2. If more than one lease is dedicated to the well, outline each and identify the ownership thereof (both as to working interest and royalty).</p> <p>3. If more than one lease of different ownership is dedicated to the well, have the interest of all owners been consolidated by communitization, unitization, force-pooling, etc.? <input type="checkbox"/> Yes <input type="checkbox"/> No If answer is "yes" type of consolidation _____</p> <p>If answer is "no" list the owners and tract descriptions which have actually been consolidated. (Use reverse side of this form if necessary.) _____</p> <p>No allowable will be assigned to the well until all interests have been consolidated (by communitization, unitization, forced-pooling, or otherwise) or until a non-standard unit, eliminating such interest, has been approved by the Division.</p>					

0 350 660 990 1320 1650 1980 2310 2640 2000 1500 1000 500 0

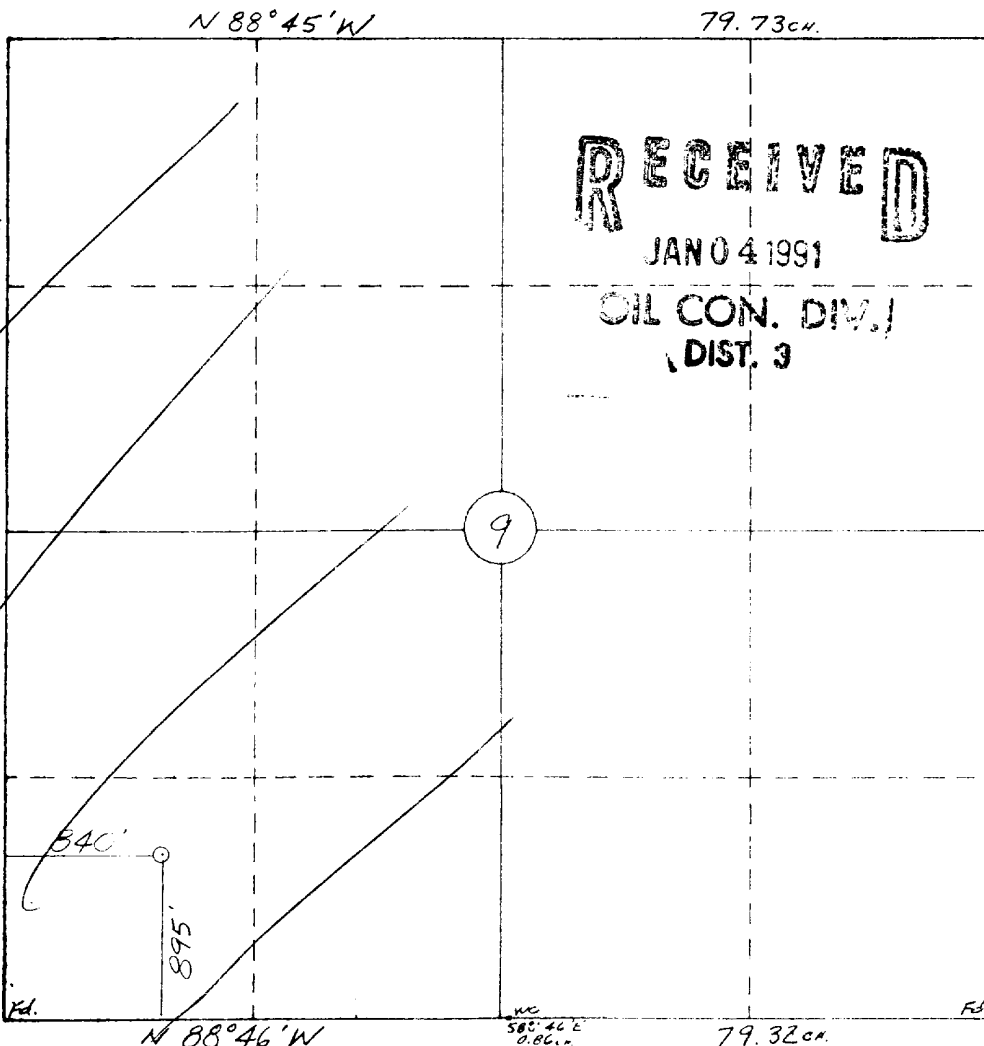

OPERATOR CERTIFICATION

I hereby certify that the information contained herein is true and complete to the best of my knowledge and belief.

Signature
D. E. Baxter
Printed Name
D. E. BAXTER
Position
DIV. SUPERINTENDENT
Company
GREAT WESTERN DRILLING CO
Date
10-28-90

SURVEYOR CERTIFICATION

I hereby certify that the well location shown on this plat was plotted from field notes of actual surveys made by me or under my supervision, and that the same is true and correct to the best of my knowledge and belief.

10-19-90
Date Surveyed
William F. Mahnke II
Signature & Seal of
Professional Surveyor

Certificate No. 8466

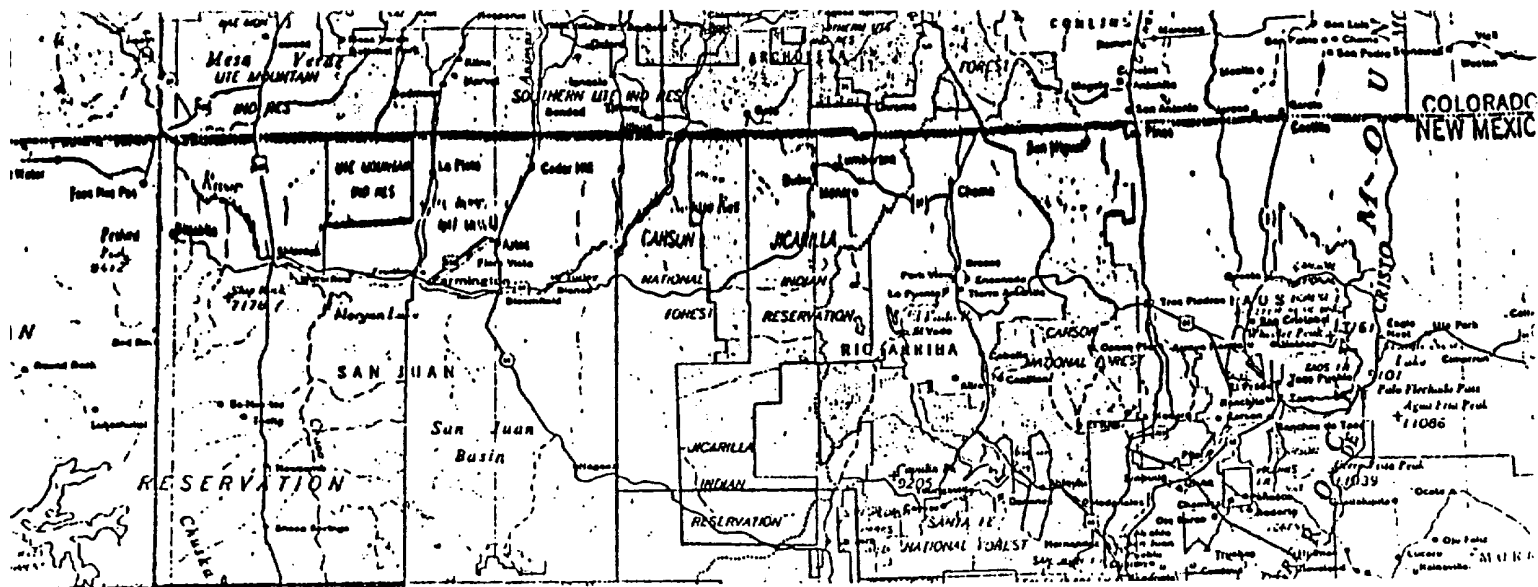

MUDGE "C" #60
 895' FSL 840' FWL
 SEC. 9, T31N, R11W NMPM
 RAIL POINT: 141 miles from Montrose, CO
 MUD POINT: 8 miles from Aztec, NM
 CEMENT POINT: 22 miles Farmington NM

