

Submit 3
Copies to
Appropriate

State of New Mexico
Energy, Minerals and Natural Resources

Form C-103
Revised 1-1-89

DISTRICT I
P.O. Box 1980, Hobbs, NM
DISTRICT II
P.O. Drawer DD, Artesia, NM 88210
DISTRICT III
1000 Rio Brazos Rd., Aztec, NM

OIL CONSERVATION DIVISION

P.O. Box 2088
Santa Fe, New Mexico 87504-2088

WELL API NO.	30-045-28616
5. Indicate Type of Lease	STATE <input type="checkbox"/> FEE <input checked="" type="checkbox"/>
6. State Oil & Gas Lease No.	

SUNDRY NOTICES AND REPORTS ON WELLS
(DO NOT USE THIS FORM FOR PROPOSALS TO DRILL OR TO DEEPEN OR PLUG BACK TO A
DIFFERENT RESERVOIR. USE "APPLICATION FOR PERMIT"
(FORM C-101) FOR SUCH PROPOSALS.)

RECEIVED
MAY 24 1999

1. Type of Well: OIL WELL <input type="checkbox"/> GAS WELL <input checked="" type="checkbox"/> OTHER	7. Lease Name or Unit Agreement Name Webb Gas Com
2. Name of Operator AMOCO PRODUCTION COMPANY Attention Mary Corley	8. Well No. 1
P. O. Box 3092 Houston, TX 77253 218-366-4491	9. Pool name or Wildcat Basin Dakota/Fruitland Coal
4. Well Location Unit Letter K : 1470 Feet From The SOUTH Line and 1850 Feet From The WEST Line Sectio 5 Township 31N Rang 10W NMPM SAN JUAN County	
10. Elevation (Show whether DF, RKB, RT, GR, etc.) 5814' KB	

11.

Check Appropriate Box to Indicate Nature of Notice Report or Other Data
NOTICE OF INTENTION TO:

PERFORM REMEDIAL WORK ☒ PLUG AND ABANDON ☐
TEMPORARILY ABANDON ☐ CHANGE PLANS ☐
PULL OR ALTER CASING ☐
OTHER: P&A the Dakota and change TBG in the Fruitland ☒

SUBSEQUENT REPORT OF:

REMEDIAL WORK ☐ ALTERING CASING ☐
COMMENCE DRILLING OPNS. ☐ PLUG AND ABANDONMENT ☐
CASING TEST AND CEMENT JOB ☐
OTHER: ☐

12. Describe Proposed or Completed Operations (Clearly state all pertinent details, and give pertinent dates, including estimated date of starting any proposed)

Amoco Production Company request premission to P&A the Dakota formation and upsize the Fruitland Tubing string as per the attached procedure.

Should you have and technical questions please contact Mike Kutas @ 281-366-5812. For administrative issues please contact Mary Corley @ 281-366-4491.

I hereby certify that the information above is true and complete to the best of my knowledge and belief.

SIGNATURE Mary Corley TITLE Sr. Business Analyst DATE 05-17-1999
TYPE OR PRINT NAME TELEPHONE NO.

(This space for State

DEPUTY OIL & GAS INSPECTOR, DIST. #3

APPROVED BY ORIGINAL SIGNED BY ERNIE BUSCH

TITLE DATE MAY 27 1999

CONDITIONS OF APPROVAL, IF ANY:

SJOET Well Work Procedure

Webb GC 1

Version: webb_gc1.doc
Date: May 12, 1999
Budget: Well Abandonment
Work Type: PXA Dakota - Upsize Fruitland TBG
SAP Project: X7-00078

Objectives:

1. PXA Dakota
 2. Upsize Fruitland tubing string
 3. Restore strong tubing flow and increase production
 4. Place well back on production
-

Pertinent Information:

Location:	1470' FSL x 1850' FWL; Sec 5K-T31N-R10W	Horizon:	FC/DK
County:	San Juan	API #:	30-045-28616
State:	New Mexico	Engr:	Mike Kutas
Lease:	Fee	Phone:	W-(281)366-5812
Well Flac:	700780		P-(888)907-0916
Lease Flac:	183222		H-(281)693-3700

Economic Information:

APC WI:	99.10%	Prod. Before Repair:	75 MCFD
Estimated Cost:	\$15,000	Anticipated Prod.:	275 MCFD
Payout:			

Note: Economics will be run on all projects that have a payout exceeding ONE year.

Formation Tops:

Nacimiento:		Menefee:	4468' - 4875'
Ojo Alamo:		Point Lookout:	4875
Kirtland Shale:		Mancos Shale:	
Fruitland:	2200' - 2610'	Gallup:	
Pictured Cliffs:	2610' - 4110'	Graneros:	
Cliff House:	4110' - 4468'	Dakota:	6990' - TD
Mesaverde:		Morrison:	

Bradenhead Test Information:

Test Date: 3/16/98 **Tubing:** 116 psi **Casing:** 133 psi **BH:** 0 psi

Time	BH	CSG	INT	CSG
5 min	0	133		
10 min	0	133		
15 min	0	133		

Comments: Bradenhead had no flow or pressure.

Webb GC 1

Orig. Comp. 7/92

TD = 7300', PBD = 7241'

Page 2 of 2

Current wellbore info: 7" CSG @ 2935'

4-1/2" Liner @ 2621'-7300

1-1/4" TBG @ 2582' (short string)

2-3/8" TBG @ 7149' (long string)

Permanent Packer @ 2636'

Perfs @ 2554'-2608' and 6988'-7182'

Current flow info: 75 MCFD

FTP=109 psi, CP=136 psi, LP=108 psi

Cannot flow up short string (flowing up annulus)

Short term plans: PxA Dakota

Change Fruitland tubing string and restore strong tubing production

1. **MIRUSU. WORK WELL HOT.....DO NOT USE KILL FLUID!**
2. Using the short string, tag for fill (packer @ 2621').
3. If no fill exists, continue to step 4. If fill is present, circulate out of hole.
4. TOH w/ 1-1/4" short string.
5. TOH w/ entire 2-3/8" long string, LD all but 2700'.
6. PU additional 1 1/4" TBG and TIH and spot CMT plug from PBTD to 5988' (DK perfs @ 6988-7182'; approx. 35-40 sxs cmt); Raise TBG above PKR and SDON.
7. TIH and tag CMT to determine TOC; TOH and LD 1 1/4" TBG; TIH w/ 2620' 2-3/8" TBG and PKR seal assembly. Sting into PKR and pressure test SQZ/CSG/PKR to 500 psi. Unseat assembly and land TBG at approx. 2580-90'. Bottom hole assembly should include a mule shoe, one joint and SN.
8. RDMOSU and turn the well over to production.

If problems are encountered contact:

Mike Kutas

Work - (281)366-5812

Home - (281)693-3700

Pager - (888)907-0916

Comments:

1 1/4" TBG Salvage Value: \$3625--includes salvage and inspection

2 3/8" TBG Salvage Value: \$9860--includes salvage and inspection

Amoco Production Company

ENGINEERING CHART

SUBJECT WEBB GC 1 FC/DK

SECT SK-T3IN-R10W

WT = 88.02%
MRE = 68.445% } Both Holes Burn

NO. 3501

Sheet No

File

Appn

Date

5-12-95

By

G.M.K.

Perfs

2554-58'
2560-68'
2588-96'
2602-08'

9 5/8" CSA 438'
36" KSS
CMT circ'd

DV Tool @ 1097'
CMT circ'd

4/3 Tag
1 1/2" Tool to 5312' GL
5/3 Tag (After Acid Stn)
1 1/2" Tool to 5316' GL

Short string:

1 1/4" TSA 2582'
2.33" JSS IT

Mule shoe on BTM, Pump SN @
1 JT OFF BTM

PKR SA 2621'

7" CSA 2935'
23" KSS
CMT circ'd

① Run tag = PKR, SET PCL
@ 2582', CMT 502 TOL
w/ 400 SXS class B + 2% gel

Long string:

2 3/8" TSA 7149'
4.7" JSS

NETTED CONN ON BTM, PMP SN 1 JT OFF BTM

6988-7062'
7072-7096'
7112-24'
7142-52'
7156-82'

- 10 1/4" P. 11 @ 7241'

F. 11 @ 7265'

PBD = 7280'

4 1/2" CSA 2621' - 7300'
11.6" KSS

CMT w/ 660 SXS 50:50 Pore + 2% gel (class G)
+ 10'3 SXS class 14

* NO RETURNS THROUGHOUT JOB

WEBB GC 1 - PROPOSED WELLBORE Sec 5K - T3IN - R10W

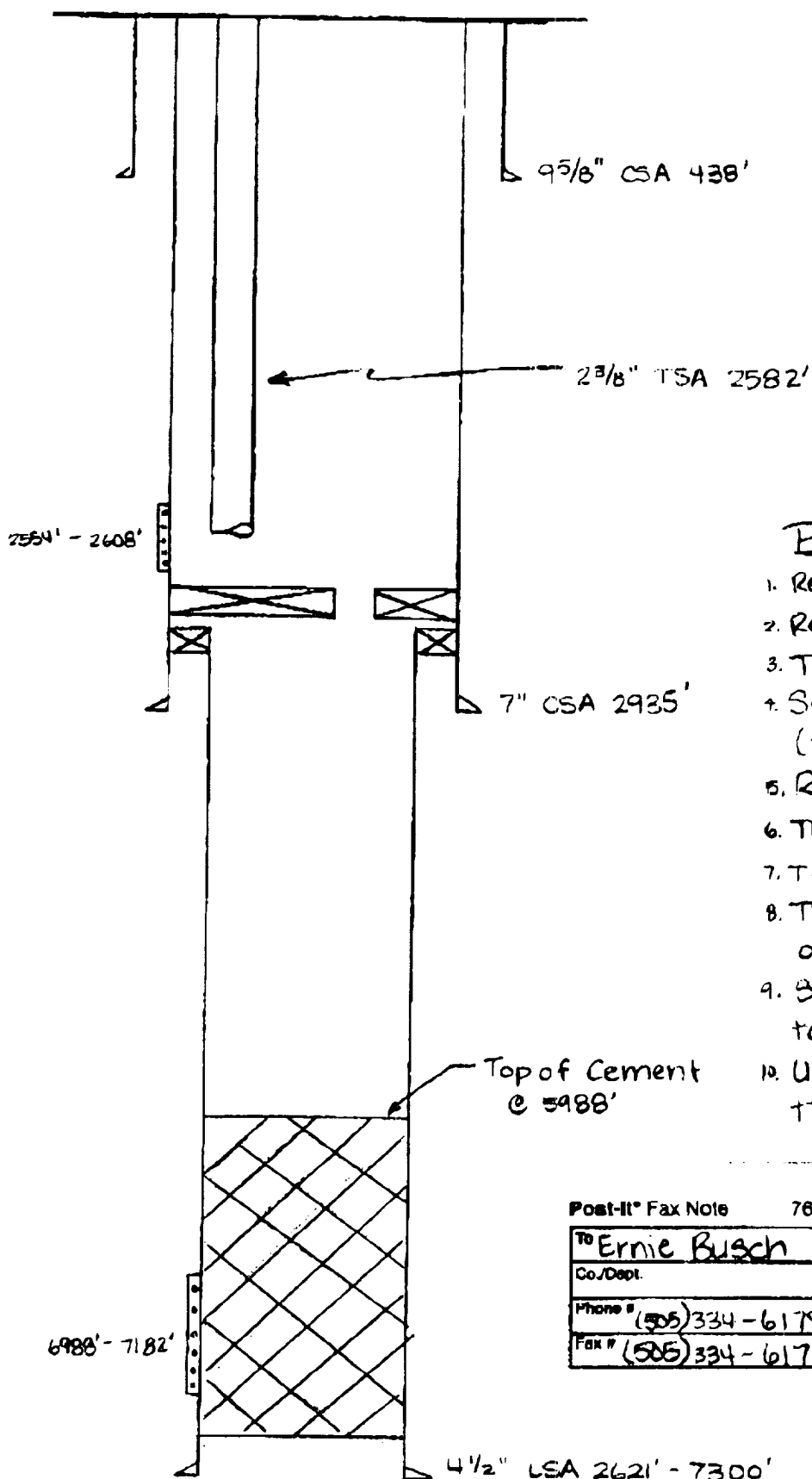

Verbal Approval Rec'd
via telecon on 5/3/99
between Mike Kutas
& Ernie Busch

Proposed Work

1. Remove short string
2. Remove long string
3. TTH w/ 1 1/4" tbg
4. Spot cmt plug from TD - 5988' (30-40 ex class B cmt)
5. Raise tubing above pkr, SDON.
6. TTH and tag to determine TOC.
7. TTH w/ 1 1/4" tbg
8. TTH w/ 2 3/8" w/ seal assembly on btm.
9. String into pkr and pressure test casing to 500 psi.
10. Unstring and land 2 3/8" tubing @ 2582'.

Post-It* Fax Note	7671	Date	3/4/99	pages	1
To	Ernie Busch	From	Brenda Bauernfeind		
Co/Dept.		Co.	AMOCO		
Phone #	(505) 334-6178	Phone #	(303) 830-4197		
Fax #	(505) 334-6170	Fax #	(303) 830-5794		

Submit to Appropriate
District Office
State Lease - 4 copies
Fee Lease - 3 copies

State of New Mexico
Energy, Minerals and Natural Resources Department

Form C-102
Revised 1-1-89

OIL CONSERVATION DIVISION

DISTRICT I
P.O. Box 1980, Hobbs, NM 88240

P.O. Box 2088
Santa Fe, New Mexico 87504-2088

DISTRICT II
P.O. Drawer DD, Artesia, NM 88210

DISTRICT III
1000 Rio Brazos Rd., Aztec, NM 87410

WELL LOCATION AND ACREAGE DEDICATION PLAT

All Distances must be from the outer boundaries of the section

Operator AMOCO PRODUCTION COMPANY			Lease WEBB GAS COM		Well No. # 1
Unit Letter K	Section 5	Township 31 NORTH	Range 10 WEST	County NMPM SAN JUAN	
Actual Footage Location of Well: 1470 feet from the SOUTH line and 1850 feet from the WEST line					
Ground level Elev. 5802	Producing Formation Dakota/Fruitland Coal		Pool Basin Dakota/Fruitland Coal	Dedicated Acreage: 5/2320/320 Acres	
<p>1. Outline the acreage dedicated to the subject well by colored pencil or hatchure marks on the plat below.</p> <p>2. If more than one lease is dedicated to the well, outline each and identify the ownership thereof (both as to working interest and royalty).</p> <p>3. If more than one lease of different ownership is dedicated to the well, have the interest of all owners been consolidated by communitization, unitization, force-pooling, etc.? <input type="checkbox"/> Yes <input type="checkbox"/> No If answer is "yes" type of consolidation _____</p> <p>If answer is "no" list the owners and tract descriptions which have actually been consolidated. (Use reverse side of this form if necessary.) _____</p> <p>No allowable will be assigned to the well until all interests have been consolidated (by communitization, unitization, forced-pooling, or otherwise) or until a non-standard unit, eliminating such interest, has been approved by the Division.</p>					

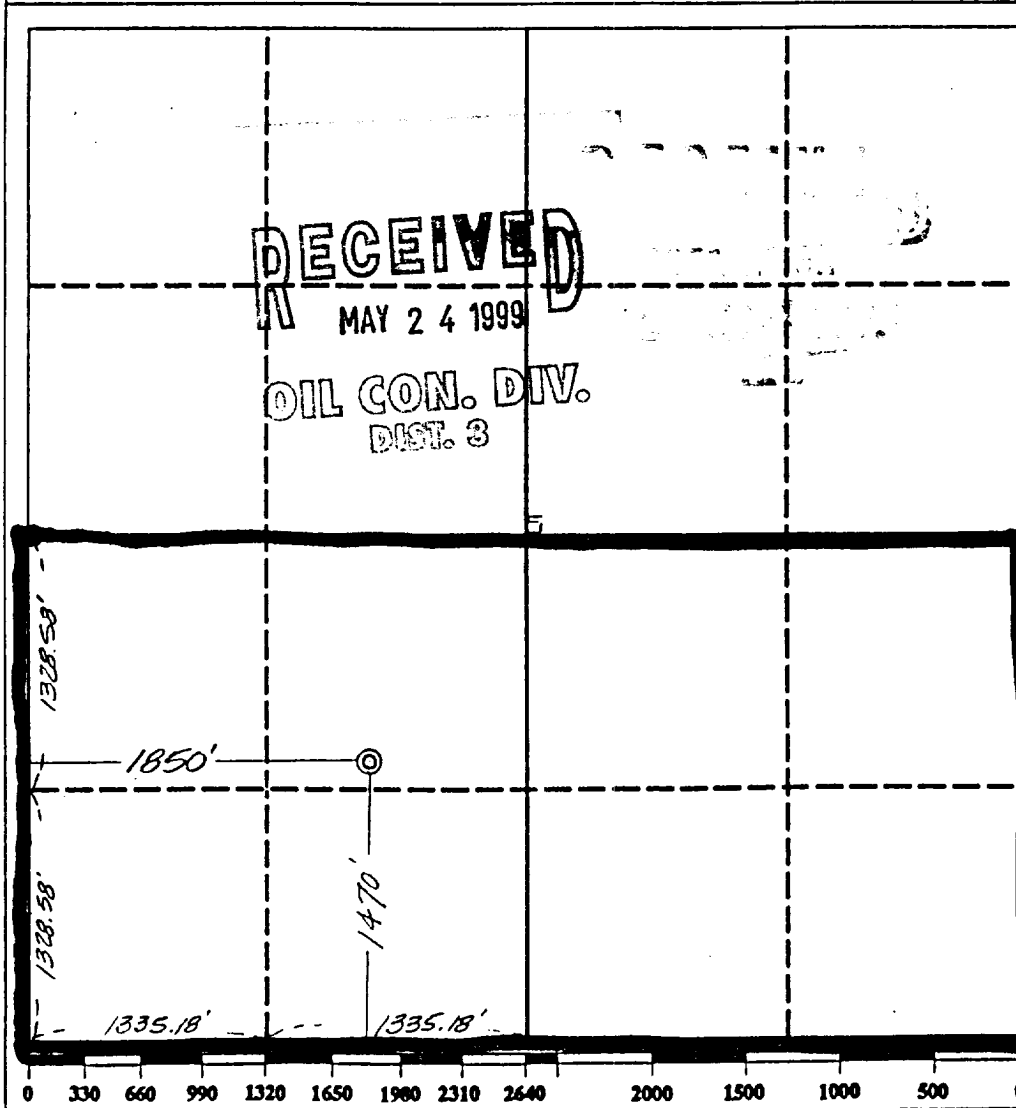

OPERATOR CERTIFICATION I hereby certify that the information contained herein is true and complete to the best of my knowledge and belief.	
Signature <i>G. L. Hampton</i>	Printed Name G. L. Hampton
Position SR Staff Admin Supv.	Company Amoco Prod. Co.
Date 10/15/91	
SURVEYOR CERTIFICATION I hereby certify that the well location shown on this plat was plotted from field notes of actual surveys made by me or under my supervision, and that the same is true and correct to the best of my knowledge and belief.	
Date Surveyed October 4, 1991	
Signature & Seal of Professional Surveyor GARY D. VANN	
Gary D. Vann 7016	