

UNITED STATES
DEPARTMENT OF THE INTERIOR
BUREAU OF LAND MANAGEMENT

30-045-28888

APPLICATION FOR PERMIT TO DRILL, DEEPEN, OR PLUG BACK

1a. TYPE OF WORK
DRILL ☒ DEEPEN ☐ PLUG BACK ☐

b. TYPE OF WELL
OIL WELL ☐ GAS WELL ☒ OTHER ☐ SINGLE ZONE ☒ MULTIPLE ZONE ☐

2. NAME OF OPERATOR
Emerald Gas Operating Company 36415

3. ADDRESS OF OPERATOR
570 Turner Drive, Unit B, Durango, CO 81301

4. LOCATION OF WELL (Report location clearly and in accordance with any State requirements.)*
At surface 2182' FNL and 1775' FEL (SWNE)
At proposed prod. zone Same

14. DISTANCE IN MILES AND DIRECTION FROM NEAREST TOWN OR POST OFFICE*
Six miles north - northwest of Aztec, NM

15. DISTANCE FROM PROPOSED* LOCATION TO NEAREST PROPERTY OR LEASE LINE, FT. (Also to nearest drlg. unit line, if any)
865'

18. DISTANCE FROM PROPOSED LOCATION* TO NEAREST WELL, DRILLING, COMPLETED, OR APPLIED FOR, ON THIS LEASE, FT.
348'

21. ELEVATIONS (Show whether DF, RT, GR, etc.)
GL: 6241'

23. PROPOSED CASING AND CEMENTING PROGRAM

SIZE OF HOLE	SIZE OF CASING	WEIGHT PER FOOT	SETTING DEPTH
12 1/4"	9 5/8"	32.0-J55	300'
8 3/4"	7"	23.0-K55	2585'
Carity Section	N/A	N/A	2585-2830

Operator proposes to drill the well and complete open hole to test the gas potential of the Fruitland Formation coal seams. The following are attached:

- Exhibit A: Surveyor's Location and Elevation Plat
- Exhibit B: Drilling Program
- Exhibit C-1,2,3: Blowout Preventer Schematic
- Exhibit D: Surface Use Program
- Exhibit E-1, E-2: Vicinity Map & Existing and Access Road Map
- Exhibit F: Radius Map of Field, Showing Existing Wells
- Exhibit G: Drill Pad Layout with Cut/Fill Diagram
- Exhibit H-1,2: Drilling Rig Layout and Layout of Anticipated Production Facilities

IN ABOVE SPACE DESCRIBE PROPOSED PROGRAM: If proposal is to deepen or plug back, give data on present productive zone and proposed new productive zone. If proposal is to drill or deepen directionally, give pertinent data on subsurface locations and measured and true vertical depths. Give blowout preventer program, if any.

24. SIGNED Burford C. Boyer TITLE Manager Development/Geology DATE November 25, 1992

(This space for Federal or State office use)

PERMIT NO.

APPROVED BY

CONDITIONS OF APPROVAL, IF ANY:

RECEIVED

DEC 15 1992

OIL CON. DIV.
DIST. 3

APPROVAL DATE

TITLE

APPROVED
AS AMENDED

DEC 11 1992

AREA MANAGER

*See Instructions On Reverse Side

NMOCD

EMERALD GAS OPERATING COMPANY

EXHIBIT "A": SURVEYOR'S LOCATION & DEDICATION PLAT

RECEIVED
BLM

92 NOV 25 AM 10:12

Operator EMERALD GAS OPERATING CO.			Lease HORTON FEDERAL CB-7		Well No. #170N, N.M.
Unit Letter G	Section 7	Township 31 North	Range 11 West	County San Juan	

Actual Footage Location of Well:

2182 feet from the North line and	1775 feet from the East line
Ground level Elev. 6241	Producing Formation Fruitland Coals
Pool Basin Fruitland Coal	Dedicated Acreage: 320 Acres

- Outline the acreage dedicated to the subject well by colored pencil or hatchure marks on the plat below.
- If more than one lease is dedicated to the well, outline each and identify the ownership thereof (both as to working interest and royalty).
- If more than one lease of different ownership is dedicated to the well, have the interest of all owners been consolidated by communitization, unitization, force-pooling, etc.? ☐ Yes ☐ No N/A If answer is "yes" type of consolidation _____
If answer is "no" list the owners and tract descriptions which have actually been consolidated. (Use reverse side of this form if necessary).
No allowable will be assigned to the well until all interests have been consolidated (by communitization, unitization, forced-pooling, or otherwise) or until a non-standard unit, eliminating such interest, has been approved by the Division.

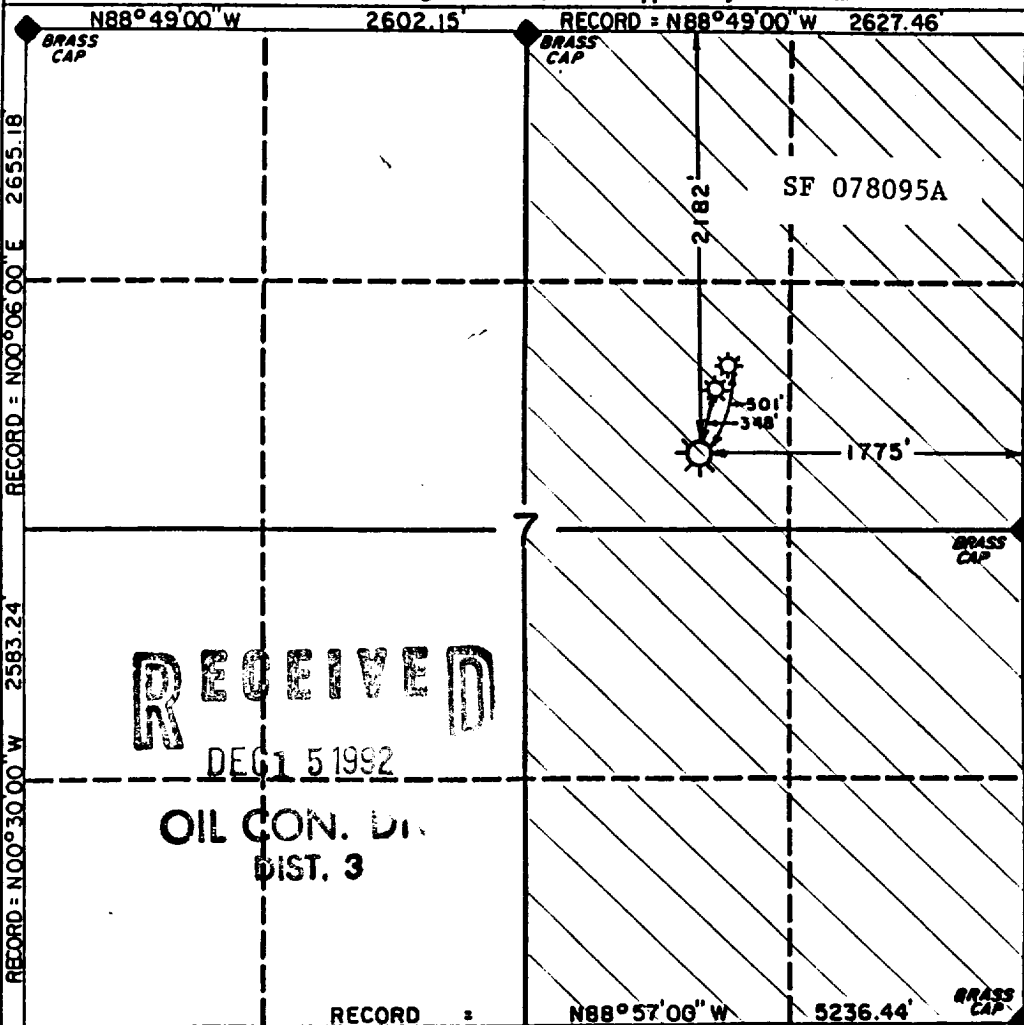

OPERATOR CERTIFICATION

I hereby certify that the information contained herein is true and complete to the best of my knowledge and belief.

Signature
Bradford C. Boyce
Printed Name
Bradford C. Boyce
Position
Mng'r of Develop + Geology
Company
Emerald Gas Operating
Date
11/24/92

SURVEYOR CERTIFICATION

I hereby certify that the well location shown on this plat was plotted from field notes, actual surveys made by me or under my supervision, and that the same is true and correct to the best of my knowledge and belief.

11/17/92

Date Surveyed
Ronald E. Johnson
Signature & Seal of Professional Surveyor

Certificate No.
6703
REGISTERED LAND SURVEYOR
NEW MEXICO
6703

RECEIVED

DEC 15 1992

OIL CON. DIST. 3

RECORD :

N88°57'06\" W 5236.44'

0 330 660 990 1320 1650 1980 2310 2640 2000 1500 1000 500 0

EMERALD GAS OPERATING COMPANY
EXHIBIT "E-2": EXISTING ROAD AND ACCESS MAP

Horton Federal CB-7 #1
SWNE, Section 7, T31N-R11W

