

Submit to Appropriate
District Office
State Lease - 6 copies
Fee Lease - 5 copies

State of New Mexico
Energy, Minerals and Natural Resources Department

Form C-101
Revised 1-1-89

OIL CONSERVATION DIVISION

P.O. Box 2088
Santa Fe, New Mexico 87504-2088

DISTRICT I
P.O. Box 1980, Hobbs, NM 88240

DISTRICT II
P.O. Drawer DD, Artesia, NM 88210

DISTRICT III
1000 Rio Brazos Rd., Aztec, NM 87410

API NO. (assigned by OCD on New Wells)

5. Indicate Type of Lease

STATE ☒ FEE ☐

6. State Oil & Gas Lease No.
B-11240-86

APPLICATION FOR PERMIT TO DRILL, DEEPEN, OR PLUG BACK

1a. Type of Work:

DRILL ☒ RE-ENTER ☐ DEEPEN ☐ PLUG BACK ☐

b. Type of Well:

OIL WELL ☐ GAS WELL ☒ OTHER ☐ SINGLE ZONE ☐ MULTIPLE ZONE ☒

2. Name of Operator

Conoco, Inc. 5673

3. Address of Operator

10 Desta Dr. Ste 100W, Midland, TX 79705 72319

4. Well Location

Unit Letter H : 1935 Feet From The North Line and 975 Feet From The East Line

Section 36 Township 31N Range 9W NMPM San Juan County

7. Lease Name or Unit Agreement Name

State Com I

8. Well No.

5R

9. Pool name or Wildcat

Blanco MV / Basin Dakota 71584

10. Proposed Depth
8100'

11. Formation
Mesaverde / Dakota

12. Rotary or C.T.

13. Elevations (Show whether DF, RT, GR, etc.)
6502'

14. Kind & Status Plug Bond

15. Drilling Contractor

16. Approx. Date Work will start

17. PROPOSED CASING AND CEMENT PROGRAM

SIZE OF HOLE	SIZE OF CASING	WEIGHT PER FOOT	SETTING DEPTH	SACKS OF CEMENT	EST. TOP
13-1/2"	10-3/4"	40.5#	225'	250 sxs	surface
9-7/8"	7-5/8"	26.4#	3500"	445 sxs	surface
6-3/4"	5-1/2" F/J	15.5#	7500'	217 sxs	3000'
4-3/4"	3-1/2" F/J	9.3#	8100'	51 sxs	7300'

It is proposed to drill this dual Mesaverde / Dakota well to a depth of 8100' according to the well plan contained in the following attachments:

1. Well Location and Acreage Dedication Plat (C-102)
2. Proposed Well Plan Outline
3. Casing, Cementing, and Mud programs information sheet
4. BOP information sheet
5. BOP / Choke Diagram

This Approval

Expires 2-11-95

And Will Not Be

Extended

RECEIVED

FEB 11 1994

OIL CON. DIV.

IN ABOVE SPACE DESCRIBE PROPOSED PROGRAM: IF PROPOSAL IS TO DEEPEN OR PLUG BACK, GIVE DATA ON PRESENT PRODUCTION AND PROPOSED NEW PRODUCTIVE ZONE. GIVE BLOWOUT PREVENTER PROGRAM, IF ANY.

I hereby certify that the information above is true and complete to the best of my knowledge and belief.

SIGNATURE

Jerry W. Hoover

TITLE Sr. Conservation Coordinator DATE 2/7/94

TYPE OR PRINT NAME

Jerry W. Hoover

(915) 686-6548 TELEPHONE NO.

(This space for State Use)

APPROVED BY

Equal B...

TITLE DEPUTY OIL & GAS INSPECTOR, DIST. #3

DATE FEB 11 1994

CONDITIONS OF APPROVAL, IF ANY:

Hold C-104 For USG

PROPOSED WELL PLAN OUTLINE

EST. GLE = +6502'

EST. KB = +6514'

WELL NAME: **ST. COM. I-5R**

LOCATION: **1935' FNL & 975' FEL, SEC 36 - T31N - R9W, SAN JUAN CO., NEW MEXICO**

TVD IN 1000'	MD	FORMATION TOPS & TYPE	DRILLING PROBLEMS	TYPE OF FORMATION EVALUATION	HOLE SIZE	CASING SIZE DEPTH	FRAC GRAD	FORMATION PRESSURE GRADIENT	MUD WT TYPE	DAYS
0					13-1/2"	10-3/4" 40.5# K-55 ST&C @ 225'		NORMAL	8.4 - 8.8# SPUD MUD	
1					9-7/8"			8.4 - 9.5#	8.4 - 10.0# GEL/WATER	
2			POSSIBLE WATER FLOW							
3		FRLD @ 3078' PCCF @ 3338'	POSSIBLE GAS FLOW POSSIBLE LOST RETURNS		9-7/8"	7-5/8" 26.4# K-55 LT&C @ 3500'		8.4 - 9.5#		
4				GR-DIL-CNL-LDT	6-3/4"			NORMAL	AIR/AIR MIST	
5		CLFH/MV @ 5152' MENF @ 5207 PTLK @ 5512'	PROBABLE LOST RETURNS IF FLUID IN HOLE							
6					6-3/4"	5-1/2" 15.5# K-55 FLUSH JT. @ 7500'				
7				GR-DIL-CNL-LDT	4-3/4"			NORMAL TO UNDERPRESS	AIR/AIR MIST	
8		DKOT @ 7503'	POSSIBLE WATER FLOW POSSIBLE OVERPRESSURE IN DEEP DAKOTAL			3-1/2" 9.3# K-55 FLUSH JT. @ 8100'				
		T.D. @ 8100'								

DATE: JANUARY 1994

Submit to Appropriate
District Office
State Leases - 4 copies
Fee Leases - 3 copies

State of New Mexico
Energy, Minerals and Natural Resources Department

Form C-102
Revised 1-1-89

OIL CONSERVATION DIVISION

DISTRICT I
P.O. Box 1980, Hobbs, NM 88240

P.O. Box 2088

Santa Fe, New Mexico 87504-2088

DISTRICT II
P.O. Drawer DD, Artesia, NM 88210

DISTRICT III
1000 Rio Brazos Rd., Aztec, NM 87410

WELL LOCATION AND ACREAGE DEDICATION PLAT

All Distances must be from the outer boundaries of the section

Operator Conoco			Lease State Com I			Well No. X-5R		
Unit Letter H	Section 36	Township 31 North	Range 9 West	County San Juan				
Actual Footage Location of Well: 1935 feet from the North line and 975 feet from the East line								
Ground level Elev. 6502'		Producing Formation Mesaverde / Dakota			Pool Blanco Mesaverde / Basin Dakota		Dedicated Acreage: W/320/320 Acres	

1. Outline the acreage dedicated to the subject well by colored pencil or hectare marks on the plat below.
2. If more than one lease is dedicated to the well, outline each and identify the ownership thereof (both as to working interest and royalty).
3. If more than one lease of different ownership is dedicated to the well, have the interest of all owners been consolidated by communitization, unitization, force-pooling, etc.?
☐ Yes ☐ No If answer is "yes" type of consolidation _____
If answer is "no" list the owners and tract descriptions which have actually been consolidated. (Use reverse side of this form if necessary).
No allowable will be assigned to the well until all interests have been consolidated (by communitization, unitization, forced-pooling, or otherwise) or until a non-standard unit, eliminating such interest, has been approved by the Division.

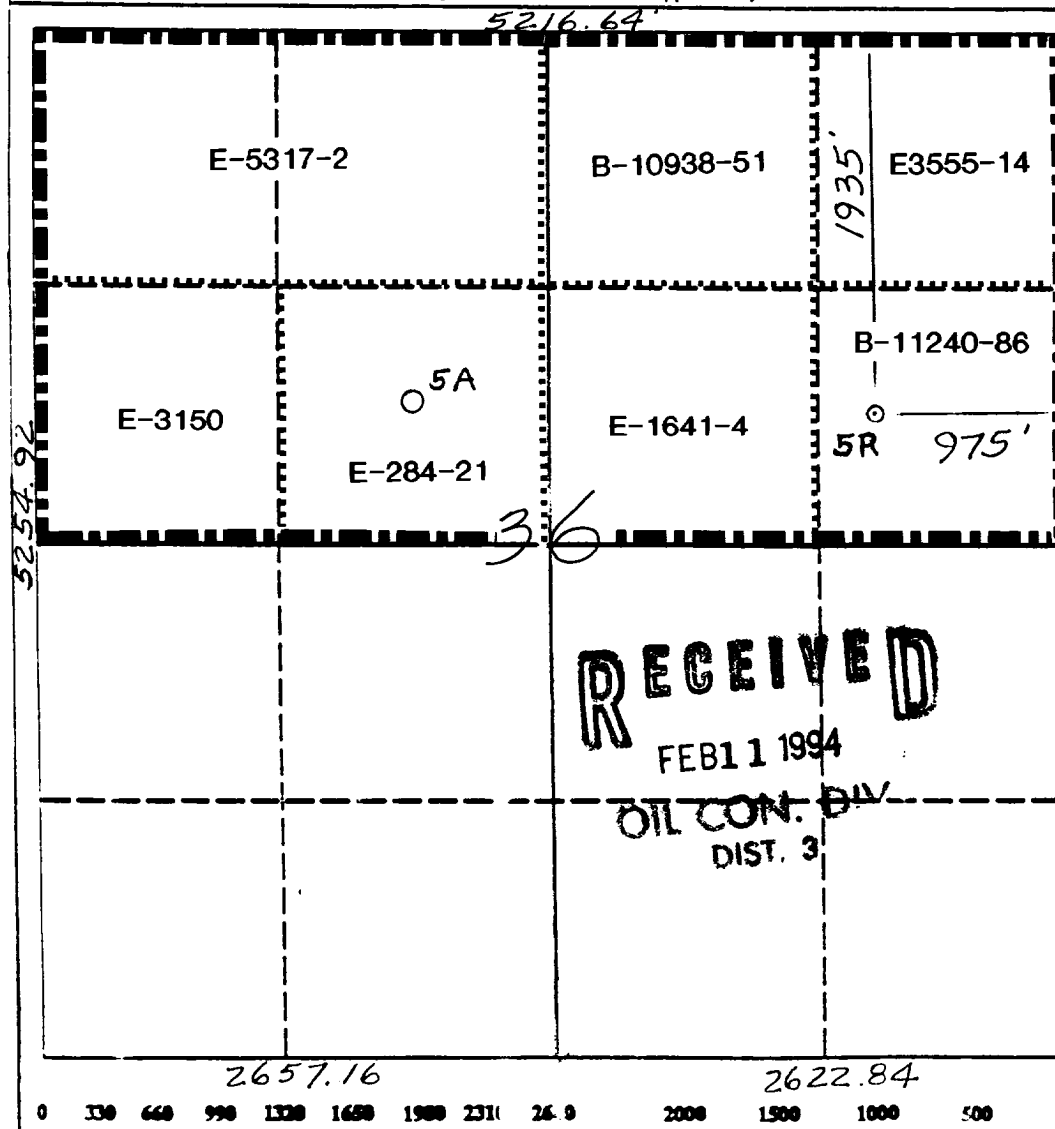

OPERATOR CERTIFICATION
I hereby certify that the information contained herein is true and complete to the best of my knowledge and belief.

Signature
Printed Name
Position
Company
Date

Jerry W. Hoover
Sr. Conservation Coordinator
Conoco Inc.
2/7/94

SURVEYOR CERTIFICATION
I hereby certify that the well location shown on this plat was plotted from field notes of actual surveys made by me or under my supervision, and that the same is true and correct to the best of my knowledge and belief.

Date Surveyed
Signature
Professional Surveyor
Certificate No.

11-1-93
Ned C. Edwards
6857
6857

STATE COM. I-5R
SEC 36, T31N, R9W
SAN JUAN COUNTY, NEW MEXICO

Conoco proposes to drill the I-5R well as a vertical hole to 8100'. The well will be a dual completion and develop gas reserves in the Mesa Verde and Dakota formations. Please see the attached WellPlan Outline for the proposed mud program and estimated formation tops.

The well plan calls for setting 10-3/4" casing at \pm 225'. Next a 9-7/8" hole will be drilled to \pm 3500' and 7-5/8" intermediate casing will be set. A 6-3/4" hole is planned to \pm 7500' where 5-1/2" casing is planned. A 4-3/4" hole is planned to total depth of the well at \pm 8100'. A 3-1/2" liner will be set if required. The surface and bottom hole location and casing and cement program are planned as follows:

Surface & PBHL: 1935' FNL & 975' FEL Sec. 36-31N-9W

CASING AND CEMENTING PROGRAM:

Footage	Casing	Cement
225'	10-3/4" 40.5#, K-55, ST&C	<u>250</u> sxs Cl "G" + 3% CaCl 15.8 ppg, 1.17 cu. ft./sx
3500'	7-5/8" 26.4#, K-55, LT&C	<u>385</u> sxs 35/65 Poz/Cl "G" + 6% Gel + 2% CaCl 12.4 ppg, 1.86 cu. ft./sx <u>60</u> sxs Cl "G" + 2% CaCl 15.8 ppg, 1.16 cu. ft./sx
7500'	5-1/2" 15.5#, K-55, FJ	<u>167</u> sxs 35/65 Poz/Cl "G" + 6% Gel 12.4 ppg, 1.86 cu. ft./sx <u>50</u> sxs Cl "G" + 35% Silica 15.8 ppg, 1.53 cu. ft./sx
7300' - 8100'	3-1/2" 9.3#, K-55, FJ	<u>51</u> sxs Cl "G" + 35% Silica 15.8 ppg, 1.53 cu. ft./sx

MUD PROGRAM

Interval	Mud Weight (lbs/gal)	Viscosity (secs)	Fluid Loss (cc)	Mud Type
0 - 225'	8.4 - 9.4	Native	N/C	Spud Mud
225' - 3500'	8.4 - 9.4	30 - 45	N/C	Gel/Water
3500' - 7500'	N/A	N/A	N/A	Air/Air-mist
7500' - 8100'	N/A	N/A	N/A	Air/Air-mist

The hole interval below 3500' is planned for Air/Air-mist drilling. The hole will be loaded with Gel/Water mud if hole conditions dictate.

No DST's are planned. DIL, LDT, CNL, and Sonic Logs will be run.

BOP INFORMATION

Drilling contractors used in the San Juan Basing supply 3000 psi equipment, but cannot provide annular preventors because of sub-structure limitations. Maximum anticipated surface pressures for this well will not exceed the working pressure of the proposed BOP system. Please see the attached BOP diagram details 2000 psi equipment according to Onshore Order No. 2 even though the equipment will test to 3000 psi. The 2000 psi system allows deletion of the annular preventor and fulfills your requirements (note diagram No. 1). In addition, the following equipment will comprise the 2000 psi system:

1. Two rams with one blind and one pipe ram.
2. Kill line (2 inch maximum).
3. One kill line valve.
4. One choke line valve.
5. Two chokes (reference diagram No. 1).
6. Upper kelly cock valve with handle.
7. Safety valve and subs to fit all drill strings in use.
8. Two-inch minimum choke line.
9. Pressure gauge on choke manifold.
10. Fill-up line above the upper most preventor.
11. Rotating head.

Please direct any questions to: Billy Goodwin - (915) 686-6154 in Conoco's Midland Office.

ISRPER

DIAGRAM 1

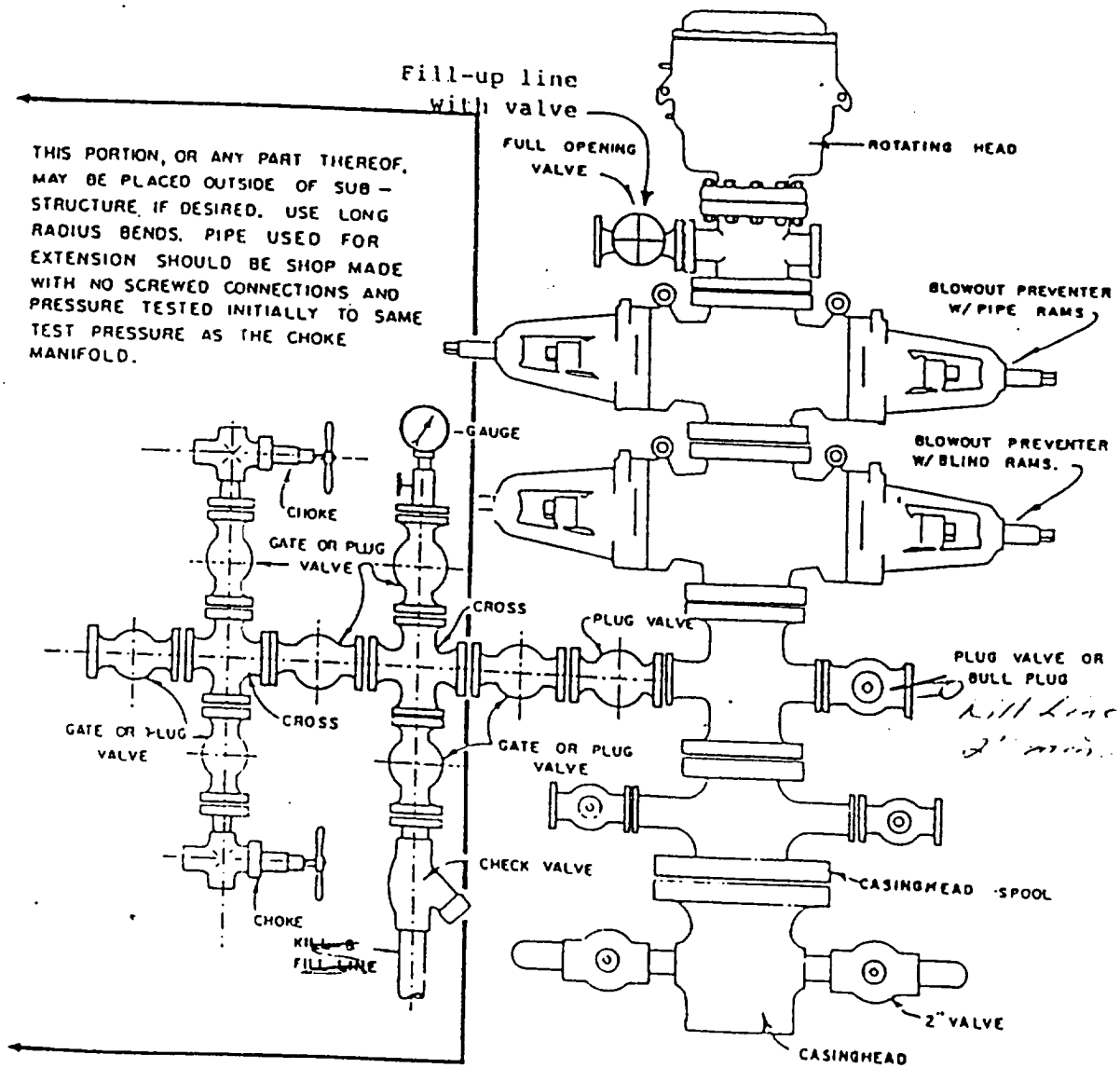

BLOWOUT PREVENTER HOOKUP