

UNITED STATES
DEPARTMENT OF THE INTERIOR
BUREAU OF LAND MANAGEMENT

APPLICATION FOR PERMIT TO DRILL OR DEEPEN

1a. TYPE OF WORK

DRILL ☒DEEPEN ☐

b. TYPE OF WELL

OIL
WELL ☐GAS
WELL ☒

OTHER

SINGLE
ZONE ☐MULTIPLE
ZONE ☐

2. NAME OF OPERATOR

Harken Southwest Corporation 138594

3. ADDRESS AND TELEPHONE NO.

P. O. Drawer 612007 Dallas, TX 75261 214-753-6700 (817) 695-4900

4. LOCATION OF WELL (Report location clearly and in accordance with any State requirements.)*

At surface

1548' FNL & 800' FEL

At proposed prod. zone

14. DISTANCE IN MILES AND DIRECTION FROM NEAREST TOWN OR POST OFFICE*

+/-7 miles north/northwest of Shiprock, NM

15. DISTANCE FROM PROPOSED*

LOCATION TO NEAREST
PROPERTY OR LEASE LINE, FT.
(Also to nearest drlg. unit line, if any)

800'

16. NO. OF ACRES IN LEASE

2400

18. DISTANCE FROM PROPOSED LOCATION*
TO NEAREST WELL, DRILLING, COMPLETED,
OR APPLIED FOR, ON THIS LEASE, FT.

19. PROPOSED DEPTH

+/-8525

21. ELEVATIONS (Show whether DF, RT, GR, etc.)

5068' GR/5081' KB

This action is subject to technical and
procedural review pursuant to 43 CFR 3165.3
and appeal pursuant to 43 CFR 3166.4.

17. NO. OF ACRES ASSIGNED
TO THIS WELL

160

20. ROTARY OR CABLE TOOLS

Rotary

22. APPROX. DATE WORK WILL START*

October 94'

23. PROPOSED CASING AND CEMENTING PROGRAM

SIZE OF HOLE	GRADE SIZE OF CASING	WEIGHT PER FOOT	SETTING DEPTH
17-1/2"	13-3/8"-H40	48#	160'-320'
8-3/4"	4-1/2"-J55	10.5#	0-8525'

DRILLING OPERATIONS AUTHORIZED ARE
SUBJECT TO COMPLIANCE WITH ATTACHED

"GENERAL REQUIREMENTS"

190 sx "G" Surface
Stage Cm per Ten Point Plan
Total 2235 sx "G"

Attached:

Surface Use Plan
Ten Point Drilling Plan
Detailed Drilling Plan
H2S Contingency Plan
Attachments as described in planRECEIVED
APR - 4 1995OIL CON. DIV.
BLM 3cc: Navajo Nation - Attn: Aktar
State of New MexicoRECEIVED
BLM
94 JUL 22 AM 10:42
070 FARMINGTON, NM

IN ABOVE SPACE DESCRIBE PROPOSED PROGRAM: If proposal is to deepen, give data on present productive zone and proposed new productive zone. If proposal is to drill or deepen directionally, give pertinent data on subsurface locations and measured and true vertical depths. Give blowout preventer program, if any.

SIGNATURE

TITLE Production Administrator

DATE 7/19/94

(This space for Federal or State office use)

PERMIT NO.

APPROVAL DATE

Application approval does not warrant or certify that the applicant holds legal or equitable title to those rights in the subject lease which would entitle the applicant to conduct operations thereon.
CONDITIONS OF APPROVAL, IF ANY:

APPROVED BY

DATE

*See Instructions On Reverse Side

OIL CONSERVATION DIVISION

P.O. Box 2088

Santa Fe, New Mexico 87504-2088

RECEIVED
BLM

94 JUL 22 AM 10:42

070 FARMINGTON, NM

WELL LOCATION AND ACREAGE DEDICATION PLAT

All Distances must be from the outer boundaries of the section

DISTRICT III
1000 Rio Brazos Rd., Aztec, NM 87410

Operator CHUGA ENERGY COMPANY 138594		Lease 16942		NO. CHIMNEY ROCK #21-H-1	
Unit Letter H	Section 21	Township 31 N.	Range 18 W.	County SAN JUAN	
Actual Footage Location of Well: 1548		NORTH		800 EAST	
feet from the		line and		feet from the	
Ground level Elev. 5068'	Producing Formation PARADOX	Pool WILDCAT 3!!! 18W 21H - PARADOX		Dedicated Acreage: 160 Acres	

1. Outline the acreage dedicated to the subject well by colored pencil or hatchure marks on the plat below.

2. If more than one lease is dedicated to the well, outline each and identify the ownership thereof (both as to working interest and royalty).

3. If more than one lease of different ownership is dedicated to the well, have the interest of all owners been consolidated by communitization, unitization, force-pooling, etc.?

☐ Yes ☐ No If answer is "yes" type of consolidation

If answer is "no" list the owners and tract descriptions which have actually been consolidated. (Use reverse side of this form if necessary.)

No allowable will be assigned to the well until all interests have been consolidated (by communitization, unitization, force-pooling, or otherwise) or until a non-standard unit, eliminating such interest, has been approved by the Division.

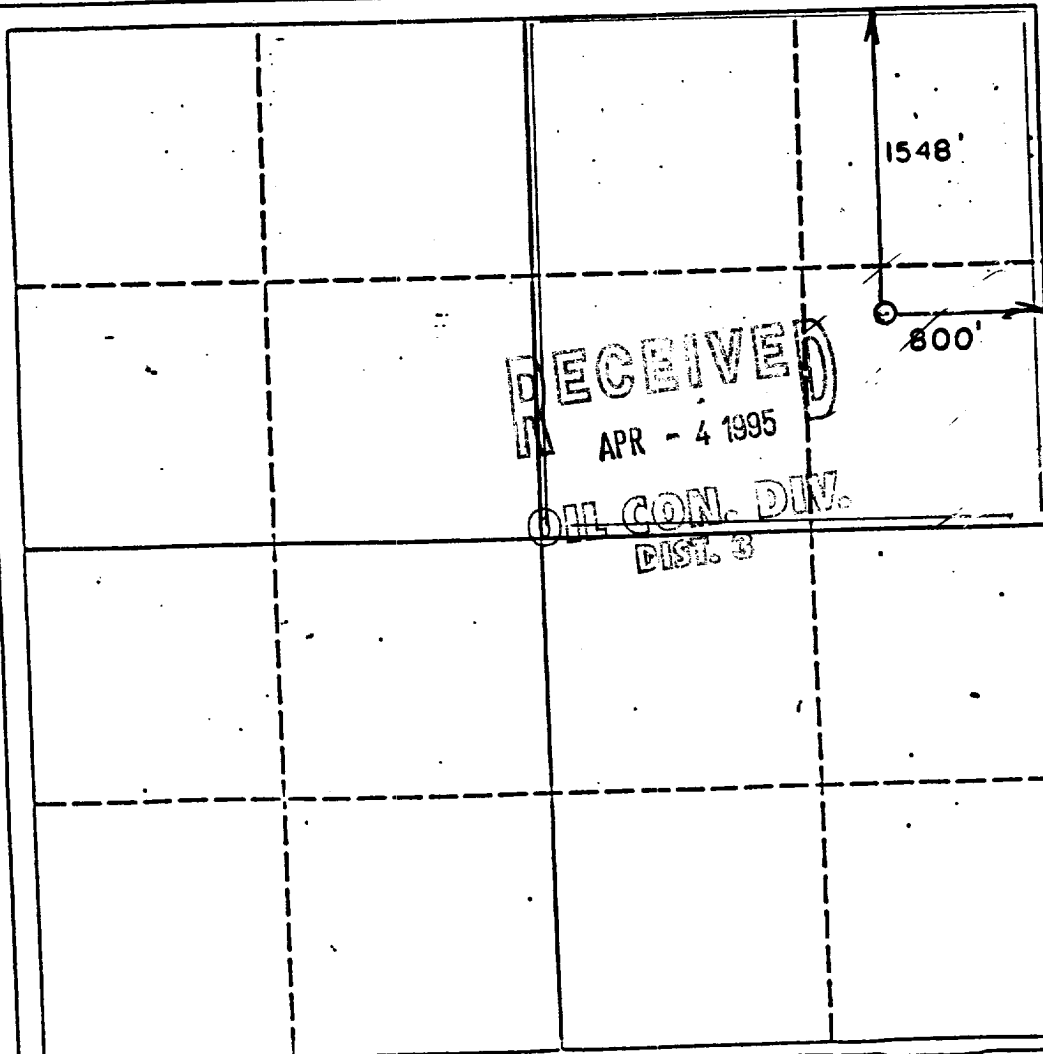

RECEIVED
APR - 4 1995
OIL CON. DIV.
DIST. 3

OPERATOR CERTIFICATION

I hereby certify that the information contained herein is true and complete to the best of my knowledge and belief.

Signature: *Rachel Montgomery*

Printed Name: Rachel Montgomery

Production Administrator

Position

Company: Harken Southwest Corp.

Date

7/21/94

Date

SURVEYOR CERTIFICATION

I hereby certify that the well location shown on this plat was plotted from field notes of actual surveys made by me or under my supervision, and that the same is true and correct to the best of my knowledge and belief.

Date Surveyed

Signature of Professional Surveyor

Certificate No.

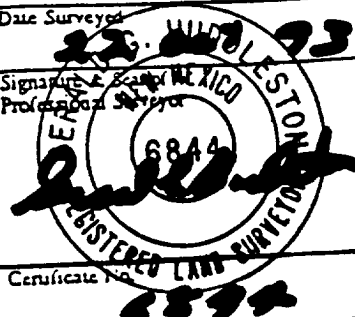

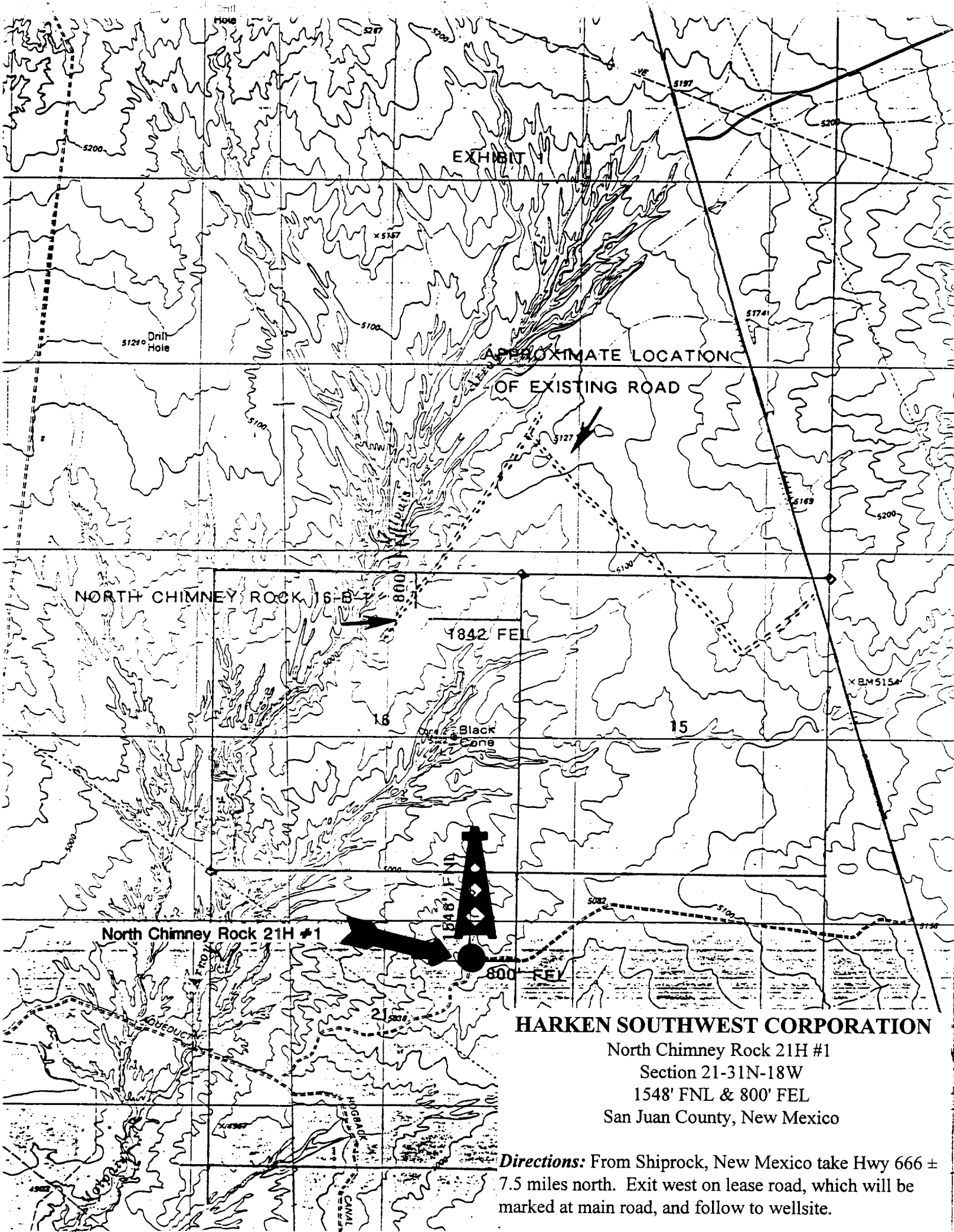

HARKEN SOUTHWEST CORPORATION

North Chimney Rock 21H #1

Section 21-31N-18W

1548' FNL & 800' FEL

San Juan County, New Mexico

Directions: From Shiprock, New Mexico take Hwy 666 ± 7.5 miles north. Exit west on lease road, which will be marked at main road, and follow to wellsite.