

UNITED STATES  
DEPARTMENT OF THE INTERIOR  
BUREAU OF LAND MANAGEMENT

## APPLICATION FOR PERMIT TO DRILL OR DEEPEN

## 1a. TYPE OF WORK

DRILL ☒DEEPEN ☐

## b. TYPE OF WELL

OIL  
WELL ☐GAS  
WELL ☒

OTHER

SINGLE  
ZONE ☒MULTIPLE  
ZONE ☐

## 2. NAME OF OPERATOR

Marathon Oil Company (915) 682-1626

## 3. ADDRESS AND TELEPHONE NO.

P. O. Box 552, Midland, Tx. 79702-0552

## 4. LOCATION OF WELL (Report location clearly and in accordance with any State requirements.)\*

At surface

2185' FSL &amp; 660' FWL

At proposed prod. zone

Same

## 14. DISTANCE IN MILES AND DIRECTION FROM NEAREST TOWN OR POST OFFICE\*

4 air miles ESE of LaPlata, NM

## 15. DISTANCE FROM PROPOSED\*

LOCATION TO NEAREST  
PROPERTY OR LEASE LINE, FT.  
(Also to nearest drig. unit line, if any)

801'

## 16. NO. OF ACRES IN LEASE

480

## 18. DISTANCE FROM PROPOSED LOCATION\*

TO NEAREST WELL, DRILLING, COMPLETED,  
OR APPLIED FOR, ON THIS LEASE, FT.

628'

## 19. PROPOSED DEPTH

5,500'

17. NO. OF ACRES ASSIGNED  
TO THIS WELL

w/ 320

## 20. ROTARY OR CABLE TOOLS

Rotary

## 21. ELEVATIONS (Show whether DF, RT, GR, etc.)

5,928' ungraded ground

## 22. APPROX. DATE WORK WILL START\*

Feb. 25, 2000

## 23.

## PROPOSED CASING AND CEMENTING PROGRAM

SIZE OF HOLE	GRADE, SIZE OF CASING	WEIGHT PER FOOT	SETTING DEPTH	QUANTITY OF CEMENT
12-1/4"	8-5/8" (J-55)	24#	350'	≈289 cu ft & to surface
7-7/8"	4-1/2" (J-55)	11.6#	5,500'	≈1829 cu ft & to surface

On sited with Danny Randall.

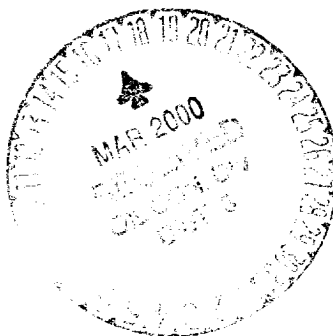
This action is subject to technical and  
procedural review pursuant to 43 CFR 3160.3  
and appeal pursuant to 43 CFR 3160.4.BUREAU OF LAND MANAGEMENT  
GENERAL INSTRUCTIONS  
FOR THE APPLICANT

IN ABOVE SPACE DESCRIBE PROPOSED PROGRAM: If proposal is to deepen, give data on present productive zone and proposed new productive zone. If proposal is to drill or deepen directionally, give pertinent data on subsurface locations and measured and true vertical depths. Give blowout preventer program, if any.

## 24.

SIGNED

TITLE

Consultant (505) 466-8120

DATE

1-22-00

(This space for Federal or State office use)

PERMIT NO.

APPROVAL DATE

Application approval does not warrant or certify that the applicant holds legal or equitable title to those rights in the subject lease which would entitle the applicant to conduct operations thereon.

CONDITIONS OF APPROVAL, IF ANY:

APPROVED BY

/s/ Charlie Beecham

TITLE

DATE

MAR 15 2000

\*See Instructions On Reverse Side

District I  
PO Box 1980, Hobbs, NM 88241-1980  
District II  
PO Drawer DD, Artesia, NM 88211-0719  
District III  
1000 Rio Bravo Rd., Aztec, NM 87410  
District IV  
PO Box 2088, Santa Fe, NM 87504-2088

State of New Mexico  
Energy, Minerals & Natural Resources Department

OIL CONSERVATION DIVISION  
PO Box 2088  
Santa Fe, NM 87504-2088

Form C-102  
Revised February 21, 1994  
Instructions on back  
Submit to Appropriate District Office  
State Lease - 4 Copies  
Fee Lease - 3 Copies

☐ AMENDED REPORT

WELL LOCATION AND ACREAGE DEDICATION PLAT

APN Number 30-045-30122	Pool Code 72319	Pool Name BLANCO - MESA VERDE
Property Code 25519	Property Name OHIO "D"	Well Number 1-C
OCID No. 14021	Operator Name MARATHON OIL COMPANY	Elevation 5928

10 Surface Location

UL or lot no.	Section	Township	Range	Lot Idn	Feet from the	North/South line	Feet from the	East/West line	County
L	8	31 N	12 W		2185	South	660	West	San Juan

11 Bottom Hole Location If Different From Surface

UL or lot no.	Section	Township	Range	Lot Idn	Feet from the	North/South line	Feet from the	East/West line	County

12 Dedicated Acres	13 Joint or Infill	14 Consolidation Code	15 Order No.
--------------------	--------------------	-----------------------	--------------

NO ALLOWABLE WILL BE ASSIGNED TO THIS COMPLETION UNTIL ALL INTERESTS HAVE BEEN CONSOLIDATED  
OR A NON-STANDARD UNIT HAS BEEN APPROVED BY THE DIVISION

<p>Sec. 8</p>	<b>17 OPERATOR CERTIFICATION</b> I hereby certify that the information contained herein is true and complete to the best of my knowledge and belief.  Signature: <i>Brian Wood</i> Printed Name: BRIAN WOOD Title: CONSULTANT Date: JAN. 22, 2000
	<b>18 SURVEYOR CERTIFICATION</b> I hereby certify that the well location shown on this plat was plotted from field notes of actual surveys made by me or under my supervision, and that the same is true and correct to the best of my belief.  Date of Survey: MAY 1999 Signature: <i>William E. Burke II</i> Professional Land Surveyor #8466 Certificate Number: 8466

Marathon Oil Company  
Ohio D 1 C  
2185' FSL & 660' FWL  
Sec. 8, T. 31 N., R. 12 W.  
San Juan County, New Mexico

PAGE 3

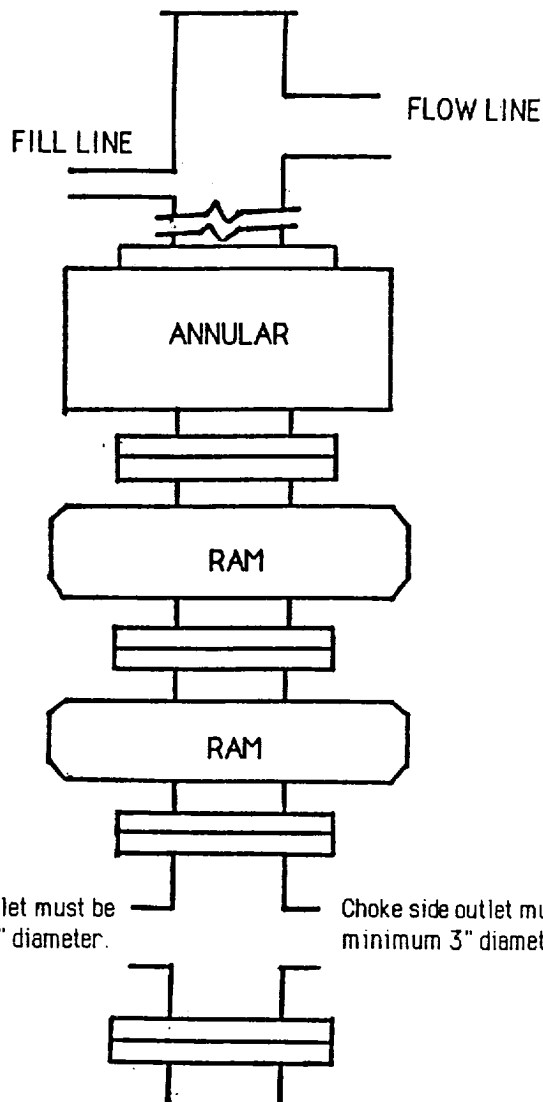

TYPICAL BOP STACK  
& CHOKE MANIFOLD

There will be at least 2 chokes and 2 choke line valves (3" minimum). The choke line will be 3" in diameter. There will be a pressure gauge on the choke manifold.

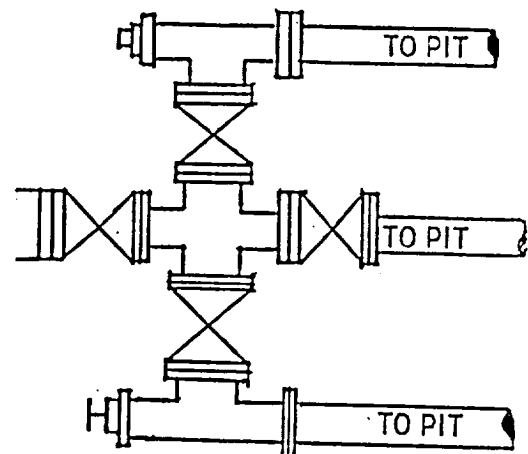

Kill line will be minimum 2" diameter and have 2 valves, one of which shall be a minimum 2" check valve.

Upper kelly cock will have handle available.  
Safety valve and subs will fit all drill string connections in use.  
All BOPE connections subjected to well pressure will be flanged, welded, or clamped.

Marathon Oil Company  
Ohio D 1 C  
2185' FSL & 660' FWL  
Sec. 8, T. 31 N., R. 12 W.  
San Juan County, New Mexico

PAGE 11

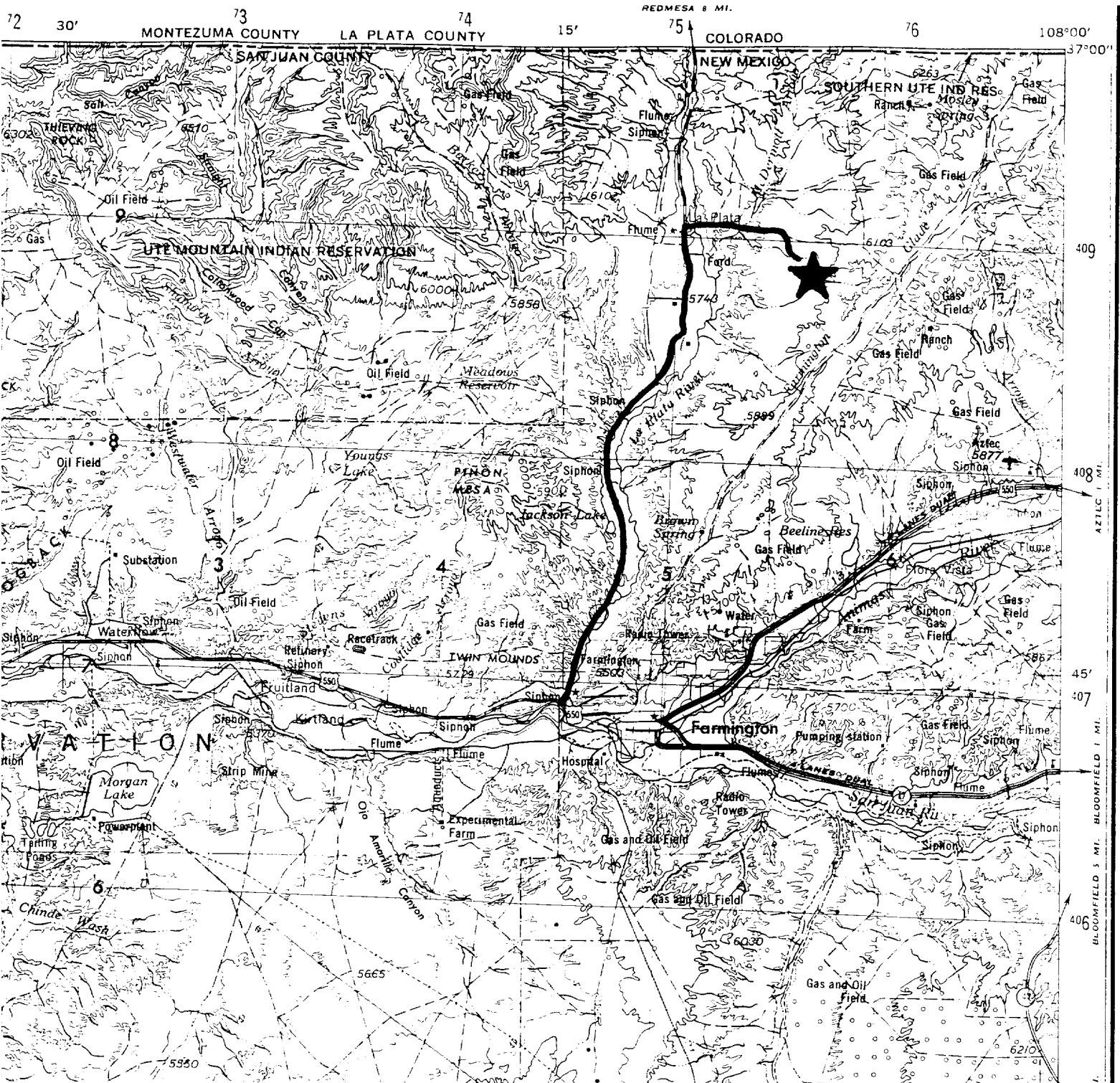

PROPOSED WELL: ★

ACCESS ROUTE: ~

**PERMITS WEST** INC.  
PROVIDING PERMITS FOR LAND USERS