

(SUBMIT IN TRIPLICATE)

UNITED STATES
DEPARTMENT OF THE INTERIOR
GEOLOGICAL SURVEY

Indian Agency _____

Allottee _____

Lease No. _____

NAVAJO TRIBAL 14-20-603-586

SUNDRY NOTICES AND REPORTS ON WELLS

NOTICE OF INTENTION TO DRILL	<input checked="" type="checkbox"/>	SUBSEQUENT REPORT OF WATER SHUT-OFF	
NOTICE OF INTENTION TO CHANGE PLANS		SUBSEQUENT REPORT OF SHOOTING OR ACIDIZING	
NOTICE OF INTENTION TO TEST WATER SHUT-OFF		SUBSEQUENT REPORT OF ALTERING CASING	
NOTICE OF INTENTION TO REDRILL OR REPAIR WELL		SUBSEQUENT REPORT OF REDRILLING OR REPAIR	
NOTICE OF INTENTION TO SHOOT OR ACIDIZE		SUBSEQUENT REPORT OF ABANDONMENT	
NOTICE OF INTENTION TO PULL OR ALTER CASING		SUPPLEMENTARY WELL HISTORY	
NOTICE OF INTENTION TO ABANDON WELL			

(INDICATE ABOVE BY CHECK MARK NATURE OF REPORT, NOTICE, OR OTHER DATA)

SEPTEMBER 13, 1963

HORSESHOE
Well No. 1 is located 330 ft. from S line and 660 ft. from E line of sec. 32
SE SE 32 32N 17W NMP
(1/4 Sec. and Sec. No.) (Twp.) (Range) (Meridian)
HORSESHOE CANYON SAN JUAN NEW MEXICO
(Field) (County or Subdivision) (State or Territory)

The elevation of the derrick floor above sea level is 5338 ft.

DETAILS OF WORK

(State names of and expected depths to objective sands; show sizes, weights, and lengths of proposed casings; indicate mudding jobs, cementing points, and all other important proposed work)

Objective horizon: Gallup sandstone (Horseshoe) at approximately 1120'.
Anticipated TD: 1175' in Carlile shale.

Will drill 9-5/8" surface hole and set 1 joint (approx. 30') surface casing and cement to surface.

Plan to run ¹¹⁷⁰ 1200' of 4-1/2" casing in the 6-3/4" hole and cement with 25 sx regular and sand-oil frac with 33,600 gals. crude and 20,000 lbs. sand.

I understand that this plan of work must receive approval in writing by the Geological Survey before operations may be commenced.

Company CURTIS J. LITTLE

Address 2929 MONTE VISTA, NE

ALBUQUERQUE, NEW MEXICO

By Curtis J. Little

Title OPERATOR

NEW MEXICO OIL CONSERVATION COMMISSION

Well Location and Acreage Dedication Plat

SECTION A.

Date September 16, 1963

Operator Curtis J. Little Lease Horseshoe
 Well No. 1 Unit Letter P Section 32 Township 32 North Range 17 West NMPM
 Located 330 Feet From South Line, 660 Feet From East Line
 County San Juan G. L. Elevation 5338 Dedicated Acreage 40 Acres
 Name of Producing Formation Gallup Pool Horseshoe Gallup

1. Is the Operator the only owner* in the dedicated acreage outlined on the plat below? Yes XXX No _____
2. If the answer to question One is "No," have the interests of all the owners been consolidated by communization agreement or otherwise? Yes _____ No _____ If answer is "Yes," Type of Consolidation _____
3. If the answer to question Two is "No," list all the owners and their respective interests below:

OWNER

LAND DESCRIPTION

SECTION B.

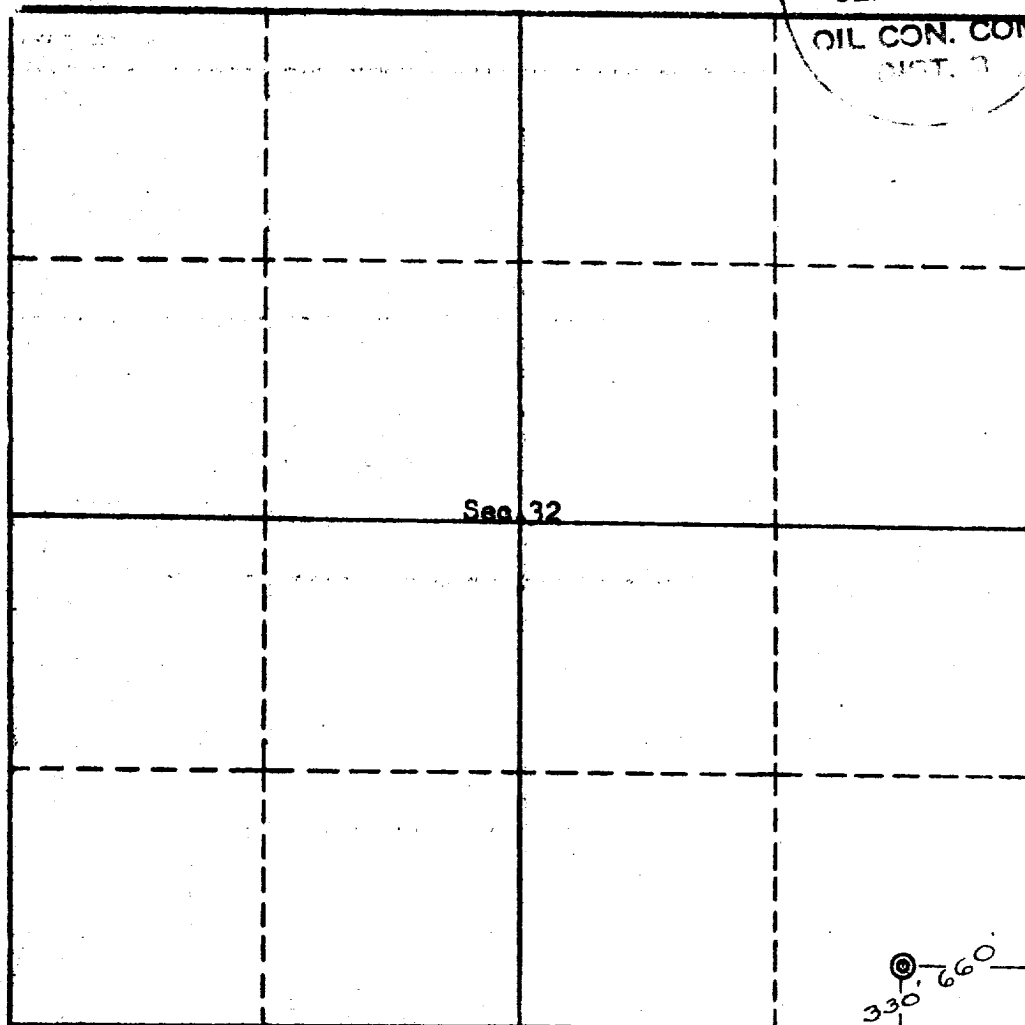

RECEIVED

SEP 16 1963

OIL CON. COM.
DIST. 7

This is to certify that the information in Section A above is true and complete to the best of my knowledge and belief.

Curtis J. Little

(OPERATOR)

(REPRESENTATIVE)

2929 Monte Vista NE

(ADDRESS)

Albuquerque, New Mexico.

This is to certify that the well location shown on the plat in Section B was plotted from field notes of actual surveys made by me or under my supervision and that the same is true and correct to the best of my knowledge and belief.

ST. JOHN'S ENGINEERING CO.
 REGISTERED ENGINEER OR
 LAND SURVEYOR
 Date Surveyed Sept. 4, 1963
 Four States Engineering Co.
 FARMINGTON, NEW MEXICO

REGISTERED ENGINEER OR
LAND SURVEYORCertificate No. 3602