

STATE OF NEW MEXICO
OIL CONSERVATION
COMMISSION

DISTRICT NO. 3
Phone 99 P. O. Box 697
AZTEC, NEW MEXICO

(SUBMIT IN TRIPLICATE)

UNITED STATES
DEPARTMENT OF THE INTERIOR
GEOLOGICAL SURVEY

Land Office Santa Fe
Lease No. 1-149-Ind.-7890
Unit Navajo Indian Tribal Lands

SUNDRY NOTICES AND REPORTS ON WELLS

NOTICE OF INTENTION TO DRILL	<input checked="" type="checkbox"/>	SUBSEQUENT REPORT OF WATER SHUT-OFF	
NOTICE OF INTENTION TO CHANGE PLANS		SUBSEQUENT REPORT OF SHOOTING OR ACIDIZING	
NOTICE OF INTENTION TO TEST WATER SHUT-OFF		SUBSEQUENT REPORT OF ALTERING CASING	
NOTICE OF INTENTION TO RE-DRILL OR REPAIR WELL		SUBSEQUENT REPORT OF REDRILLING OR REPAIR	
NOTICE OF INTENTION TO SHOOT OR ACIDIZE		SUBSEQUENT REPORT OF ABANDONMENT	
NOTICE OF INTENTION TO PULL OR ALTER CASING		SUPPLEMENTARY WELL HISTORY	
NOTICE OF INTENTION TO ABANDON WELL			

(INDICATE ABOVE BY CHECK MARK NATURE OF REPORT, NOTICE, OR OTHER DATA)

November 26, 1952, 19

Well No. 1 is located 660 ft. from S line and 660 ft. from W line of sec. 36
W 1/4 Sec. 36 32 North 18 East N.M.P.M.
 (1/4 Sec. and Sec. No.) (Twp.) (Range) (Meridian)
Wildcat San Juan County New Mexico
 (Field) (County or Subdivision) (State or Territory)

The elevation of the derrick floor above sea level is _____ ft. - To be furnished

DETAILS OF WORK

(State names of and expected depths to objective sands; show sizes, weights, and lengths of proposed casings; indicate mudding jobs, cementing points, and all other important proposed work)

• propose to drill a well using rotary tools to thoroughly test the Permian section of the Pennsylvanian formation, or not less than 2500 feet.

following is the proposed casing program:

150' of 13-3/8" casing cemented to surface
 2000' of 9-5/8" casing cemented with 500 sacks
 8000' of 5-1/2" casing cemented with 500 sacks

I understand that this plan of work must receive approval in writing by the Geological Survey before operations may be commenced.

Company SOUTHERN UNION GAS COMPANY

Address Surt Building

Dallas, Texas

By Van Johnson

Title Manager Exploration Dept.

Company Southern Union Gas Company

Lease Texas Co.- Navajo Well No. 1-A

Sec. 36, T. 32 N., R. 18 W., N.M.P.M.

Location 660' from the South line and 660' from the West line.

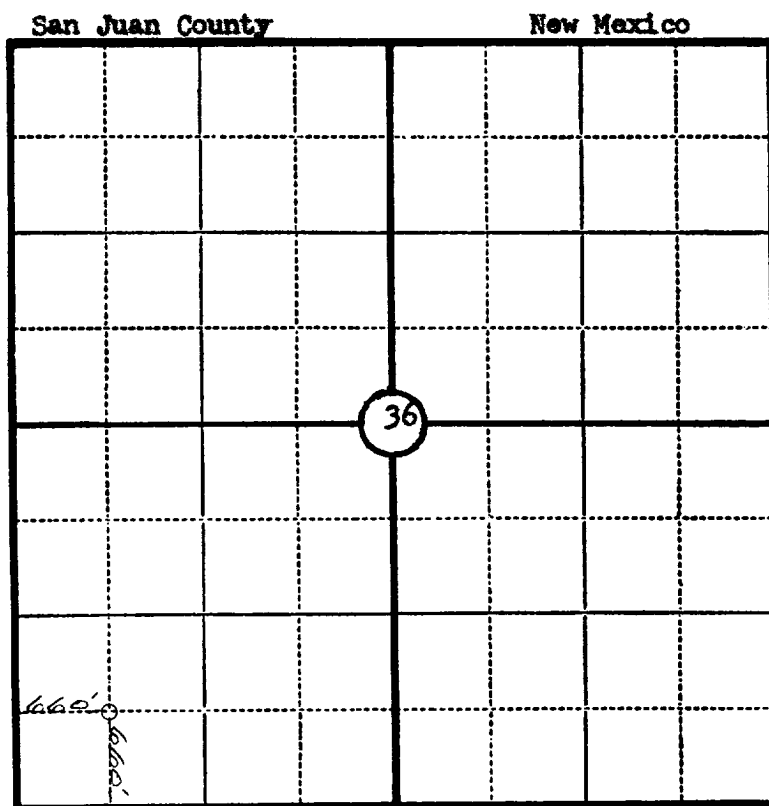

Scale—4 inches equal 1 mile.

This is to certify that the above plat was prepared from field notes of actual surveys made by me or under my supervision and that the same are true and correct to the best of my knowledge and belief.

Charles J. Finklea

Seal:

Registered Professional
Engineer and Land Surveyor.

Charles J. Finklea
N. Mex. Reg. No. 1302

Surveyed November 20, 19 52