

UNITED STATES
DEPARTMENT OF THE INTERIOR
GEOLOGICAL SURVEY

APPLICATION FOR PERMIT TO DRILL, DEEPEN, OR PLUG BACK

1a. TYPE OF WORK

DRILL ☒DEEPEN ☐PLUG BACK ☐

b. TYPE OF WELL

OIL
WELL ☒GAS
WELL ☐OTHER ☐SINGLE
ZONE ☐MULTIPLE
ZONE ☐

2. NAME OF OPERATOR

Howard L. Kennedy, John F. Mitchell, La Plata Drilling Corp.

3. ADDRESS OF OPERATOR

P. O. Box 3348 - Durango, Colorado 81302

4. LOCATION OF WELL (Report location clearly and in accordance with any State requirements.)*

At surface

1980' FSL x 660' FWL

At proposed prod. zone approx. same

14. DISTANCE IN MILES AND DIRECTION FROM NEAREST TOWN OR POST OFFICE*

10 miles north of Shiprock, New Mexico

15. DISTANCE FROM PROPOSED*

LOCATION TO NEAREST
PROPERTY OR LEASE LINE, FT.

(Also to nearest drig. unit line, if any)

660'

16. NO. OF ACRES IN LEASE

2240

17. NO. OF ACRES ASSIGNED
TO THIS WELL

40

18. DISTANCE FROM PROPOSED LOCATION* TO NEAREST WELL, DRILLING, COMPLETION, OR APPLIED FOR, ON THIS LEASE, FT.

Gallup well
in NWNE Sec. 31

19. PROPOSED DEPTH

1200' (Gallup)

20. ROTARY OR CABLE TOOLS

Rotary

21. ELEVATIONS (Show whether DF, RT, GR, etc.)

5404' Ground

22. APPROX. DATE WORK WILL START*

July 19, 1965

23. PROPOSED CASING AND CEMENTING PROGRAM

SIZE OF HOLE	SIZE OF CASING	WEIGHT PER FOOT	SETTING DEPTH	QUANTITY OF CEMENT

It is intended to drill this well in the following manner: Drill a 9" hole to 30' and cement 7" casing to surface with 6 sacks. Drill 6-1/2" hole to total depth. If commercial production is encountered, set 4-1/2" production casing with cement and fluid frac with chemicals. Put well on production.

RECEIVED

JUL 16 1965

U. S. GEOLOGICAL SURVEY
FARMINGTON, N. M.

RECEIVED

JUL 19 1965

OIL CON. COM.
DIST. 3

IN ABOVE SPACE DESCRIBE PROPOSED PROGRAM: If proposal is to deepen or plug back, give data on present productive zone and proposed new productive zone. If proposal is to drill or deepen directionally, give pertinent data on subsurface locations and measured and true vertical depths. Give blowout preventer program, if any.

24.

SIGNED

John F. Mitchell

TITLE

Operator

DATE

7-15-65

(This space for Federal or State office use)

PERMIT NO.

APPROVAL DATE

APPROVED BY

TITLE

DATE

CONDITIONS OF APPROVAL, IF ANY:

*See Instructions On Reverse Side

Instructions

General: This form is designed for submitting proposals to perform certain well operations, as indicated, on all types of lands and leases for appropriate action by either a Federal or a State agency, or both, pursuant to applicable Federal and/or State laws and regulations. Any necessary special instructions concerning the use of this form and the number of copies to be submitted, particularly with regard to local, area, or regional procedures and practices, either are shown below or will be issued by, or may be obtained from, the local Federal and/or State office.

Item 1: If the proposal is to redrill to the same reservoir at a different subsurface location or to a new reservoir, use this form with appropriate notations. Consult applicable State or Federal regulations concerning subsequent work proposals or reports on the well.

Item 4: If there are no applicable State requirements, locations on Federal or Indian land should be described in accordance with Federal requirements. Consult local State or Federal office for specific instructions.

Item 14: Needed only when location of well cannot readily be found by road from the land or lease description. A plat, or plats, separate or on this reverse side, showing the roads to, and the surveyed location of, the well, and any other required information, should be furnished when required by Federal or State agency offices.

Items 15 and 18: If well is to be, or has been directionally drilled, give distances for subsurface location of hole in any present or objective production zone.

Item 22: Consult applicable Federal or State regulations, or appropriate officials, concerning approval of the proposal before operations are started.

NEW MEXICO OIL CONSERVATION COMMISSION

Well Location and Acreage Dedication Plat

Date **July 15, 1965**

Section **A** **Howard L. Kennedy, John F. Mitchell &**

Navajo #14-20-603-586

Operator **La Plata Drilling Corp.** Lease _____
Well No. **1** Unit Letter **L** Section **32** Township **32 North** Range **17 West** NMPM
Located **1980** Feet From **South** Line, **660** Feet From **West** Line
County **San Juan** G. L. Elevation **5404** Dedicated Acreage _____ Acres
Name of Producing Formation **Gallup** Pool **Wildest**

1. Is the Operator the only owner* in the dedicated acreage outlined on the plat below?
Yes ☒ No _____
2. If the answer to question one is "no," have the interests of all the owners been consolidated by communitization agreement or otherwise? Yes _____ No _____. If answer is "yes," Type of Consolidation _____
3. If the answer to question two is "no," list all the owners and their respective interests below:

Owner

Land Description

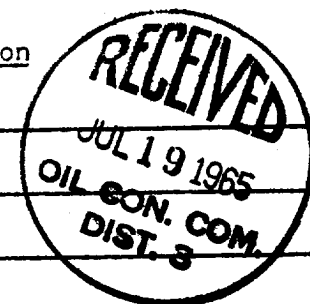

Section B

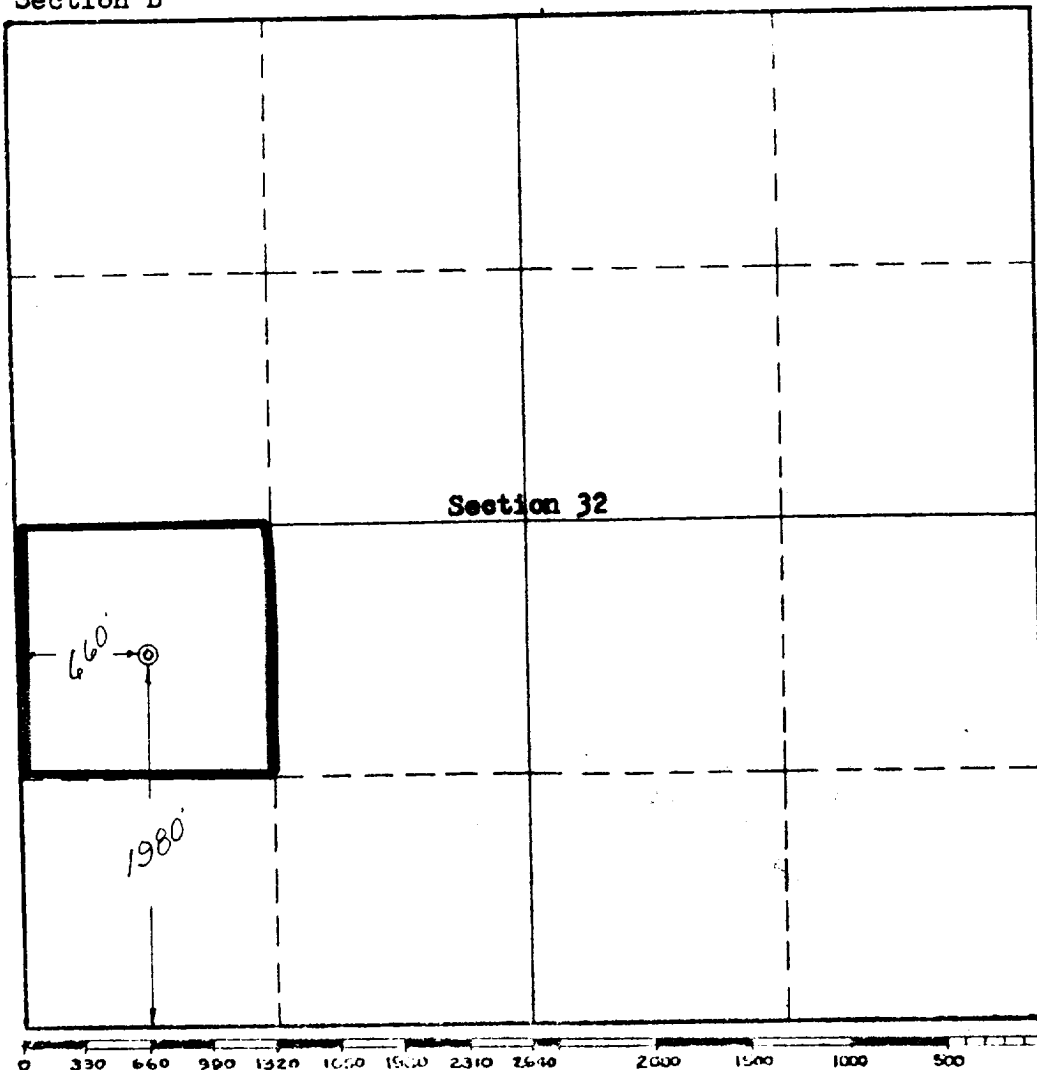

This is to certify that the information in Section A above is true and complete to the best of my knowledge and belief.

John F. Mitchell
(Operator)

John F. Mitchell, et al
(Representative)
P. O. Box 3348
Durango, Colorado 81302
Address

This is to certify that the well location shown on the plat in Section B was plotted from field notes of actual surveys made by me or under my supervision and that the same is true and correct to the best of my knowledge and belief.

Date Surveyed **July 15, 1965**
C. L. Poter
Registered Professional
Engineer and Land Surveyor
3084
STATE OF NEW MEXICO
Certificate No. _____