

NEW MEXICO OIL CONSERVATION COMMISSION.

Well Location and Acreage Dedication Plat

Section A.

Date May 13, 1960

Operator Astec Oil & Gas Company Lease Culpepper-Martin
Well No. 14 Unit Letter A Section 32 Township 32N Range 12W NMPM
Located 990 Feet From North Line, 990 Feet From East Line
County San Juan G. L. Elevation 5921 Dedicated Acreage 320 Acres
Name of Producing Formation Mesa Verde Pool Blanco

1. Is the Operator the only owner* in the dedicated acreage outlined on the plat below?
Yes XX No _____.
2. If the answer to question one is "no," have the interests of all the owners been consolidated by communitization agreement or otherwise? Yes _____ No _____. If answer is "yes,"
Type of Consolidation _____
3. If the answer to question two is "no," list all the owners and their respective interests below:

Owner

Land Description



Section. B

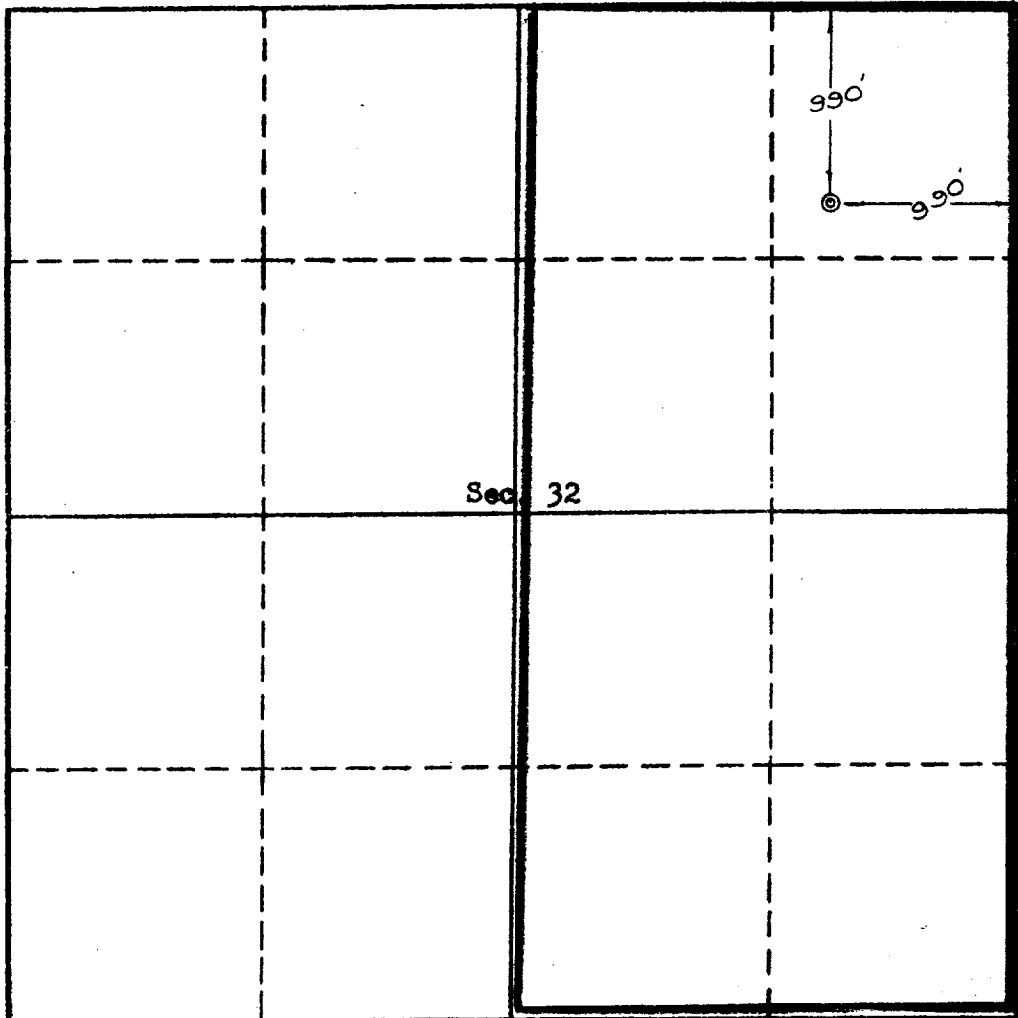

This is to certify that the information in Section A above is true and complete to the best of my knowledge and belief.

Astec Oil & Gas Company
(Operator)

Box 786, Farmington, N. M.
(Representative)

ORIGINAL SIGNED BY JOE C. SALMON

Address

This is to certify that the well location shown on the plat in Section B was taken from field notes of actual surveys made by me or under my supervision and that the same is true and correct to the best of my knowledge and belief.

Date Surveyed Aug. 22, 1959

Ernest V. Echoshawk
Ernest V. Echoshawk
Registered Land Surveyor.

Certificate No. 1545

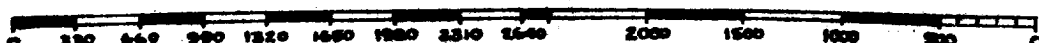

STATE OF NEW MEXICO		
OIL CONSERVATION COMMISSION		
AZTEC DISTRICT OFFICE		
NUMBER OF COPIES RECEIVED		6
DISTRIBUTION		
SANTA FE		1
FILE		2
U.S.G.S.		1
FIELD OFFICE		2
TRANSPORTER	OIL	
	GAS	
REGULATION OFFICE		
OPERATOR		2