

		• 77

(SUBMIT IN TRIPLICATE)

UNITED STATES
DEPARTMENT OF THE INTERIOR
GEOLOGICAL SURVEY

Indian Agency Nava Jo
Tribal
Allottee Nava Jo "M"
Lease No. 14-20-403-9013

SUNDRY NOTICES AND REPORTS ON WELLS

NOTICE OF INTENTION TO DRILL	<input checked="" type="checkbox"/>	SUBSEQUENT REPORT OF WATER SHUT-OFF	
NOTICE OF INTENTION TO CHANGE PLANS		SUBSEQUENT REPORT OF SHOOTING OR ACIDIZING	
NOTICE OF INTENTION TO TEST WATER SHUT-OFF		SUBSEQUENT REPORT OF ALTERING CASING	
NOTICE OF INTENTION TO REDRILL OR REPAIR WELL		SUBSEQUENT REPORT OF REDRILLING OR REPAIR	
NOTICE OF INTENTION TO SHOOT OR ACIDIZE		SUBSEQUENT REPORT OF ABANDONMENT	
NOTICE OF INTENTION TO PULL OR ALTER CASING		SUPPLEMENTARY WELL HISTORY	
NOTICE OF INTENTION TO ABANDON WELL			

(INDICATE ABOVE BY CHECK MARK NATURE OF REPORT, NOTICE, OR OTHER DATA)

Hobbs, New Mexico - February 13, 1963

Nava Jo "M"
Well No. 7 is located 790 ft. from N line and 2230 ft. from E line of sec. 34
NW/4 NE/4 Sec. 34 32-N 17-W N.M.P.M.
(1/4 Sec. and Sec. No.) (Twp.) (Range) (Meridian)
Horseshoe Gallup San Juan New Mexico
(Field) (County or Subdivision) (State or Territory)

The elevation of the derrick floor above sea level is _____ ft.

DETAILS OF WORK

(State names of and expected depths to objective sands; show sizes, weights, and lengths of proposed casings; indicate mudding, cementing points, and all other important proposed work)

Propose to drill with rotary tools from surface to total depth of approx. 1800' in the Gallup Formation. Casing program to be approx. as follows:

Size Hole	Size Casing	Casing Point	Feet of Cement
11"	8-5/8"	40'	10
7-7/8"	5-1/2"	1800'	75

The 40' of 8-5/8" OD casing will be cemented by hand, while the 1800' of 5-1/2" will be cemented by the pump & plug process. The well will be perforated and fractured with approx. 20,000 gals. of oil & 30,000# 20/40 sand. The designated drilling unit is the NW/4 NE/4 of Section 34-32N-17W, San Juan County, New Mexico.

I understand that this plan of work must receive approval in writing by the Geological Survey before operations may be commenced.

Company Shelly Oil Company

Address Box 96

Hobbs, New Mexico

By (ORIGINAL) H. E. Aab

Title Dist. Supt.

NEW MEXICO OIL CONSERVATION COMMISSION

Well Location and Acreage Dedication Plat

SECTION A.

Date **February 13, 1963**

Operator **Skelly Oil Company** Lease **Navajo "M"**
 Well No. **7** Unit Letter **B** Section **34** Township **32 North** Range **17 West** NMPM
 Located **750** Feet From **North** Line, **2230** Feet From **East** Line
 County **San Juan** G. L. Elevation **5882** Dedicated Acreage _____ Acres
 Name of Producing Formation **Gallup** Pool **Horseshoe Gallup**

1. Is the Operator the only owner* in the dedicated acreage outlined on the plat below? Yes ☒ No _____
2. If the answer to question One is "No," have the interests of all the owners been consolidated by communization agreement or otherwise? Yes _____ No _____. If answer is "Yes," Type of Consolidation _____
3. If the answer to question Two is "No," list all the owners and their respective interests below:

OWNER

LAND DESCRIPTION

SECTION B.

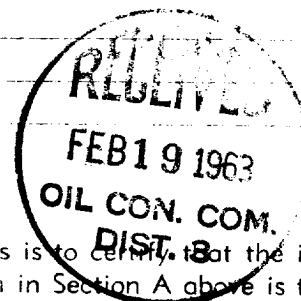
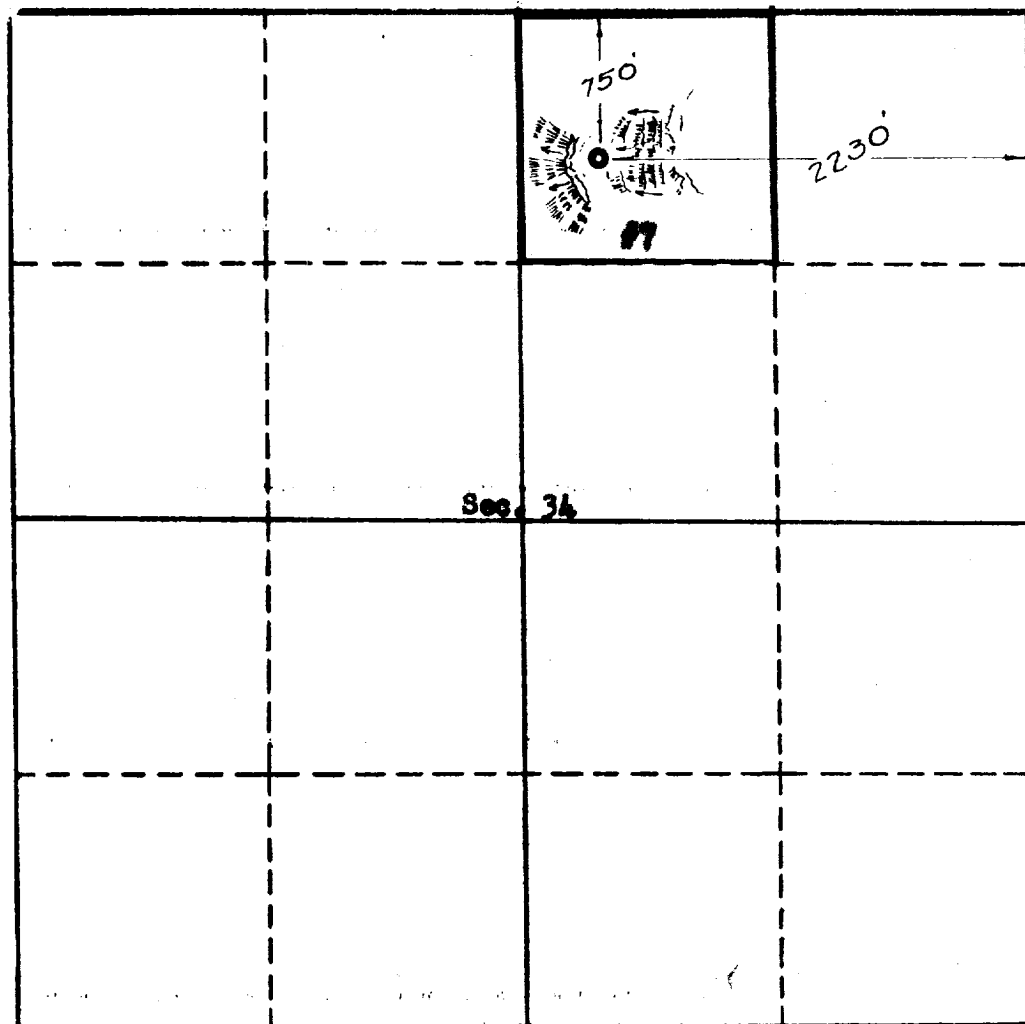

This is to certify that the information in Section A above is true and complete to the best of my knowledge and belief.

Skelly Oil Company
 (ORIGINAL SIGNATURE) **H. E. Anderson**
 Dist. Supt.
 (REPRESENTATIVE)

Box 38 - Hobbs, New Mexico
 (ADDRESS)

THIS is to certify that the well location shown on the plat in Section B was plotted from field notes of actual surveys made by me or under my supervision and that the same is true and correct to the best of my knowledge and belief.

Date Surveyed **Jan. 8, 1963**

Four States Engineering Co.
 FARMINGTON, NEW MEXICO

Charles J. Cochran
 REGISTERED ENGINEER OR
 LAND SURVEYOR

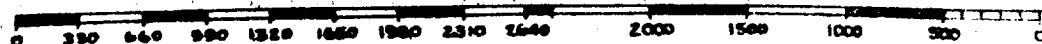
Certificate No. **3602**

(SUBMIT IN TRIPLICATE)

UNITED STATES
DEPARTMENT OF THE INTERIOR
GEOLOGICAL SURVEY

Indian Agency Navajo
Tribe Navajo
Allottee Navajo
Lease No. 14-20-603-5013

SUNDRY NOTICES AND REPORTS ON WELLS

NOTICE OF INTENTION TO DRILL	SUBSEQUENT REPORT OF WATER SHUT-OFF	XX
NOTICE OF INTENTION TO CHANGE PLANS	SUBSEQUENT REPORT OF SHOOTING OR ACIDIZING	
NOTICE OF INTENTION TO TEST WATER SHUT-OFF	SUBSEQUENT REPORT OF ALTERING CASING	
NOTICE OF INTENTION TO REDRILL OR REPAIR WELL	SUBSEQUENT REPORT OF REDRILLING OR REPAIR	
NOTICE OF INTENTION TO SHOOT OR ACIDIZE	SUBSEQUENT REPORT OF ABANDONMENT	
NOTICE OF INTENTION TO PULL OR ALTER CASING	SUPPLEMENTARY WELL HISTORY	
NOTICE OF INTENTION TO ABANDON WELL	Perforating and Treating	XX

(INDICATE ABOVE BY CHECK MARK NATURE OF REPORT, NOTICE, OR OTHER DATA)

Navajo, New Mexico March 13, 1963

Well No. 7 is located 720 ft. from N line and 2130 ft. from E line of sec. 34
N4 1/4 Sec. 34 12-N 17-W R.M.P.M.
(1/4 Sec. and Sec. No.) (Twp.) (Range) (Meridian)
Horseshoe Gallup San Juan New Mexico
(Field) (County or Subdivision) (State or Territory)

The elevation of the derrick floor above sea level is 5000 ft. O.L.

DETAILS OF WORK

(State names of and expected depths to objective sands; show sizes, weights, and lengths of proposed casings; indicate mudlogging jobs, cementing points, and all other important proposed work)

Well spudded March 2, 1963. Set 8-5/8" OD casing at 35' and cemented with 10 sacks by hand. V.O.C. Drilled to 1675'.

COSE NO. 1 - 1675-1685' - Perforated 20'
7-1/2' - Oil saturated sand
12-1/2' - Shale

Reached total depth of 1713' on March 13, 1963. Set 9-1/2" OD casing at 1720' and cemented with 75 sacks. V.O.C. 2 1/2 hrs. Shut off tested OK. Did not drill out cement plug at 1702'. P.B.T.D. 1702'. Perforated 9-1/2" OD casing from 1676-1683' for a total of 7' and 38 holes. Treated through 9-1/2" OD casing perfor. 1676-1683' with 22,462 gallons lease oil and 25,000/ 20/40 sand. After recovering all lease oil well pumped 115 barrels of oil in 2 1/2 hours.

I understand that this plan of work must receive approval in writing by the Geological Survey before operations may be commenced.

Company Shelly Oil Company

Address Box 30
Navajo, New Mexico

By (ORIGINAL) H. E. Aub

Title Dist. Supt.